

INSTALLATION INSTRUCTIONS

PARTS LIST:

Qty	Item Description	Qty	Item Description
1	Driver/Left Side Running Board	12	6-1.0mm x 25mm Hex Bolts
1	Passenger/Right Side Running Board	24	6mm x 22mm x 2mm Flat Washers
1	Driver/Left Side Front Mounting Bracket	12	6mm x 1.00mm Nylon Lock Nuts
1	Passenger/Right Side Front Mounting Bracket	6	8-1.25mm x 35mm Hex Bolts
1	Driver/Left Side Center Mounting Bracket	6	8mm x 28mm x 3mm Flat Washers
1	Passenger/Right Side Center Mounting Bracket	6	8mm Lock Washers
1	Driver/Left Side Rear Mounting Bracket	6	10-1.5mm x 30mm Hex Bolts
1	Passenger/Right Side Rear Mounting Bracket	6	10-1.5mm x 35mm Hex Bolts
3	Driver/Left Side Support Bracket	18	10mm x 30mm x 2.5mm Flat Washers
3	Passenger/Right Side Support Bracket	6	10mm x 1.50mm Hex Nuts
6	10mm x 1.25mm Hex Nut Plates	12	10mm Lock Washers
12	8-1.25mm x 25mm Combo Bolts		

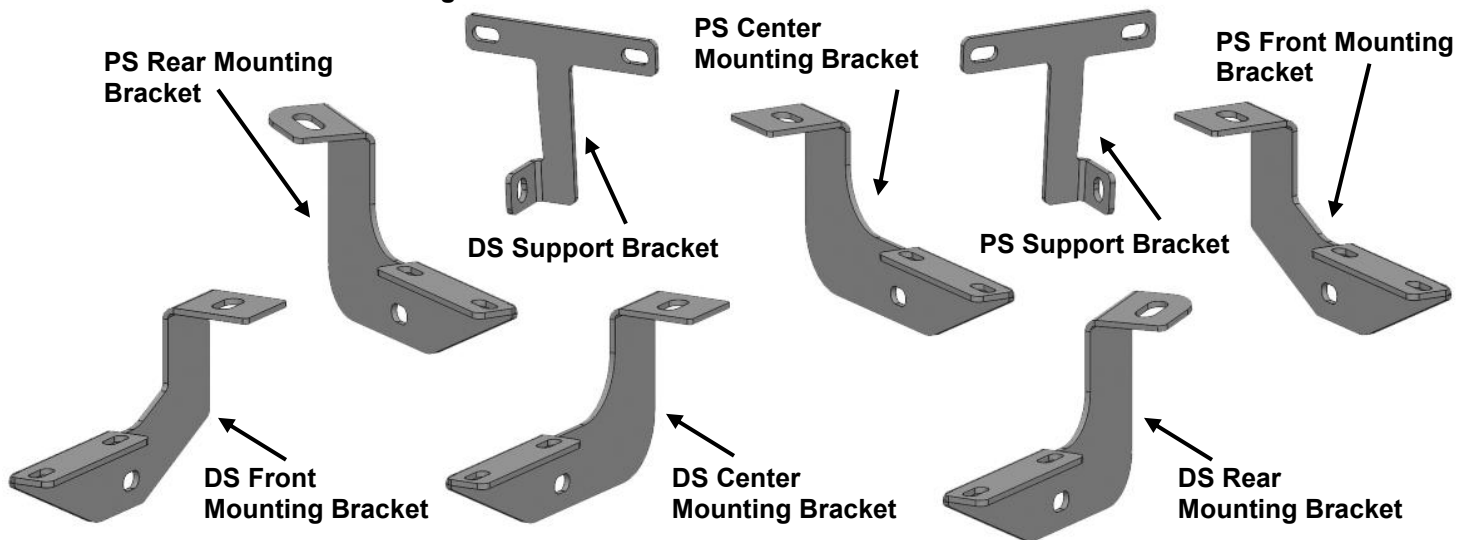
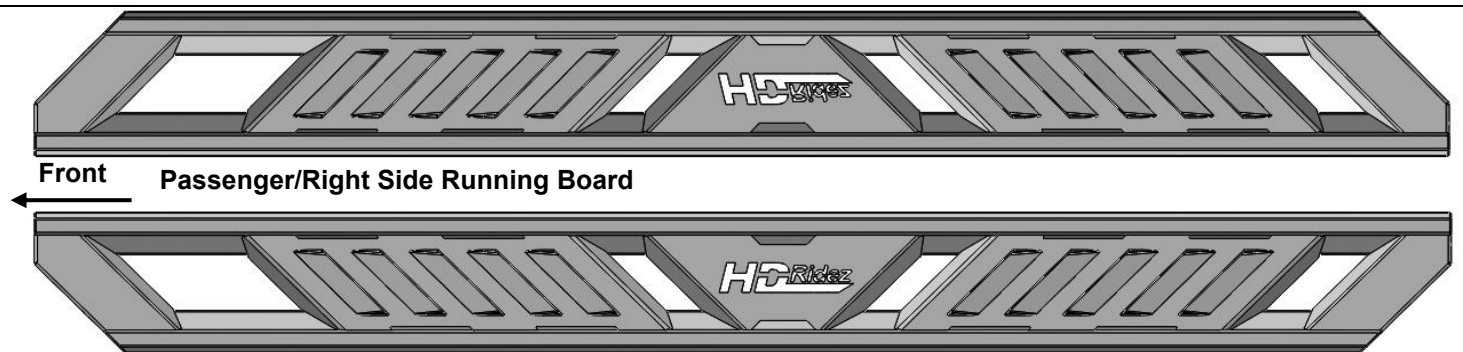

Lock Washer

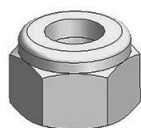

Lock Nut



Flat Washer

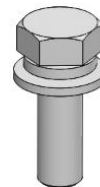

Combo Bolt



Hex Bolt

TOOLS REQUIRED



Ratchet



Socket



Extensions



Wrench

1

Follow (Fig 1 – 6) to attach Passenger/Right Mounting Brackets and Support Brackets. Ensure hardware is hand tightened. Repeat the following steps on the Driver Side.

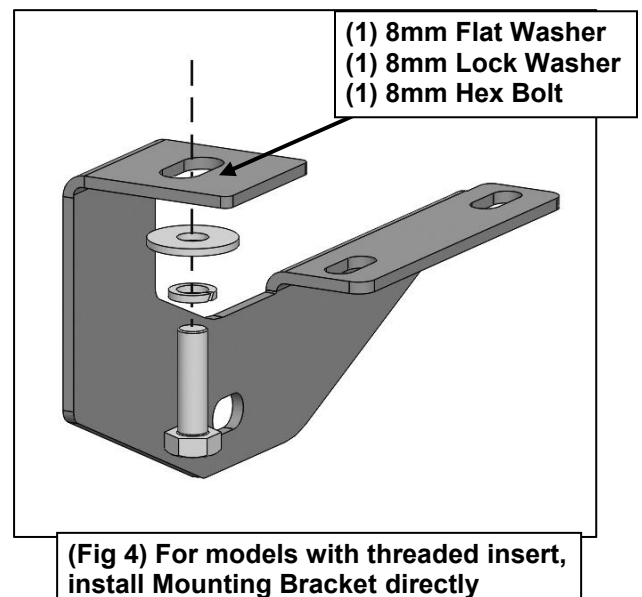
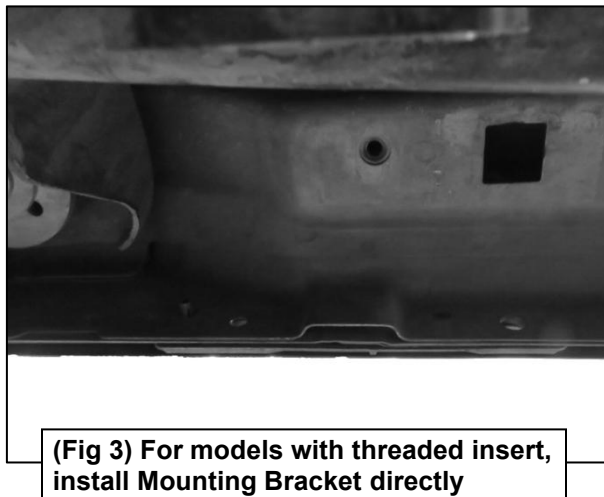
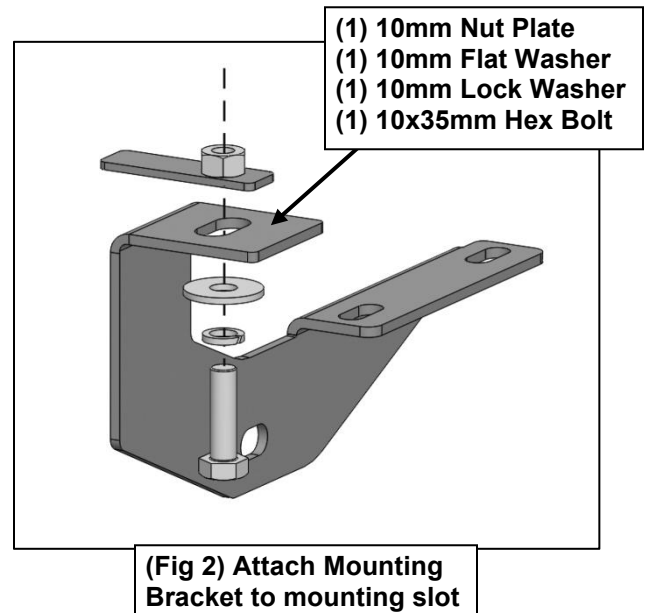
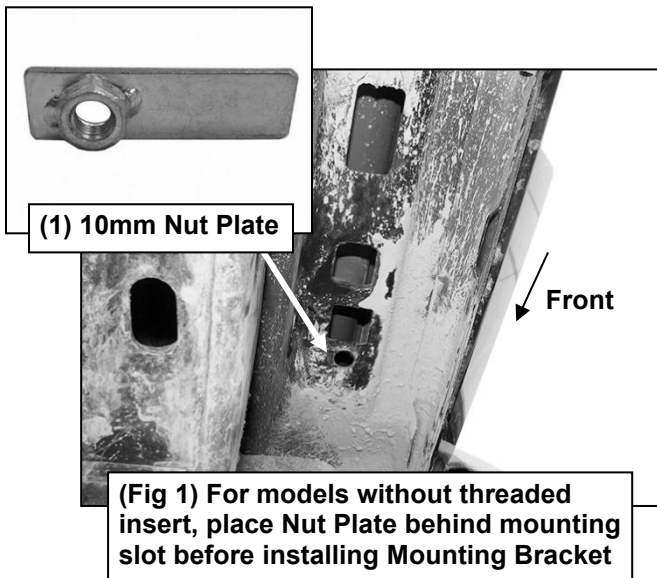

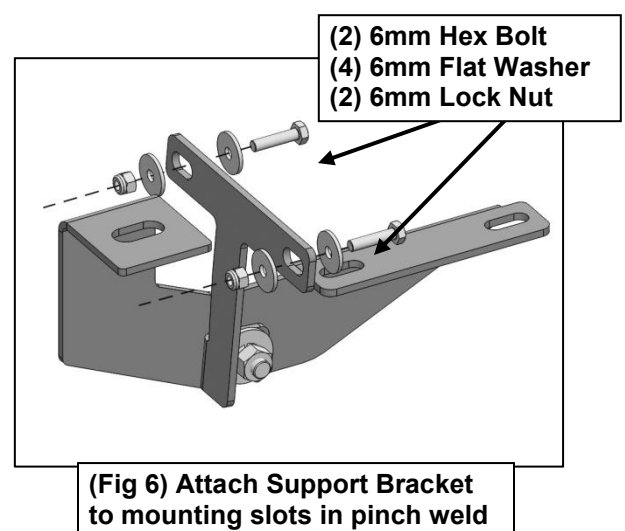
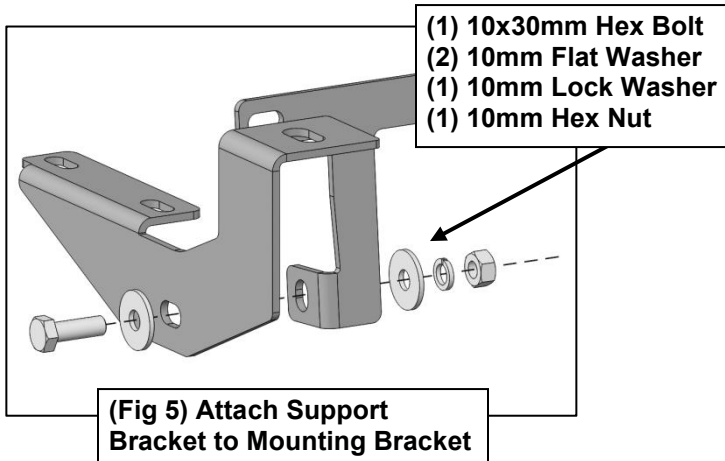

- 2** Follow (Fig 7 – 8) to attach Passenger/Right Running Board to Mounting Brackets. Ensure hardware is hand tightened. Repeat on Driver/Left side.

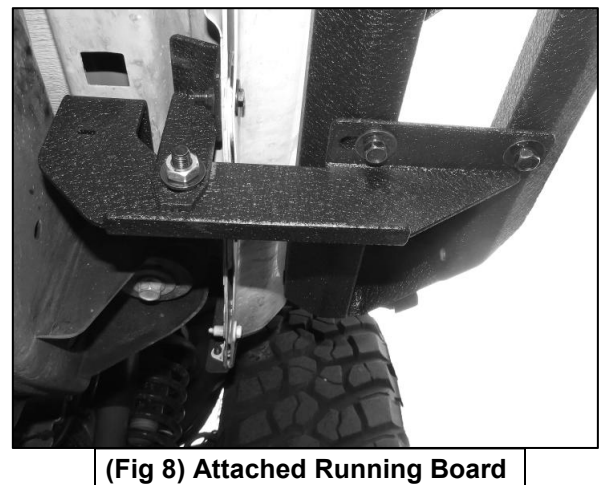
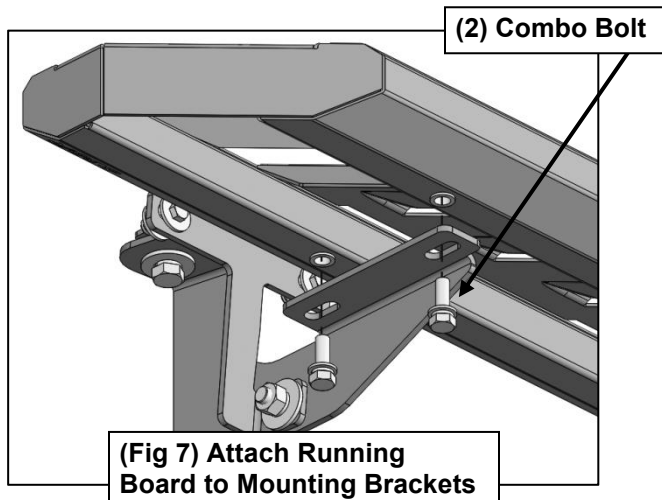

- 3** Installation is complete. Do periodic inspections to the installation to make sure that all hardware is secure and tight.

