

## Installation Instructions

### PARTS LIST:

Qty	Item Description	Qty	Item Description
1	Driver/Left Side Running Board	17	8-1.25mm x 25mm Hex Bolts
1	Passenger/Right Side Running Board	17	8mm x 24mm x 2mm Flat Washers
4	Driver/Left Mounting Bracket	17	8mm Lock Washers
3	Passenger/Right Center & Rear Mounting Bracket	15	8mm Clip Nuts
1	Passenger/Right Side Front Mounting Bracket	1	8mm Nylon Lock Nut
1	Passenger/Right Side Front Support Bracket	1	8-1.25mm x 35mm Bolt Plate
16	8-1.25mm x 25mm Combo Bolts		



Front  
←

Passenger/Right Running Board



Driver/Left Running Board

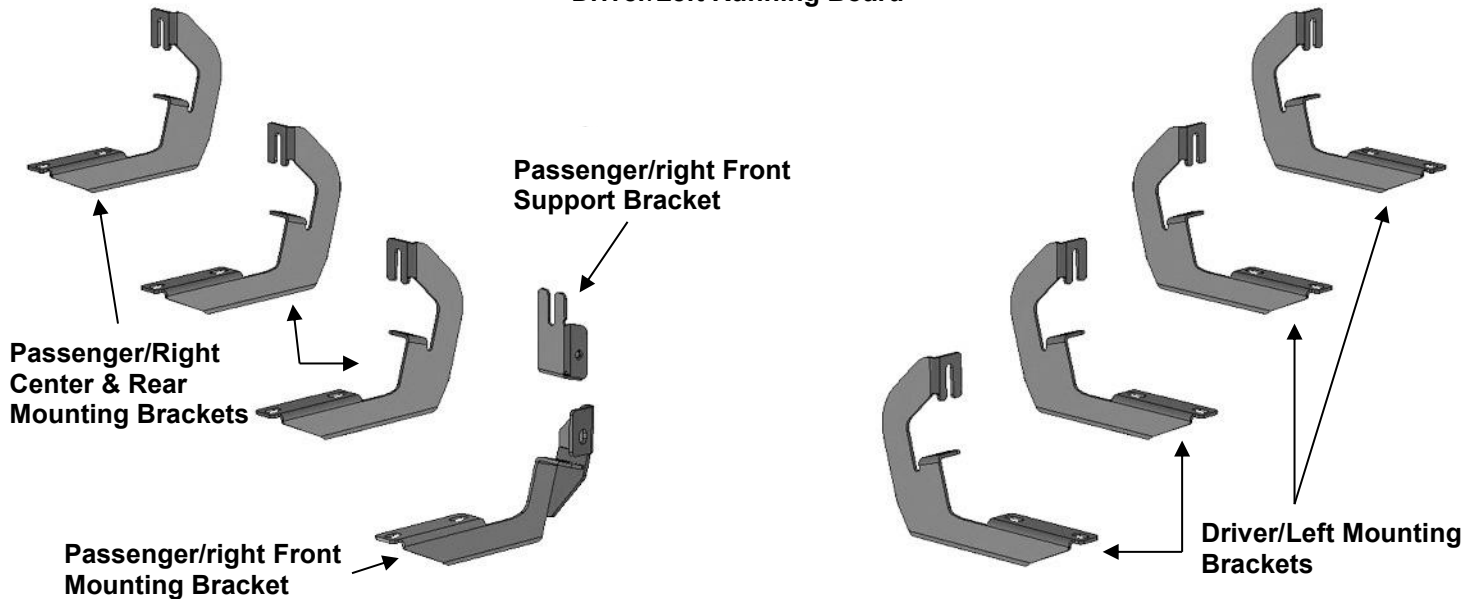

Hex Bolt

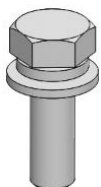

Combo Bolt

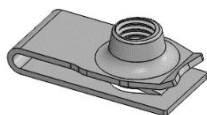

Clip Nut



Lock Washer

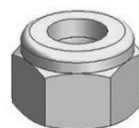

Lock Nut



Flat Washer

### TOOLS REQUIRED



**Ratchet**



**13mm Socket**



**Extensions**



**Wrench**

**1**

Follow (Fig 1 – 21) to attach the brackets to the Driver Side. Remove DEF tank cover, then attach the brackets to the Passenger side. Ensure hardware is hand tightened at this point.

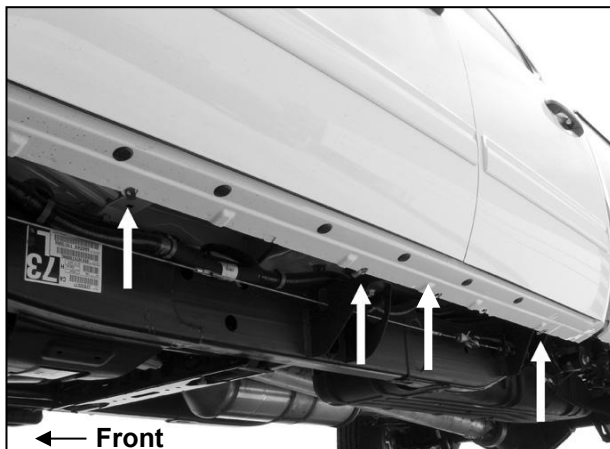

**(Fig 1) Driver/left side (4) mounting locations**

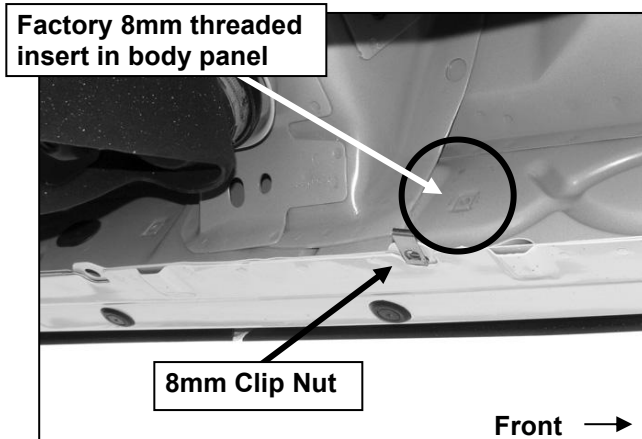

**(Fig 3) Driver/left side center location with tab and 8mm Clip Nut**

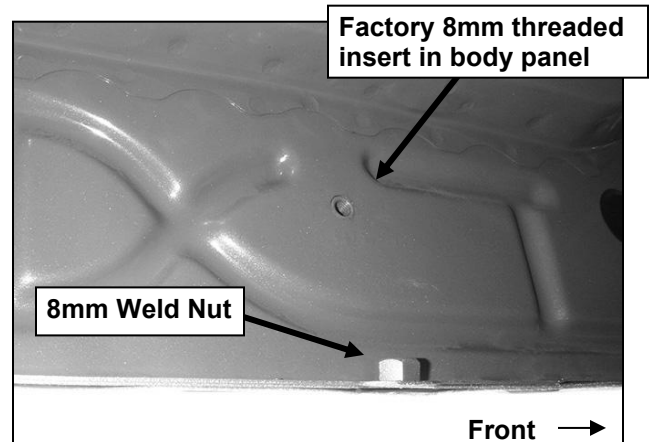

**(Fig 2) Passenger/right side front mounting location with weld nut pictured for example**

Remove plug

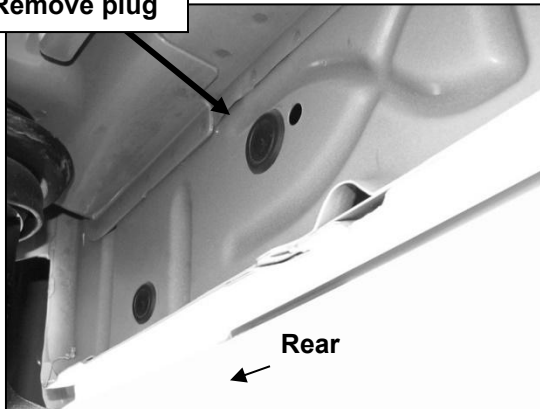

(Fig 4) Driver/left side rear mounting location

(2) 8mm Clip Nuts

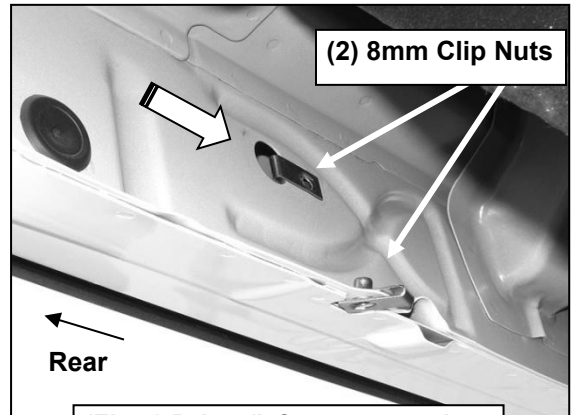

(Fig 5) Driver/left rear mounting location with 8mm Clip Nuts

(2) 8mm Clip Nuts

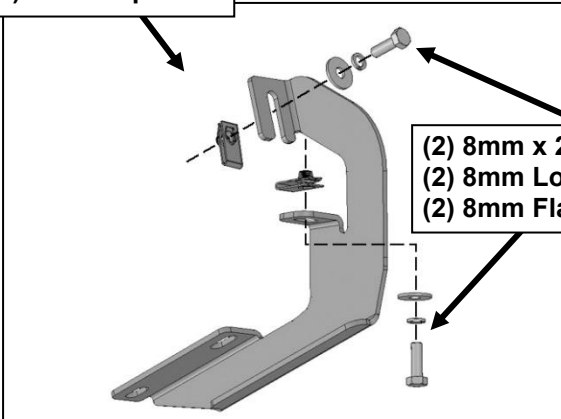

(2) 8mm x 25mm Hex Bolts  
 (2) 8mm Lock Washers  
 (2) 8mm Flat Washers

(Fig 6) Attach driver/left Mounting Brackets

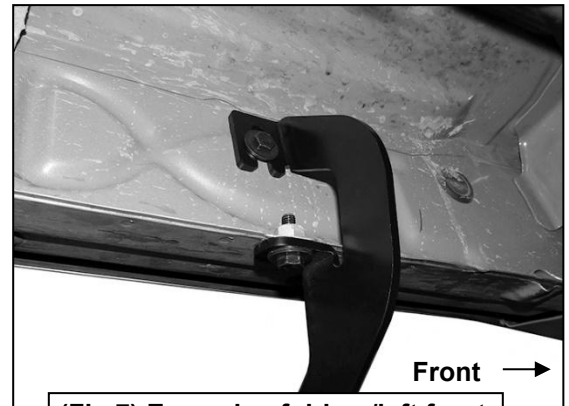

(Fig 7) Example of driver/left front Bracket attached to location with factory threaded mounting holes



(Fig 8) Example of driver/left rear Bracket attached to location with 8mm Clip Nuts

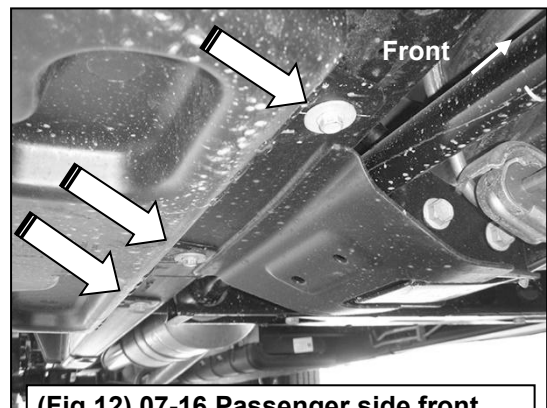

(Fig 12) 07-16 Passenger side front pictured with DEF tank cover. Remove (3) hex bolts to remove cover

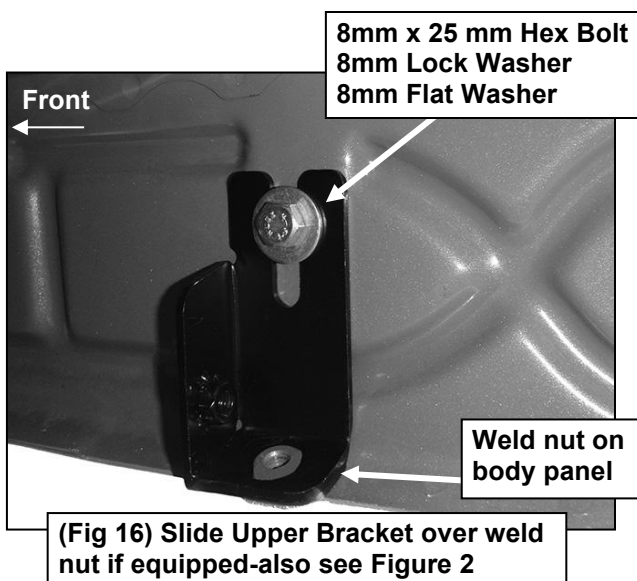
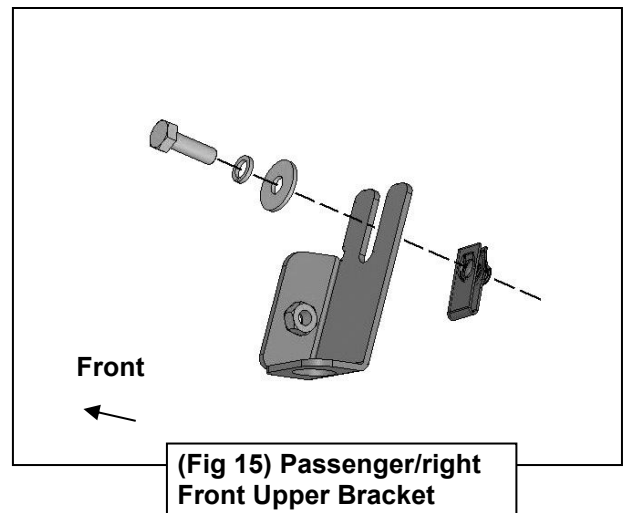
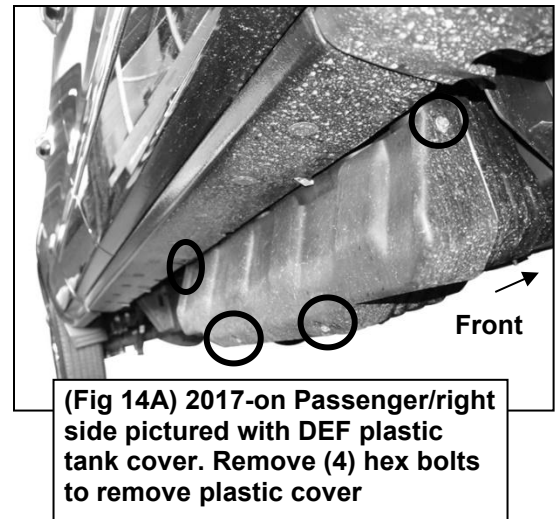
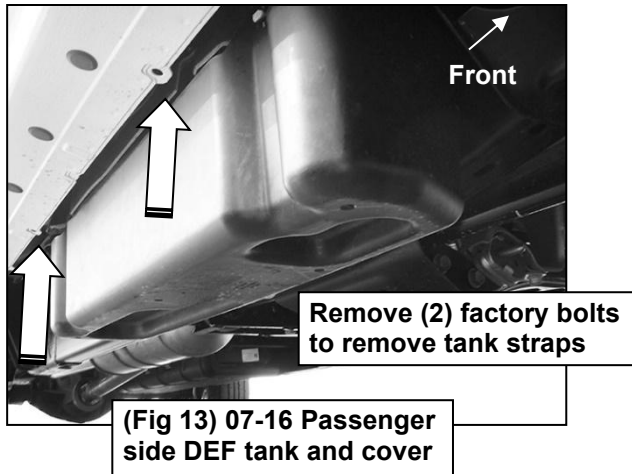

8mm x 25 mm Hex Bolt  
8mm Lock Washer  
8mm Flat Washer

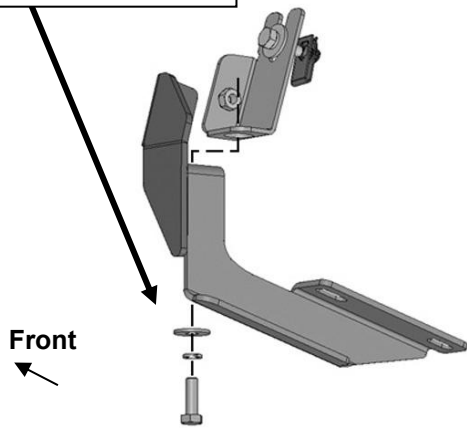

(Fig 17) On models with weld nut on pinch weld, attach passenger/right Front Lower Bracket to Upper Bracket and bottom of body

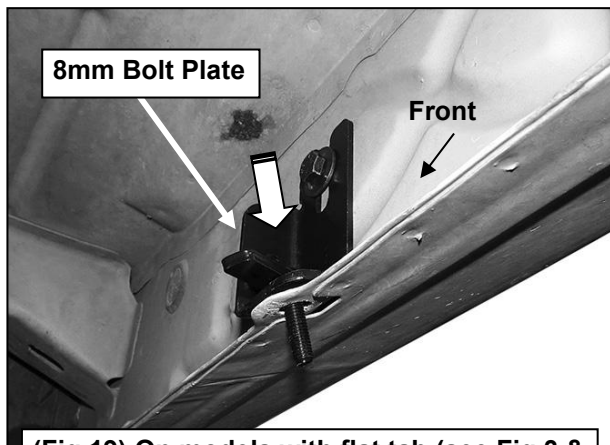

(Fig 19) On models with flat tab (see Fig 3 & 4), insert 8mm Bolt Plate (Fig 17) down through Upper Bracket and mounting tab

8mm x 25 mm Hex Bolt  
8mm Lock Washer  
8mm Flat Washer

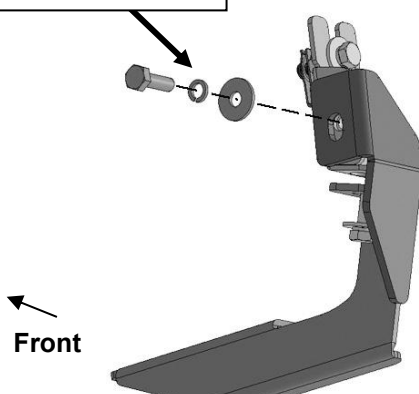

(Fig 21) Attach Front Lower Bracket to front facing side of Upper Bracket



(Fig 18) 8mm x 35mm Bolt Plate

8mm Flat Washer  
8mm Nylon Lock Nut

8mm Bolt Plate

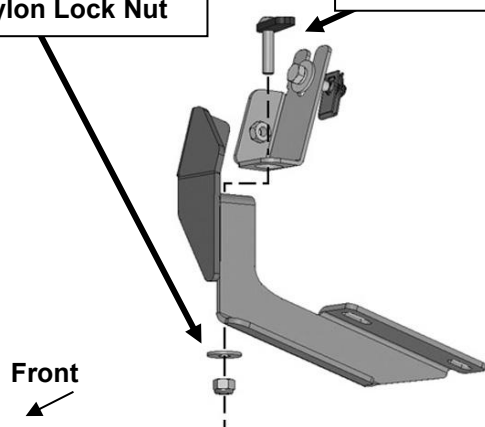

(Fig 20) On models with flat tab, attach passenger/right Front Lower Bracket to Upper Bracket and bottom of body

- 2** Follow (Fig 22 – 23) to attach Passenger/Right Running Board to Mounting Brackets. Repeat the following steps on the Driver/Left side. Ensure hardware is hand tightened at this point.

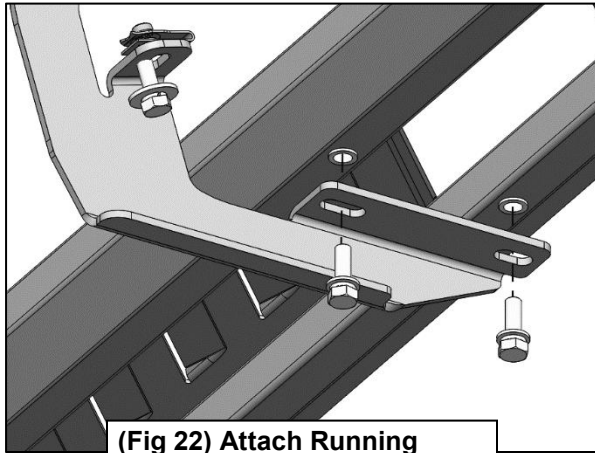

(Fig 22) Attach Running Board to Mounting Brackets



(Fig 23) Attached Running Board

- 3** Follow (Fig 24 – 26) to ensure Running Board is level, then tighten all hardware. Mark the DEF cover and trim, then reattach. Installation is complete. Do periodic inspections to the installation to make sure that all hardware is secure and tight.

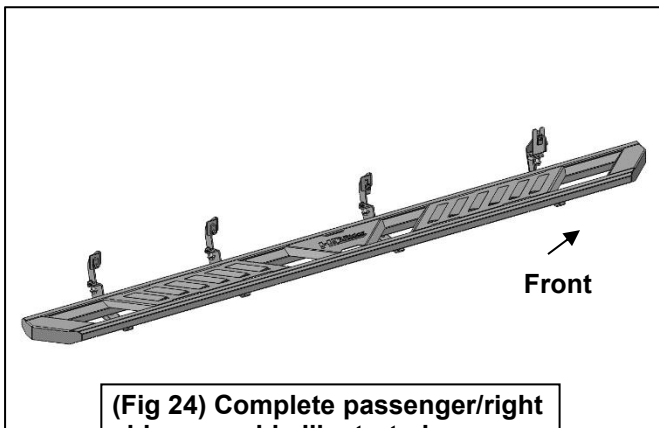

(Fig 24) Complete passenger/right side assembly illustrated

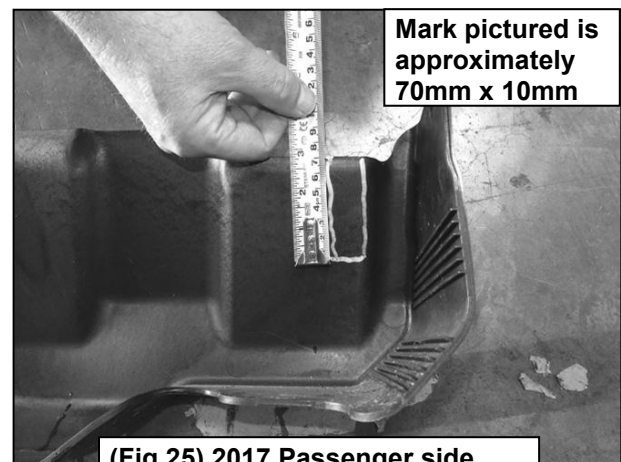

(Fig 25) 2017 Passenger side DEF cover marked for trimming



(Fig 26) 2017-on Passenger side DEF cut for example only