

SR1 Running Board
07-18 Chevy Silverado/GMC Sierra 1500 Ext /Double Cab
(Incl. 19-21 Silverado 1500 LD & 19-21 Sierra 1500 Limited)
07-19 Chevy Silverado/GMC Sierra 2500/3500 Ext/Double Cab (Including Diesel models with DEF)
Installation Instructions

PARTS LIST:

Qty	Item Description	Qty	Item Description
1	Driver/Left Running Board (76")	12	8-1.25mm x 25mm Combo Bolts
1	Passenger/Right Running Board (76")	13	8-1.25mm x 25mm Hex Bolts
3	Driver/Left Center & Rear Mounting Brackets	13	8mm x 24mm x 2mm Flat Washers
2	Passenger/Right Center & Rear Mounting Brackets	13	8mm Lock Washers
1	Passenger/Right Front Mounting Bracket	11	8mm Clip Nuts
1	Passenger/Right Front Support Bracket	1	8mm Nylon Lock Nut
1	8mm Bolt Plate		

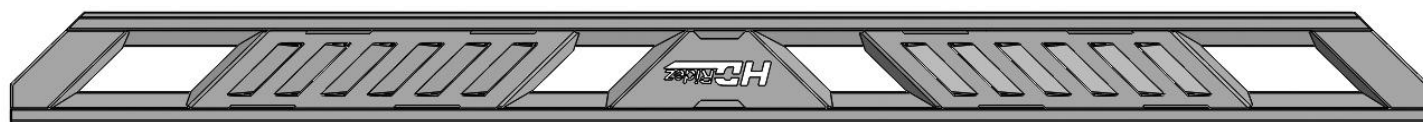

Front
←

Passenger/Right Running Board



Driver/Left Running Board

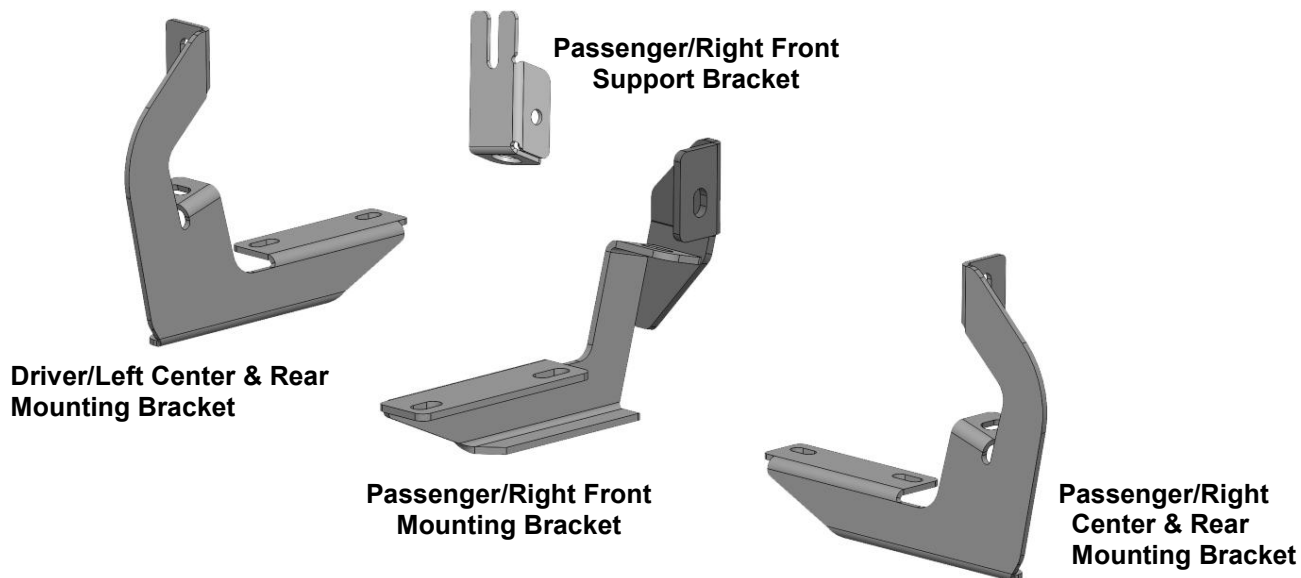

Hex Bolt

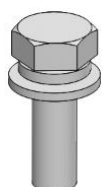

Combo Bolt

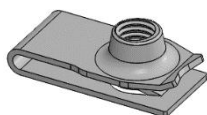

Clip Nut



Lock Washer

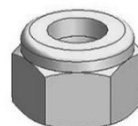

Lock Nut



Flat Washer

SR1 Running Board
07-18 Chevy Silverado/GMC Sierra 1500 Ext /Double Cab
(Incl. 19-21 Silverado 1500 LD & 19-21 Sierra 1500 Limited)
07-19 Chevy Silverado/GMC Sierra 2500/3500 Ext/Double Cab (Including Diesel models with DEF)

TOOLS REQUIRED



Ratchet



13mm Socket



Extensions



Wrench

1

Follow (Fig 1 – 17) to attach the brackets to the Driver Side. Remove DEF tank cover, then attach the brackets to the Passenger side. Ensure hardware is hand tightened at this point.

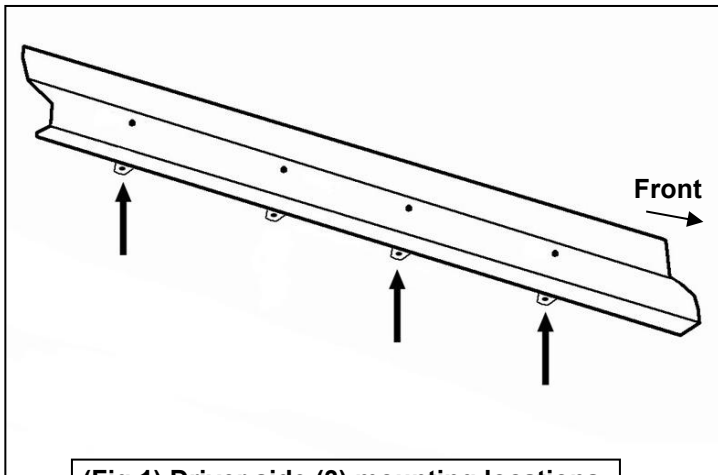

(Fig 1) Driver side (3) mounting locations

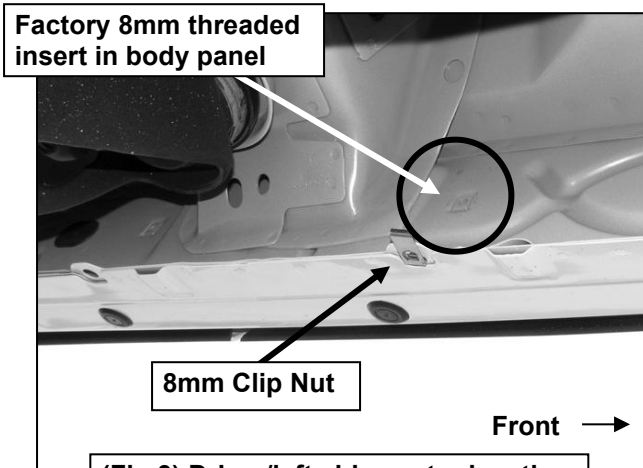

(Fig 3) Driver/left side center location with tab and 8mm Clip Nut

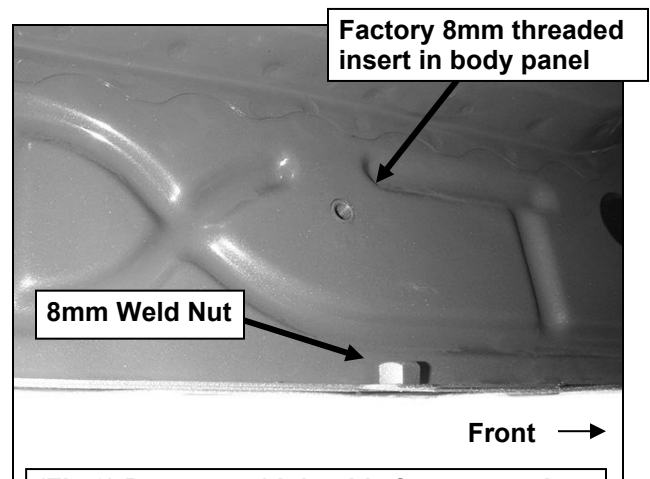

(Fig 2) Passenger/right side front mounting location with weld nut pictured for example

SR1 Running Board
07-18 Chevy Silverado/GMC Sierra 1500 Ext /Double Cab
(Incl. 19-21 Silverado 1500 LD & 19-21 Sierra 1500 Limited)

07-19 Chevy Silverado/GMC Sierra 2500/3500 Ext/Double Cab (Including Diesel models with DEF)

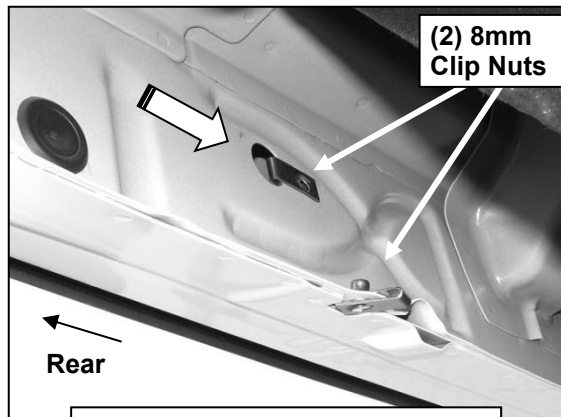

(Fig 4) Driver/left rear mounting location with 8mm Clip Nuts

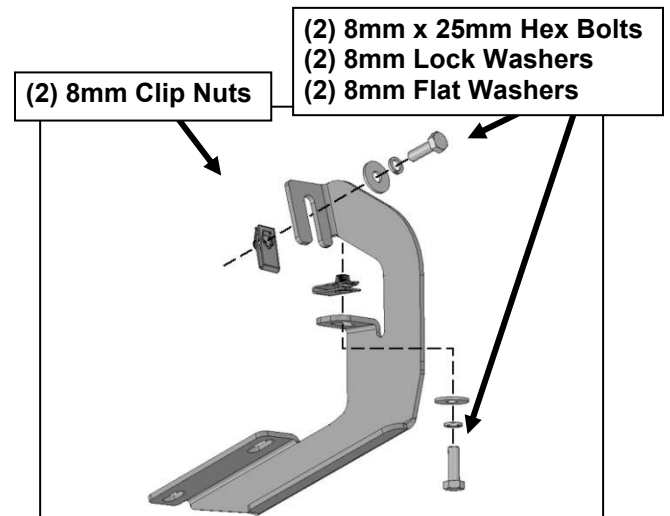

(Fig 5) Attach Driver/Left Mounting Brackets

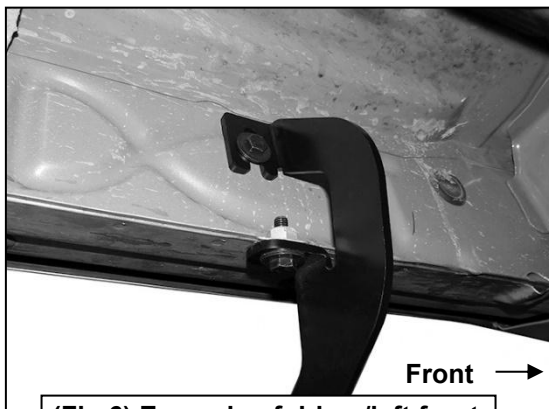

(Fig 6) Example of driver/left front Bracket attached to location with factory threaded mounting holes



(Fig 7) Example of driver/left rear bracket attached to location with 8mm Clip Nuts

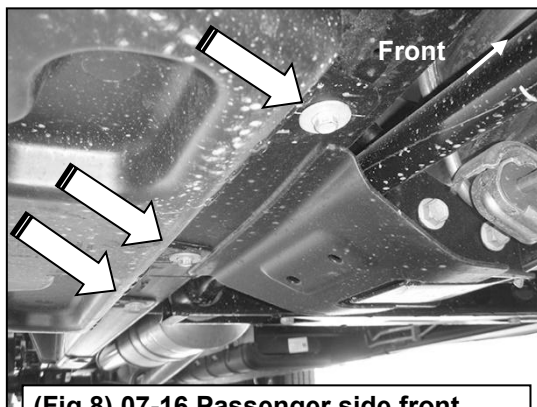

(Fig 8) 07-16 Passenger side front pictured with DEF tank cover. Remove (3) hex bolts to remove cover

SR1 Running Board
07-18 Chevy Silverado/GMC Sierra 1500 Ext /Double Cab
(Incl. 19-21 Silverado 1500 LD & 19-21 Sierra 1500 Limited)

07-19 Chevy Silverado/GMC Sierra 2500/3500 Ext/Double Cab (Including Diesel models with DEF)

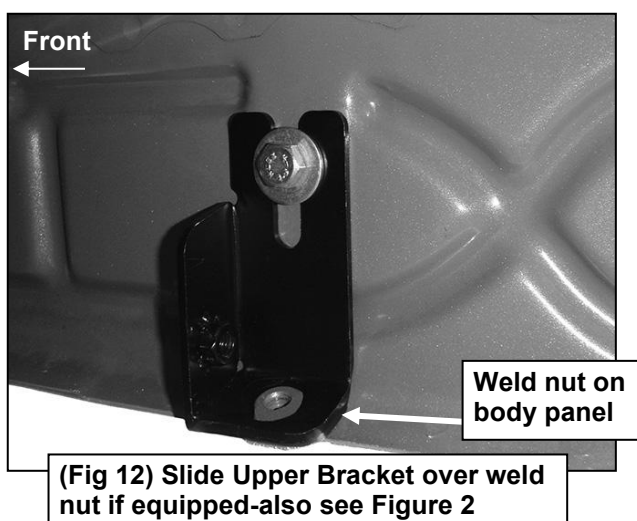
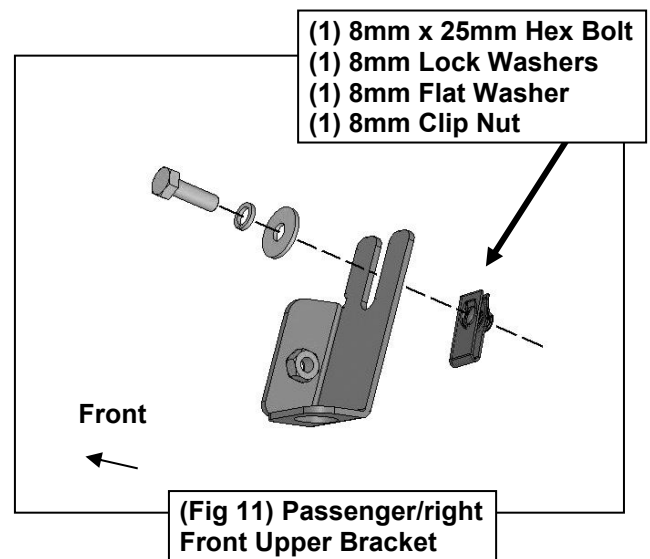
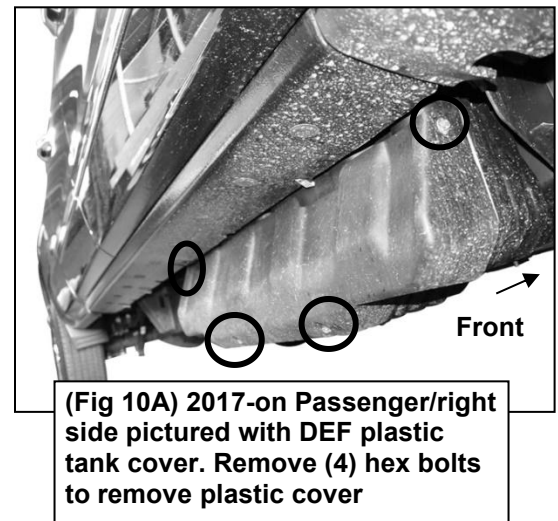
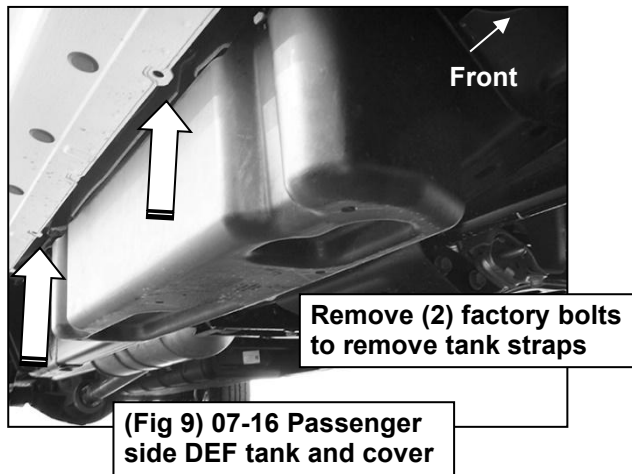

SR1 Running Board
07-18 Chevy Silverado/GMC Sierra 1500 Ext /Double Cab
(Incl. 19-21 Silverado 1500 LD & 19-21 Sierra 1500 Limited)

07-19 Chevy Silverado/GMC Sierra 2500/3500 Ext/Double Cab (Including Diesel models with DEF)

- (1) 8mm x 25mm Hex Bolt
- (1) 8mm Lock Washer
- (1) 8mm Flat Washer

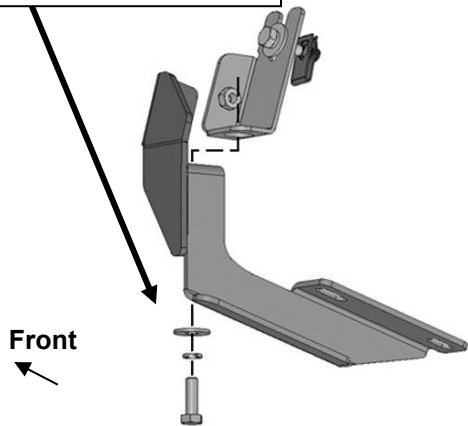

(Fig 13) On models with weld nut on pinch weld, attach passenger/right Front Lower Bracket to Upper Bracket and bottom of body

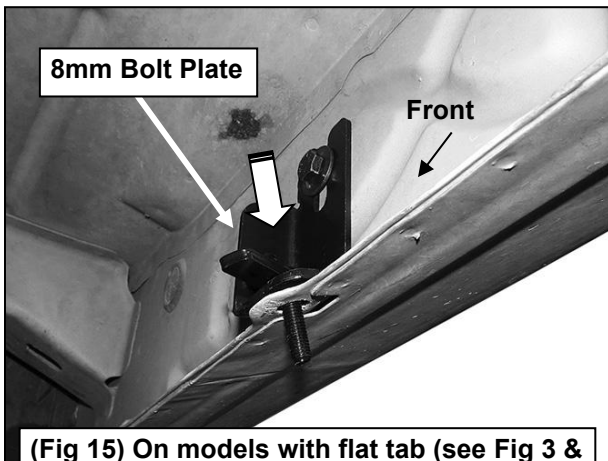

(Fig 15) On models with flat tab (see Fig 3 & 4), insert 8mm Bolt Plate (Fig 17) down through Upper Bracket and mounting tab

- (1) 8mm x 25mm Hex Bolt
- (1) 8mm Lock Washer
- (1) 8mm Flat Washer

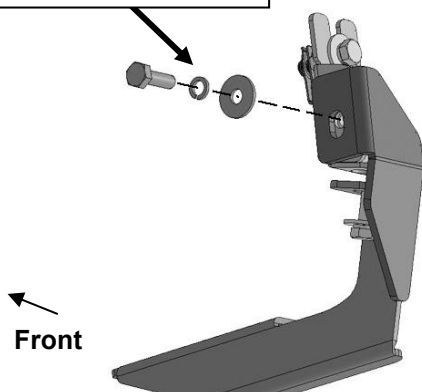

(Fig 17) Attach Front Lower Bracket to front facing side of Upper Bracket



(Fig 14) 8mm x 35mm Bolt Plate

- (1) 8mm Flat Washer

- (1) 8mm Bolt Plate

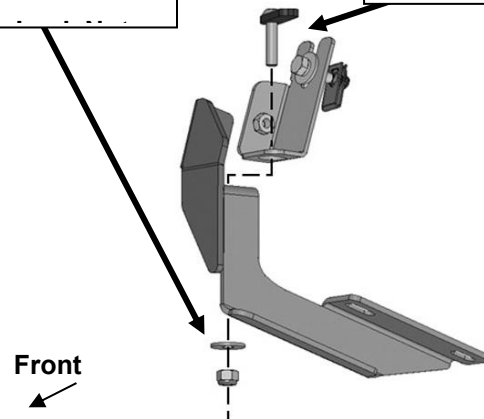

(Fig 16) On models with flat tab, attach passenger/right Front Lower Bracket to Upper Bracket and bottom of body

SR1 Running Board
07-18 Chevy Silverado/GMC Sierra 1500 Ext /Double Cab
(Incl. 19-21 Silverado 1500 LD & 19-21 Sierra 1500 Limited)
07-19 Chevy Silverado/GMC Sierra 2500/3500 Ext/Double Cab (Including Diesel models with DEF)

- 2** Follow (Fig 18 – 19) to attach Passenger/Right Running Board to Mounting Brackets. Repeat the following steps on the Driver/Left side. Ensure hardware is hand tightened at this point.

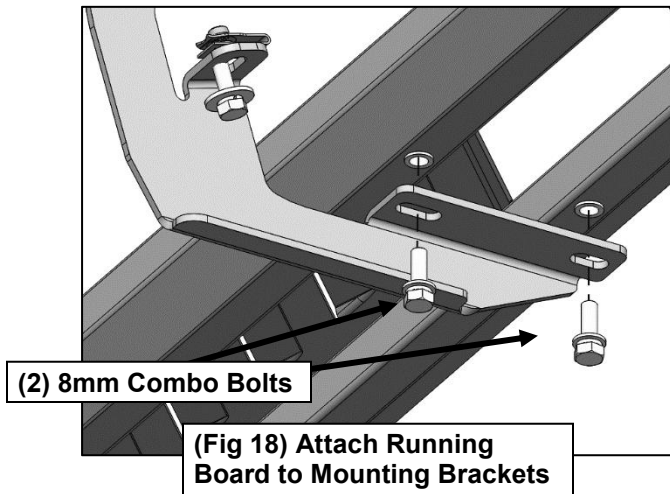

- 3** Follow (Fig 20 – 22) to ensure Running Board is level, then tighten all hardware. Mark the DEF cover and trim, then reattach. Installation is complete. Do periodic inspections to the installation to make sure that all hardware is secure and tight.

