

# iBoard®

## iBoard® by APS

PART#: IB-190

READ INSTRUCTIONS CAREFULLY BEFORE STARTING INSTALLATION. REMOVE CONTENTS FROM BOX AND VERIFY ALL PARTS ARE PRESENT. ASSISTANCE IS RECOMMENDED.

\*BODY FRAME MOUNT  
\*NO DRILLING REQUIRED

Fastener Size	Tightening Torque (ft-lbs)	Required
6mm	6-7	√
8mm	16-18	X
10mm	31-32	√
12mm	56-58	X
14mm	92-94	X

### PART LIST

Front

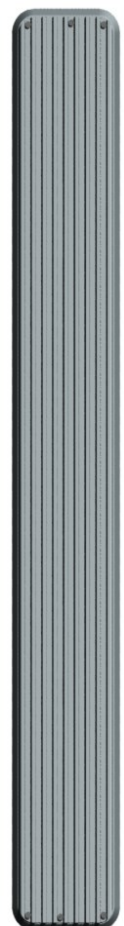

Driver Front Support

Bracket (DFS)

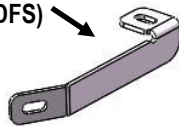

Passenger Front Support

Bracket (PFS)

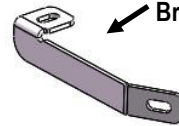

Driver Front Mounting

Bracket (DFM)

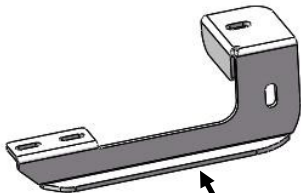

Passenger Front Mounting

Bracket (PFM)

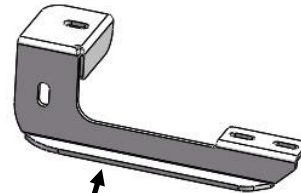

Driver Rear Mounting

Bracket (DRM)

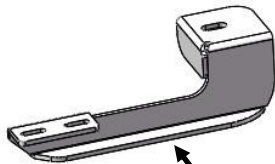

Passenger Rear Mounting

Bracket (PRM)

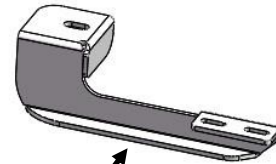

Customer Support: [info@iboardauto.com](mailto:info@iboardauto.com)

# iBoard®

## Hardware Package A (For Bracket Installation)

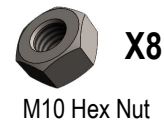
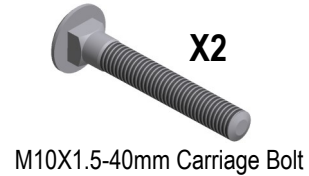
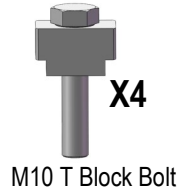

## Hardware Package B (For Aluminum Step Bar Installation Only, Not Supply to Stainless Steel Step Bar)

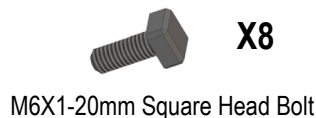

## Hardware Package C (For Stainless Steel Step Bar Installation Only, Not Supply to Aluminum Step Bar)



## STEP 1

Start installation from the driver side front of the vehicle. Locate and remove the factory round and oval rubber plugs in the bottom of the body panel located closest to the front tire opening, (Figs 1 & 2).

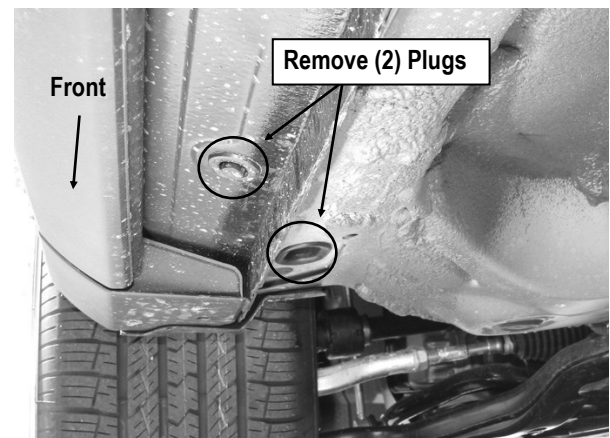

(Fig 1) Driver Side Front Mounting Location Pictured

# iBoard®

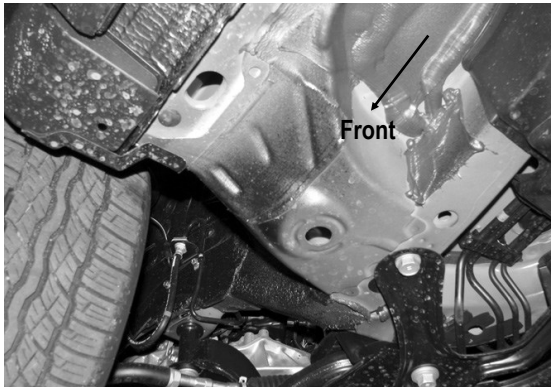

(Fig 2) Driver Side Front Mounting Location Pictured

## STEP 2

Select (1) M10X1.5-40mm Carriage Bolt, (1) M10 Rectangular Washer and (1) M10 Plastic Washer, (Fig 3A). Slide the Rectangular Washer onto and over the square shoulder on the Carriage Bolt. Thread the Plastic Washer part way onto the Bolt. **NOTE:** The Plastic Washer is designed to help hold the Bolt in place during Bracket installation.

Insert the Carriage Bolt with Rectangular Washer and Plastic Washer into the inner round hole in the floor panel. Line up the Carriage Bolt with the center of the hole and the Rectangular Washer across the hole. Pull the Carriage Bolt down through the slot in the Washer. Thread the Plastic Washer down tight against the floor panel, (Fig 3B).

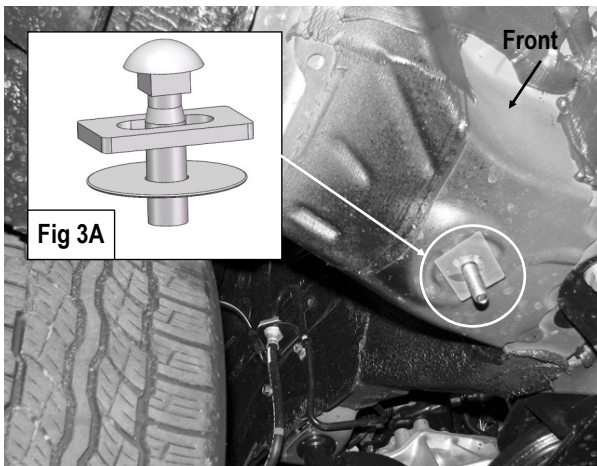

(Fig 3B) Insert M10X1.5-40mm Carriage Bolt

## STEP 3

Select (1) M10 T Block Bolt and (1) M10 Plastic Washer. Insert the M10 T Block Bolt up into the oval hole and rotate it 90-degrees so that the block is across the oval hole. Thread the Plastic Washer onto the T Block Bolt and tight against the floor panel, (Fig 4).

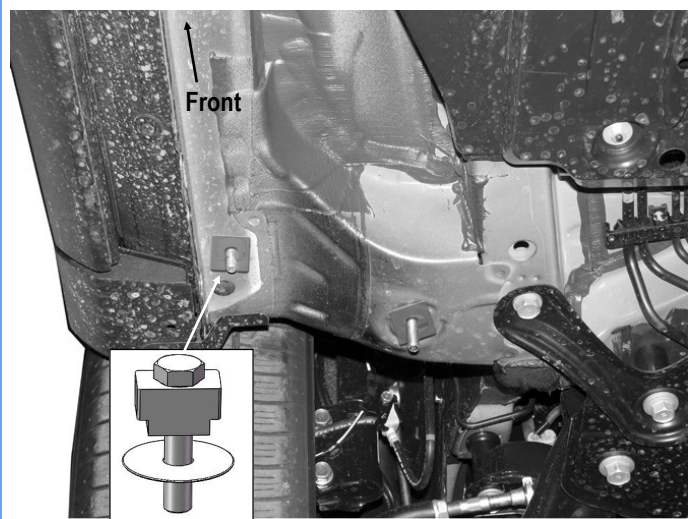

M10 T Block Bolt with  
M10 Plastic Washer

(Fig 4) Insert M10 T Block Bolt

## STEP 4

Assemble the Driver Front Support Bracket (DFS) and the Driver Front Mounting Bracket (DFM) with (1) M10X1.5-35mm Hex Bolt, (2) M10 Large Flat Washers, (1) M10 Lock Washer and (1) M10 Hex Nut, (Fig 5). Do not fully tighten at this time.

Next, attach the Driver Front Mounting Bracket (DFM) to the M10 T Block Bolt with (1) M10 Large Flat Washer, (1) M10 Lock Washer and (1) M10 Hex Nut, (Fig 6). Bolt the Support Bracket to the M10X1.5-40mm Carriage Bolt with (1) M10 Large Flat Washer, (1) M10 Lock Washer and (1) M10 Hex Nut, (Fig 6). Do not fully tighten the hardware at this time.

# iBoard®

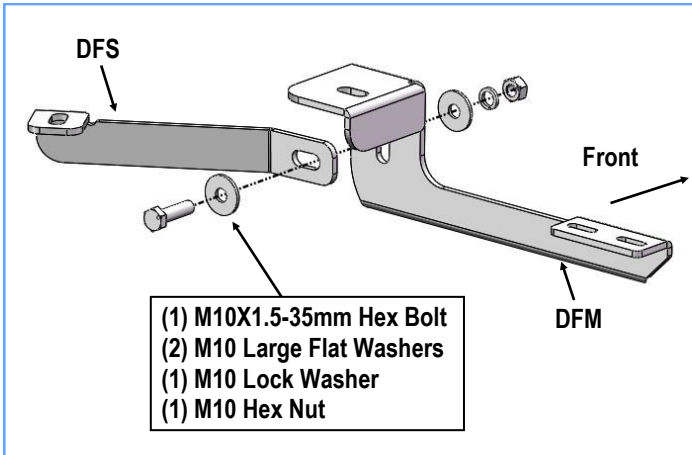

(Fig 5) Driver Side Front Brackets Assembly

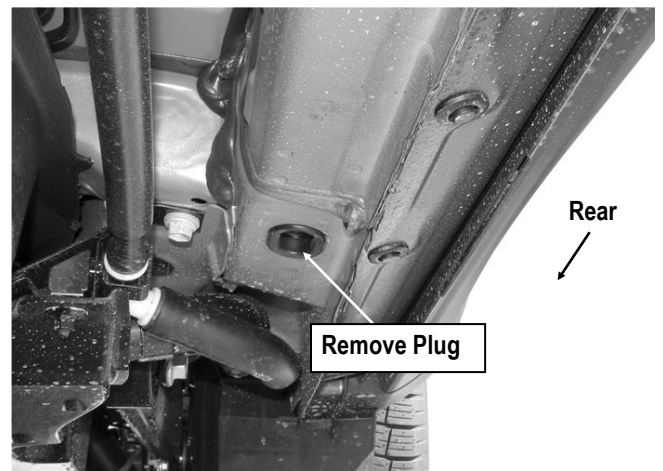

(Fig 7) Driver Side Rear Mounting Location

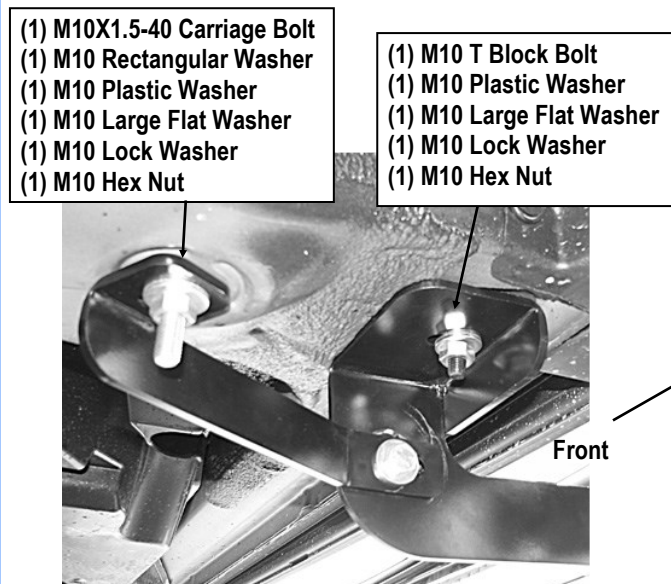

(Fig 6) Driver Side Front Mounting Bracket Installation

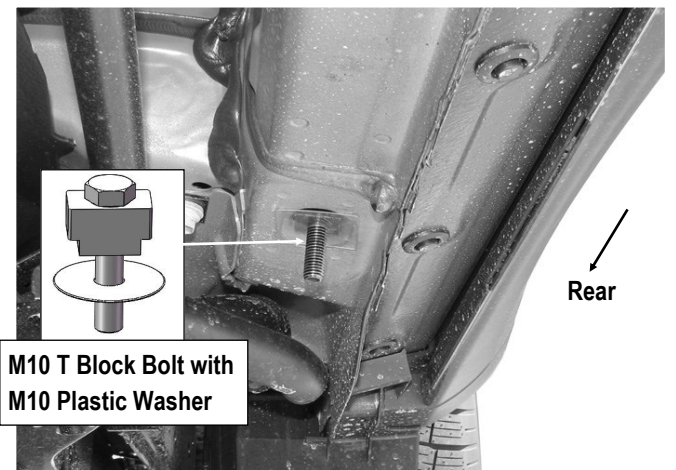

(Fig 8) Driver Side Rear Mounting Location

## STEP 5

Move to the rear mounting location, (Fig 7). Remove the oval rubber plug. Select (1) M10 T Block Bolt and (1) M10 Plastic Washer. Insert the M10 T Block Bolt up into the oval hole and rotate 90-degrees so that the block is across the oval hole. Thread the Plastic Washer onto the T Block Bolt and tight against the floor panel as described in **Step 2, (Fig 8)**.

## STEP 6

Select the Driver Rear Mounting Bracket (**DRM**). Hang the Rear Bracket from the M10 T Block Bolt with (1) M10 Large Flat Washer, (1) M10 Lock Washer and (1) M10 Hex Nut, (Fig 9). Do not fully tighten the hardware at this time.



# iBoard®



(Fig 9) Driver Side Rear Mounting Bracket Installation

## STEP 7

Once all (2) mounting brackets are installed, then proceed to the Step Bar installation. According to the style of Step Bar proceed to the correct installation STEPS.

**Note:** Aluminum Step Bar refer to STEP 8; Stainless Steel Step Bar skip to STEP 9.

## STEP 8

### Aluminum Step Bar Installation:

Select a **Aluminum Step Bar**. Slip (2) M6x1-20mm Square Head Bolts into each bottom channel (Fig 10). Carefully position the Step Bar onto the (2) Mounting Brackets.

**IMPORTANT:** Do not slide the Step Bar on the Brackets or the bottom surface of the board will be damaged. Attach the Step Bar to each Mounting Brackets with (2) M6x1-20mm Square Head Bolts, (2) M6 Large Flat Washers and (2) M6 Nylon Lock Nuts, (Fig 11). Do not fully tighten at this time.

Level and adjust the Step Bar and fully tighten all hardware.

Repeat **Steps 1-8** for the other side Step Bar installation. **The installation is completed!!!**



(Fig 10) Slip M6X1-20mm Square Head Bolts Into The Bottom Channels

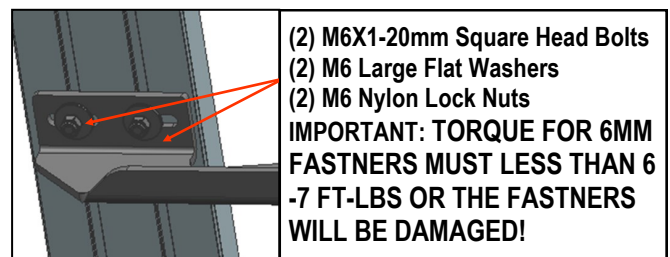

(Fig 11) Running Board Installed Onto Mounting Bracket

## STEP 9

### Stainless Steel Step Bar Installation:

Select a **Stainless Steel Step Bar** (with the U-Sliders installed on the Bar). Loose the U-Sliders, reposition the U-Sliders onto the board according to the (2) Installed Mounting Brackets location, (Fig 12). Re-secure the U-Sliders on the Step Bar. Attach the Step Bar to the installed Mounting Brackets with (4) M6X1-20mm Hex Bolts, (4) M6 Large Flat Washers & (4) M6 Lock Washers, (Fig 13). Do not fully tighten hardware at this time.

Level and adjust the Step Bar and fully tighten all hardware.

Repeat **Steps 1-7 and 9** for the other side Step Bar installation. **The installation is completed!!!**

# iBoard®



(Fig 12) Slide & line up the U-Slider with the installed mounting brackets along bottom channel

- (2) M6X1-20mm Hex Bolts
- (2) M6 Large Flat Washers
- (2) M6 Lock Washers

**IMPORTANT: TORQUE FOR 6MM FASTNERS MUST LESS THAN 6-7 FT-LBS OR THE FASTNERS WILL BE DAMAGED!**

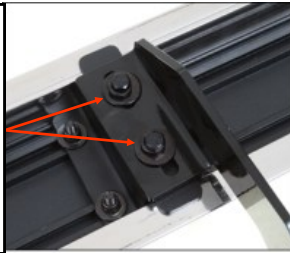

(Fig 13) Step Bar Installed on Bracket Installed (Example)

## Attention

Do periodic inspections to the installation to make sure that all hardware is secure and tight.

In order to protect your bars/boards, please use only mild soap/non-abrasive products for cleaning.