



**PART#: IB-P191Y&H**

## iBoard® Series

READ INSTRUCTIONS CAREFULLY BEFORE STARTING  
INSTALLATION. REMOVE CONTENTS FROM BOX AND  
VERIFY ALL PARTS ARE PRESENT. ASSISTANCE IS  
RECOMMENDED.

\*ROCKER PANEL MOUNT  
\*NO DRILLING REQUIRED

Fastener Size	Tightening Torque (ft-lbs)	Required
6mm	6-7	X
8mm	16-18	√
10mm	31-32	√
12mm	56-58	X
14mm	92-94	X

### PART LIST

#### Driver Side Step Bar

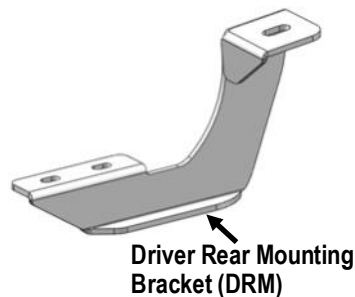
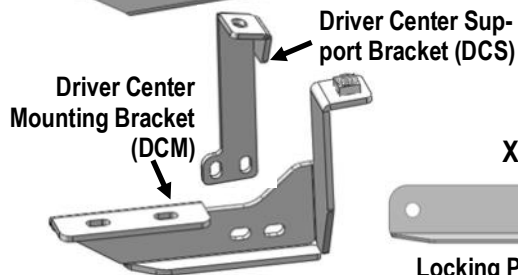
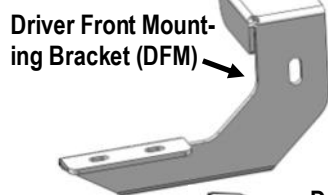
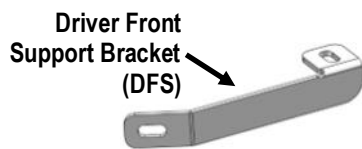

Front



#### Passenger Side Step Bar

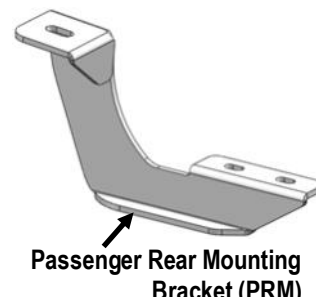
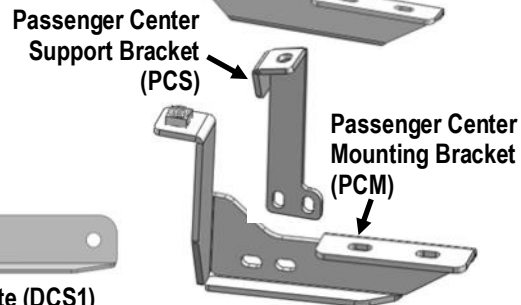
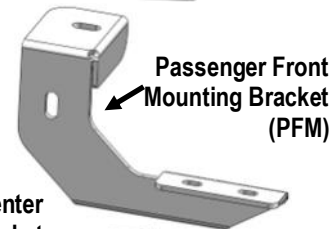
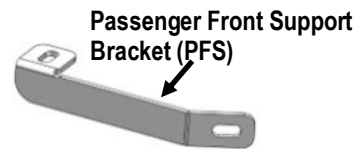

X2

Locking Plate (DCS1)



Scan for  
Installation Video

### Hardware Package A (For Bracket Installation)

Item	QTY	Description	Item	QTY	Description
1#	2	Support Plates	9#	6	M10 Large Flat Washers
2#	2	Rectangular Washers	10#	8	M10 Flat Washers
3#	4	M10X1.5-50 T-Bolt Plates	11#	12	M10 Nylon Lock Nuts
4#	4	M10X35 Bolt Plates	12#	2	M10 Hex Nuts
5#	10	M10 Plastic Washers	13#	4	M8X1.25-30 Hex Bolts
6#	2	M10X1.5-40 Hex Bolts	14#	8	M8 Flat Washers
7#	2	M10X1.5-40 Carriage Bolts	15#	4	M8 Nylon Lock Nuts
8#	2	M10X1.5-30 Hex Bolts			

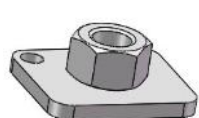

1 #



2 #



3 #



4 #



5 #



6 #



7 #



8 #



9 #



10 #



11#



12#



13#



14#



15#

### Hardware Package B (For Step Bar Installation)

Item	QTY	Description	Item	QTY	Description
1#	12	M8X1.25-35mm Carriage Bolts	3#	12	M8 Nylon Lock Nuts
2#	12	M8 Large Flat Washers	4#	6	Sliders (Packed with Mounting Brackets)



1 #



2 #



3 #



4 #



## STEP 1

Start installation from the driver side front of the vehicle. Locate and remove the factory oval rubber plug and the (2) round rubber plugs in the bottom of the floor panel close to the front tire, (Figs 1 & 2).

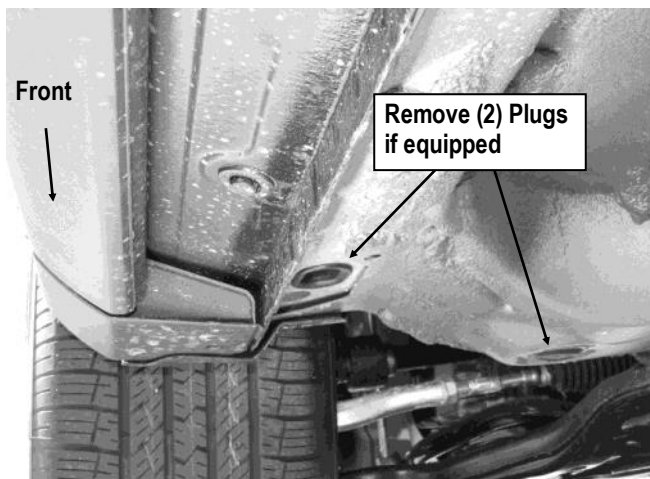

(Fig 1) Driver Side Front Mounting Location

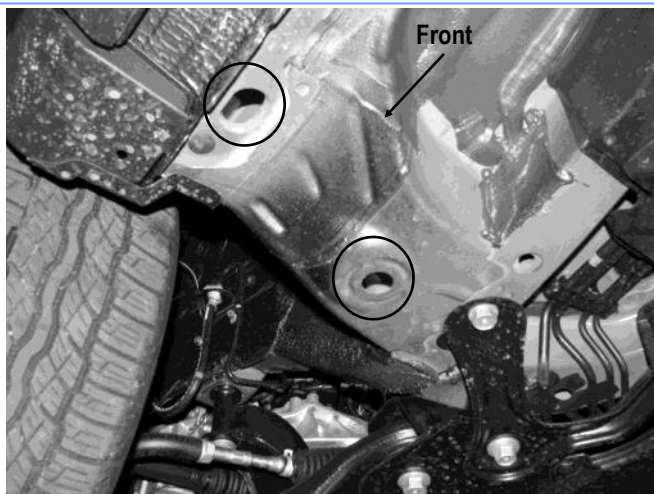

(Fig 2) Driver Side Front Mounting Location

## STEP 2

Select (1) M10X1.5-40 Carriage Bolt, (1) Rectangular Washer and (1) M10 Plastic Washer, (Fig 3A). Slide the Rectangular Washer onto and over the square shoulder on the Carriage Bolt. Thread the M10 Plastic Washer part way onto the Bolt.

**NOTE:** The M10 Plastic Washer is designed to help hold the Bolt in place during Bracket installation.

Insert the Carriage Bolt with Rectangular Washer and Plastic Washer into the inner round hole on the floor panel. Line up the Carriage Bolt with the center of the hole and the Rectangular Washer across the hole. Pull the Carriage Bolt down through the slot in the Washer. Thread the Plastic Washer down tight against the floor panel, (Fig 3B).

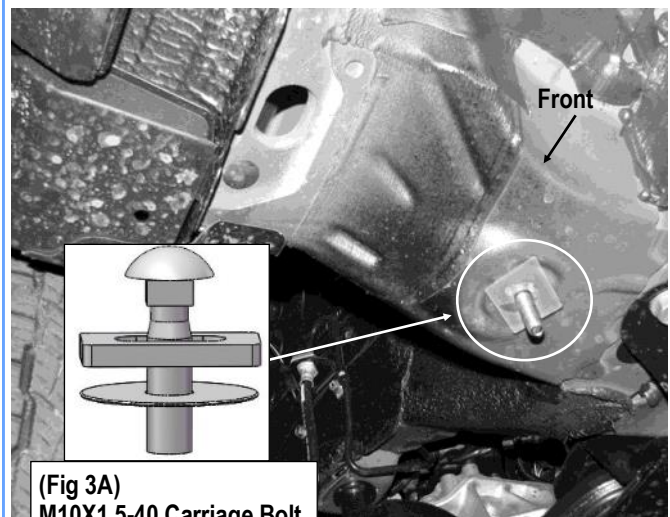

(Fig 3A)  
M10X1.5-40 Carriage Bolt  
Rectangular Washer  
M10 Plastic Washer

(Fig 3B) M10X1.5-40 Carriage Bolt Installed

## STEP 3

Select (1) M10X50 T-Bolt Plate and (1) M10 Plastic Washer, (Fig 4A). Insert the T-Bolt up into the oval hole and rotate it 90-degrees so that the block is across the oval hole. Thread the Plastic Washer onto the T-Bolt and tight against the floor panel, (Fig 4B).

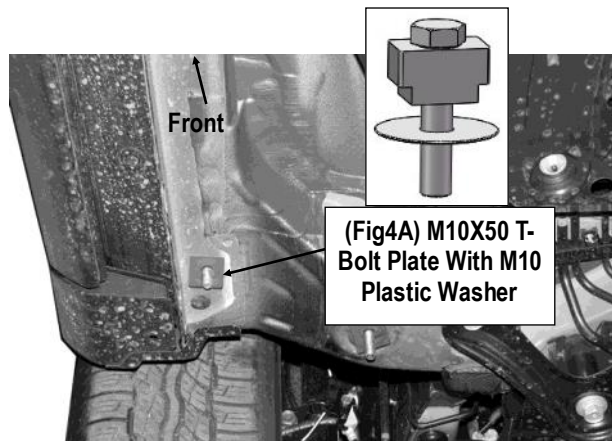

(Fig 4B) M10X50 T-Bolt Plate Installed

## STEP 4

Select (1) Driver Front Mounting Bracket (**DFM**) and (1) Driver Front Support Bracket (**DFS**). Assembly with (1) M10X1.5-30 Hex Bolt, (2) M10 Flat Washers and (1) M10 Nylon Lock Nut, (**Fig 5**). Do not fully tighten hardware at this time.

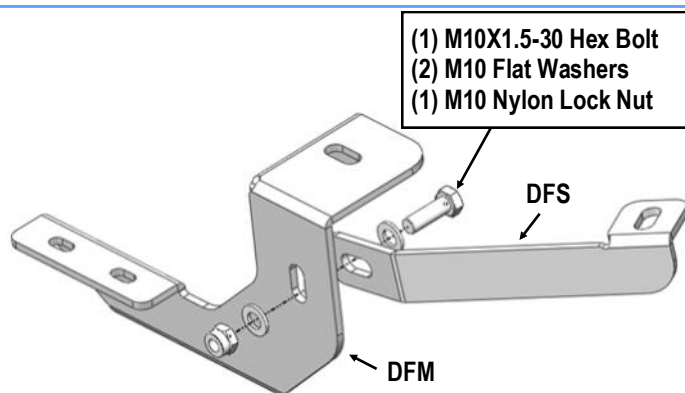

(Fig 5) Driver Side Front Brackets Assembly

## STEP 5

Secure the Driver Front Mounting Bracket (**DFM**) to the installed M10X50 T-Bolt Plate with (1) M10 Large Flat Washer and (1) M10 Nylon Lock Nut, (**Fig 6**). Do not fully tighten hardware at this time.

Slide the Driver Front Support Bracket (**DFS**) onto the M10X1.5-40 Carriage Bolt with (1) M10 Flat Washer and (1) M10 Nylon Lock Nut, (**Fig 6**). Do not fully tighten hardware at this time.

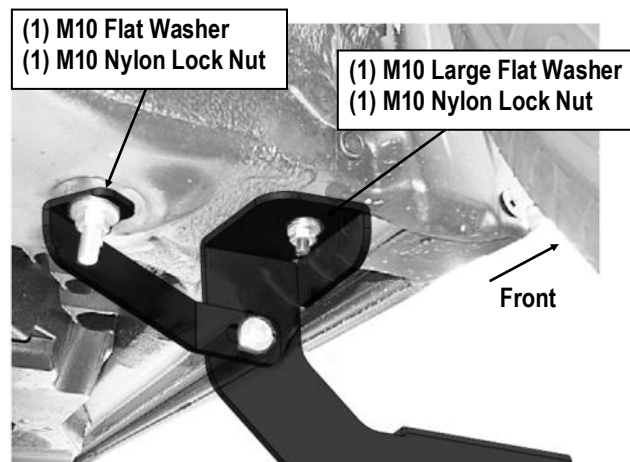

(Fig 6) Driver Side Front Mounting Bracket Installation

## STEP 6

Move to the Driver Side Center Mounting Location (The 4th and 5th holes on the floor panel from the front wheel), (**Fig 7**). Remove the (2) rubber plugs if equipped.

Insert (1) M10X35 Bolt Plate with (1) M10 Plastic Washer into the first and second round hole on the floor panel next to the pinch weld, (**Figs 8A & 8B**).

**NOTE:** Rotate the Bolt Plates with the "Plates" pointing toward each other, (**Fig 8C**).

Attach (1) Locking Plate to the (2) Bolt Plates with (1) M10 Large Flat Washer and (1) M10 Nylon Lock Nut, (**Fig 9**). Do not fully tighten hardware.





Locate the 4th and 5th rubber plugs along the floor panel from the front fender

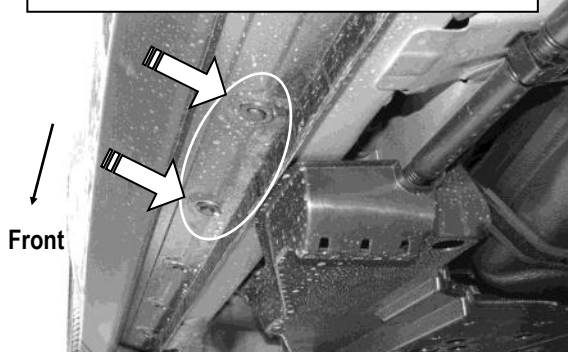

(Fig 7) Driver Side Center Mounting Location

(1) M10 Large Flat Washer  
(1) M10 Nylon Lock Nut



(Fig 9) Locking Plate (DCS1) Installation  
(Driver Side Center Mounting Location )

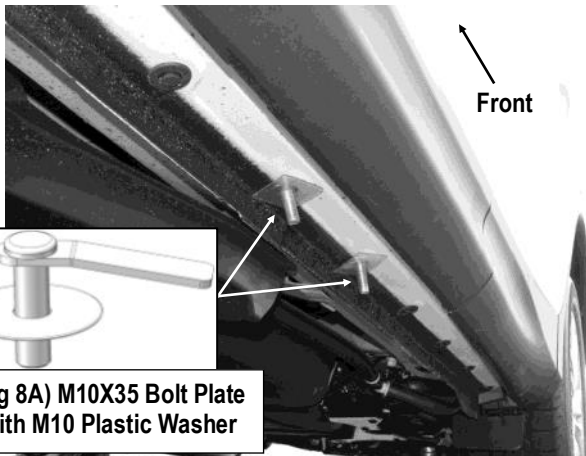

(Fig 8A) M10X35 Bolt Plate  
With M10 Plastic Washer

(Fig 8B) M10X35 Bolt Plates Installed

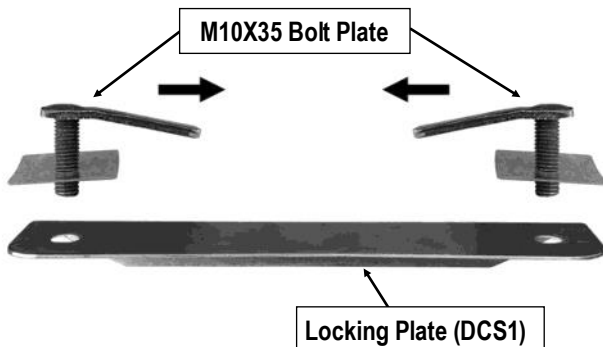

(Fig 8C) Install Bolt Plates With Plates Pointing Towards Each Other

## STEP 7

Assemble (1) Driver Center Mounting Bracket (**DCM**) and (1) Driver Center Support Bracket (**DCS**) with (2) M8X1.25-30 Hex Bolts, (4) M8 Flat Washers and (2) M8 Nylon Lock Nuts, (**Fig 10**). Do not fully tighten hardware at this time.

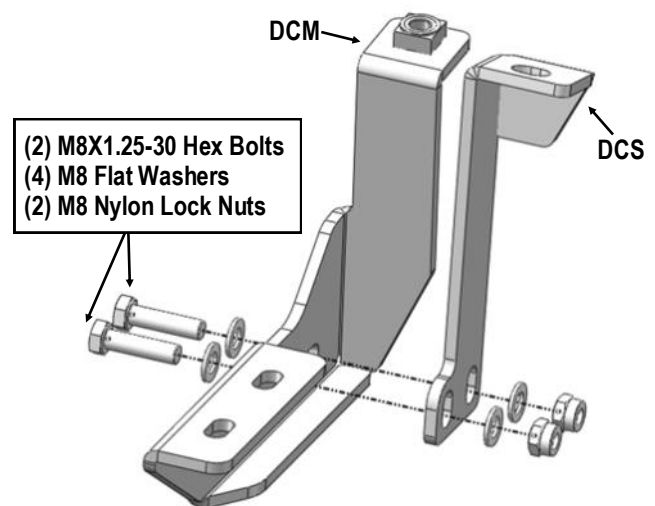

(Fig 10) Driver Side Center Brackets Assembly



## STEP 8

Select (1) Driver Center Support Bracket (**DCS**), hang the Center Support Bracket onto the installed M10x35 Bolt Plate and over the Lock Plate secure with (1) M10 Flat Washer and (1) M10 Nylon Lock Nut, (**Fig 12**). Do not fully tighten hardware at this time.

Select (1) M10X1.5-40 Hex Bolt, (1) Support Plate and (1) M10 Hex Nut. Thread the M10 Hex Nut all the way down the M10X1.5-40 Hex Bolt. Thread the Hex Bolt with Nut up and into the welded nut on the tab on the Driver Center Mounting Bracket (**DCM**), (**Figs 11 & 12**).

Place (1) Support Plate onto the threaded end of the M10X1.5-40 Hex Bolt, (**Fig 11**). Continue to thread the Hex Bolt in until the Support Plate is close to but not touching the bottom of the body panel, (**Fig 12**).

**IMPORTANT:** Do not tighten the hardware on the Center Brackets until the **final Steps**, (**Refer to Step 15**).

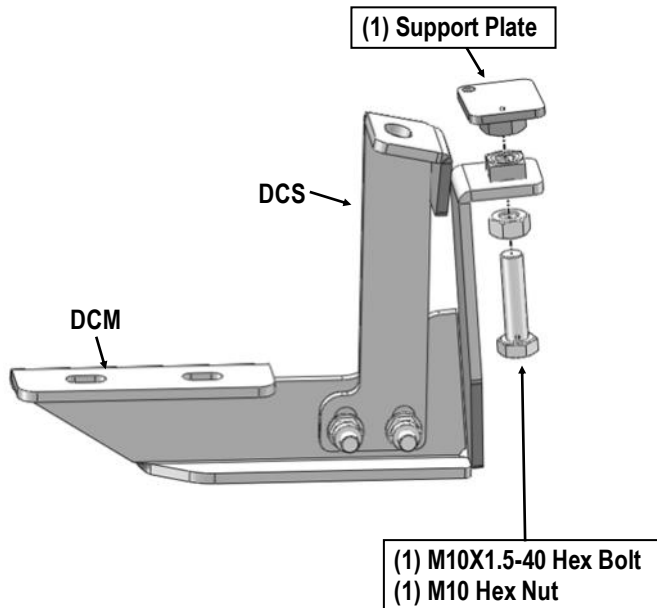

(Fig 11) Driver Side Center Mounting Bracket Installation

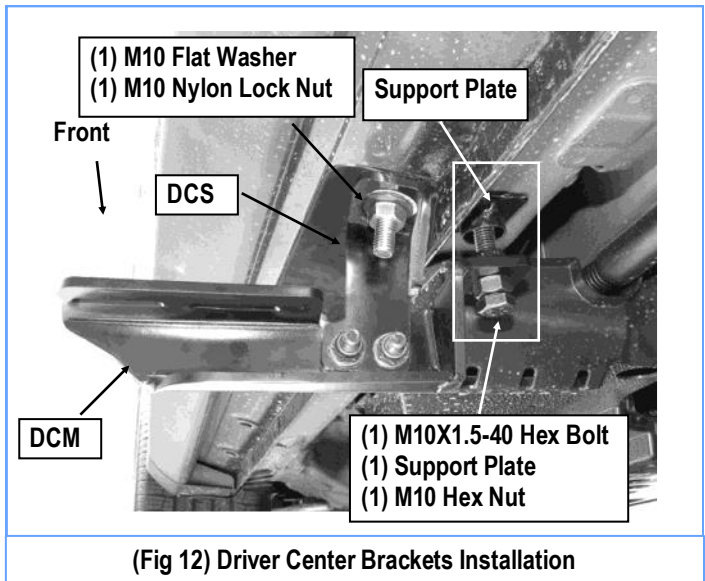

(Fig 12) Driver Center Brackets Installation

## STEP 9

Move to the rear of the vehicle, (**Fig 13**). Remove the oval rubber plug. Select (1) M10X50 T-Bolt Plate with (1) M10 Plastic Washer, (**Fig 14A**). Insert the T-Bolt up into the oval hole and rotate 90-degrees so that the block is across the oval hole. Thread the Plastic Retainer onto the T-Bolt and tight against the floor panel as described in **Step 3**, (**Fig 14B**).

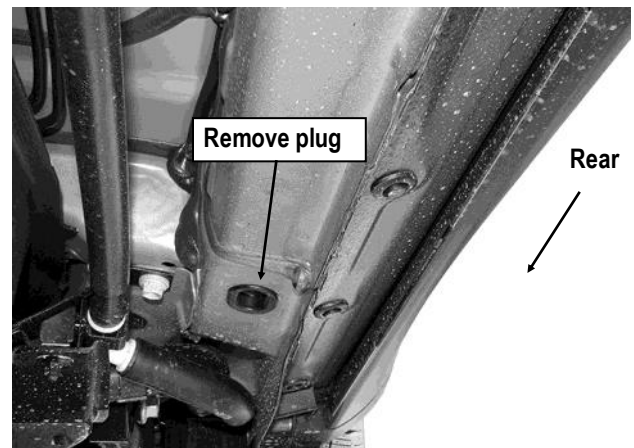

(Fig 13) Driver Side Rear Mounting Location

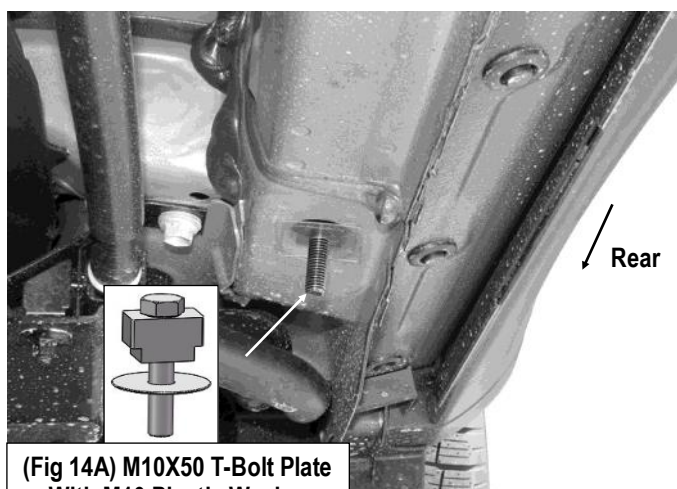

(Fig 14A) M10X50 T-Bolt Plate  
With M10 Plastic Washer

(Fig 14B) M10X50 T-Bolt Plate Installed  
(On Driver Side Rear Mounting Location)

## STEP 10

Select the Driver Rear Mounting Bracket (**DRM**). Hang the Rear Bracket to the installed T-Bolt with (1) M10 Large Flat Washer and (1) M10 Nylon Lock Nut, (**Fig 15**). Do not fully tighten hardware.

After installation of step bar (**Step 11**), level the Step Bar to by adjusting the Brackets in or out. Once the step bar is level, tighten the M10 hardware of the Rear Bracket (**Fig 15**).

(1) M10 Large Flat Washer  
(1) M10 Nylon Lock Nut

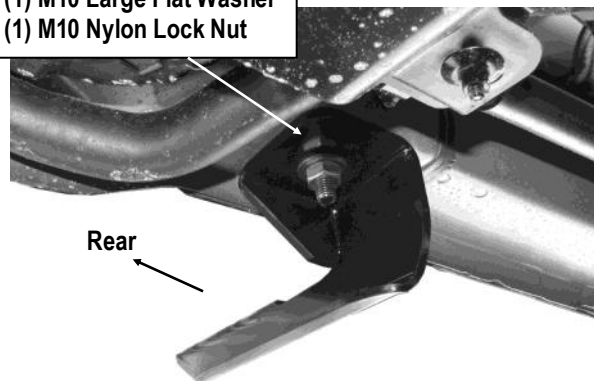

(Fig 15) Driver Rear Mounting Bracket Installation

## STEP 11

Once all (3) Driver side mounting brackets are installed, then proceed to the Step Bar installation. (**Figs 16 & 17**)

- (1) Select (1) Slider and (2) M8X1.25-35mm Carriage Bolts;
- (2) Install (2) M8X1.25-35mm Carriage Bolts in (1) Slider.
- (3) Slide the Slider (with carriage bolts) to the **Step Bar**.
- (4) Repeat to install the other (2) sliders to the step bar.
- (5) Attach the Step Bar (with the Sliders) onto the installed mounting brackets. Position the Sliders to the installed brackets. Secure the Step Bar to the installed Brackets by using (6) M8 Large Flat Washers and (6) M8 Nylon Lock Nuts and (3) Sliders, (**Fig 17**). Do not fully tighten hardware at this time.

**Note:** The Sliders are packed with the Mounting Brackets.

## STEP 12

Next, move to the front Bracket. Tighten the T-Bolt and Bolt Plate hardware only, (**Figs 3A & 4A**). Adjust the height of the front Bracket as necessary. Once properly adjusted, tighten the M10 Hex Bolt securing the Support Bracket to the front Mounting Bracket, (**Fig 6**).

## STEP 13

With the front and rear Brackets fully tightened to the vehicle, move to the Center Bracket, (**Fig 18**).

- a. Fully tighten the M10 Nylon Lock Nut securing the Support Bracket to the Bolt Plate.
- b. Gently push the Mounting Bracket up against and level to the bottom of the Running Board.
- c. Tighten the (2) M8 Hex Bolts.
- d. Slowly tighten the M10X1.5-40 Hex Bolt until the Support Plate is snug against the bottom of the body panel.
- e. Turn the Hex Bolt (2) full turns tighter to add preload. Tighten the M10 Nylon Lock Nut to lock the Bolt in place.



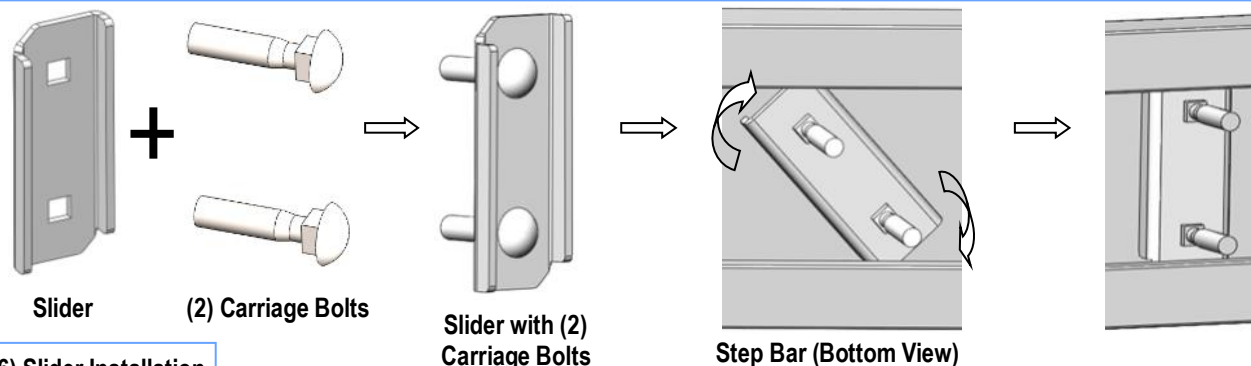

(Fig 16) Slider Installation

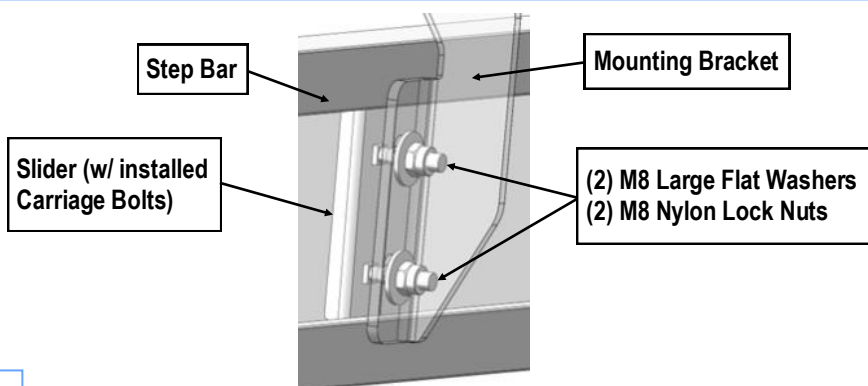

(Fig 17) Step Bar Installation

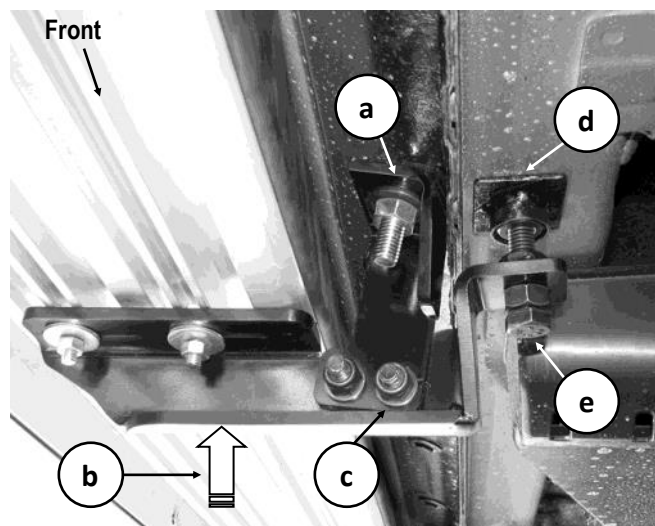

(Fig 18) Driver Side Center Mounting Bracket Adjustment

## STEP 14

Level and adjust the Step and fully tighten all hardware.  
Repeat **Steps 1-13** for other side Step Bar installation. **The installation is completed.**

### Attention

Do periodic inspections to the installation to make sure that all hardware is secure and tight.

In order to protect your bars/boards, please use mild soap/non-abrasive products for cleaning only.