

# iBoard®

## iBoard® by APS

PART#: IB-269

READ INSTRUCTIONS CAREFULLY BEFORE STARTING INSTALLATION. REMOVE CONTENTS FROM BOX AND VERIFY ALL PARTS ARE PRESENT. ASSISTANCE IS RECOMMENDED.

\*BODY FRAME MOUNT

\*DRILLING IS REQUIRED/ CUTTING IS REQUIRED

Fastener Size	Tightening Torque (ft-lbs)	Required
6mm	6-7	√
8mm	16-18	√
10mm	31-32	X
12mm	56-58	X
14mm	92-94	X

### PART LIST

Front

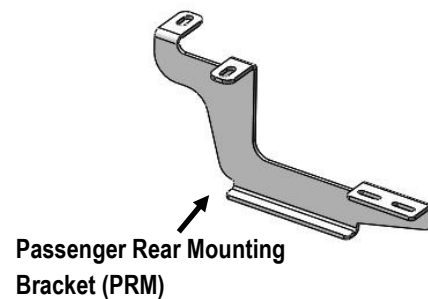
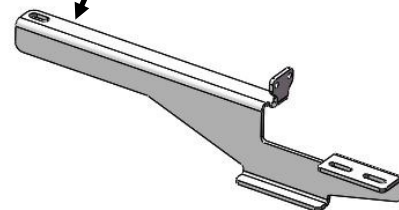
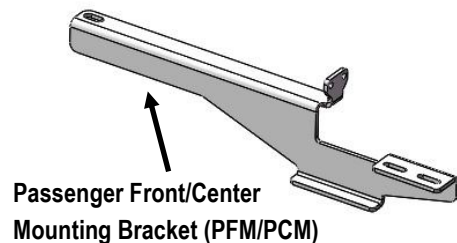
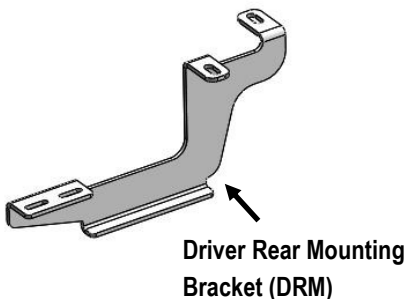
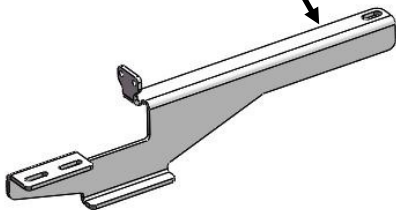
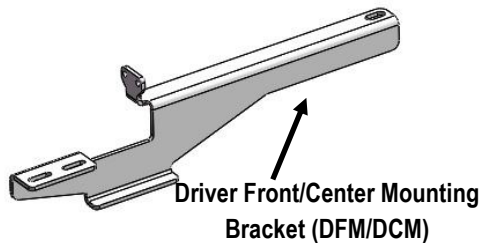

Customer Support: [info@iboardauto.com](mailto:info@iboardauto.com)

# iBoard®

## Hardware Package A (For Bracket Installation)

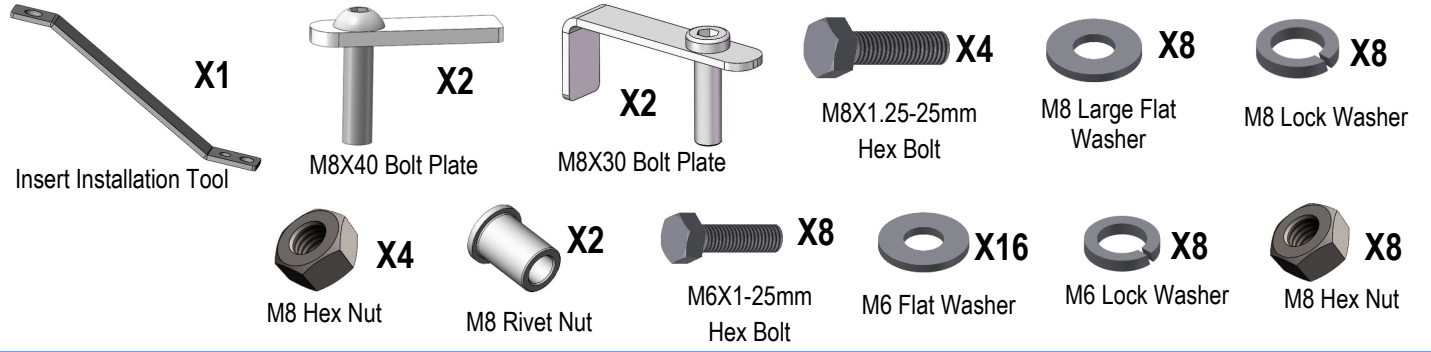

## Hardware Package B (For Aluminum Step Bar Installation Only, Not Supply to Stainless Steel Step Bar)



## Hardware Package C (For Stainless Steel Step Bar Installation Only, Not Supply to Aluminum Step Bar)



### STEP 1

Start installation from the passenger side front of the vehicle. Remove the plastic rocker panel cover running from wheel opening to wheel opening, (Fig 1). **NOTE:** Removal of the rocker panel cover is not mandatory but it is highly recommended.

### STEP 2

Locate the (2) factory hex bolts in the bottom of the inner frame channel, (Fig 2). Remove only the rear hex bolt if equipped, (Fig 2). Do not remove the front hex bolt.

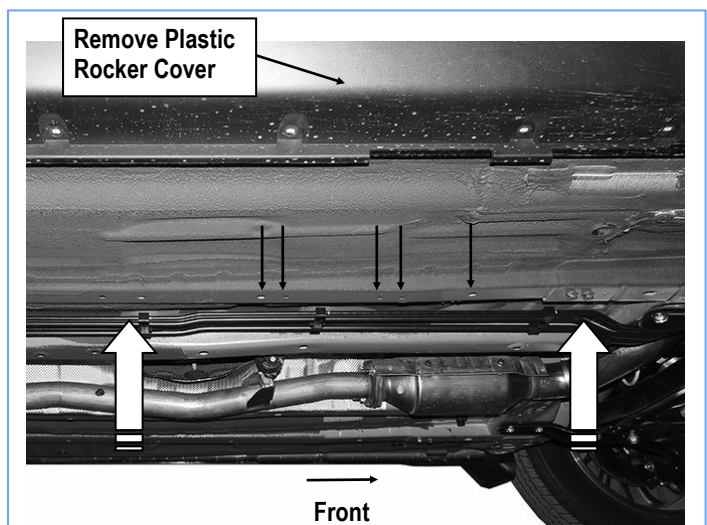

(Fig 1) Passenger Side Front Mounting Location Pictured

# iBoard®

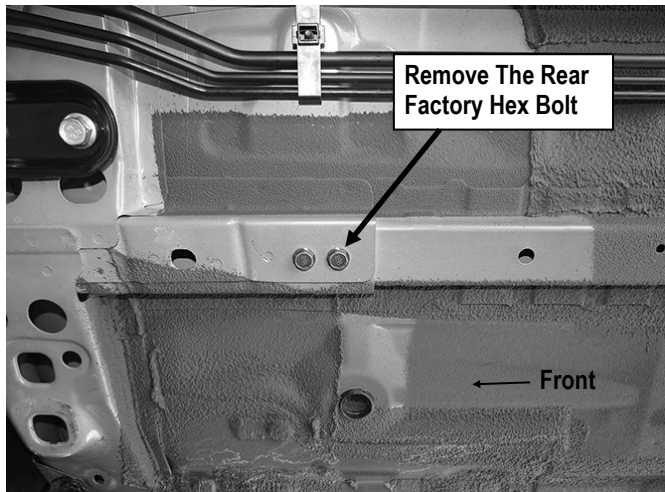

(Fig 2) Passenger Side Front Mounting Location Pictured

## STEP 3

Select (1) Passenger Front Mounting Bracket (**PFM/PCM**).  
**NOTE:** When properly installed, the mounting cradles on all (3) Brackets will point toward the rear of the vehicle.

Attach the inner end of the Bracket to the frame channel with (1) M8X1.25-25mm Hex Bolts, (1) M8 Lock Washer and (1) M8 Large Flat Washer, (**Fig 3**). Do not fully tighten hardware at this time. Line up the tab on the Bracket with the outside of the pinch weld. Use a clamp to temporarily attach the tab on the Bracket to the pinch weld.

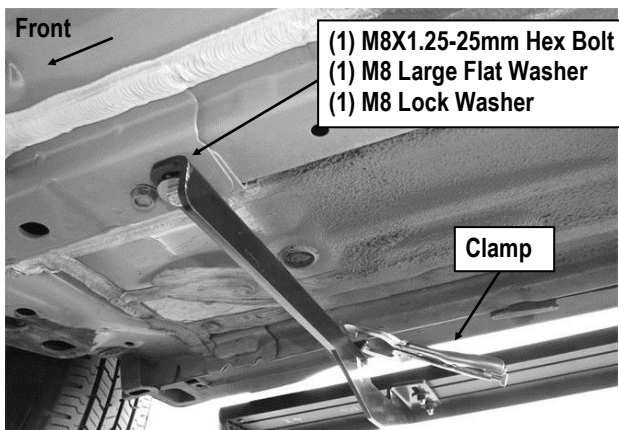

(Fig 3) Passenger Front Mounting Bracket Installation

## STEP 4

Move to the rear of the vehicle. Locate the factory holes in the bottom of the floor panel behind the jack point on the pinch weld directly in front of the rear suspension mount, (**Fig 4**). Select (1) M8X40 Bolt Plate, (**Fig 5A**). Insert the M8X40 Bolt Plate into the round hole in the inner floor panel, (**Fig 5**). Select (1) M8X30 Bolt Plate, (**Fig 5B**). Insert the M8X40 Bolt Plate into the oval hole. Feed the threaded end of the M8X30 Bolt Plate into and out of the smaller outer hole, (**Fig 5**). **NOTE:** Hold the passenger side Rear Bracket up in place to help determine the correct mounting holes for the Bracket.

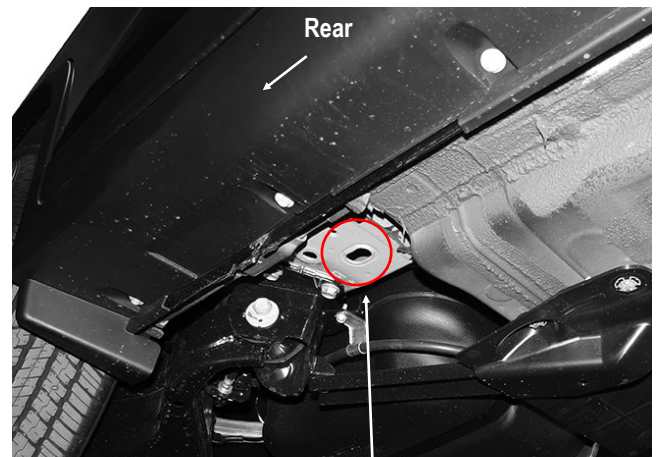

(Fig 4) Passenger Side Rear Mounting Location Pictured

## STEP 5

Select the Passenger Rear Mounting Bracket (**PRM**). Attach the Bracket to the (2) Installed Bolt Plates with (2) M8 Large Flat Washers, (2) M8 Lock Washers and (2) M8 Hex Nuts, (**Fig 6**). Do not fully tighten hardware at this time.

# iBoard®

## STEP 7

### Aluminum Step Bar Installation:

Select a **Aluminum Step Bar**. Slip (3) M6x1-20mm Square Head Bolts into each bottom channel (**Fig 7**). Carefully position the Step Bar onto the (3) Mounting Brackets.

**IMPORTANT:** Do not slide the Step Bar on the Brackets or the bottom surface of the board will be damaged. Attach the Step Bar to each Mounting Brackets with (2) M6x1-20mm Square Head Bolts, (2) M6 Large Flat Washers and (2) M6 Nylon Lock Nuts, (**Fig 8**). Do not fully tighten at this time.

Level and adjust the Step Bar and fully tighten all hardware.

Repeat **Steps 1-7** for the other side Step Bar installation.

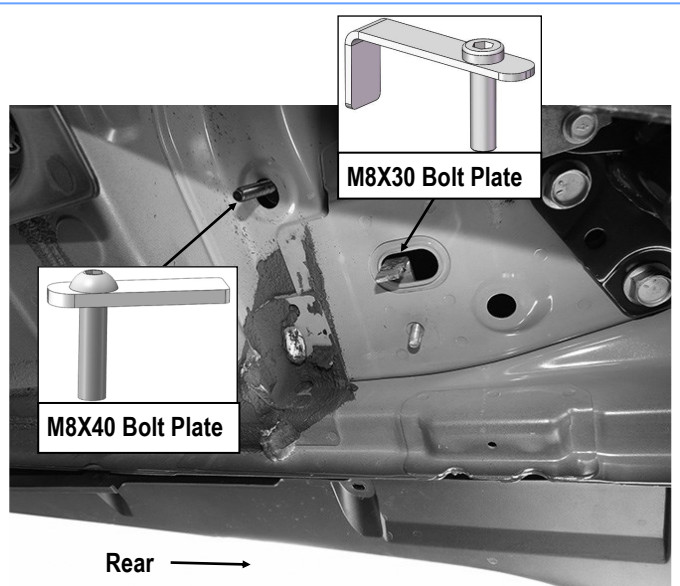

(Fig 5) Insert M8X40 Bolt Plate & M8X30 Bolt Plate

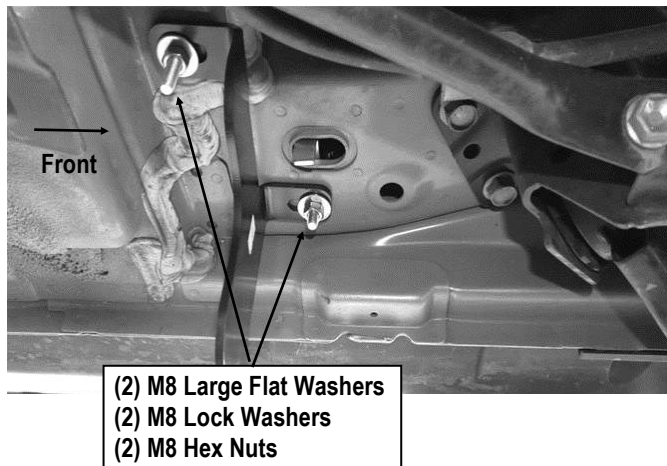

(Fig 6) Passenger Rear Mounting Bracket Installation

## STEP 6

Once all (3) mounting brackets are installed, then proceed to the Step Bar installation. According to the style of Step Bar proceed to the correct installation STEPS.

**Note:** Aluminum Step Bar refer to STEP 6; Stainless Steel Step Bar skip to STEP 7.



(Fig 7) Slip M6X1-20mm Square Head Bolts Into The Bottom Channels

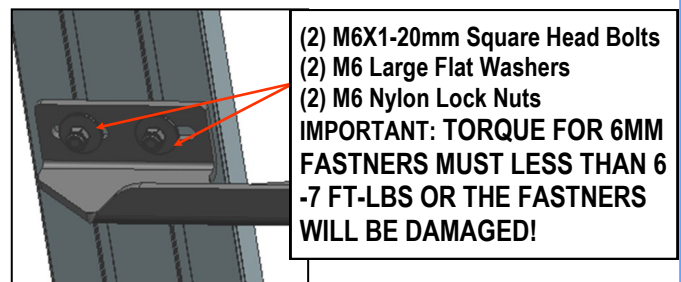

(Fig 8) Running Board Installed Onto Mounting Bracket

# iBoard®

## STEP 8

### Stainless Steel Step Bar Installation:

Select a **Stainless Steel Step Bar** (with the U-Sliders installed on the Bar). Loosen the U-Sliders, reposition the U-Sliders onto the board according to the (3) Installed Mounting Brackets location, (**Fig 9**). Re-secure the U-Sliders on the Step Bar. Attach the Step Bar to the installed Mounting Brackets with (6) M6X1-20mm Hex Bolts, (6) M6 Large Flat Washers & (6) M6 Lock Washers, (**Fig 10**). Do not fully tighten hardware at this time.

Level and adjust the Step Bar and fully tighten all hardware. Repeat **Steps 1-6 and 8** for the other side Step Bar installation.



(Fig 9) Slide & line up the U-Slider with the installed mounting brackets along bottom channel

(2) M6X1-20mm Hex Bolts  
(2) M6 Large Flat Washers  
(2) M6 Lock Washers  
**IMPORTANT: TORQUE FOR 6MM FASTENERS MUST BE LESS THAN 6-7 FT-LBS OR THE FASTENERS WILL BE DAMAGED!**

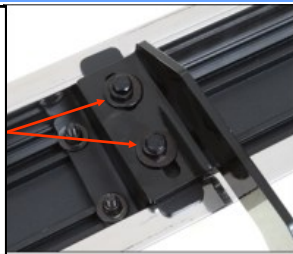

(Fig 10) Step Bar Installed on Bracket Installed (Example)

## STEP 9

Line up the Running Board with the front and rear of the vehicle. Once properly aligned, tighten the hardware and clamp attaching the front and rear mounting Brackets to the vehicle only.

## STEP 10

Move to the center of the vehicle. Locate the holes in the bottom of the inner frame channel, (**Fig 1**). Locate the 6th hole back from the front bracket mounting location. **IMPORTANT:** Mark the correct mounting hole before moving to **Step 11**, (**Fig 11**).

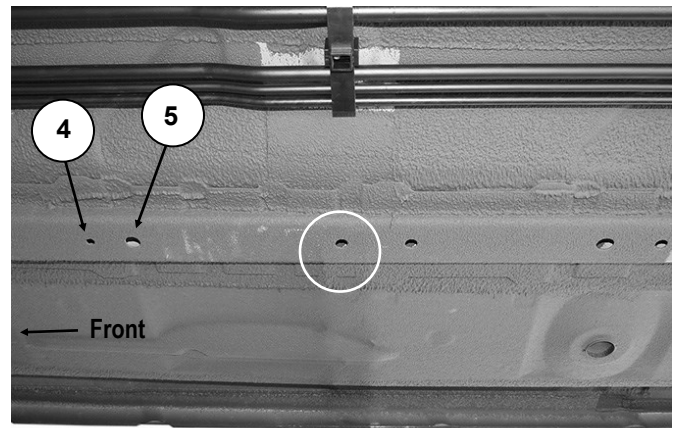

(Fig 11) Passenger Side Center Mounting Location Pictured

## STEP 11

Select (1) M8X1.25-25mm Hex Bolts, (1) M8 Large Flat Washer, (1) Insert Installation Tool and (1) M8 Rivet Nut. Assemble the tool as pictured in (**Fig 12**). **NOTE: Select 8 mm hole on Threaded Insert Tool (Fig 13)**. Hold the Tool assembly and push the threaded Insert into the correct hole in the frame channel identified in **Step 8**, (**Fig 1 & 11**).

**IMPORTANT:** M8 Rivet Nut cannot be removed once installed. Verify that M8 Rivet Nut is in the correct hole in the frame channel before proceeding.

# iBoard®



- (1) M8X1.25-25mm Hex Bolt
- (1) M8 Large Flat Washer
- (1) Insert Installation Tool
- (1) M8 Rivet Nut

Fig 12



Fig 13

## STEP 12

Hold the Insert in place by firmly grasping the handle on the Tool. Turn the M8 Hex Bolt, (tighten), with wrench to expand the Insert in the hole in the frame channel, (Fig 14). Once the Insert is fully compressed/ expanded, remove the Hex Bolt and Tool from the Insert. **WARNING:** Do not over-tighten the Insert or damage to the part or Insert may result.

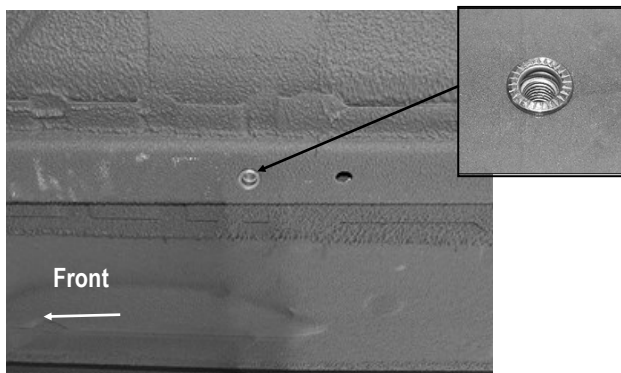

Fig 14

## STEP 13

Select (1) Passenger Center Mounting Bracket (PFM/PCM). Bolt the inner end of the center Bracket to the M8 Rivet Nut with (1) M8X1.25-25mm Hex Bolts, (1) M8 Lock Washer and (1) M8 Large Flat Washer, (Fig 15). Do not fully tighten hardware at this time.

Use a clamp to temporarily attach the outer end of the Bracket to the pinch weld to help hold up the Bracket as described in Step 3, (Fig 15).

- (1) M8X1.25-25mm Hex Bolt
- (1) M8 Large Flat Washer
- (1) M8 Lock Washer

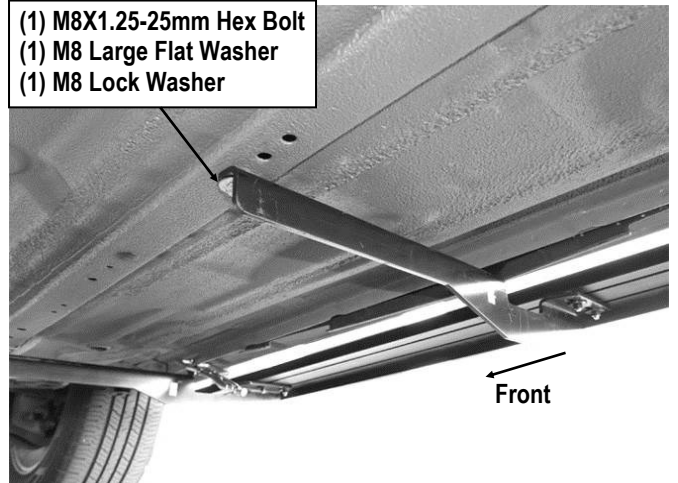

(Fig 15) Passenger Center Mounting Bracket Installation

## STEP 14

Level and adjust the Running Board to the vehicle.

Once properly adjusted, mark the location of the front, (Fig 16), and center, (Fig 17), mounting tabs onto the outside of the pinch weld.

**IMPORTANT:** Adjust the Running Board height, (push upward), so that when level, the holes in the mounting tabs are not too close to the bottom edge of the pinch weld.

# iBoard®

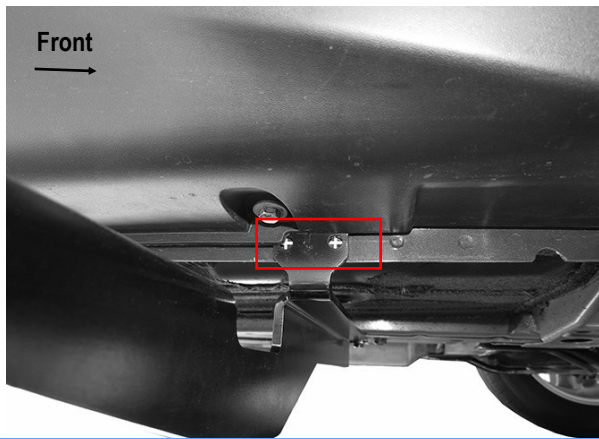

(Fig 16) Passenger Front Bracket Location Marked Before Drilling

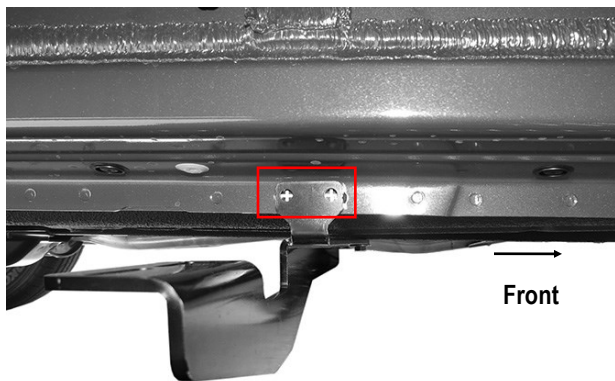

(Fig 17) Passenger Center Bracket Location Marked Before Drilling (Rocker Panel Cover Removed)

## STEP 15

Remove the Running Board and loosen or remove the Passenger Front & Center Mounting Brackets (**PFM/PCM**). Use a 1/4" drill bit to drill out the (4) holes in the pinch weld for the Passenger Front & Center Mounting Brackets (**PFM/PCM**).

**IMPORTANT!** Any cutting or drilling tool may break or shatter. Government regulations require safety glasses & equipment at all times when cutting or drilling.

## STEP 16

Reinstall the Passenger Front Mounting Bracket (**PFM/PCM**) as previously described. Attach the outer end of the Bracket to the outside of the pinch weld with (2) M6X1-25mm Hex Bolts, (4) M6 Flat Washers, (2) M6 Lock Washers and (2) M6 Hex Nuts, (**Fig 18**). Do not fully tighten hardware at this time.

Repeat to reinstall the Passenger Center Mounting Bracket (**PFM/PCM**), (**Fig 19**).

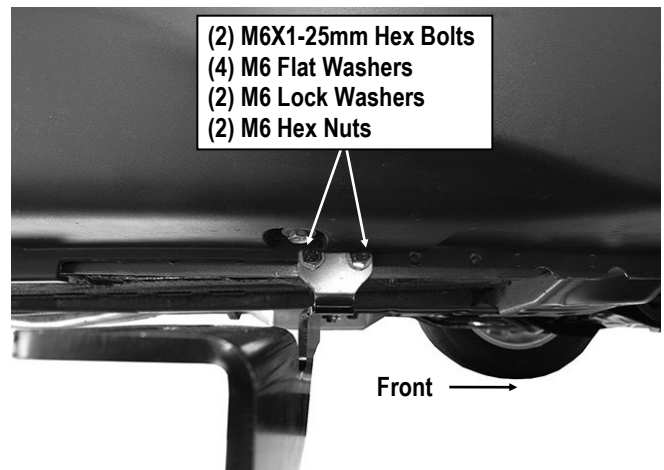

(Fig 18) Passenger Front Mounting Bracket Installation

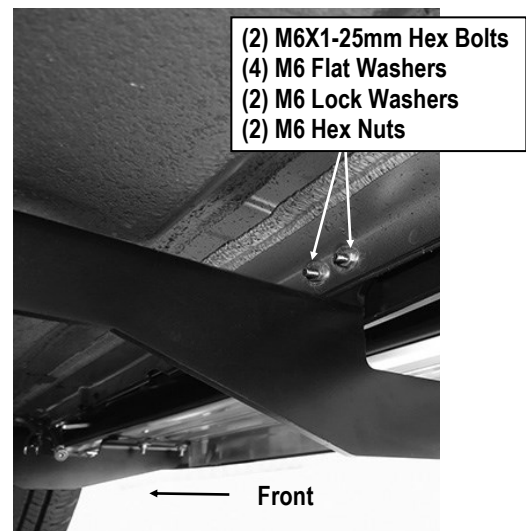

(Fig 19) Passenger Center Mounting Bracket Installation

# iBoard®

## STEP 17

Hold the plastic rocker panel cover up in position over the mounting tabs on the front and center Brackets, **(Fig 20)**. Apply removable tape, (masking tape for example), to the plastic cover. Mark the location of the mounting tabs onto the tape, not the cover. Use a sharp knife or hacksaw blade to carefully cut out a section of the cover to clear each mounting tab. **IMPORTANT:** Trim as little as possible to clear the mounting tab and hardware.

**NOTE:** Primarily, the cover will need to be trimmed to clear the tab on the Passenger Center Mounting Bracket **(PCM)**, **(Fig 20)**. The front of the cover may only need minor trimming to clear the tab, **(Fig 19)**.

Reinstall the rocker cover with the factory hardware once properly cleared.

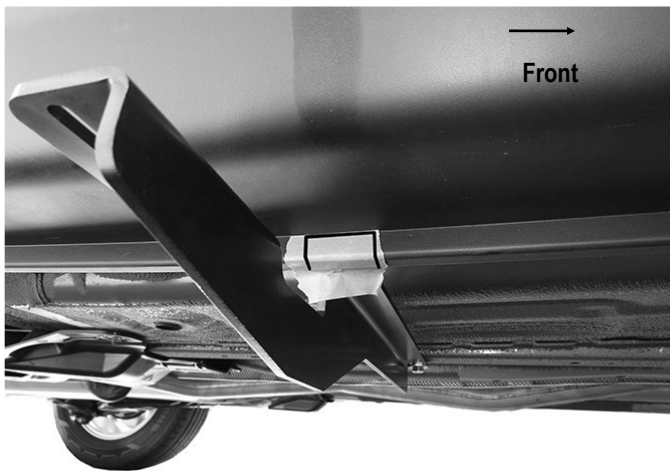

**(Fig 20) Passenger Side Center Bracket Pictured  
(Marks indicating area to cut are for example only)**

## STEP 18

Level and adjust the Running Board and fully tighten all hardware.

## STEP 19

Repeat **Steps 1-19** for other side Running Board installation. The installation is completed.

### Attention

**Do periodic inspections to the installation to make sure that all hardware is secure and tight.**

**In order to protect your bars/boards, please use only mild soap/non-abrasive products for cleaning.**