

# iBoard®

## iBoard® by APS

PART#: IB-339A-B

READ INSTRUCTIONS CAREFULLY BEFORE STARTING INSTALLATION. REMOVE CONTENTS FROM BOX AND VERIFY ALL PARTS ARE PRESENT. ASSISTANCE IS RECOMMENDED.

\*BODY FRAME MOUNT  
\*DRILLING IS REQUIRED

Fastener Size	Tightening Torque (ft-lbs)
6mm	6-7
8mm	16-18
10mm	31-32
12mm	56-58
14mm	92-94

### PART LIST

Front  
↑

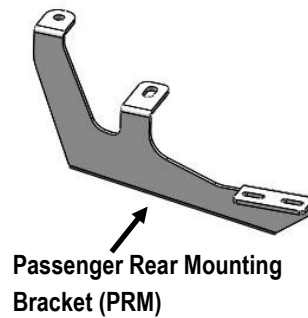
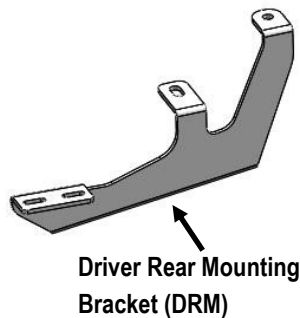
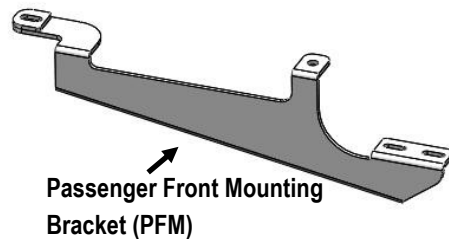
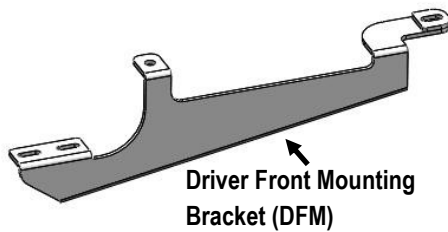

Customer Support: [info@iboardauto.com](mailto:info@iboardauto.com)

# iBoard®

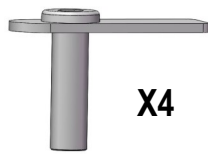

X4

M10X35 Short Bolt Plate

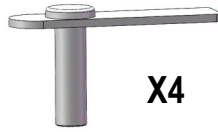

X4

M10X35 Long Bolt Plate



X8

M10 Large Flat Washer



X8

M10 Lock Washer

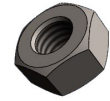

X8

M10 Hex Nut



X8

M6X1-20mm Square Head Bolt



X8

M6 Large Flat Washer



X8

M6X1 Nylon Lock Nut

## STEP 1

Start installation from the passenger side front of the vehicle. Partially remove the front part of the undercover to locate and remove the round rubber plug on the bottom of the inner frame channel. Insert (1) M10x35 Long Bolt Plate into the hole. Insert the threaded bolt through the hole of the undercover, (**Fig 1**).

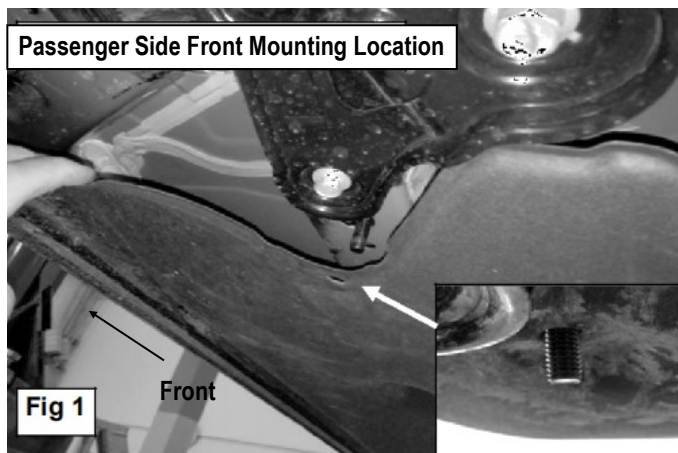

## STEP 2

Remove the plastic round plug located on the outside of the pinch weld. Insert (1) M10X35 Short Bolt Plate into the hole. Attach the Passenger Front Mounting Bracket (**PFM**) to the installed Bolt plates with (2) M10 Large Flat Washers, (2) M10 Lock Washers and (2) M10 Hex Nuts, (**Fig 2**). Do not fully tighten hardware at this time. Reinstall the undercover.

(1) M10X35 Short Bolt Plate  
(1) M10 Large Flat Washer  
(1) M10 Lock Washer  
(1) M10 Hex Nut

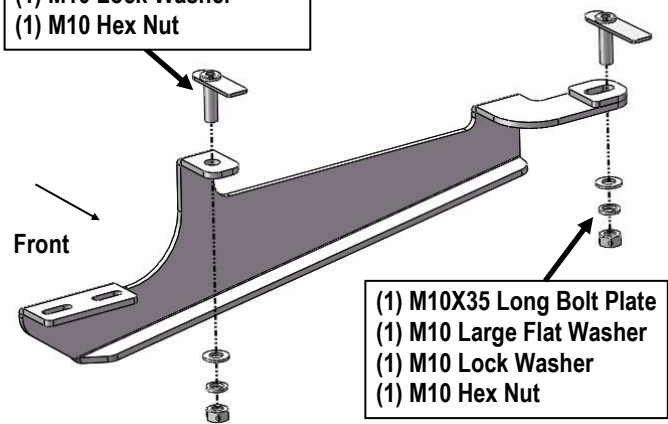

(Fig 2) Passenger Front Mounting Bracket Installation

# iBoard®

## STEP 3

Move to the passenger side rear mounting location of the vehicle. Locate and remove the rubber plug on the mounting location. Insert (1) M10x35 Long Bolt Plate into the hole (**Fig 3**). And attached Passenger Rear Mounting Bracket (**PRM**) to the installed Bolt plate. Use the bracket as template, mark the slot position on the body panel (**Fig 4**).



(Fig 3) Remove Rubber Plug

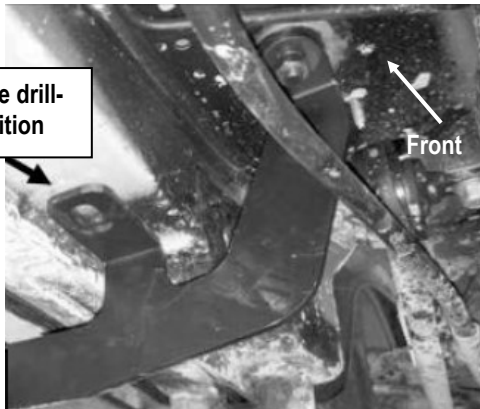

Fig 4

## STEP 4

Remove bracket and drill a 3/16" hole on the body panel according to the mark. Enlarge the hole to 7/8" with a unibit (**Fig 5 & 6**). Suggest to paint the drilled hole with undercoating for anti-rust. And then insert (1) M10x35 Short Bolt Plate into the hole.

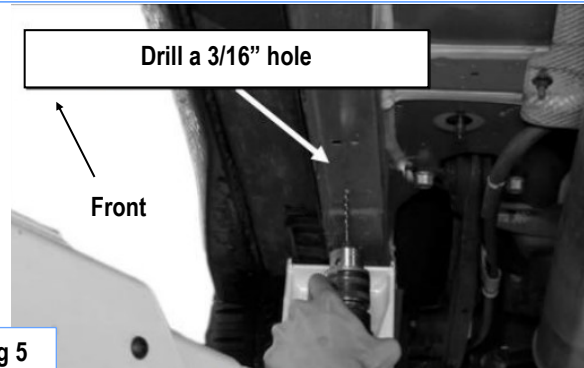

Fig 5

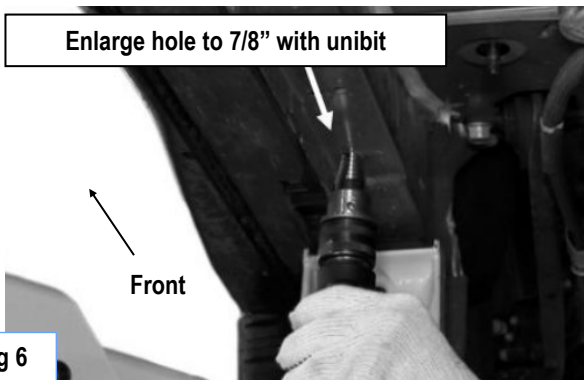
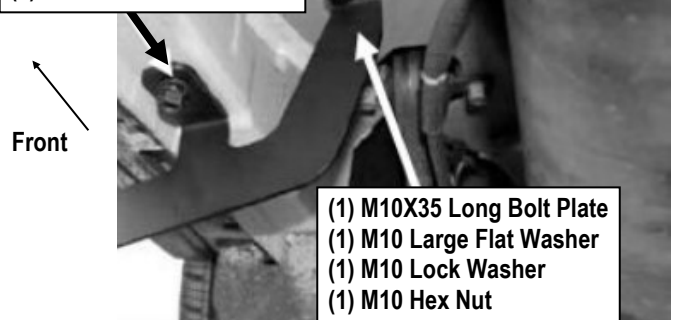

Fig 6

## STEP 5

Attach the Passenger Rear Mounting Bracket (**PRM**) to the installed Bolt plates with (2) M10 Large Flat Washers, (2) M10 Lock Washers and (2) M10 Hex Nuts, (**Fig 7**). Do not fully tighten hardware at this time.

- (1) M10X35 Short Bolt Plate
- (1) M10 Large Flat Washer
- (1) M10 Lock Washer
- (1) M10 Hex Nut



- (1) M10X35 Long Bolt Plate
- (1) M10 Large Flat Washer
- (1) M10 Lock Washer
- (1) M10 Hex Nut

(Fig 7) Passenger Rear Mounting Bracket (PRM) Installation

# iBoard®

## STEP 6

Select a Running Board. Slip (2) M6X1-20mm Square Head Bolts into each bottom channel (**Fig 8**). Carefully position the Running Board onto the (2) Mounting Brackets.

**IMPORTANT:** Do not slide the Running Board on the Brackets or the bottom surface of the board will be damaged. Attach the Running Board to each Mounting Bracket with (2) M6x1-20mm Square Head Bolts, (2) M6 Large Flat Washers and (2) M6 X1 Nylon Lock Nuts (**Fig 9**). Do not fully tighten at this time.



(Fig 8) Slip M6X1-20mm Square Head Bolts Into The Bottom Channels

(2) M6X1-20mm Square Head Bolts  
(2) M6 Large Flat Washers  
(2) M6X1 Nylon Lock Nuts

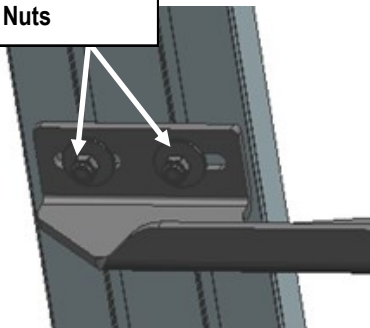

(Fig 9) Running Board Installed Onto the Mounting Bracket

## STEP 7

Level and adjust the Running Board and fully tighten all hardware.

## STEP 8

Repeat **Steps 1-7** for other side Running Board installation. The installation is completed (**Fig 10**).



(Fig 10) Installation Completed

### Attention

Do periodic inspections to the installation to make sure that all hardware is secure and tight.

In order to protect your bars/boards, please use only mild soap/non-abrasive products for cleaning.