

# iBoard®

## iBoard® by APS

PART#: IB-R116

READ INSTRUCTIONS CAREFULLY BEFORE STARTING INSTALLATION. REMOVE CONTENTS FROM BOX AND VERIFY ALL PARTS ARE PRESENT. ASSISTANCE IS RECOMMENDED.

\*ROCKER PANEL MOUNT  
\*NO DRILLING REQUIRED

Fastener Size	Tightening Torque (ft-lbs)	Required
6mm	6-7	√
8mm	16-18	√
10mm	31-32	X
12mm	56-58	X
14mm	92-94	X

### PART LIST

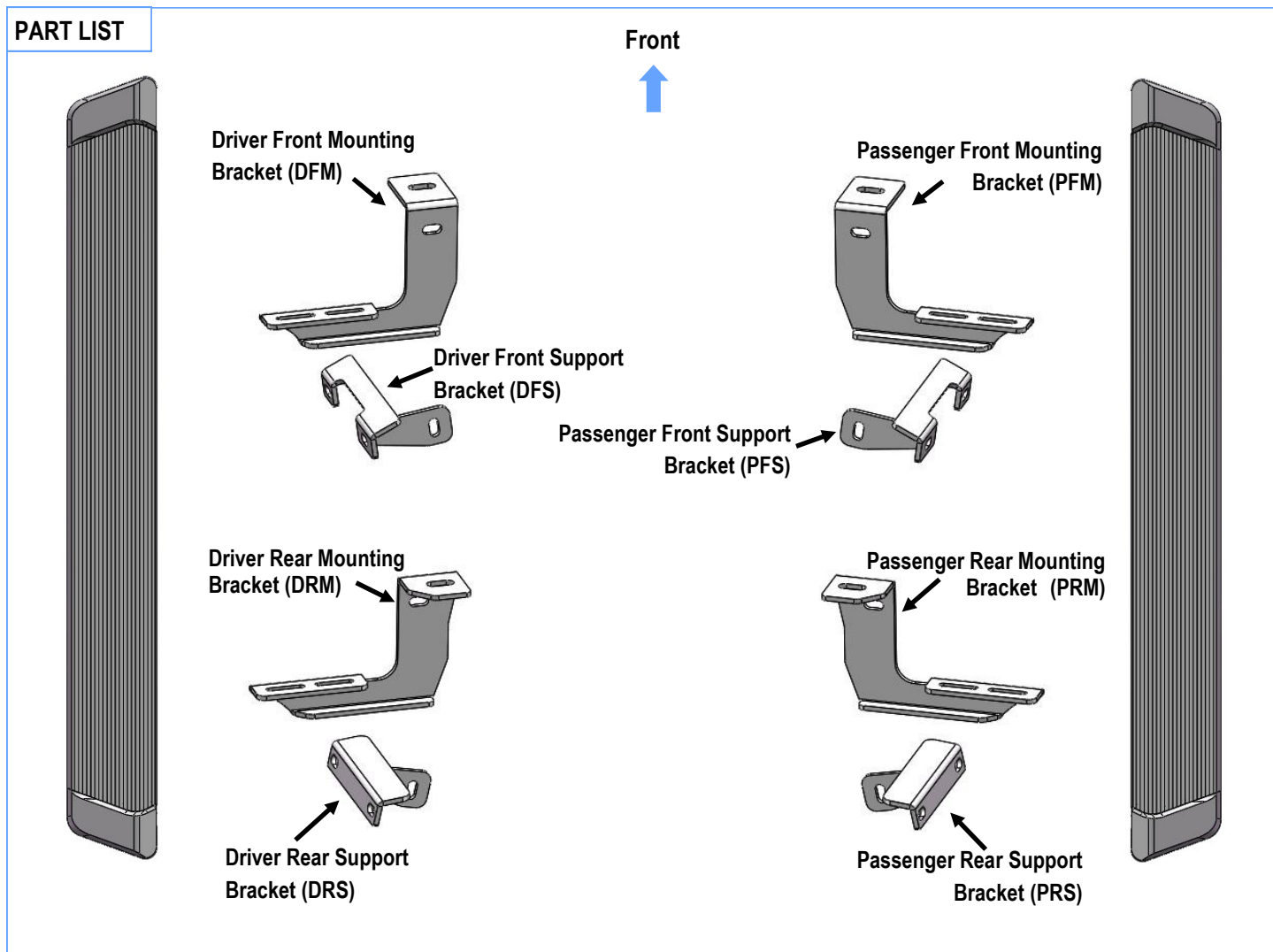

Customer Support: [info@iboardauto.com](mailto:info@iboardauto.com)

# iBoard®



## STEP 1

Start installation from the passenger side front of the vehicle. Assemble the Passenger Front Mounting Bracket (PFM) and Passenger Front Support Bracket (PFS) as shown, (Fig 1). Do not fully tighten hardware at this time.

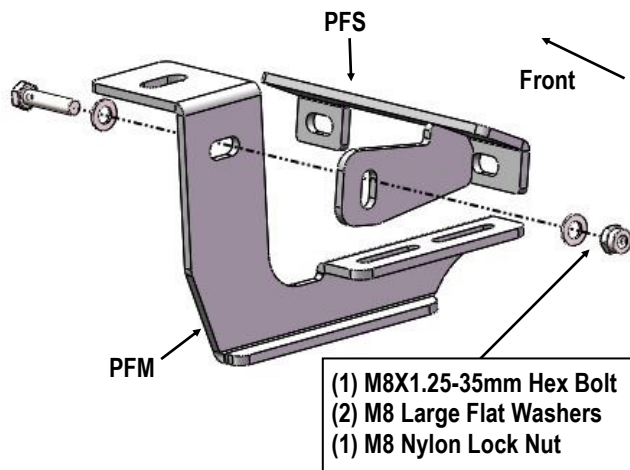

(Fig 1) Passenger Front Mounting Bracket Assembly

## STEP 2

Locate the Passenger Side Front Mounting position on vehicle, there are (2) holes on the pinch weld and (1) threaded hole on the bottom floor, (Fig 2).

Factory Threaded Hole

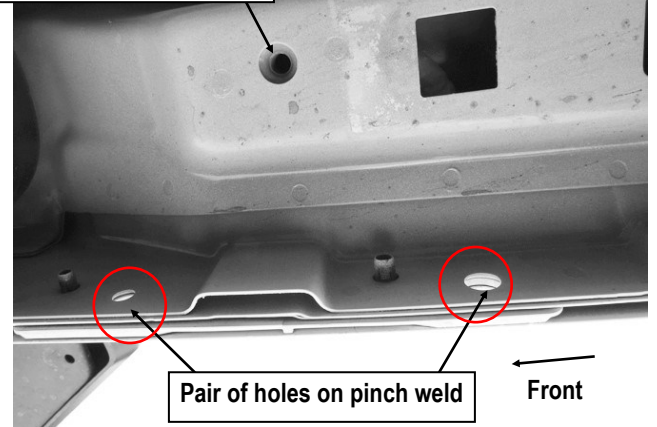

(Fig 2) Passenger Side Front Mounting Location

## STEP 3

Attach the Assembled Passenger Front Mounting Bracket on the mounting position. Attach the Passenger Front Mounting Bracket (PFM) on the factory threaded hole with (1) M8X1.25-35mm Hex Bolt, (1) M8 Large Flat Washer and (1) M8 Lock Washer. Install Passenger Front Support Bracket (PFS) on the pinch weld with (2) M6X1-25mm Hex Bolts, (4) M6 Large Flat Washers, and (2) M6 Nylon Lock Nuts, (Fig 3). Do not fully tighten hardware at this time.

# iBoard®

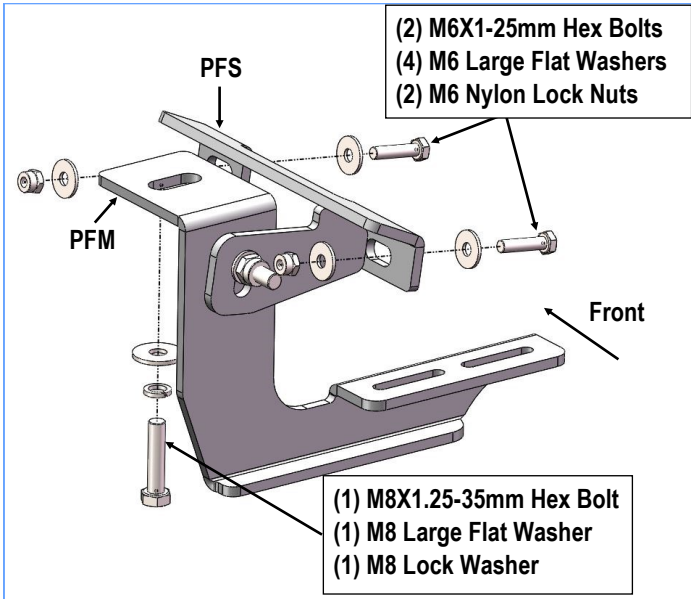

(Fig 3) Passenger Front Mounting Bracket Installed

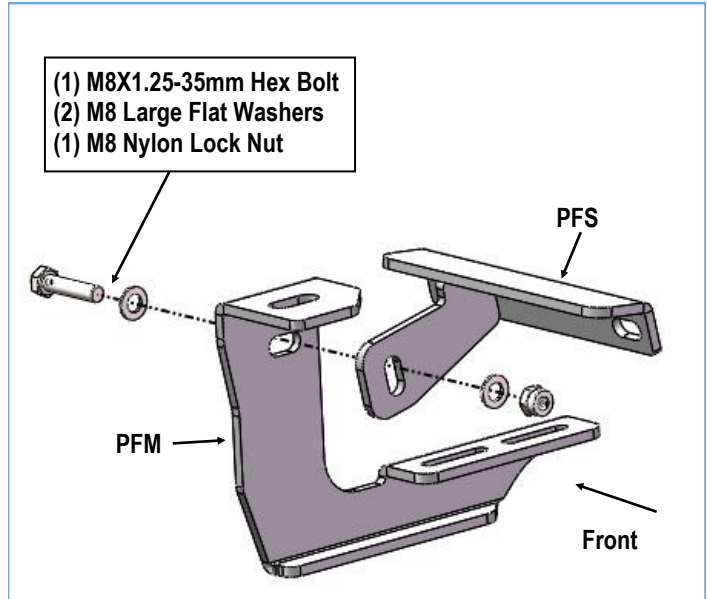

(Fig 5) Passenger Rear Mounting Bracket Installed

## STEP 4

Move to the rear of the vehicle, (Fig 4). Repeat Steps 1-3 to assemble and install the Passenger Rear Mounting Bracket (PRM) and Passenger Rear Support Brackets (PRS), (Figs 5 & 6). Do not fully tighten hardware at this time.

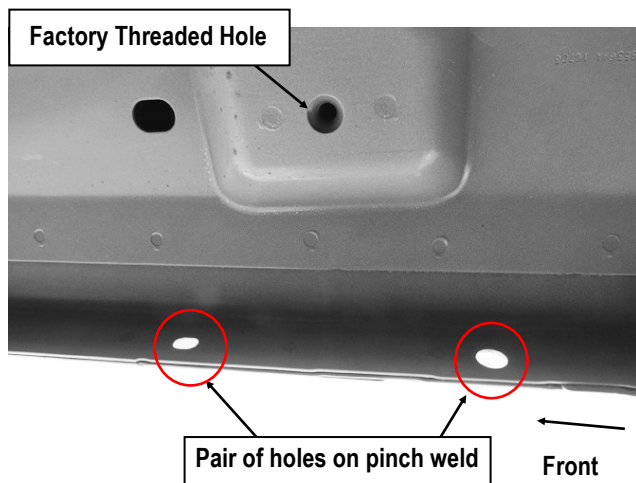

(Fig 4) Passenger Side Rear Mounting Location

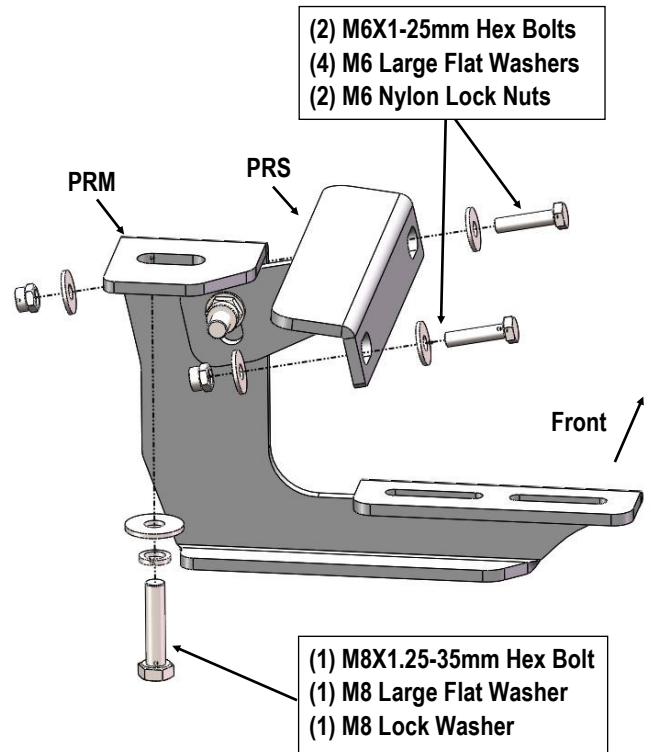

(Fig 6) Passenger Rear Mounting Bracket Installed

# iBoard®

## STEP 5

Select a Running Board. Slip (2) M6x1-20mm Square Head Bolts into each bottom channel (**Fig 7**). Carefully position the Running Board onto the (2) Mounting Brackets.

**IMPORTANT:** Do not slide the Running Board on the Brackets or the bottom surface of the board will be damaged. Attach the Running Board to each Mounting Bracket with (2) M6x1-20mm Square Head Bolts, (2) M6 Large Flat Washers and (2) M6 Nylon Lock Nuts (**Fig 8**). Do not fully tighten at this time.

M6X1-20mm Square Head Bolts

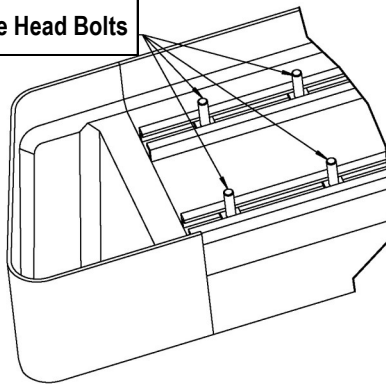

(Fig 7) Slip M6X1-20mm Square Head Bolts Into The Bottom Channels

(2) M6X1-20mm Square Head Bolts  
(2) M6 Large Flat Washers  
(2) M6 Nylon Lock Nuts

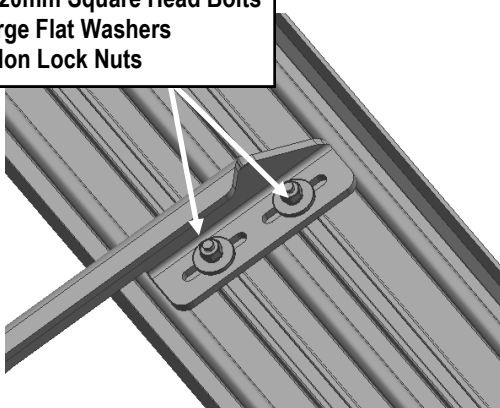

(Fig 8) Running Board Installed Onto Mounting Bracket

## STEP 6

Level and adjust the Running Board and fully tighten all hardware.

**Important:** Please follow the recommended Tightening Torques shown in the table on page 1. Don't over tighten, or the nuts/bolts will be damaged.

## STEP 7

Repeat **Steps 1-6** for the other side Running Board installation. The installation is completed.

### Attention

Do periodic inspections to the installation to make sure that all hardware is secure and tight.

In order to protect your bars/boards, please use only mild soap/non-abrasive products for cleaning.