

# iBoard®

## iBoard® by APS

PART#: IB-R111

READ INSTRUCTIONS CAREFULLY BEFORE STARTING INSTALLATION. REMOVE CONTENTS FROM BOX AND VERIFY ALL PARTS ARE PRESENT. ASSISTANCE IS RECOMMENDED.

\*ROCKER PANEL MOUNT  
\*NO DRILLING REQUIRED

Fastener Size	Tightening Torque (ft-lbs)	Required
6mm	6-7	√
8mm	16-18	√
10mm	31-32	X
12mm	56-58	X
14mm	92-94	X

Item	QTY	Description	Item	QTY	Description
1#	1	Driver Front Mounting Bracket	11#	6	M8X1.25-25mm Hex Bolts
2#	1	Driver Center Mounting Bracket	12#	6	M8X1.25-35mm Hex Bolts
3#	1	Driver Rear Mounting Bracket	13#	18	M8 Large Flat Washers
4#	1	Passenger Front Mounting Bracket	14#	12	M8 Lock Washers
5#	1	Passenger Center Mounting Bracket	15#	6	M8 Hex Nuts
6#	1	Passenger Rear Mounting Bracket	16#	12	M6X1-25mm Hex Bolts
7#	1	Driver Front Support Bracket	17#	12	M6X1-20mm Square Head Bolts
8#	1	Passenger Front Support Bracket	18#	36	M6 Large Flat Washers
9#	2	Driver Center / Rear Support Brackets	19#	24	M6 Nylon Lock Nuts
10#	2	Passenger Center / Rear Support Brackets			

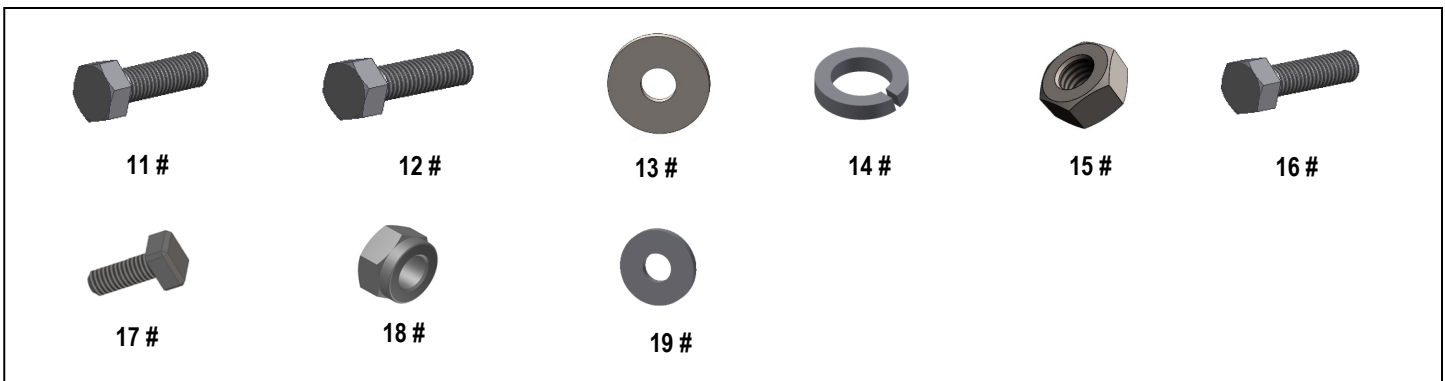

# iBoard®

Driver

Front

Passenger

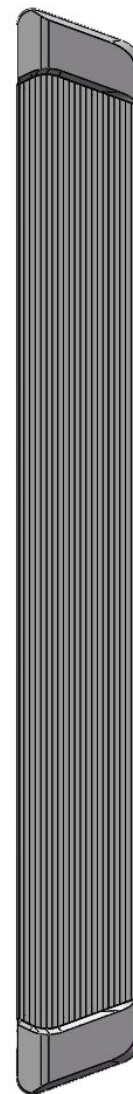
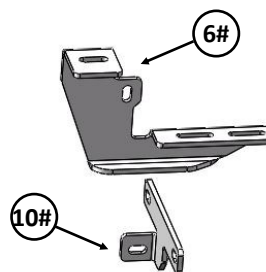
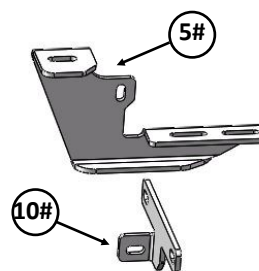
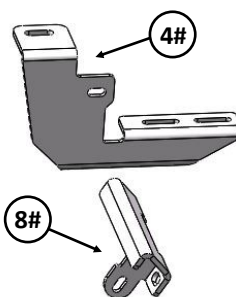
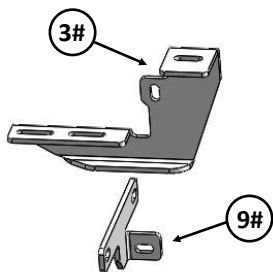
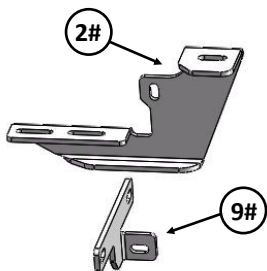
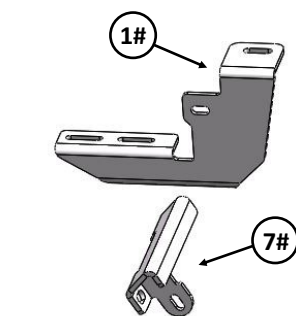
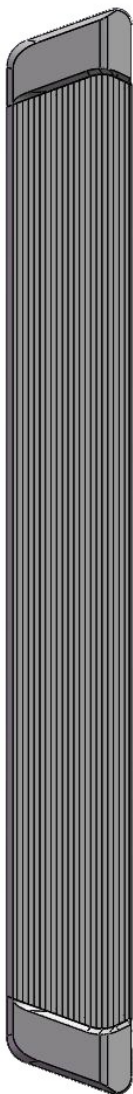

# iBoard®

## STEP 1

Start installation from the Passenger side front of the vehicle. Locate the (3) pairs of factory mounting holes along the pinch weld, (Fig 1).

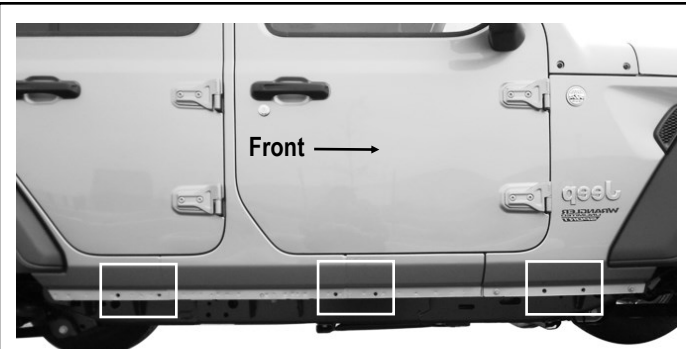

(Fig 1) Passenger Side Front Mounting Location

## STEP 2

Start installation from the passenger side front of the vehicle (Fig 2). Assemble Passenger Front Mounting Bracket and Passenger Front Support Bracket with (1) M8X1.25-25mm Hex Bolt, (2) M8 Large Flat Washers, (1) M8 Lock Washer and (1) M8 Hex Nut (Fig 3). And then install the Passenger Front Brackets to the rocker panel as shown (Figs 4-5). Don't fully tighten the hardware at this time.

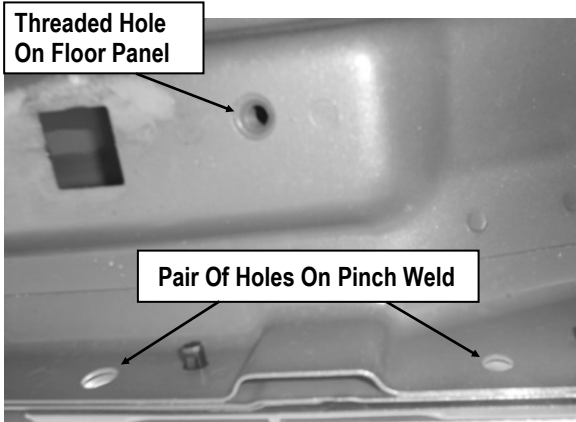

(Fig 2) Passenger Side Front Mounting Location

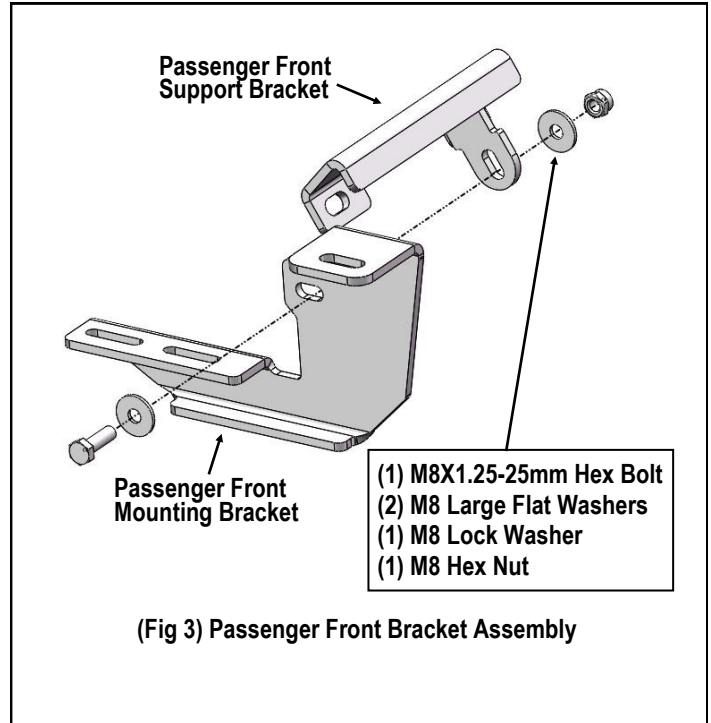

(Fig 3) Passenger Front Bracket Assembly

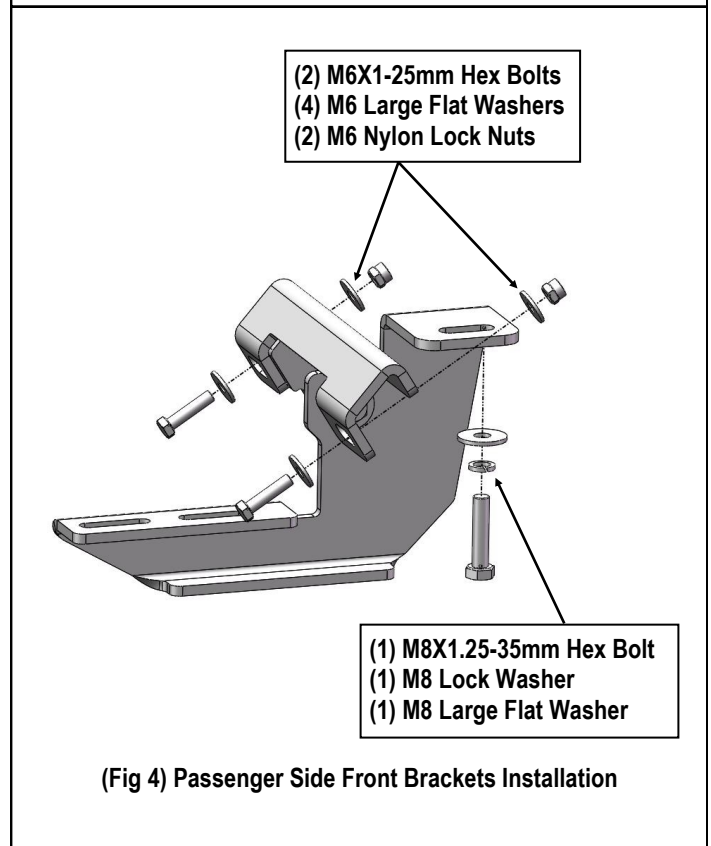

(Fig 4) Passenger Side Front Brackets Installation

# iBoard®

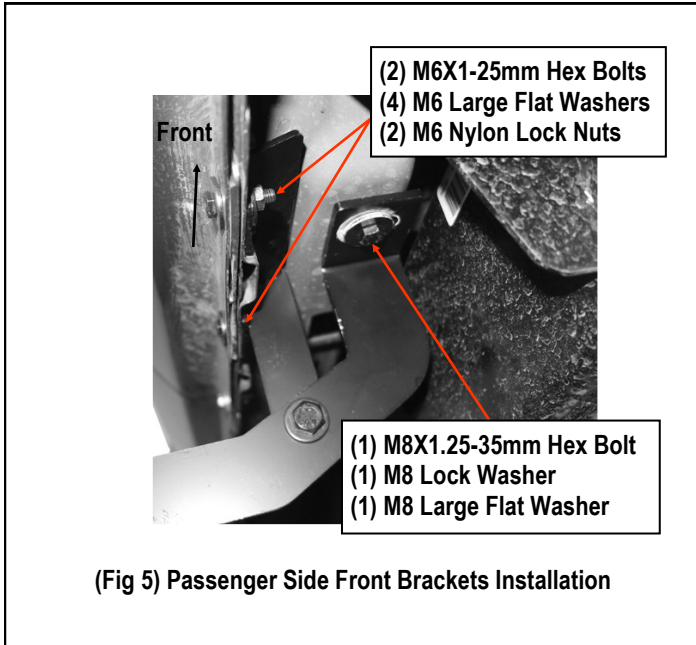

(Fig 5) Passenger Side Front Brackets Installation

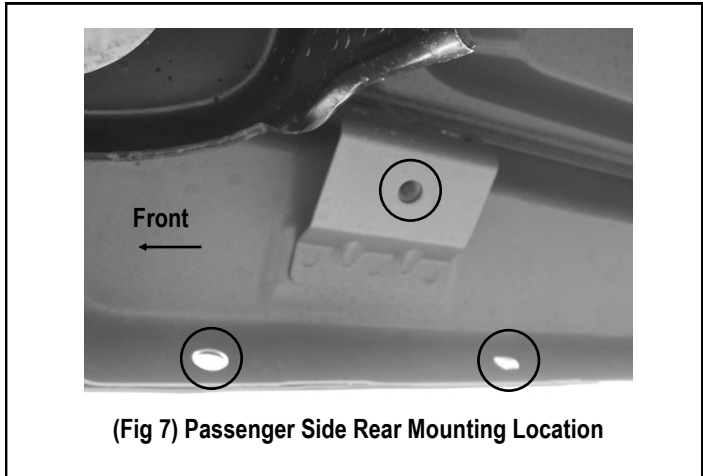

(Fig 7) Passenger Side Rear Mounting Location

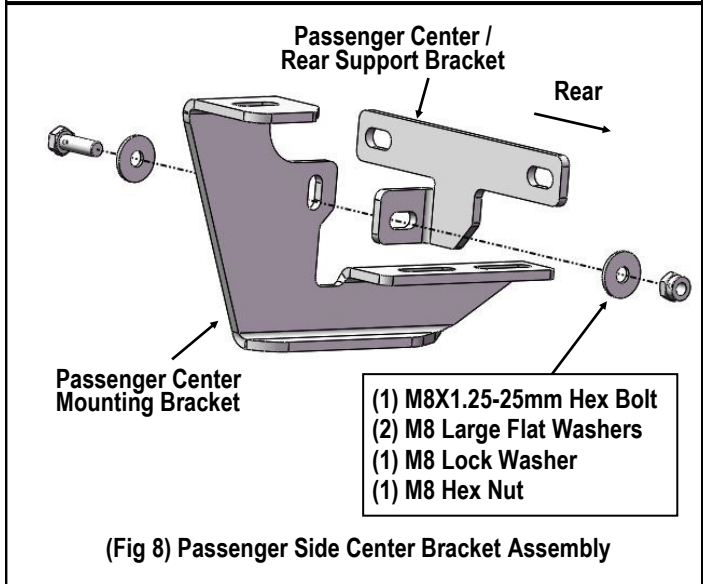

(Fig 8) Passenger Side Center Bracket Assembly

**STEP 3**

Move to Passenger Side Center & Rear Mounting Locations, (Figs 5 & 6). Repeat **Step 2** to install Passenger Center and Rear Brackets (Figs 7-8). Don't fully tighten the hardware at this time.

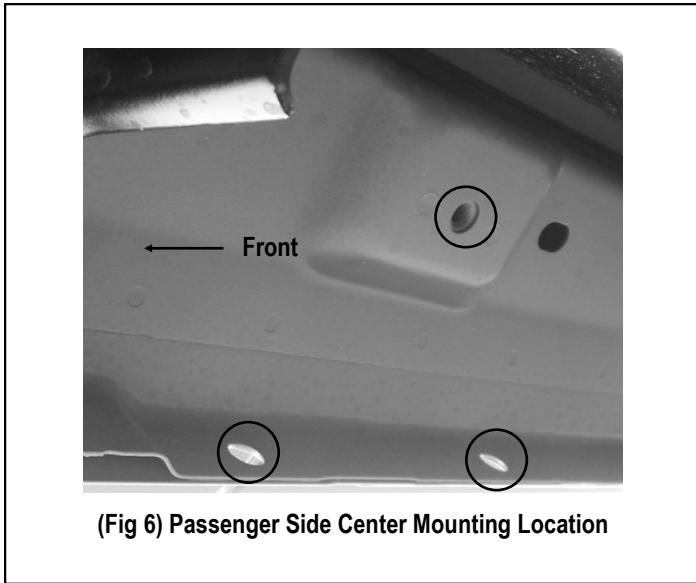

(Fig 6) Passenger Side Center Mounting Location

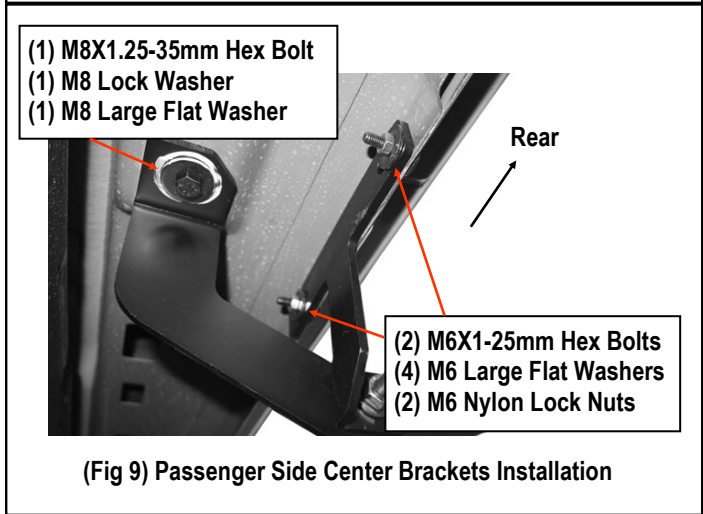

(Fig 9) Passenger Side Center Brackets Installation

# iBoard®

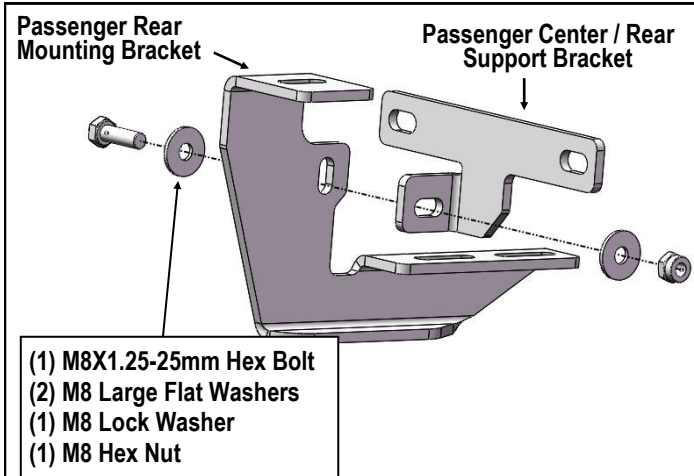

(Fig 10) Passenger Side Rear Brackets Assembly

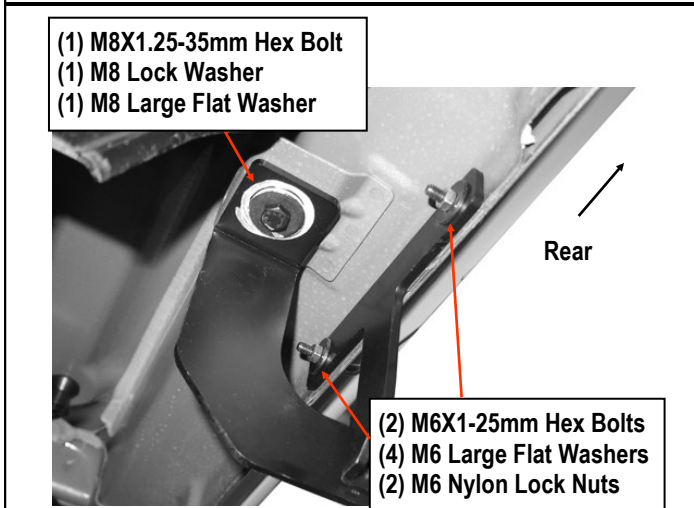

(Fig 11) Passenger Side Rear Brackets Installation

## STEP 4

Select a Running Board. Slip (3) M6x1-20mm Square Head Bolts into each bottom channel (Fig 12). Carefully position the Running Board onto the (3) Mounting Brackets.

**IMPORTANT:** Do not slide the Running Board on the Brackets or the bottom surface of the board will be damaged. Attach the Running Board to each Mounting Bracket with (2) M6x1-20mm Square Head Bolts, (2) M6 Large Flat Washers and (2) M6 Nylon Lock Nuts (Fig 13). Do not fully tighten at this time.

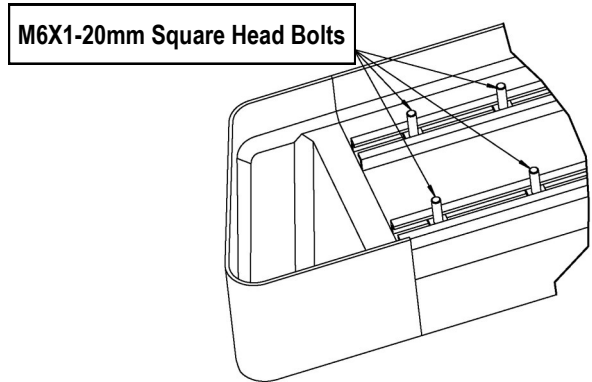

(Fig 12) Slip M6X1-20mm Square Head Bolts Into The Bottom Channels

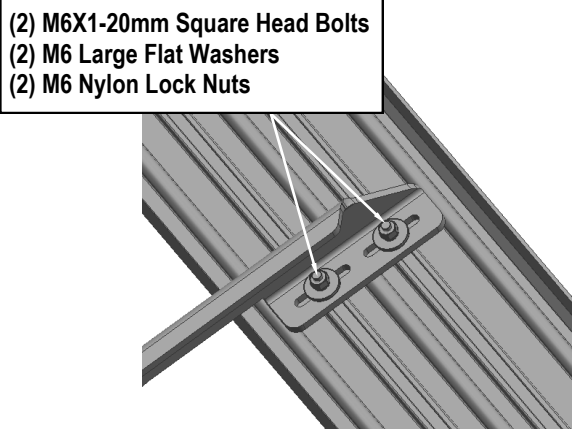

(Fig 13) Running Board Installed Onto Mounting Bracket

## STEP 5

Level and adjust the Running Board and fully tighten all hardware.

**Important:** Please follow the recommended Tightening Torques shown in the table on page 1. Don't over tighten, or the nuts/bolts will be damaged.

# iBoard®

## STEP 6

Repeat **Steps 1-5** for the other side Running Board installation.  
The installation is completed .

### Attention

**Do periodic inspections to the installation to make sure that all hardware is secure and tight.**

**In order to protect your bars/boards, please use only mild soap/non-abrasive products for cleaning.**