

iBoard®

iBoard® by APS

PART#: IB-039A&B

READ INSTRUCTIONS CAREFULLY BEFORE STARTING INSTALLATION. REMOVE CONTENTS FROM BOX AND VERIFY ALL PARTS ARE PRESENT. ASSISTANCE IS RECOMMENDED.

*ROCKER PANEL MOUNT
*NO DRILLING REQUIRED

Fastener Size	Tightening Torque (ft-lbs)
6mm	6-7
8mm	16-18
10mm	31-32
12mm	56-58
14mm	92-94

Item	QTY	Description	Item	QTY	Description
1#	1	Driver Front Mounting Bracket	11#	1	M10 Passenger Double Nut Plate
2#	1	Passenger Front Mounting Bracket	12#	14	M10X1.5-30mm Hex Bolts
3#	1	Driver Rear Mounting Bracket	13#	24	M10 Flat Washers
4#	1	Passenger Rear Mounting Bracket	14#	14	M10 Lock Washers
5#	2	Driver/Passenger Front Bar Brackets	15#	10	M10X1.5 Hex Nuts
6#	1	Driver Front Support Bracket	16#	4	M8X1.25-20mm Inner Hex Bolts
7#	1	Passenger Front Support Bracket	17#	4	M8X1.25 Hex Flange Nuts
8#	1	Driver Rear Support Bracket	18#	8	M6X1-20mm Square Head Bolts
9#	1	Passenger Rear Support Bracket	19#	8	M6 Large Flat Washers
10#	1	M10 Driver Double Nut Plate	20#	8	M6X1 Nylon Lock Nuts

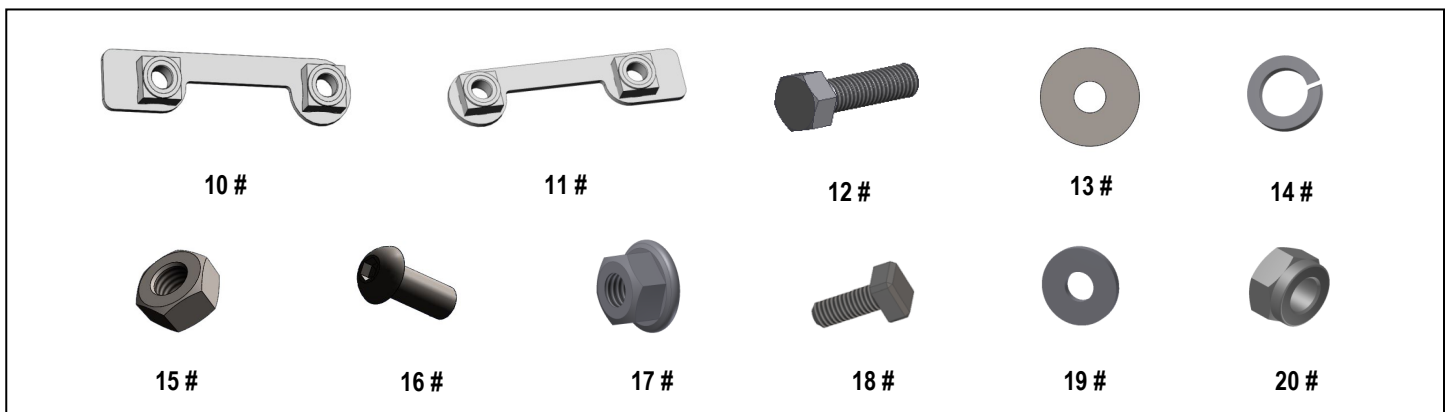

Customer Support: info@iboardauto.com

iBoard®

Driver

Front
↑

Passenger

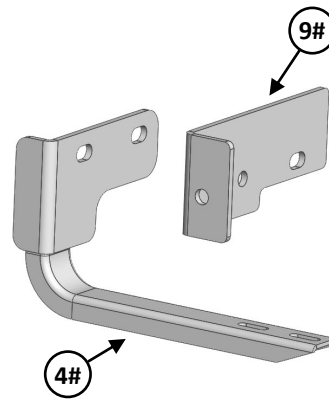
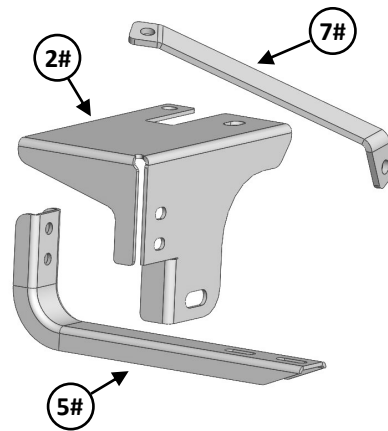
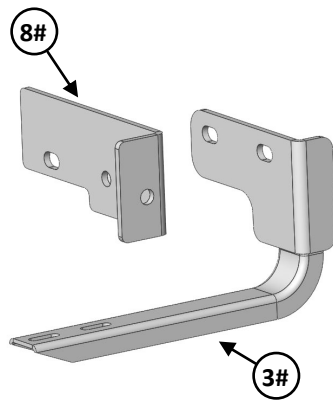
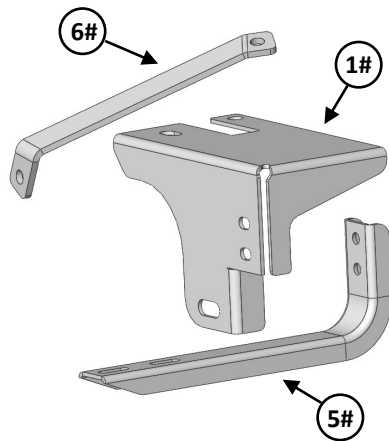
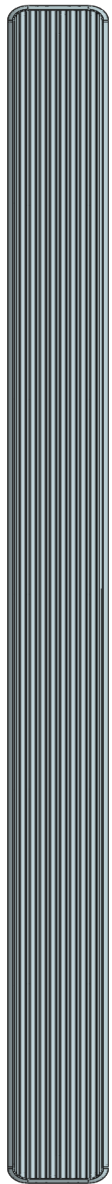

iBoard®

STEP 1

From underside of vehicle, locate the three factory holes (one large, two small) in the driver side cross frame by the front body mount. With the welded nuts facing up, insert the smaller end of the driver side Double Nut Plate through large hole in the frame and orient it to front smaller hole (**Fig 1**).

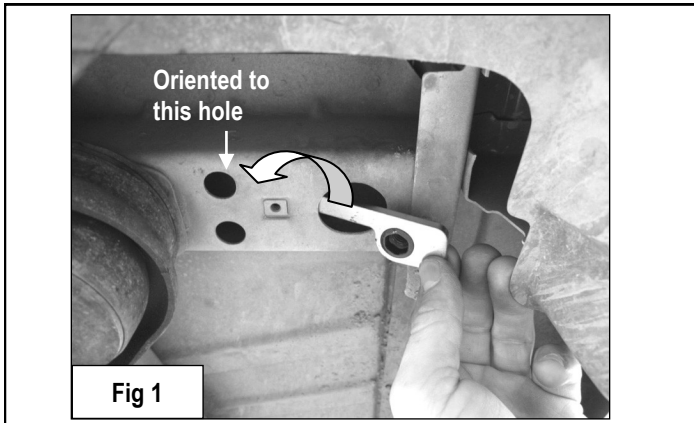

STEP 2

Assemble Driver Front Mounting Bracket and Driver Front Bar Bracket using the included (2) M8X1.25 - 20mm Inner Hex Bolts and (2) M8X1.25 Hex Flange Nuts (**Fig 2**). Partially hang driver side front Mounting Bracket from already inserted Double Nut Plate using the included (2) M10X1.5-30mm Hex Bolts, (2) M10 Lock Washers, and (2) M10 Flat Washers (**Fig 3**). Do not fully tighten at this time.

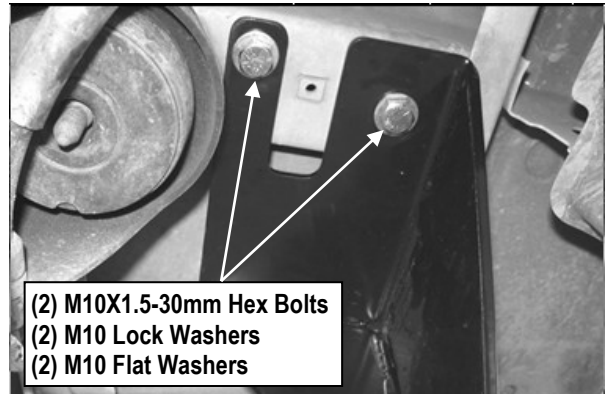
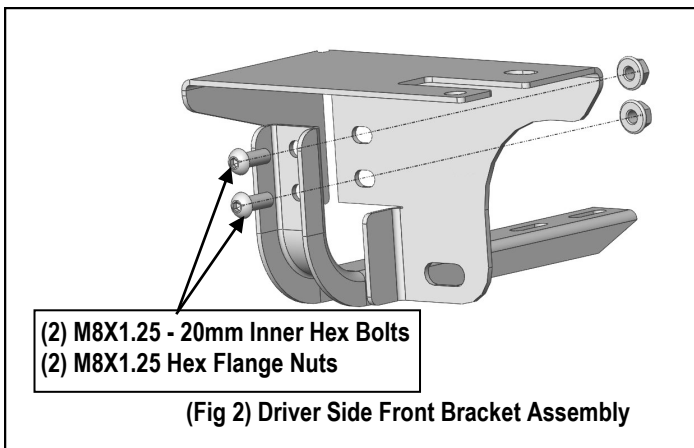

(Fig 3) Driver Side Front Bracket Located

STEP 3

On the rear side of the driver front body mount there is a factory hole in the floor panel located by the frame rail, loosely attach the straight end of the Driver Front Support Bracket to this factory hole using the included (1) M10X1.5-30mm Hex Bolt, (1) M10 Lock Washer, (1) M10X1.5 Hex Nut, and (2) M10 Flat Washers. And attach the angle end of the Driver Front Support Bracket to the Driver Front Mounting Bracket with (1) M10X1.5-30mm Hex Bolt, (1) M10 Lock Washer, (1) M10X1.5 Hex Nut, and (2) M10 Flat Washers, (**Fig 4**). Do not fully tighten at this time.

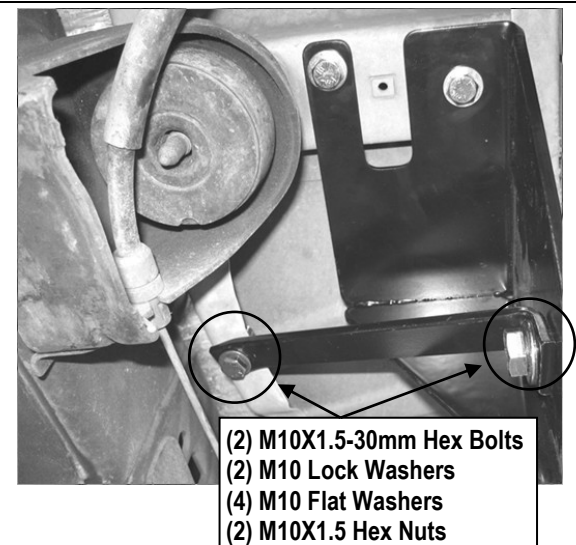

(Fig 4) Passenger Front Mounting Bracket Installation

iBoard®

STEP 4

With the 90° bend towards the rear of the vehicle and facing the side of the vehicle, insert the Driver Rear Support Bracket (**DRS**) through rectangular hole located in the bottom of the body (**Fig 5**). Line up the hole in the 90° bend with factory hole located between the cab and the bed of the vehicle and secure it using the (1) M10X1.5-30mm Hex Bolt, (1) M10 Lock Washer, (1) M10X1.5 Hex Nut, and (2) M10 Flat Washers, (**Fig 6**). Do not fully tighten at this time. **NOTE:** Before tightening make sure that the two holes on the longer side of the Support Bracket lines up with the two factory holes located in the side panel.

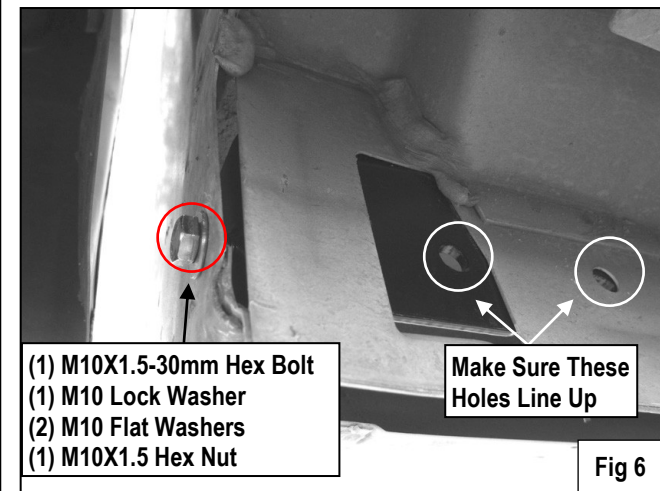
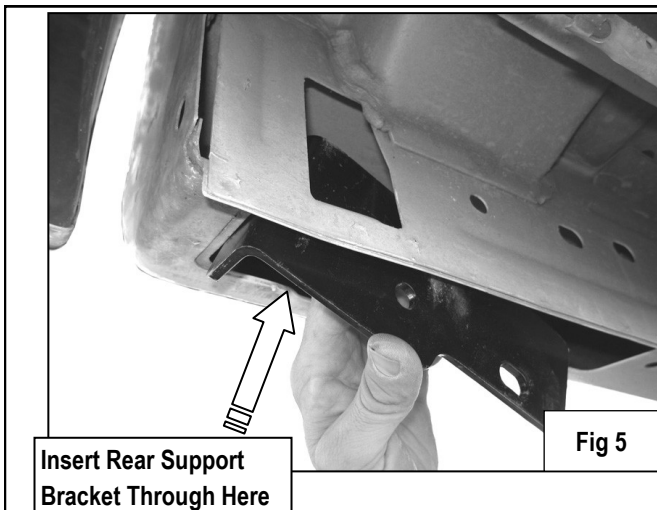

STEP 5

Loosely attach Driver Rear Mounting Bracket to already inserted Driver Rear Support Bracket using the included (1) M10X1.5-30mm Hex Bolt, (1) M10 Lock Washer, (1) M10X1.5 Hex Nut, and (2) M10 Flat Washers, (**Fig 7**). Do not fully tighten at this time.

NOTE: Make sure that the 90° bends on the rear Mounting Bracket are facing the inside of the vehicle when installed.

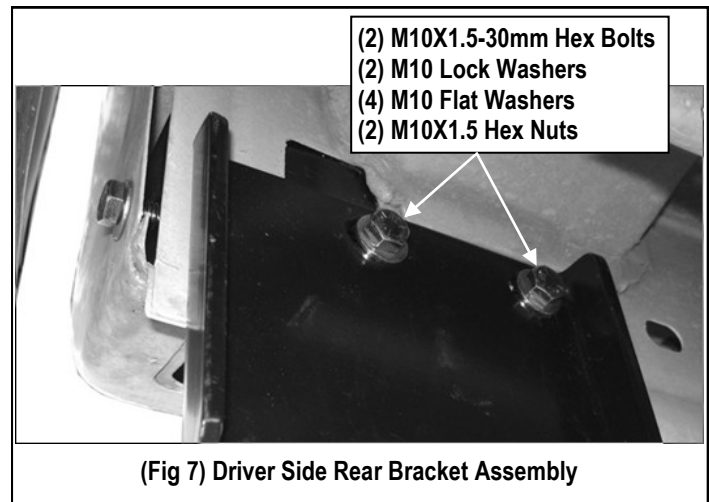

STEP 6

Select a Running Board. Slip (2) M6x1-20mm Square Head Bolts into each bottom channel (**Fig 8**). Carefully position the Running Board onto the (2) Mounting Brackets.

IMPORTANT: Do not slide the Running Board on the Brackets or the bottom surface of the board will be damaged. Attach the Running Board to each Mounting Brackets with (2) M6x1-20mm Square Head Bolts, (2) M6 Large Flat Washers and (2) M6 X1 Nylon Lock Nuts (**Fig 9**). Do not fully tighten at this time.

iBoard®



(Fig 8) Slip M6X1-20mm Square Head Bolts Into The Bottom Channels

- (2) M6X1-20mm Square Head Bolts
- (2) M6 Large Flat Washers
- (2) M6X1 Nylon Lock Nuts

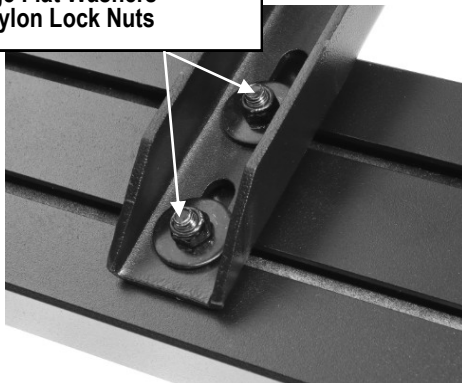

(Fig 9) Running Board Installed Onto Mounting Bracket

STEP 7

Level and adjust the Running Board and fully tighten all hardware.

STEP 8

Repeat **Steps 1-7** for the other side Running Board installation. The installation is completed (**Fig 10**).



(Fig 10) Installation Completed

Attention

Do periodic inspections to the installation to make sure that all hardware is secure and tight.

In order to protect your bars/boards, please use only mild soap/non-abrasive products for cleaning.