

# iBoard®

## iBoard® by APS

PART#: IB-R912

READ INSTRUCTIONS CAREFULLY BEFORE STARTING INSTALLATION. REMOVE CONTENTS FROM BOX AND VERIFY ALL PARTS ARE PRESENT. ASSISTANCE IS RECOMMENDED.

\*ROCKER PANEL MOUNT  
\*NO DRILLING REQUIRED

Fastener Size	Tightening Torque (ft-lbs)	Required
6mm	6-7	√
8mm	16-18	X
10mm	31-32	√
12mm	56-58	X
14mm	92-94	X

Item	QTY	Description	Item	QTY	Description
1#	6	Mounting Brackets	6#	6	M10 Hex Nuts
2#	6	M10X35 Bolt Plates	7#	6	M10 Rivet Nuts
3#	6	M10X1.5-25mm Hex Bolts	8#	12	M6X1-20mm Square Head Bolts
4#	12	M10 Flat Washers	9#	12	M6 Large Flat Washers
5#	12	M10 Lock Washers	10#	12	M6 Nylon Lock Nuts

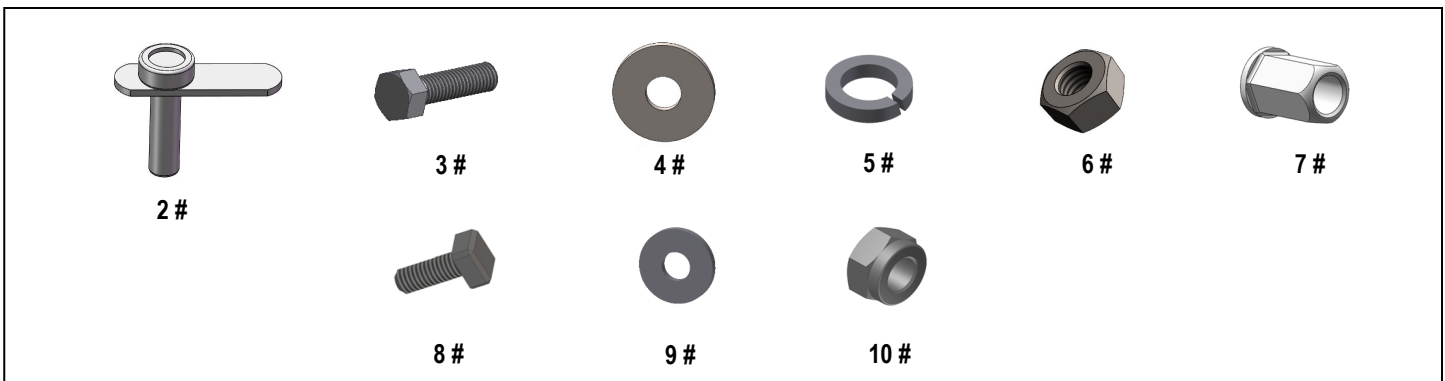

# iBoard®

Driver

Front

Passenger

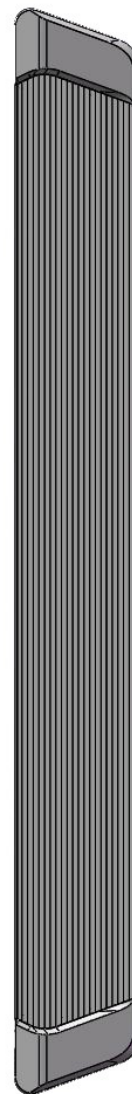
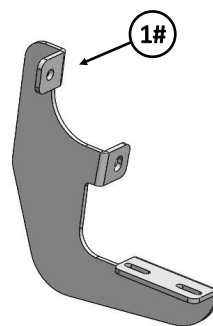
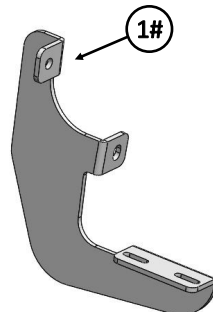
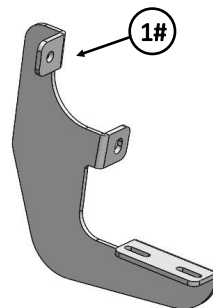
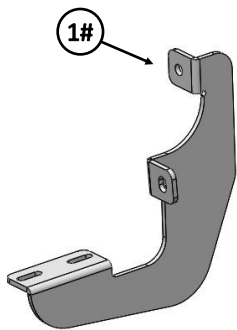
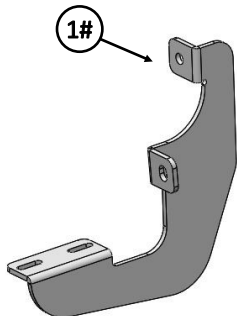
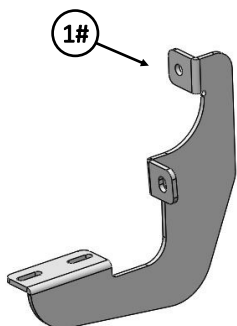
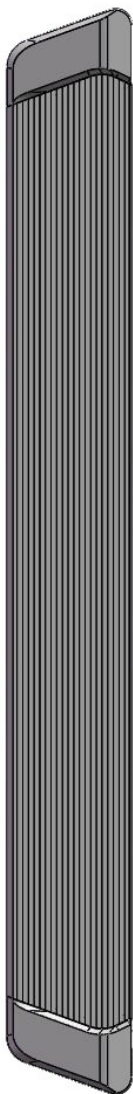

# iBoard®

## STEP 1

Start installation from the driver side of the vehicle. Separate trim from rocker panel and insert M10x35 Bolt Plate as shown. Do not fully tighten at this time, (Fig 1 & 2).

Insert M10 Rivet Nuts as shown. (Fig 2).

## STEP 2

Attach (1) Mounting Bracket with (1) M10X1.5-25mm Hex Bolt, (2) M10 Flat Washers, (2) M10 Lock Washers and (1) M10 Hex Nut, (Fig 3). Do not fully tighten hardware at this time.

Tighten top bolt to crimp Rivet Nut until increased resistance is felt. Verify M10 Rivet Nut is not loose in hole, otherwise re-tighten. Hole M10x35 Bolt Plate parallel to rocker panel and tighten bottom nut. Re-attach trim panel as shown, (Fig 4).

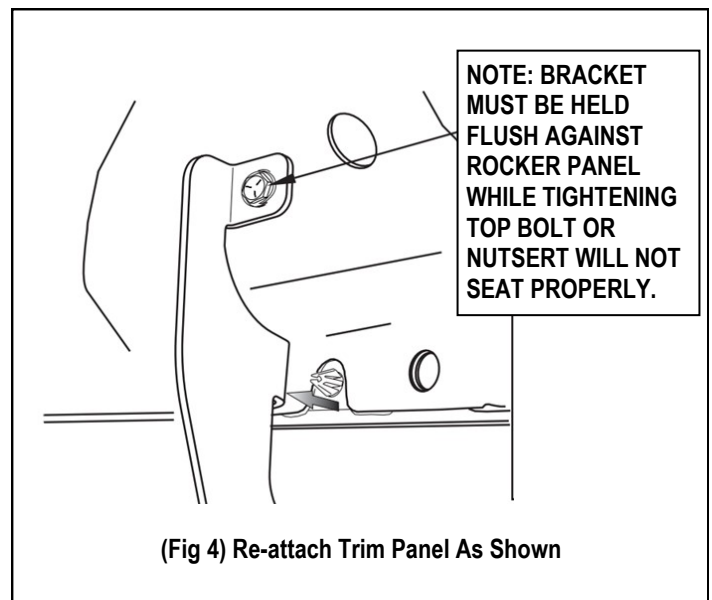
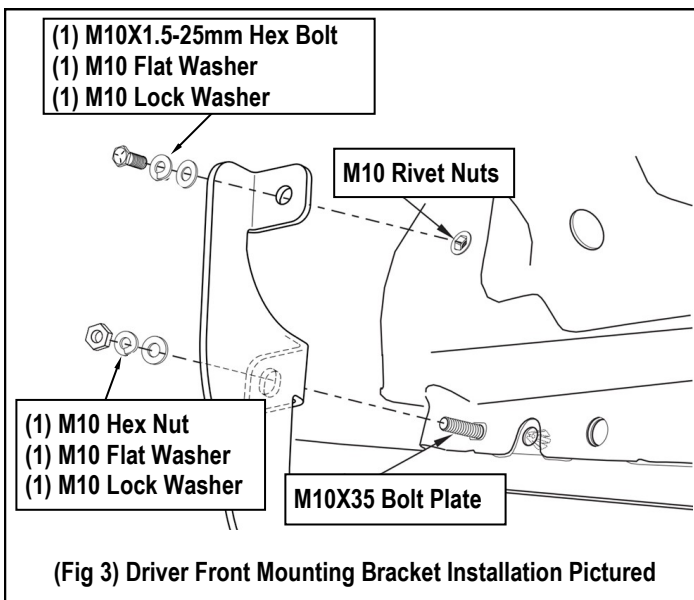
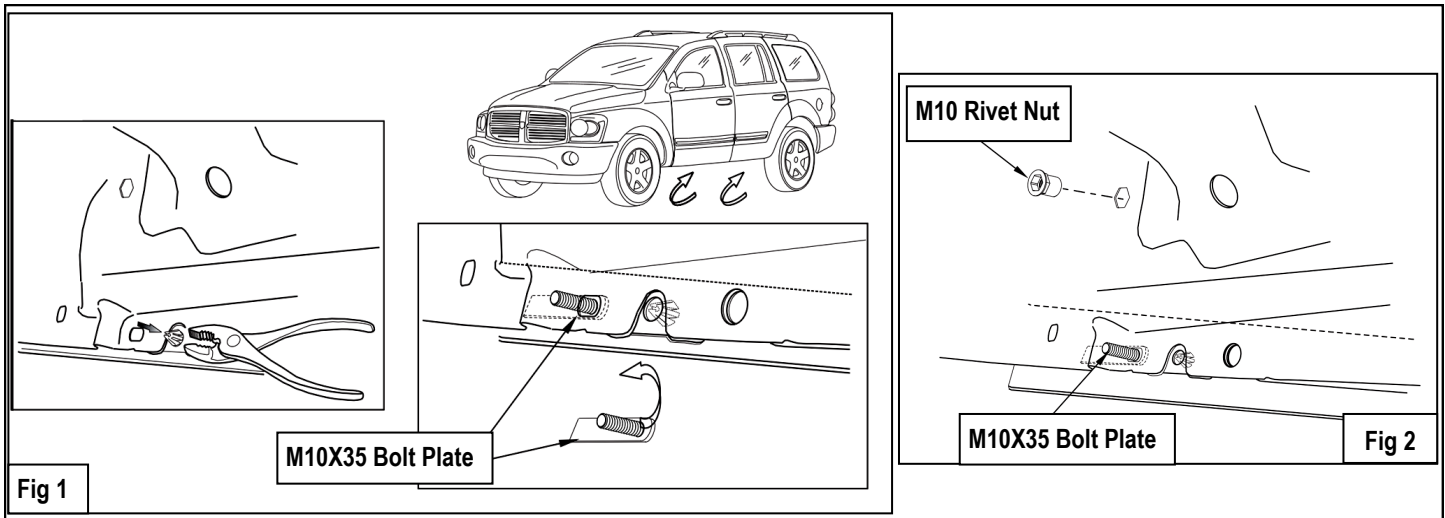

# iBoard®

## STEP 3

Move to the driver side center & rear of the vehicle. Repeat **Steps 1-2** for other (2) Mounting Brackets installation.

**Note:** (6) Mounting Brackets are universal.

## STEP 4

Select a Running Board. Slip (3) M6x1-20mm Square Head Bolts into each bottom channel (**Fig 5**). Carefully position the Running Board onto the (3) Mounting Brackets.

**IMPORTANT:** Do not slide the Running Board on the Brackets or the bottom surface of the board will be damaged. Attach the Running Board to each Mounting Bracket with (2) M6x1-20mm Square Head Bolts, (2) M6 Large Flat Washers and (2) M6 Nylon Lock Nuts (**Fig 6**). Do not fully tighten at this time.

M6X1-20mm Square Head Bolts

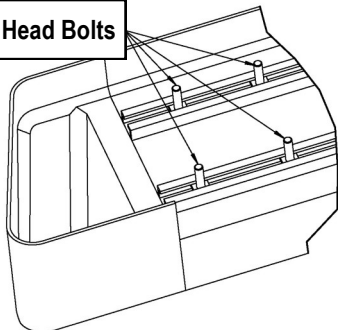

(Fig 4) Slip M6X1-20mm Square Head Bolts Into The Bottom Channels

## STEP 5

Level and adjust the Running Board and fully tighten all hardware.

**Important:** Please follow the recommended Tightening Torques shown in the table on page 1. Don't over tighten, or the nuts/bolts will be damaged.

(2) M6X1-20mm Square Head Bolts  
(2) M6 Large Flat Washers  
(2) M6 Nylon Lock Nuts

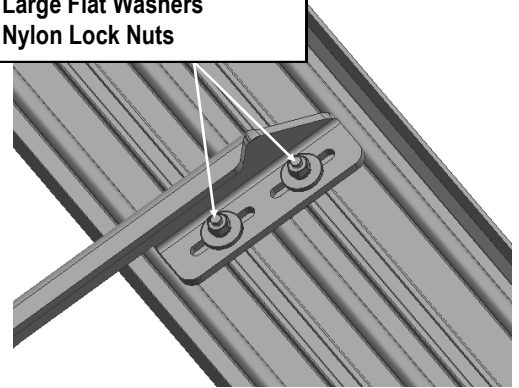

(Fig 5) Running Board Installed Onto Mounting Bracket

## STEP 6

Repeat **Steps 1-5** for the other side Running Board installation. The installation is completed.

### Attention

Do periodic inspections to the installation to make sure that all hardware is secure and tight.

In order to protect your bars/boards, please use only mild soap/non-abrasive products for cleaning.