

iBoard®

iBoard® by APS

PART#: IB-006

READ INSTRUCTIONS CAREFULLY BEFORE STARTING INSTALLATION. REMOVE CONTENTS FROM BOX AND VERIFY ALL PARTS ARE PRESENT. ASSISTANCE IS RECOMMENDED.

*BODY FRAME MOUNT
*DRILLING MAYBE REQUIRED

Fastener Size	Tightening Torque (ft-lbs)	Required
6mm	6-7	√
8mm	16-18	X
10mm	31-32	√
12mm	56-58	√
14mm	92-94	X

PART LIST

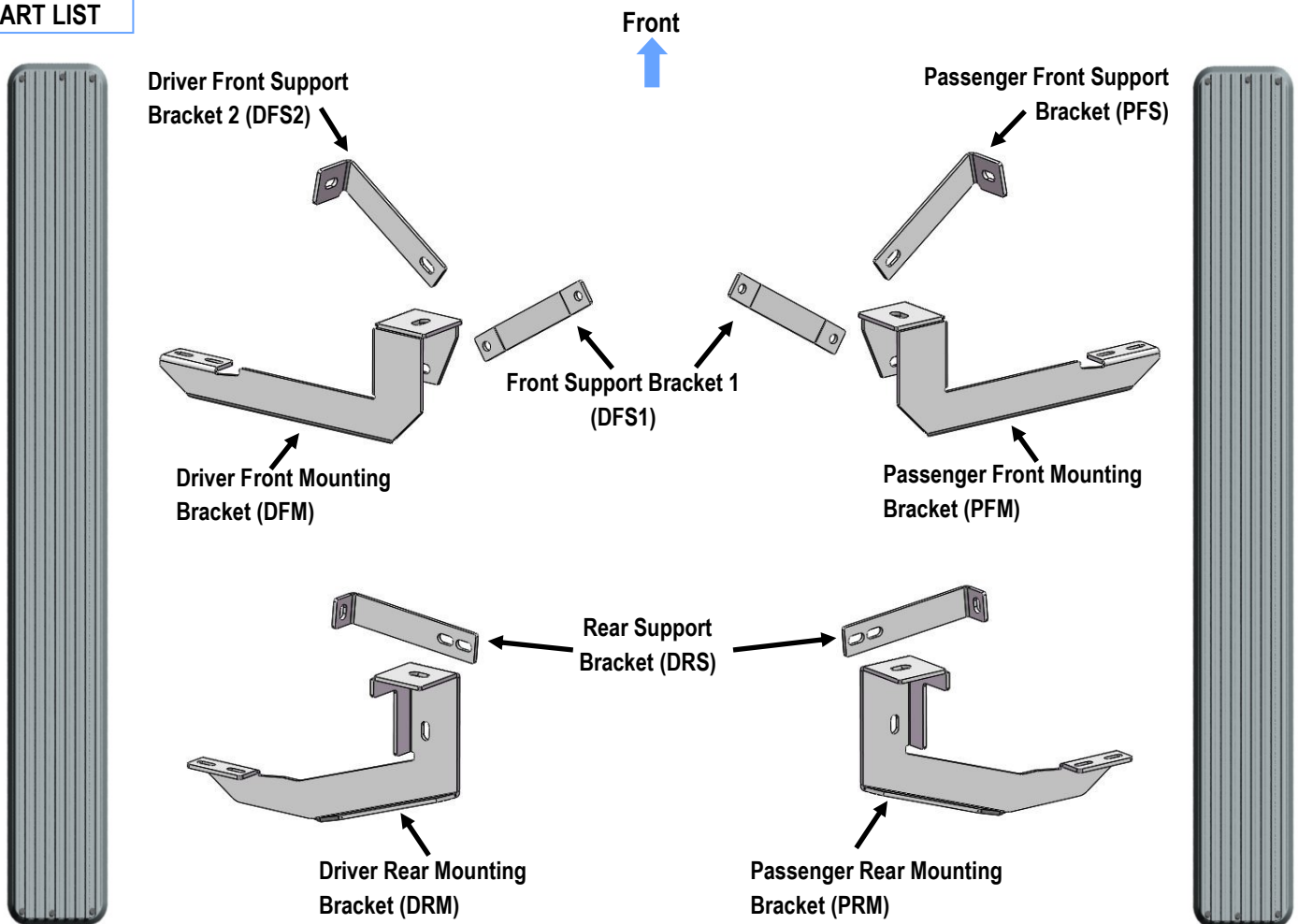

Customer Support: info@iboardauto.com

iBoard®

Hardware Package A (For Bracket Installation)



Hardware Package B (For Aluminum Step Bar Installation Only, Not Supply to Stainless Steel Step Bar)



Hardware Package C (For Stainless Steel Step Bar Installation Only, Not Supply to Aluminum Step Bar)



STEP 1

Start installation from the driver side front of the vehicle. Remove the factory body mount bolt. The rubber bushing will be reused. Select (1) Driver Front Mounting Bracket (DFM), install with (1) Spacer Plate, (1) M12X1.75-120mm Hex Bolt, (1) M12 Flat Washer and (1) M12 Lock Washer, (Fig 1). Do not fully tighten hardware at this time.

Note: Put the spacer Plate between the Mounting Bracket and the factory rubber bushing.

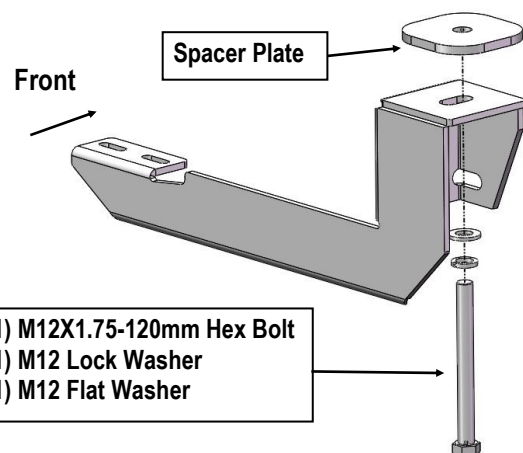

(Fig 1) Driver Front Mounting Bracket (DFM) Installation

iBoard®

STEP 2

Next, select the correct Front Support Bracket for your application.

2002-2005 Models:

Select the Driver Front Support Bracket 1 (**DFS1**) with the straight 2-hole. Attach one end to the Driver Front Mounting Bracket (**DFM**) with (1) M10X1.5-30mm Hex Bolt, (2) M10 Flat Washers, (1) M10 Lock Washer and (1) M10 Hex Nut, (**Fig 3**). Do not fully tighten hardware at this time.

Line up the other end of the support bracket with the hole on the factory body mount bracket. Bolt the Support Bracket to the body mount bracket with (1) M10X1.5-30mm Hex Bolt, (2) M10 Flat Washers, (1) M10 Lock Washer and (1) M10 Hex Nut, (**Fig 3**). Do not fully tighten hardware at this time.

NOTE: Some models may require to drill a mounting hole on the factory body mount bracket if not equipped.

IMPORTANT! Any cutting or drilling tool may break or shatter. Government regulations require safety glasses & equipment at all times when cutting or drilling.

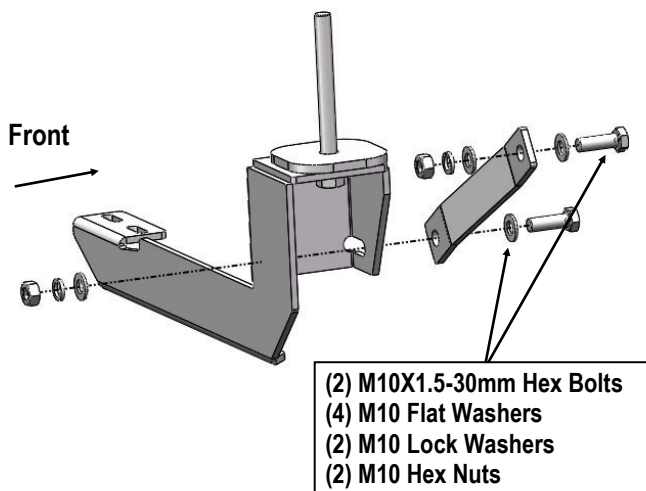

(Fig 3) Driver Front Support 1 Bracket (DFS1) Installation
(For 2002-2005 Models)

2006-2008 Models:

Select the Driver Front Support Bracket 2 (**DFS2**). Remove the sealing tape on the mounting location on the body panel. Partially thread (1) M10 Plastic Washer onto (1) M10X40 Bolt Plate. Insert the M10 Bolt Plate into the mounting hole and thread the M10 Plastic Washer down against the body panel to hold the bolt plate in place. **NOTE:** The M10 Plastic Washer is designed to prevent the M10 Bolt Plate from falling into the body cavity within bracket installation.

Secure the short end of Support Bracket 2 to the installed M10 Bolt Plate with (1) M10 Flat Washer, (1) M10 Lock Washer and (1) M10 Hex Nut. Attach the long end of the Support Bracket to the Mounting Bracket with (1) M10X1.5-30mm Hex Bolt, (2) M10 Flat Washers, (1) M10 Lock Washer and (1) M10 Hex Nut, (**Fig 5**). Do not fully tighten hardware at this time.

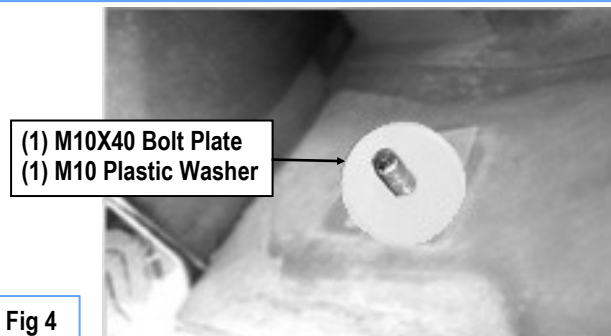
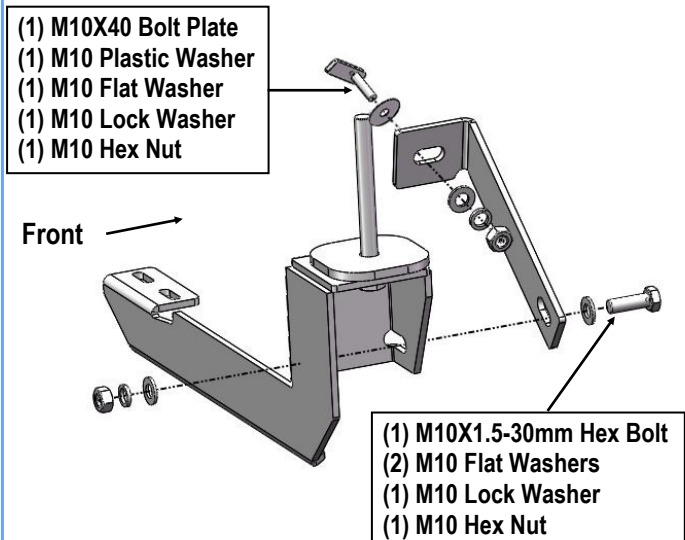

Fig 4



(Fig 5) Driver Front Support Bracket 2 (DFS2) Installation
(For 2006-2008 Models)

iBoard®

STEP 3

Move to Driver Side Rear Mounting Location. Repeat **Step 2** for the Driver Rear Mounting Bracket (**DRM**) installation, (**Fig 6**).

Next, select the Driver Rear Support Bracket (**DRS**), (90-degree bend on one end). Remove the sealing tape on the inner body panel to uncover the mounting location. Partially thread (1) M10 Plastic Washer onto (1) M10X40 Bolt Plate. Insert the M10 Bolt Plate into the mounting hole and thread the M10 Plastic Washer down until it is flush against the body panel, (**Fig 6**).

Secure the Support Bracket to the M10 Bolt Plate with (1) M10 Flat Washer, (1) M10 Lock Washer and (1) M10 Hex Nut. Attach the Support Bracket to the front-facing side of the Mounting Bracket with (1) M10X1.5-30mm Hex Bolt, (2) M10 Flat Washers, (1) M10 Lock Washer and (1) M10 Hex Nut, (**Fig 6**). Do not fully tighten hardware at this time.

NOTE: The Driver Rear Support Bracket is not required on the Regular Cab models.

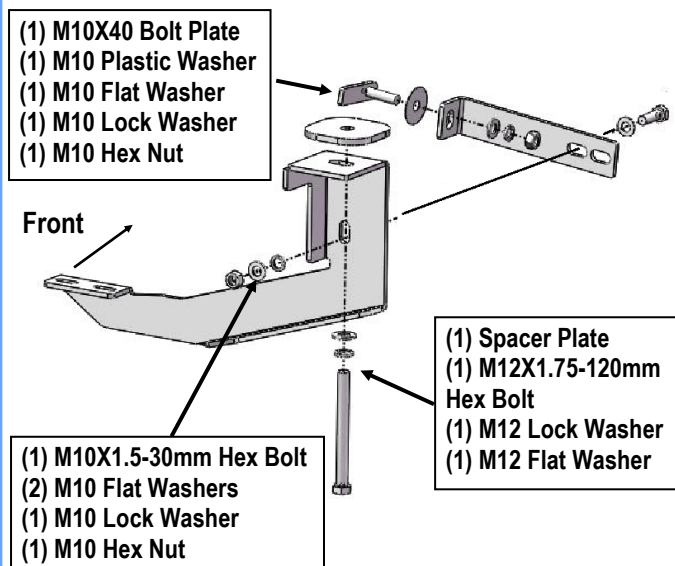

(Fig 6) Driver Rear Side Mounting Bracket Installation

STEP 4

Once all (2) mounting brackets are installed, then proceed to the Step Bar installation. According to the style of Step Bar proceed to the correct installation STEPS.

Note: Aluminum Step Bar refer to STEP 5; Stainless Steel Step Bar skip to STEP 6.

STEP 5

Aluminum Step Bar Installation:

Select a **Aluminum Step Bar**. Slip (2) M6x1-20mm Square Head Bolts into each bottom channel (**Fig 7**). Carefully position the Step Bar onto the (2) Mounting Brackets.

IMPORTANT: Do not slide the Step Bar on the Brackets or the bottom surface of the board will be damaged. Attach the Step Bar to each Mounting Brackets with (2) M6x1-20mm Square Head Bolts, (2) M6 Large Flat Washers and (2) M6 Nylon Lock Nuts, (**Fig 8**). Do not fully tighten at this time.

Level and adjust the Step Bar and fully tighten all hardware. Repeat **Steps 1-5** for the other side Step Bar installation. **The installation is completed!!!**



(Fig 7) Slip M6X1-20mm Square Head Bolts Into The Bottom Channels

iBoard®

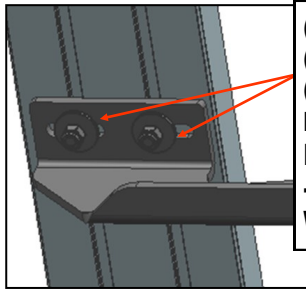

(2) M6X1-20mm Square Head Bolts
(2) M6 Large Flat Washers
(2) M6 Nylon Lock Nuts
IMPORTANT: TORQUE FOR 6MM FASTNERS MUST LESS THAN 6-7 FT-LBS OR THE FASTNERS WILL BE DAMAGED!

(Fig 8) Running Board Installed Onto Mounting Bracket

STEP 6

Stainless Steel Step Bar Installation:

Select a **Stainless Steel Step Bar** (with the U-Sliders installed on the Bar). Loose the U-Sliders, reposition the U-Sliders onto the board according to the (2) Installed Mounting Brackets location, **(Fig 9)**. Re-secure the U-Sliders on the Step Bar. Attach the Step Bar to the installed Mounting Brackets with (4) M6X1-20mm Hex Bolts, (4) M6 Large Flat Washers & (4) M6 Lock Washers, **(Fig 10)**. Do not fully tighten hardware at this time.

Level and adjust the Step Bar and fully tighten all hardware.

Repeat **Steps 1-4 and 6** for the other side Step Bar installation.

The installation is completed!!!

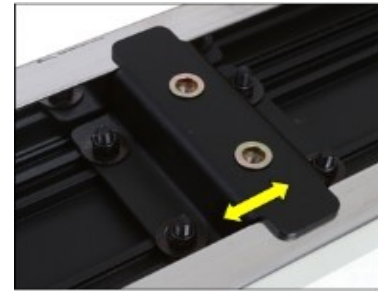

(Fig 9) Slide & line up the U-Slider with the installed mounting brackets along bottom channel

(2) M6X1-20mm Hex Bolts
(2) M6 Large Flat Washers
(2) M6 Lock Washers
IMPORTANT: TORQUE FOR 6MM FASTNERS MUST LESS THAN 6-7 FT-LBS OR THE FASTNERS WILL BE DAMAGED!

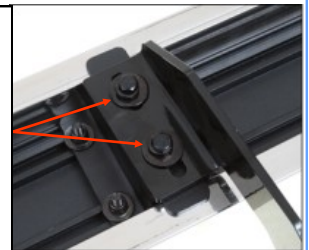

(Fig 10) Step Bar Installed on Bracket Installed (Example)

Attention

Do periodic inspections to the installation to make sure that all hardware is secure and tight.

In order to protect your bars/boards, please use only mild soap/non-abrasive products for cleaning.