



iBoard® by APS

PART#: IB-206C&H

READ INSTRUCTIONS CAREFULLY BEFORE STARTING INSTALLATION. REMOVE CONTENTS FROM BOX AND VERIFY ALL PARTS ARE PRESENT. ASSISTANCE IS RECOMMENDED.

*ROCKER PANEL MOUNT
*DRILLING IS REQUIRED

Fastener Size	Tightening Torque (ft-lbs)	Required
6mm	6-7	√
8mm	16-18	√
10mm	31-32	√
12mm	56-58	X
14mm	92-94	X

PART LIST

Driver Side Step Bar

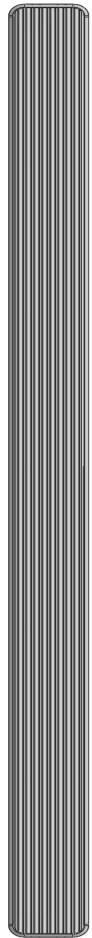

Driver Side Support Bracket (DFS/DCS/DRS)

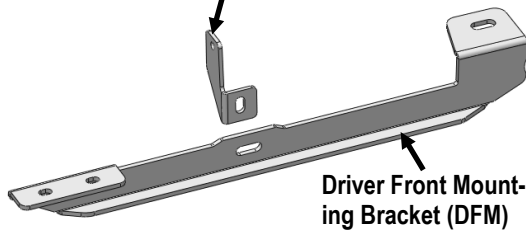

Driver Front Mounting Bracket (DFM)

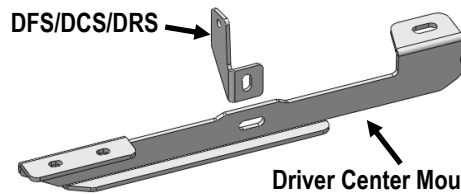

Driver Center Mounting Bracket (DCM)

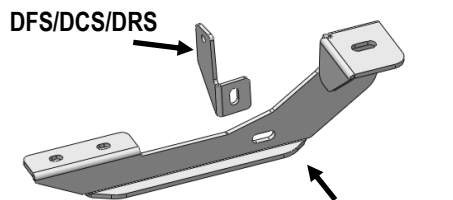

Driver Rear Mounting Bracket (DRM)

Front



Passenger Side Support Bracket (PFS/PCS/PRS)

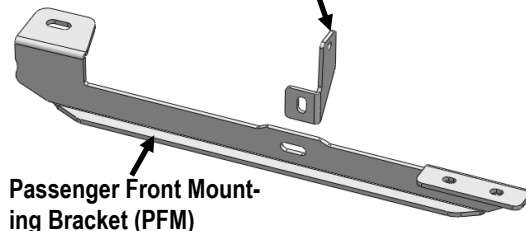

Passenger Front Mounting Bracket (PFM)

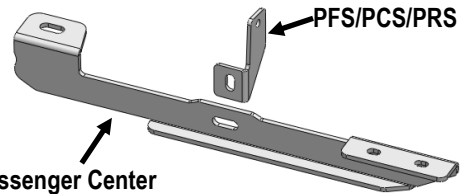

Passenger Center Mounting Bracket (PCM)

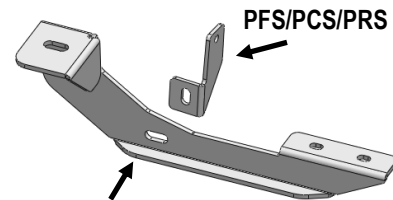

Passenger Rear Mounting Bracket (PRM)

Passenger Side Step Bar

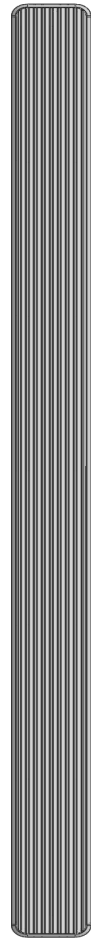

Note: (3) Driver Side Support Brackets are universal.
(3) Passenger Side Support Brackets are universal.



Hardware Package A (For Bracket Installation)					
Item	QTY	Description	Item	QTY	Description
1#	2	M10X35 Bolt Plates	7#	12	M8 Flat Washers
2#	4	M10X40 Bolt Plates	8#	6	M8 Lock Washers
3#	6	M10 Flat Washers	9#	6	M8 Hex Nuts
4#	6	M10 Lock Washers	10#	6	M6X1-20mm Inner Hex Bolts
5#	6	M10 Hex Nuts	11#	12	M6 Large Flat Washers
6#	6	M8X1.25-25mm Hex Bolts	12#	6	M6 Nylon Lock Nuts

1# 2# 3# 4# 5# 6#

7# 8# 9# 10# 11# 12#

Hardware Package B (For Stainless Steel Step Bar Installation)					
Item	QTY	Description	Item	QTY	Description
1#	12	M8X1.25-35mm Carriage Bolts	3#	12	M8 Nylon Lock Nuts
2#	12	M8 Large Flat Washers	4#	6	Sliders (Packed with Step Bars)

1# 2# 3# 4#



STEP 1

Start installation from the driver side front of the vehicle, (**Fig 1**).

STEP 2

Select (1) Driver Front Mounting Bracket (**DFM**) and (1) Driver Side Support Bracket (**DFS/DCS/DRS**). Bolt the Support Bracket to the front of the Mounting Bracket with (1) M8X1.25-25mm Hex Bolt, (2) M8 Flat Washers, (1) M8 Lock Washer and (1) M8 Hex Nut, (**Fig 2**). Do not fully tighten hardware at this time.

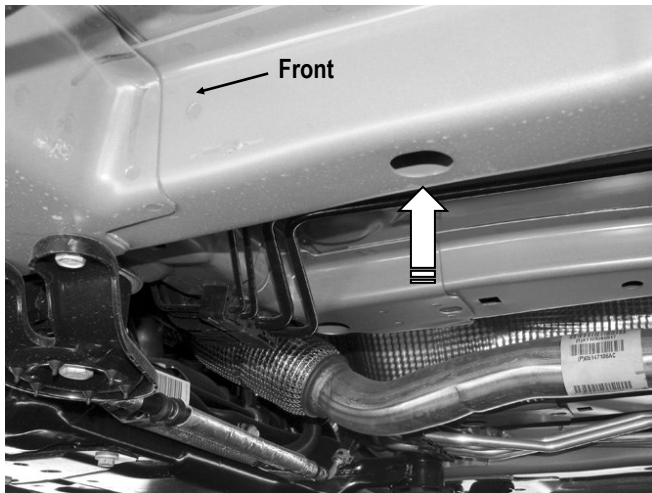

(Fig 1) Driver Side Front Mounting Location

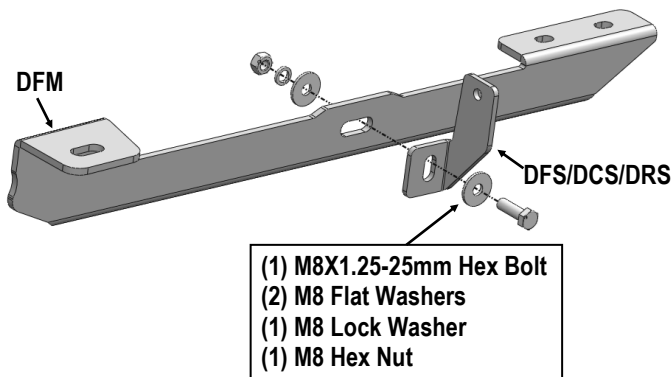

(Fig 2) Driver Front Mounting Bracket Assembly

STEP 3

Locate the factory oval hole at the bottom of the inner frame channel, (**Fig 1**). Insert (1) M10X40 Bolt Plate into the factory hole, (**Figs 3A & 3B**). Attach the Driver Front Mounting Bracket (**DFM**) to the installed M10X40 Bolt Plate with (1) M10 Flat Washer, (1) M10 Lock Washer and (1) M10 Hex Nut, (**Fig 4**). Do not fully tighten hardware at this time.

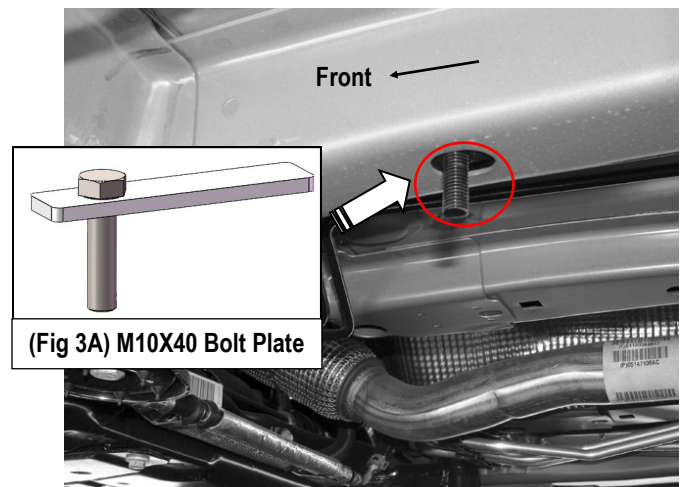

(Fig 3B) M10X40 Bolt Plate Installed
(On Driver Side Front Mounting Location)

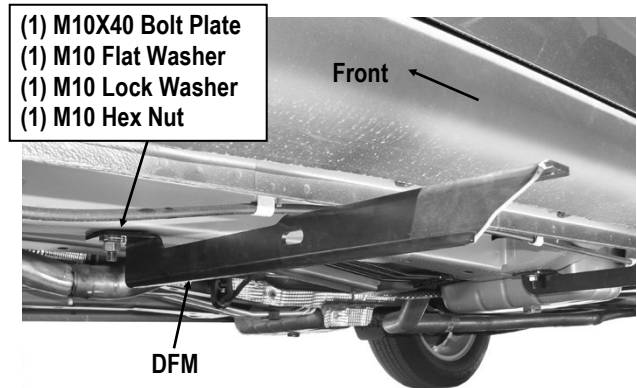

(Fig 4) Driver Front Mounting Bracket (DFM) Installation



STEP 4

Move to the driver side center mounting location. Locate the square hole at the bottom of the frame channel, **(Fig 5)**. Insert (1) M10X35 Bolt Plate into the factory hole, **(Figs 6A & 6B)**. Attach the Driver Center Mounting Bracket **(DCM)** to the M10X35 Bolt Plate with (1) M10 Flat Washer, (1) M10 Lock Washer and (1) M10 Hex Nut, **(Fig 7)**. Attach the Driver Support Bracket **(DFS/DCS/DRS)** to the mounting bracket, **(Fig 7)**. Do not fully tighten hardware at this time.

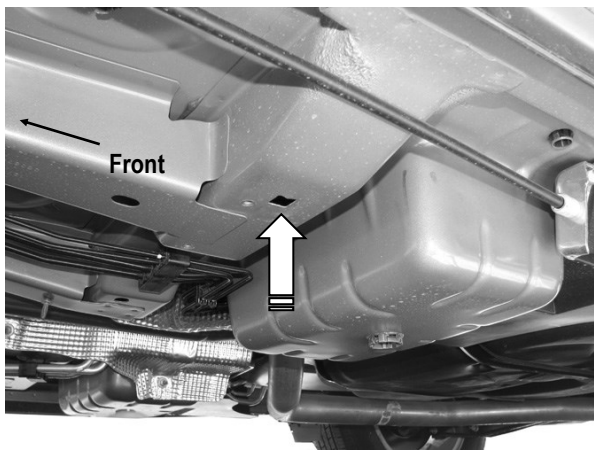

(Fig 5) Driver Center Mounting Location

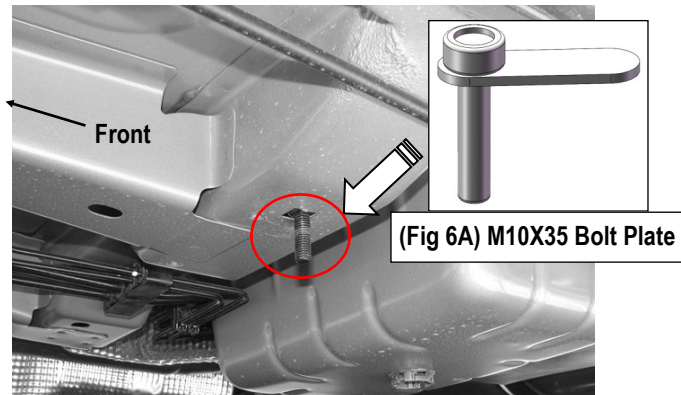

**(Fig 6B) M10X35 Bolt Plate Installed
(On Driver Side Center Mounting Location)**

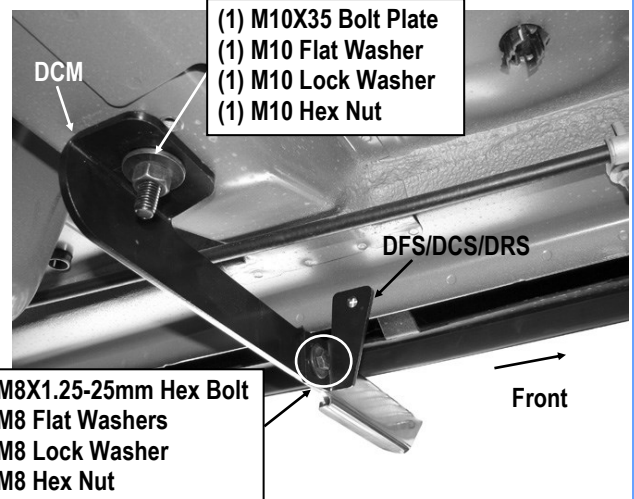

(Fig 7) Driver Side Center Brackets Installed

STEP 5

Move to the driver side rear mounting location, locate the factory oval hole in the floor panel, **(Fig 8)**. Insert (1) M10X40 Bolt Plate into the oval hole, **(Figs 9A & 9B)**. Rotate the Bolt Plate 90-degrees or until it stopped cross to the oval hole. Attach the Driver Rear Mounting Bracket **(DRM)** to the M10X40 Bolt Plate with (1) M10 Flat Washer, (1) M10 Lock Washer and (1) M10 Hex Nut, **(Fig 10)**. Secure the Driver Side Support Bracket onto the Mounting Bracket, **(Fig 10)**. Do not fully tighten hardware at this time.

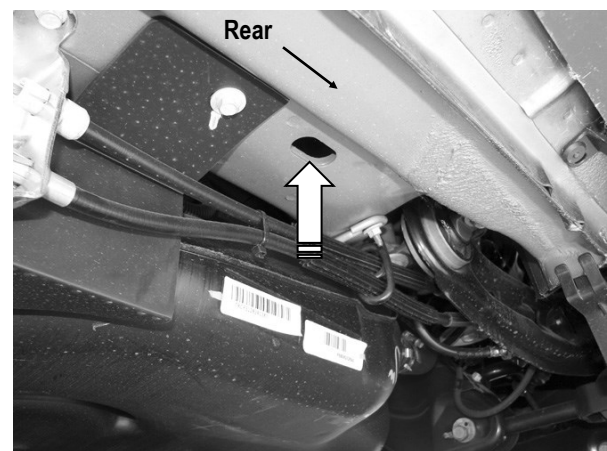

(Fig 8) Driver Side Rear Mounting Location

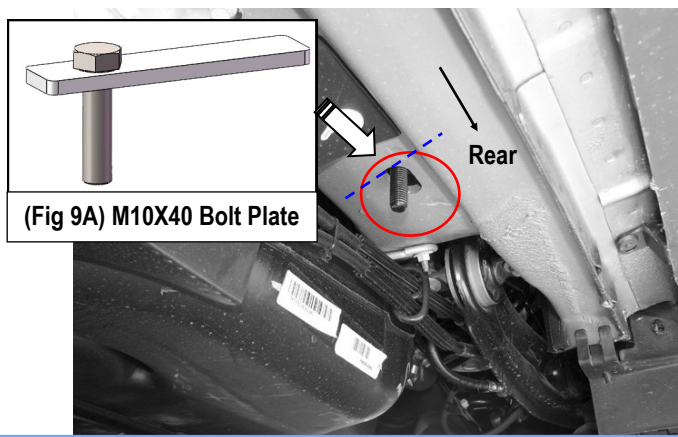

(Fig 9B) M10X40 Bolt Plate Installed
(on Driver Side Rear Mounting Location)

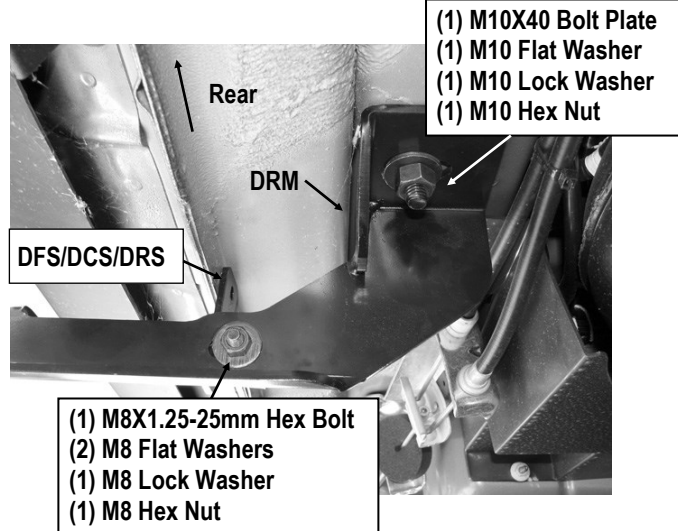

(Fig 10) Driver Side Rear Brackets Installed

STEP 6

Once all (3) Driver side mounting brackets are installed, then proceed to the Step Bar installation. (Figs 11 & 12)

- (1) Select (1) Slider and (2) M8X1.25-35mm Carriage Bolts;
- (2) Install (2) M8X1.25-35mm Carriage Bolts in (1) Slider.
- (3) Slide the Slider (with carriage bolts) to the **Step Bar**.
- (4) Repeat to install the other (2) sliders to the step bar.
- (5) Attach the Step Bar (with the Sliders) onto the installed mounting brackets. Position the Sliders to the installed brackets. Secure the Step Bar to the installed Brackets by using (6) M8 Large Flat Washers and (6) M8 Nylon Lock Nuts and (3) Sliders, (Fig 12). Do not fully tighten hardware at this time.

Note: The Sliders are packed with the Step Bars.

Level and adjust the Step Bar and fully tighten all hardware.

STEP 7

Attach the Support Brackets on the inner side of the pinch weld. Secure the Support Brackets to the pinch weld temporarily by using clamps, (Figs 13). Mark the location of the (3) Support Brackets onto the inner side of the pinch weld, (Fig 14). Once all (3) locations are marked, drill 1/4" through holes on the pinch weld, (If necessary, remove the Step Bar or loosen the Brackets).

VERY IMPORTANT: Do not drill too close to the edge of the pinch weld.

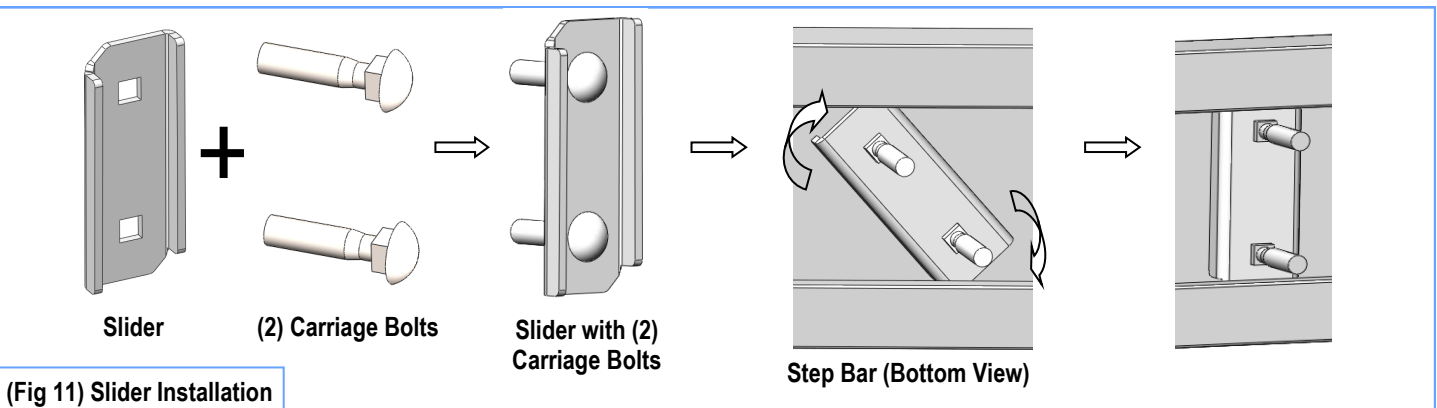

(Fig 11) Slider Installation

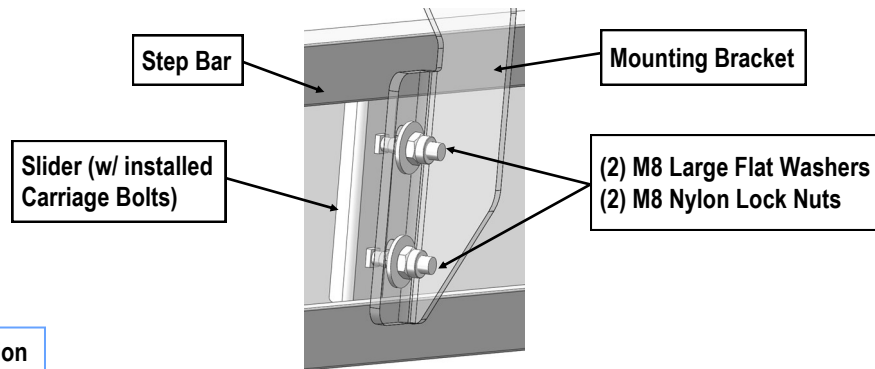

(Fig 12) Step Bar Installation

Attach each Support Bracket to the pinch weld with (1) M6X1-20mm Inner Hex Bolt, (2) M6 Large Flat Washers and (1) M6 Nylon Lock Nut, (Fig 15).

Reinstall the Step Bar, align, adjust as necessary and tighten all hardware.

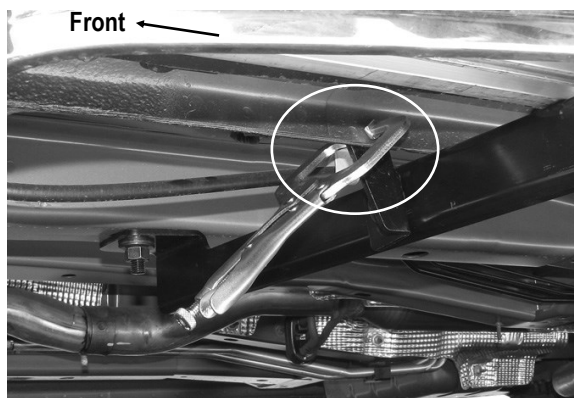

(Fig 13) Secure The Support Brackets To The Pinch Weld Temporarily By Using Clamps

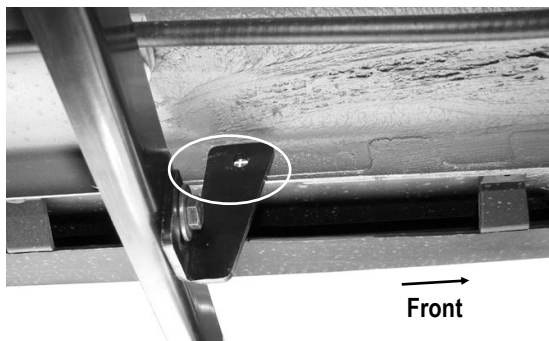

(Fig 14) Mark The Locations Onto The Inner Side Of The Pinch Weld

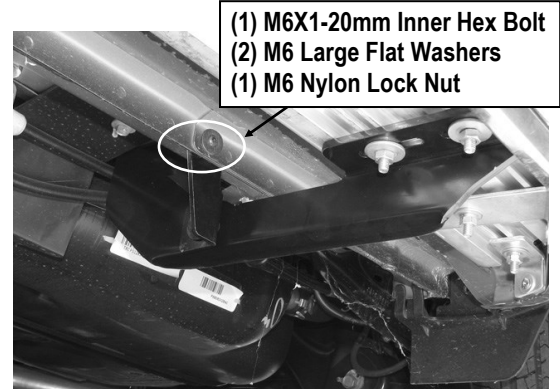

(Fig 15) Support Bracket Installed

STEP 8

Repeat **Steps 1-8** for the other side Step Bar installation. The installation is completed.

Attention

Do periodic inspections to the installation to make sure that all hardware is secure and tight.

In order to protect your bars/boards, please use mild soap/non-abrasive products for cleaning only.