



iBoard® by APS

PART#: IB-179/208C&H

READ INSTRUCTIONS CAREFULLY BEFORE STARTING INSTALLATION. REMOVE CONTENTS FROM BOX AND VERIFY ALL PARTS ARE PRESENT. ASSISTANCE IS RECOMMENDED.

*ROCKER PANEL MOUNT

*DRILLING MAY BE REQUIRED

Fastener Size	Tightening Torque (ft-lbs)	Required
6mm	6-7	√
8mm	16-18	√
10mm	31-32	X
12mm	56-58	X
14mm	92-94	X

PART LIST

Driver Side Step Bar

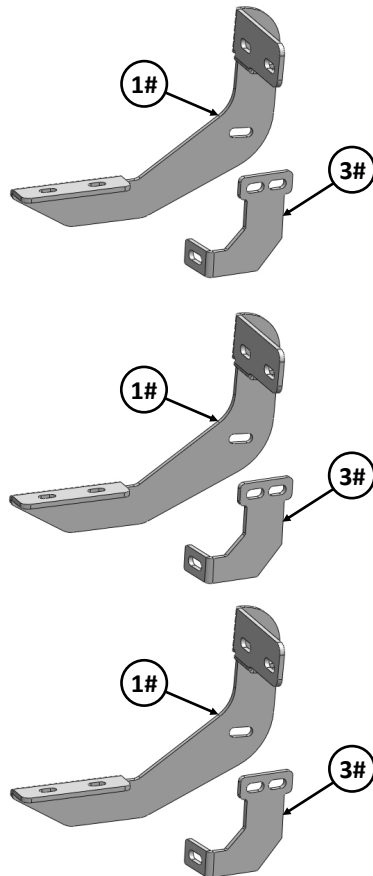
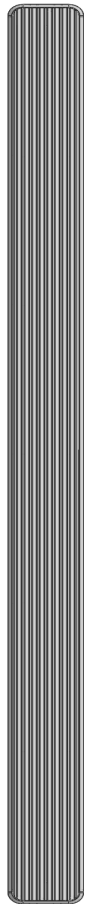

Front



Passenger Side Step Bar

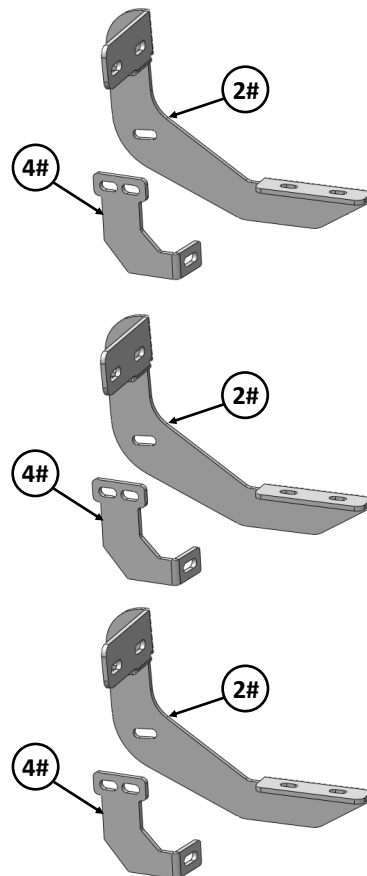
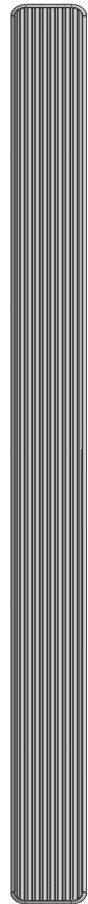



Mounting Bracket List

Item	QTY	Description	Item	QTY	Description
1#	3	Driver Side Mounting Brackets	3#	3	Driver Side Support Brackets
2#	3	Passenger Side Mounting Brackets	4#	3	Passenger Side Support Brackets

Hardware Package A (For Bracket Installation)

Item	QTY	Description	Item	QTY	Description
1#	6	M8 Bolt Plates	6#	6	M8X1.25 Hex Nuts
2#	6	M8 Plastic Washers	7#	6	M8X1.25 Nylon Lock Nuts
3#	18	M8X1.25-30 Hex Bolts	8#	12	M6X1-25 Hex Bolts
4#	24	M8 Large Flat Washers	9#	24	M6 Large Flat Washers
5#	12	M8 Lock Washers	10#	12	M6X1 Nylon Lock Nuts

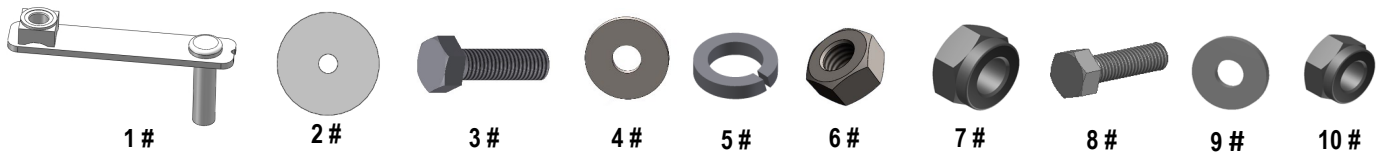

Hardware Package B (For Stainless Steel Step Bar Installation)

Item	QTY	Description	Item	QTY	Description
1#	12	M8X1.25-35mm Carriage Bolts	3#	12	M8 Nylon Lock Nuts
2#	12	M8 Large Flat Washers	4#	6	Sliders (Packed with Step Bars)

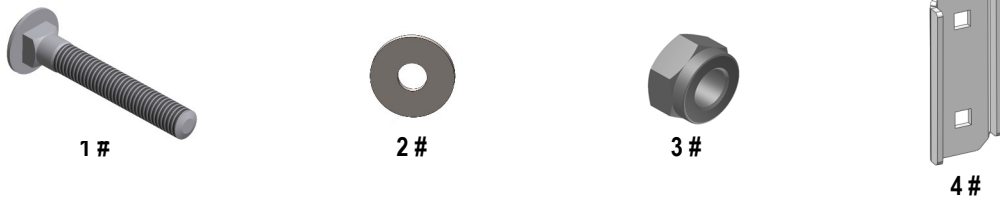



STEP 1

Starting at the **passenger** side front of the vehicle, remove the sealing tape covering the factory holes on the side of the inner panel, (Fig 1).

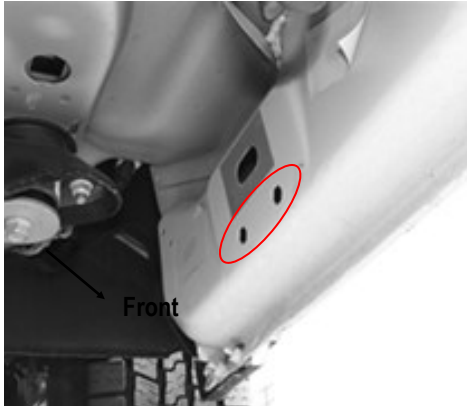

(Fig 1) Passenger Side Front Mounting Location (Example)

STEP 2

Determine the correct procedure to attach (1) Driver Front Mounting Bracket for your model/year:

Models without factory threaded inserts in body panel:

- a. Partially thread (1) M8X1.25-30 Hex Bolt into the threaded end on (1) M8 Bolt/Nut Plate (Fig 2). Thread the hex bolt in until it is flush with the welded nut, (Fig 3). Use the hex bolt as a handle and insert the Bolt/Nut Plate into the oval hole, (Fig 4). Feed the threaded bolt on the plate through one of the hex holes. Thread (1) M8 Plastic Washer onto the threaded end and down tight against the body panel, (Fig 5).

NOTE: The Plastic washer is designed to keep the Bolt/Nut Plate from falling into the body panel and to aid in bracket installation.

- b. Attach (1) Passenger Front Mounting Bracket to the threaded end of the installed M8 Bolt/Nut Plate with (1) M8 Large Flat Washer, (1) M8 Lock Washer and (1) M8X1.25 Hex Nut, (Fig 6a).

Remove the M8X1.25-30 Hex Bolt from the welded nut on the Bolt/Nut Plate. Rotate the Bolt/Nut Plate until the threaded nut lines up with the remaining hole in the Mounting Bracket and body panel. Do not fully tighten hardware at this time.

C. Attach the Passenger Front Mounting Bracket to the threaded nut on the M8 Bolt Plate with (1) M8X1.25-30 Hex Bolt, (1) M8 Lock Washer and (1) M8 Large Flat Washer, (Fig 6b). Do not fully tighten hardware at this time.

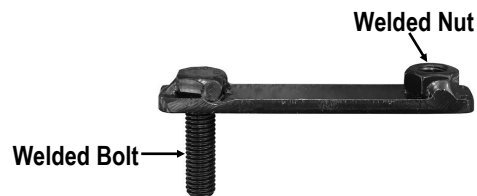

(Fig 2) M8 Bolt/Nut Plate (**NOTE:** M8 Bolt/Nut Plate is not required on models with threaded inserts)

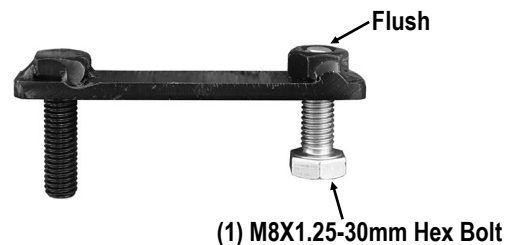

(Fig 3) Thread (1) M8X1.25-30 Hex Bolt into the welded nut on the plate.

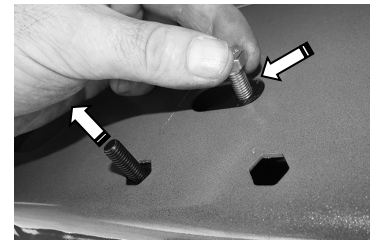

(Fig 4) Use the Hex Bolt as a handle. Insert the Bolt/Nut Plate into the oval hole and feed the threaded end out either factory hex shaped hole.

IMPORTANT: Do not remove the Hex Bolt until the Plastic Washer is threaded onto the welded bolt (Fig 5).

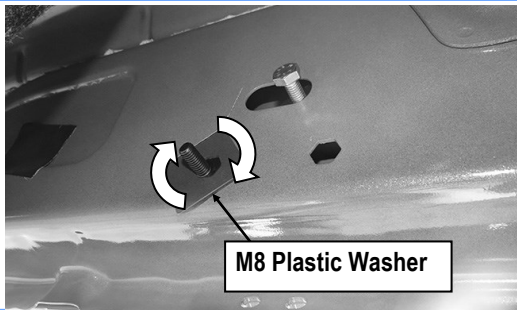

(Fig 5) Thread Plastic Washer onto Bolt Plate to hold Bolt Plate in position

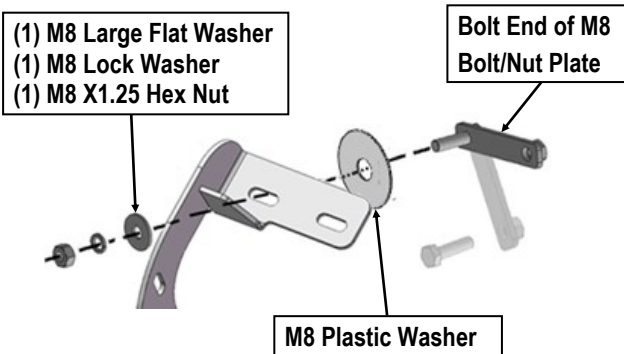

(Fig 6a) Passenger Front Mounting Bracket Installation
(For Models without factory threaded inserts)

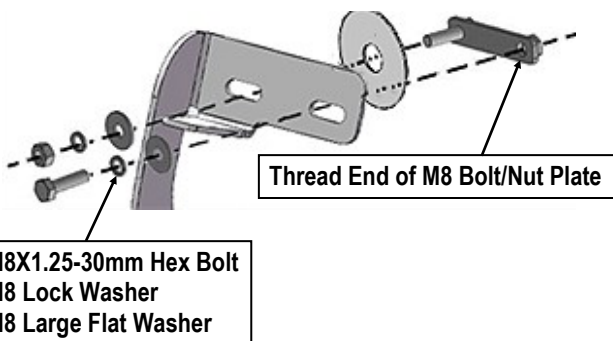

(Fig 6b) Attach the Bracket to Threaded End of the Bolt/Nut Plate

Models with factory threaded inserts:

Attach Passenger Front Mounting Bracket to the threaded inserts with (2) M8X1.25-30 Hex Bolts, (2) M8 Lock Washers and (2) M8 Large Flat Washers, (Fig 7 & 8). Leave hardware loose.

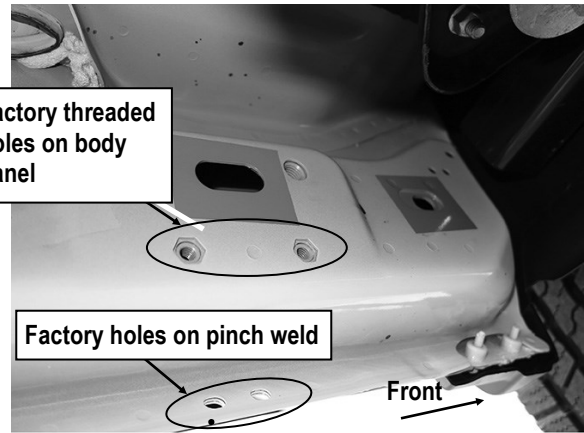

(Fig 7) Passenger Side Front Mounting Location (Mid 2015-On, An Example Of Models With Factory Installed Threaded Inserts)

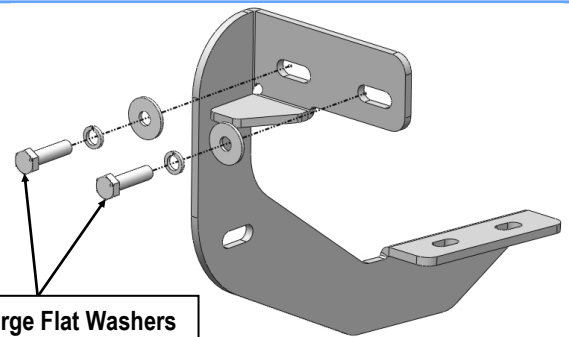

(Fig 8) Passenger Front Mounting Bracket Installation
(For Models with factory threaded inserts)

STEP 3

Next, select (1) Passenger Side Support Bracket (PFS/PCS/PRS). Assemble the Support Bracket to the passenger front Mounting Bracket with (1) M8X1.25-30mm Hex Bolt, (2) M8 Large Flat Washers and (1) M8X1.25 Nylon Lock Nut, (Fig 9). Rotate the Support Bracket to the back of the pinch weld. Line up the slots in the top of the Support Bracket with the (2) factory holes in the pinch weld. Attach the Bracket to the back of the pinch weld with (2) M6X1-25mm Hex Bolts, (4) M6 Large Flat Washers and (2) M6X1 Nylon Lock Nuts, (Fig 10). Do not fully tighten hardware at this time.



IMPORTANT: Some models are not equipped with factory holes and will require drilling through the pinch weld to attach the Support Bracket. Do not drill through pinch weld at this time.

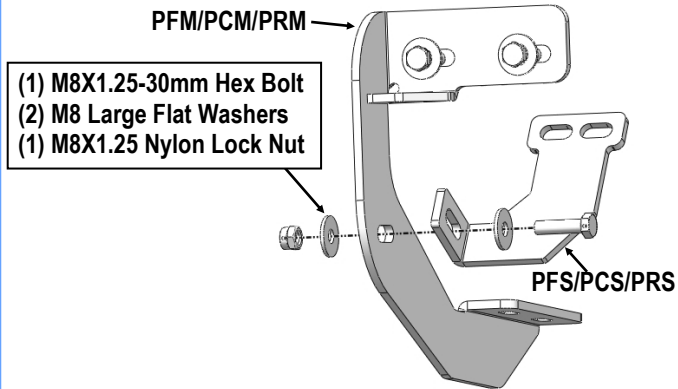

(Fig 9) Attach Passenger Support Bracket to the Passenger side Mounting Bracket

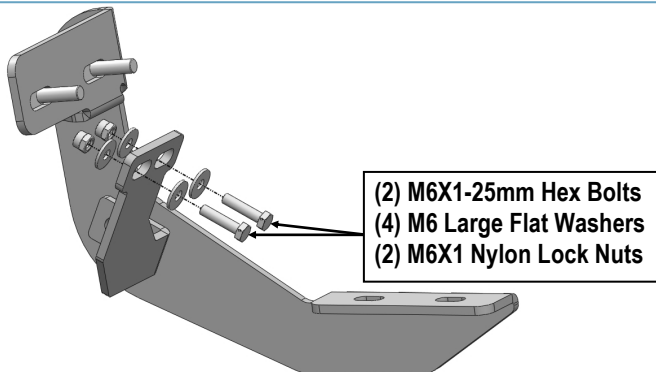

(Fig 10) Attach Support Bracket to the Back of Pinch Weld (Some Models May Require to Drill Holes on Pinch Weld)

STEP 4

Move along the side of the body panel to the center and rear mounting location, (Figs 11 & 12). Repeat **Steps 2-3** to install the passenger side center & rear Brackets.

IMPORTANT: All (3) Passenger side Mounting Brackets are universal.

IMPORTANT: Some models without holes in pinch weld will require drilling 1/4" holes through pinch weld to attach driver side front support bracket. Do complete installation of the Driver Side Bar first, level board before drilling holes for support bracket.

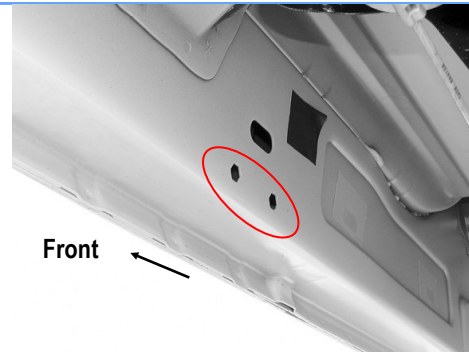

(Fig 11) Passenger Side Center Mounting Location

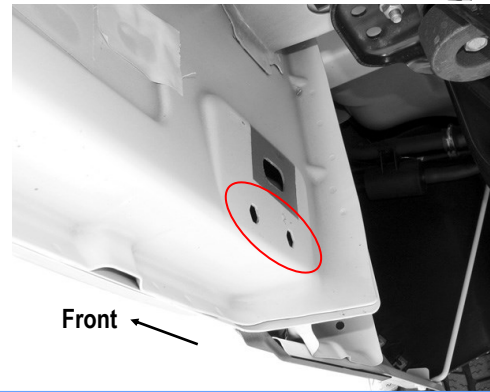

(Fig 12) Passenger Side Rear Mounting Location

STEP 5

Once all (3) Passenger side mounting brackets are assembled, then proceed to the Step Bar installation. (Figs 13 & 14)

- (1) Select (1) Slider and (2) M8X1.25-35mm Carriage Bolts;
- (2) Install (2) M8X1.25-35mm Carriage Bolts in (1) Slider.
- (3) Slide the Slider (with carriage bolts) to the **Step Bar**.
- (4) Repeat to install the other (2) sliders to the step bar.
- (5) Attach the Step Bar (with the Sliders) onto the installed mounting brackets. Position the Sliders to the installed brackets. Secure the Step Bar to the installed Brackets by using (6) M8 Large Flat Washers and (6) M8 Nylon Lock Nuts and (3) Sliders, (Fig 14). Do not fully tighten hardware at this time.

Note: The Sliders are packed with the Mounting Brackets.

Level and adjust the Step Bar and fully tighten all hardware.

Repeat **Steps 1-5** for the other side Step Bar installation. **The installation is completed!!!**

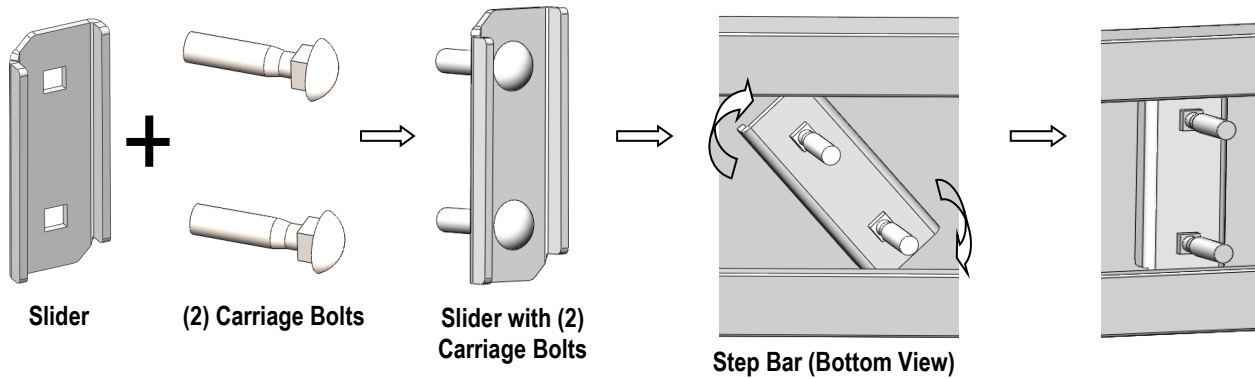

(Fig 13) Slider Installation

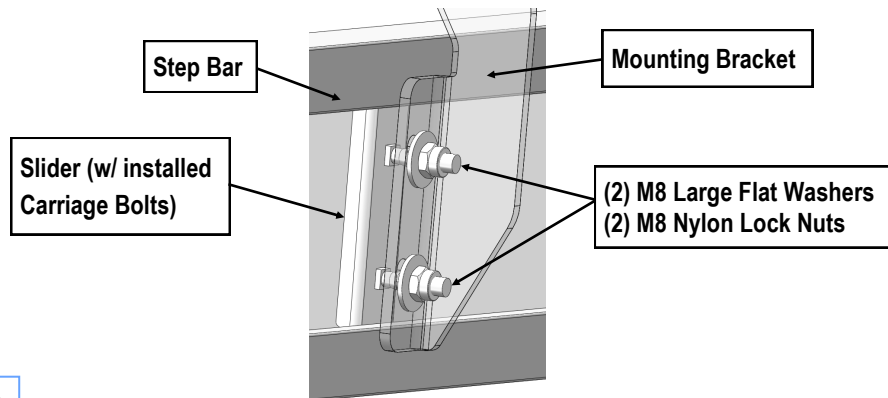

(Fig 14) Step Bar Installation