

# iBoard®

## iBoard® by APS

PART#: IB-R907

READ INSTRUCTIONS CAREFULLY BEFORE STARTING INSTALLATION. REMOVE CONTENTS FROM BOX AND VERIFY ALL PARTS ARE PRESENT. ASSISTANCE IS RECOMMENDED.

\*ROCKER PANEL MOUNT  
\*NO DRILLING REQUIRED

Fastener Size	Tightening Torque (ft-lbs)	Required
6mm	6-7	√
8mm	16-18	X
10mm	31-32	√
12mm	56-58	X
14mm	92-94	X

### PART LIST

Front

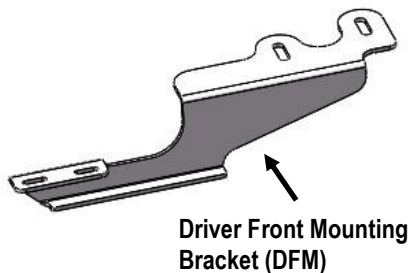

Driver Front Mounting Bracket (DFM)

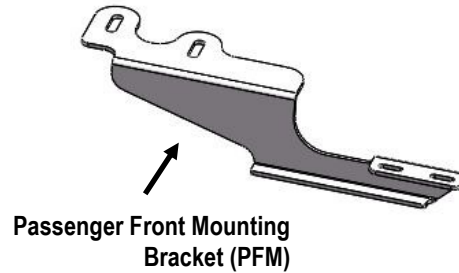

Passenger Front Mounting Bracket (PFM)

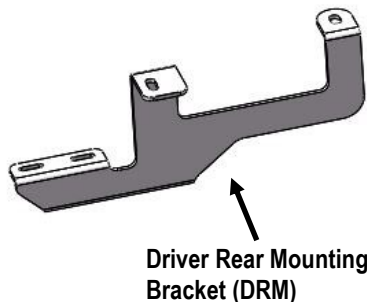

Driver Rear Mounting Bracket (DRM)

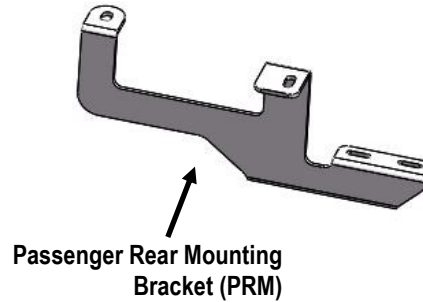

Passenger Rear Mounting Bracket (PRM)



Customer Support: [info@iboardauto.com](mailto:info@iboardauto.com)

# iBoard®

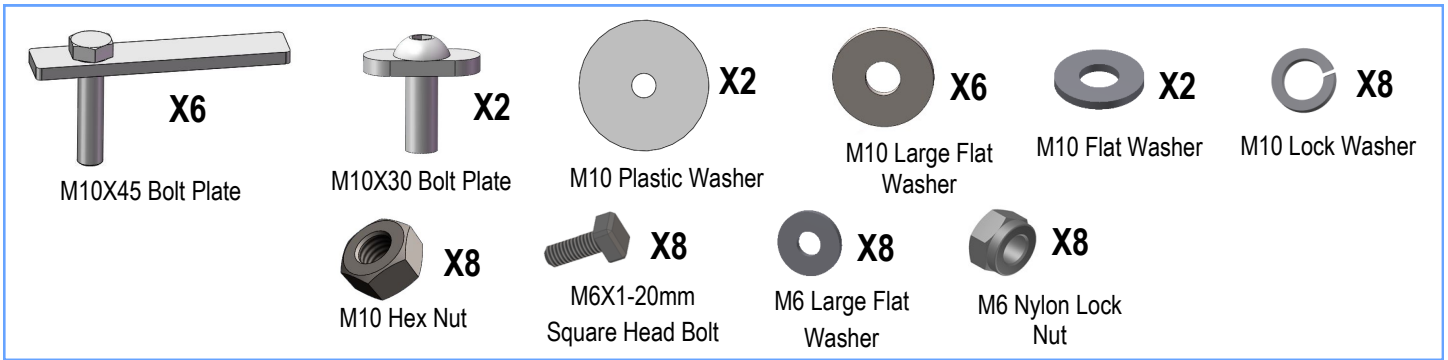

## STEP 1

Start installation from the driver side of the vehicle. Attach the Driver Front Mounting Bracket (DFM) using (2) M10X45 Bolt Plates, (2) M10 Large Flat Washers, (2) M10 Lock Washers, and (2) M10 Hex Nuts as shown, (Fig 1). Do not fully tighten at this time.

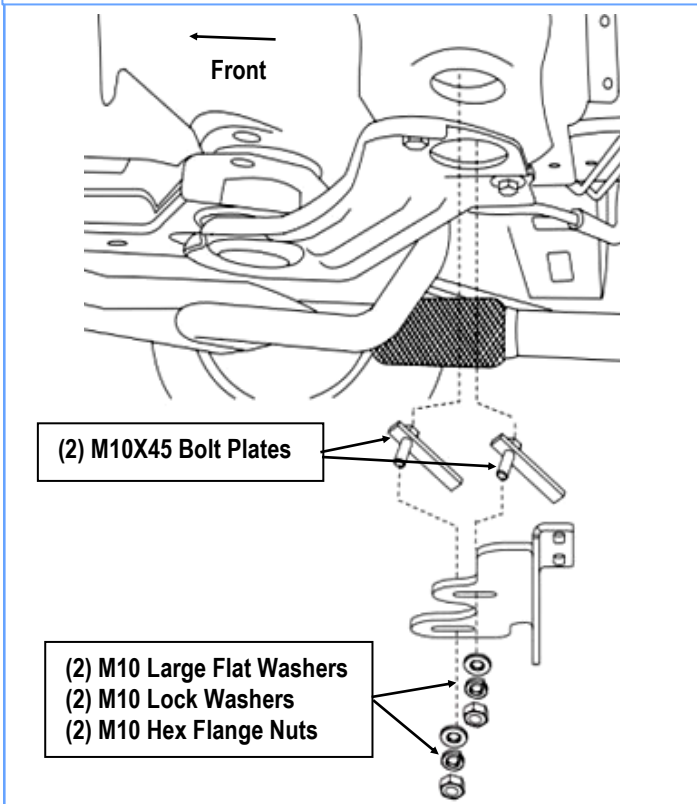

(Fig 1) Driver Side Front Mounting Bracket Installed

## STEP 2

Move to the driver side rear of the vehicle. Attach the Driver Rear Mounting Bracket (DRM) using (1) M10X30 Bolt Plate, (1) M10 Plastic Washer, (1) M10X45 Bolt Plate, (1) M10 Large Flat Washer, (1) M10 Flat Washer, (2) M10 Lock Washers, and (2) M10 Hex Nuts as shown, (Fig 2). Do not fully tighten at this time.

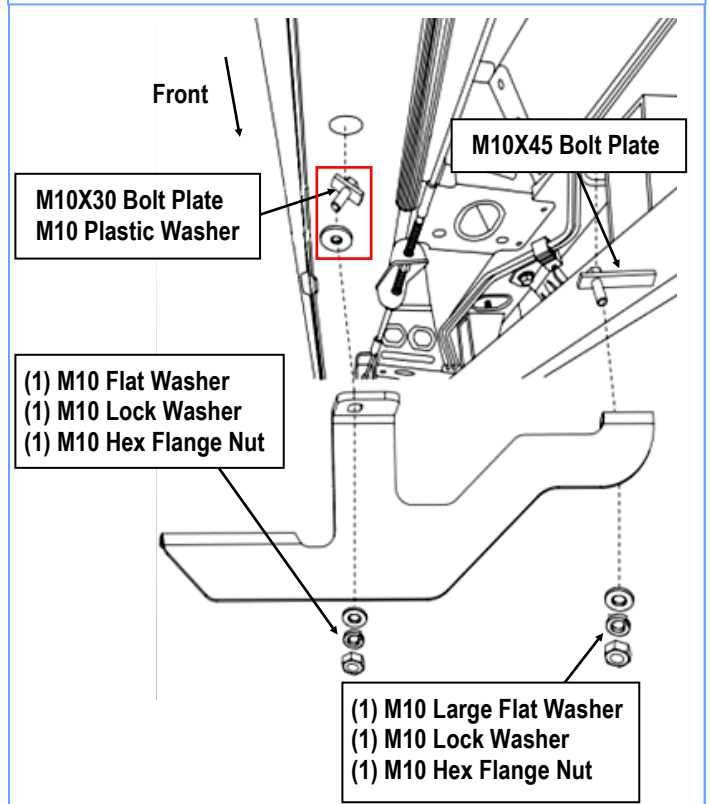

(Fig 2) Driver Side Rear Mounting Bracket Installed

# iBoard®

## STEP 3

Select a Running Board. Slip (2) M6x1-20mm Square Head Bolts into each bottom channel (**Fig 3**). Carefully position the Running Board onto the (2) Mounting Brackets.

**IMPORTANT:** Do not slide the Running Board on the Brackets or the bottom surface of the board will be damaged. Attach the Running Board to each Mounting Bracket with (2) M6x1-20mm Square Head Bolts, (2) M6 Large Flat Washers and (2) M6 Nylon Lock Nuts (**Fig 4**). Do not fully tighten at this time.

M6X1-20mm Square Head Bolts

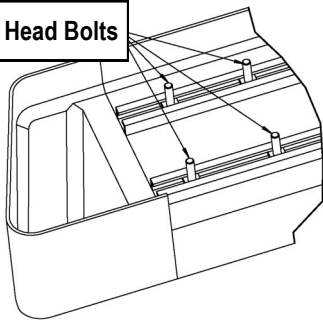

(Fig 3) Slip M6X1-20mm Square Head Bolts Into The Bottom Channels

(2) M6X1-20mm Square Head Bolts  
(2) M6 Large Flat Washers  
(2) M6 Nylon Lock Nuts

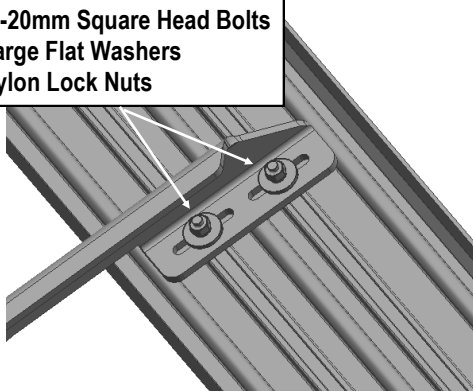

(Fig 4) Running Board Installed Onto Mounting Bracket

## STEP 4

Level and adjust the Running Board and fully tighten all hardware.

**Important:** Please follow the recommended Tightening Torques shown in the table on page 1. Don't over tighten, or

## STEP 5

Repeat **Steps 1-4** for the other side Running Board installation. **Note:** Make sure that the Passenger Front Mounting Bracket (PFM) does not interfere with the metal fuel line, (**Fig 5**).

The installation is completed.

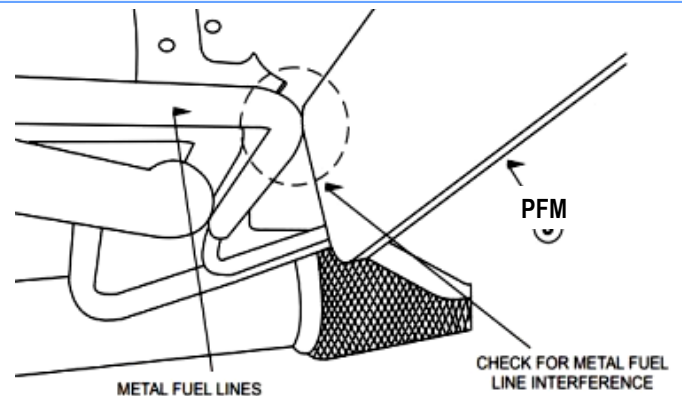

(Fig 5) Installation Completed

### Attention

Do periodic inspections to the installation to make sure that all hardware is secure and tight.

In order to protect your bars/boards, please use only mild soap/non-abrasive products for cleaning.