

iArmor®

IARMOR EDGE™

PART#: IA-W975

BEFORE INSTALLATION

REMOVE CONTENTS FROM BOX. VERIFY ALL PARTS ARE PRESENT. READ INSTRUCTIONS CAREFULLY BEFORE STARTING INSTALLATION. ASSISTANCE IS RECOMMENDED. THANK YOU FOR CHOOSING OUR PRODUCT!

***ROCKER PANEL MOUNT**

***DRILLING NOT REQUIRED / CUTTING IS REQUIRED**

Torque Value

Fastener Size	Tightening Torque (ft-lbs)	Required
6mm	6-7	√
8mm	16-18	X
10mm	31-32	√
12mm	56-58	X
14mm	92-94	X

PART LIST

Front
↑

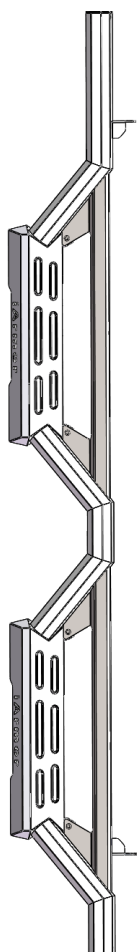

Driver Side Step Bar

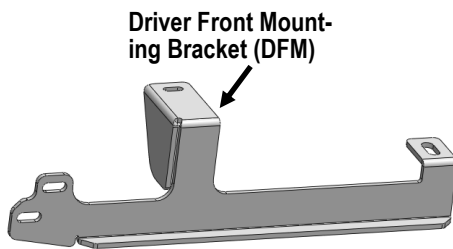

Driver Front Mounting Bracket (DFM)

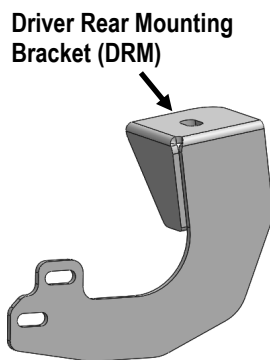

Driver Rear Mounting Bracket (DRM)

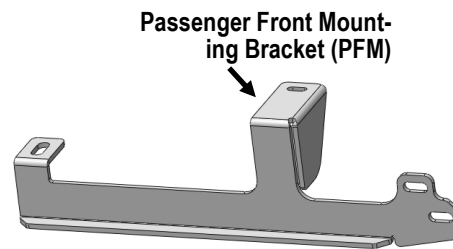

Passenger Front Mounting Bracket (PFM)

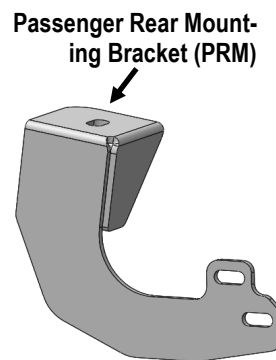

Passenger Rear Mounting Bracket (PRM)

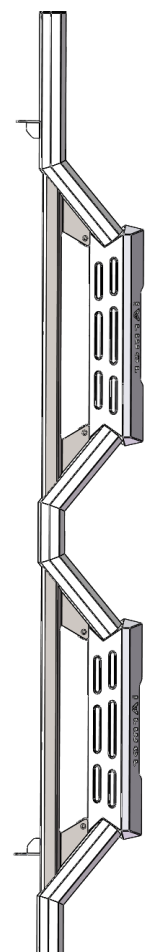

Passenger Side Step Bar

Customer Support: info@iarmorauto.com

iArmor[®]

Hardware Package (For Brackets & Step Bars Installation)

Item	QTY	Description	Item	QTY	Description
1#	2	M6X1 Nut Plate	8#	2	M6X1-30 Hex Bolts
2#	2	M10X50 T Block Bolt	9#	2	M6 Extra Large Flat Washers
3#	2	M10X35 Bolt Plate	10#	2	M6 Lock Washers
4#	2	M10 Extra Large Flat Washers	11#	8	M10X1.5-25 Hex Bolts
5#	2	M10 Large Flat Washers	12#	16	M10 Flat Washers
6#	4	M10 Lock Washers	13#	8	M10X1.5 Nylon Lock Nuts
7#	4	M10X1.5 Hex Nuts			



1#



2#

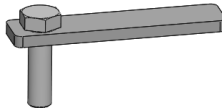

3#



4#



5#



6#



7#



8#



9#



10#



11#



12#

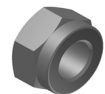

13#

iArmor®

The instruction here is for your reference only. We strongly recommend the professional installer for best result. We are not responsible for any damage caused by the installation.

STEP 1

Start installation from the driver side of the vehicle. Remove the front and middle section of the plastic splash guard, (Fig 1). Place the splash guard on a clean, stable work surface.

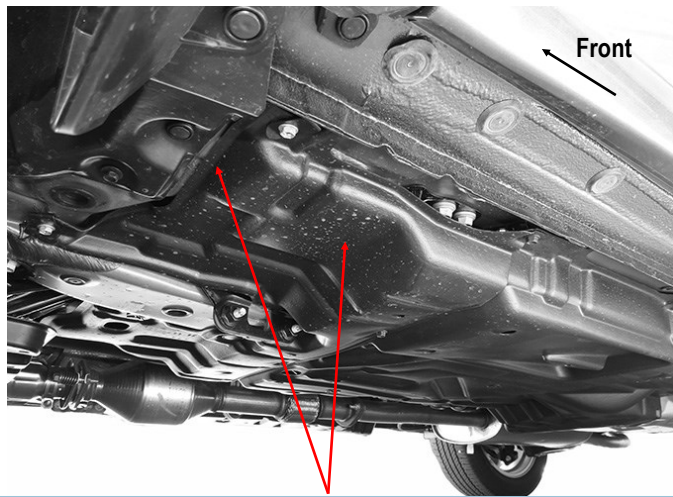

(Fig 1) Temporarily Remove The Driver Side Front And Middle Plastic Splash Guard

STEP 2

Move to the driver side front mounting location (Fig 2). Remove the rubber plug if equipped from the hole closest to the tie down loop. Insert (1) M10 Bolt Plate into the factory hole, (Fig 3).

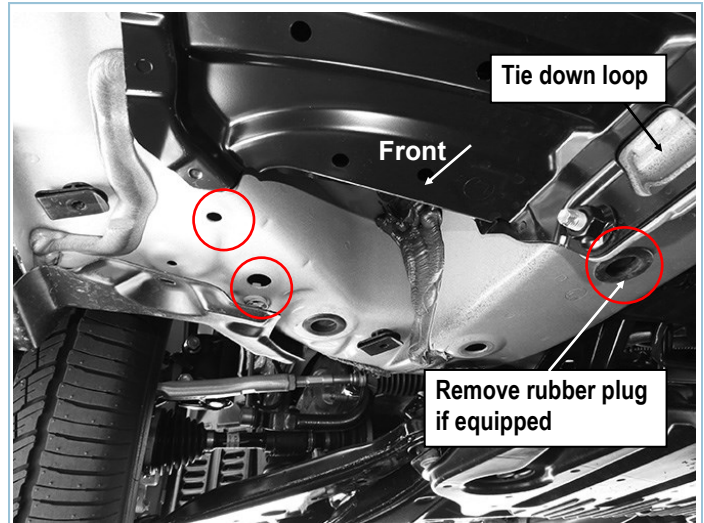

(Fig 2) Driver Side Front Mounting Location

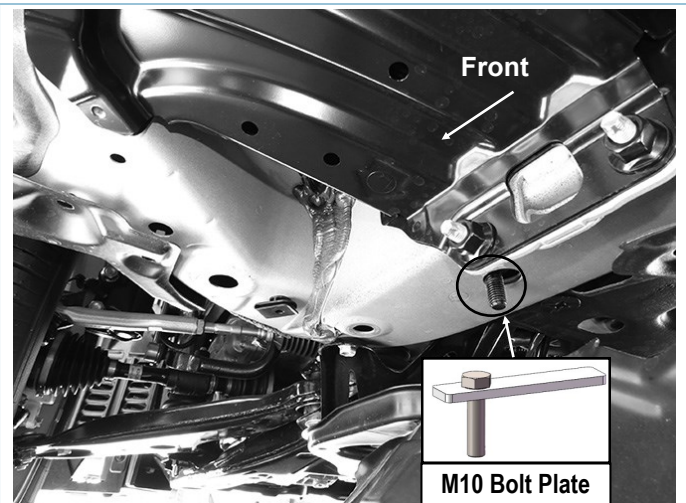

(Fig 3) M10 Bolt Plate Installed
(On Driver Side Front Mounting Location)

STEP 3

Next, select the Driver Front Mounting Bracket (DFM). Attach the Bracket to the installed M10 Bolt Plate with (1) M10 Large Flat Washer, (1) M10 Lock Washer and (1) M10 Hex Nut, (Fig 4). Do not fully tighten hardware at this time.

iArmor®

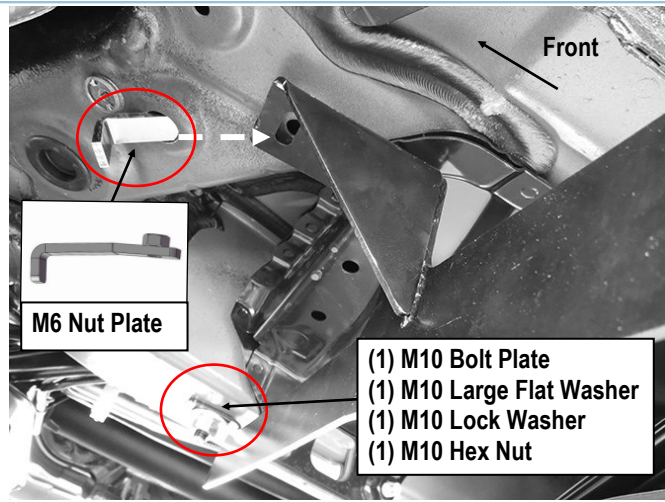

(Fig 4) Driver Front Mounting Bracket Installation

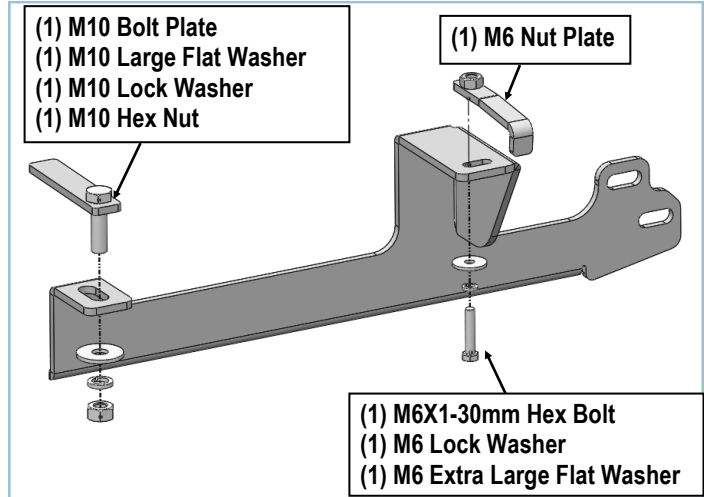

(Fig 6) Driver Front Mounting Bracket Installation

STEP 4

Line up the mounting tab on the Driver Front Mounting Bracket with the factory hole on the frame rail, (Figs 2 & 4). Insert (1) M6 Nut Plate into the larger inner hole and line up the welded nut on the nut plate with the mounting hole on the mounting bracket, (Figs 4 & 5).

Note: The Welded Nut on the Nut Plate should face up.

Secure the Mounting Bracket to the Nut Plate with (1) M6X1-30mm Hex Bolt, (1) M6 Lock Washer and (1) M6 Large Flat Washer, (Fig 6). Do not fully tighten hardware at this time.

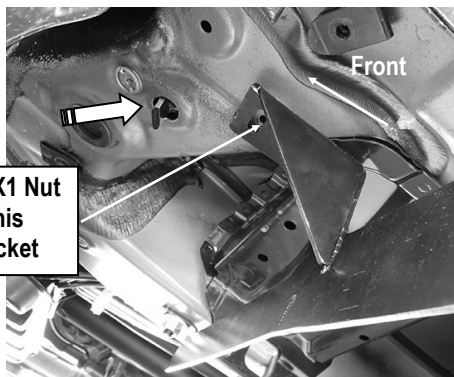

(Fig 5) M6X1 Nut Plate Installation
(On Driver Side Front Mounting Location)

STEP 5

Mark the outline of the location of the Driver Front Mounting Bracket (DFM) onto the bottom of the vehicle for reference if necessary. Temporarily remove the Driver Front Mounting Bracket. Hold the plastic Splash Guard up in approximate location against the vehicle. Trace the location of the Bracket onto the plastic Splash Guard. Use a hack saw or utility knife to cut out an opening 2" x 3-1/2" on the middle splash guard as pictured, (Fig 8). Cut a 1-1/2" x 1-1/2" opening in the front splash guard, (Fig 7).

IMPORTANT: The trimming area on the plastic splash guard will be varied on different model/years. Suggest hold up the brackets in position to verify the trimming area before cutting the splash guards. Try to cut as little as possible on the splash guard. Reinstall the splash guards using the factory fasteners.

iArmor®

Cut plastic splash guard to clear the bent end of 6mm Nut Plate as necessary (The splash guard may be varied on different model/year).

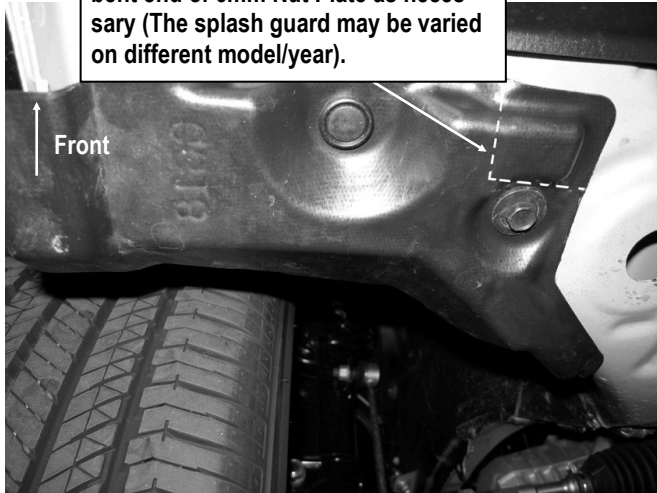

(Fig 7) Driver Side Front Plastic Splash Guard Trimming

Cut to clear mounting tab on front Bracket as necessary (The splash guard may be varied on different model/year). Remove front Bracket to reinstall the plastic splash guards.

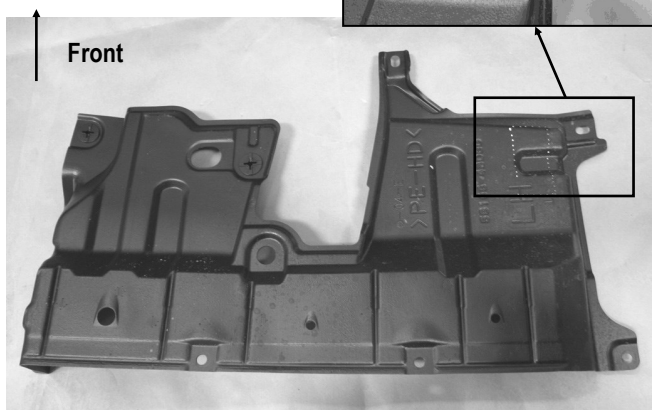
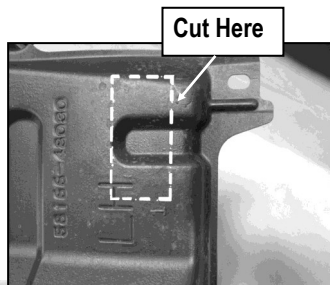

(Fig 8) Driver Side Middle Plastic Splash Guard Trimming

STEP 6

Reinstall the front Bracket as described in **Steps 3—4**. Do not fully tighten hardware at this time.

STEP 7

Next, move to the driver side rear mounting location (**Fig 9**). Remove the rubber plug if equipped. Insert (1) M10X50 T Block Bolt into the factory hole, (**Fig 10**).

NOTE: Rotate the T Block Bolt to 90-degrees to across the oval hole, (**Fig 10**).



(Fig 9) Driver Side Rear Mounting Location

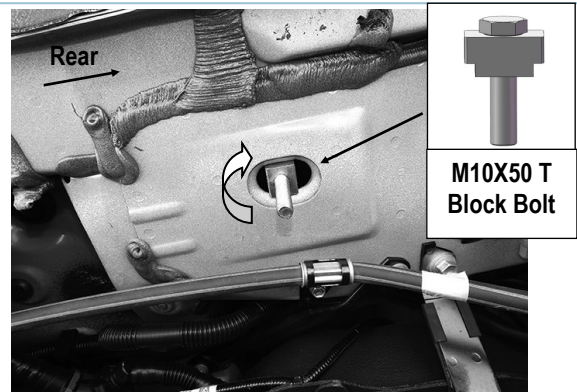

(Fig 10) M10 T Block Bolt Installed

iArmor®

STEP 8

Select the Driver Rear Mounting Bracket (**DRM**). Attach to the installed M10 T Block Bolt with the (1) M10 Extra Large Flat Washer, (1) M10 Lock Washer and (1) M10 Hex Nut, (**Fig 11**). Do not fully tighten hardware at this time.

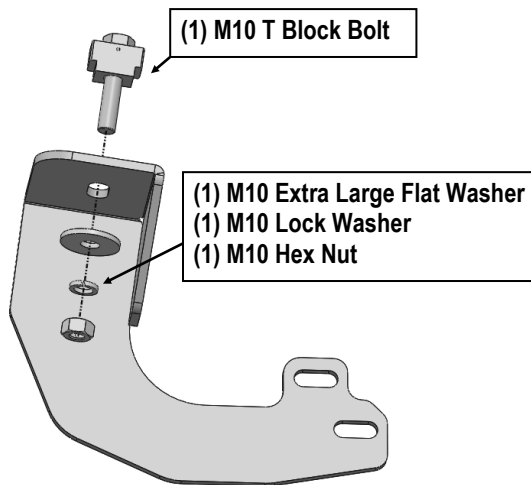

(Fig 11) Driver Front Mounting Bracket Installation

STEP 9

Once all (2) Mounting Brackets have been installed, attach the Driver Side Step Bar to the Mounting Brackets with (4) M10X1.5-25 Hex Bolts, (8) M10 Flat Washers and (4) M10X1.5 Nylon Lock Nuts, (**Fig 12**). Do not fully tighten hardware at this time.

STEP 10

Properly level and adjust the Step Bar and fully tighten all hardware.

STEP 11

Move to the other side of the vehicle. Repeat **Steps 1-10** for the other Side Step Bar installation.

Attention

Do periodic inspections to the installation to make sure that all hardware is secure and tight.

In order to protect your bars/boards, please use mild soap/non-abrasive products for cleaning only.

iArmor[®]

