

## IARMOR EDGE™

PART#: IA-W093

### BEFORE INSTALLATION

REMOVE CONTENTS FROM BOX. VERIFY ALL PARTS ARE PRESENT. READ INSTRUCTIONS CAREFULLY BEFORE STARTING INSTALLATION. ASSISTANCE IS RECOMMENDED. THANK YOU FOR CHOOSING OUR PRODUCT!

\*ROCKER PANEL MOUNT

\*DRILLING/TRIMMING NOT REQUIRED

### Torque Value

Fastener Size	Tightening Torque (ft-lbs)	Required
6mm	6-7	X
8mm	16-18	X
10mm	31-32	√
12mm	56-58	√
14mm	92-94	X

### PART LIST

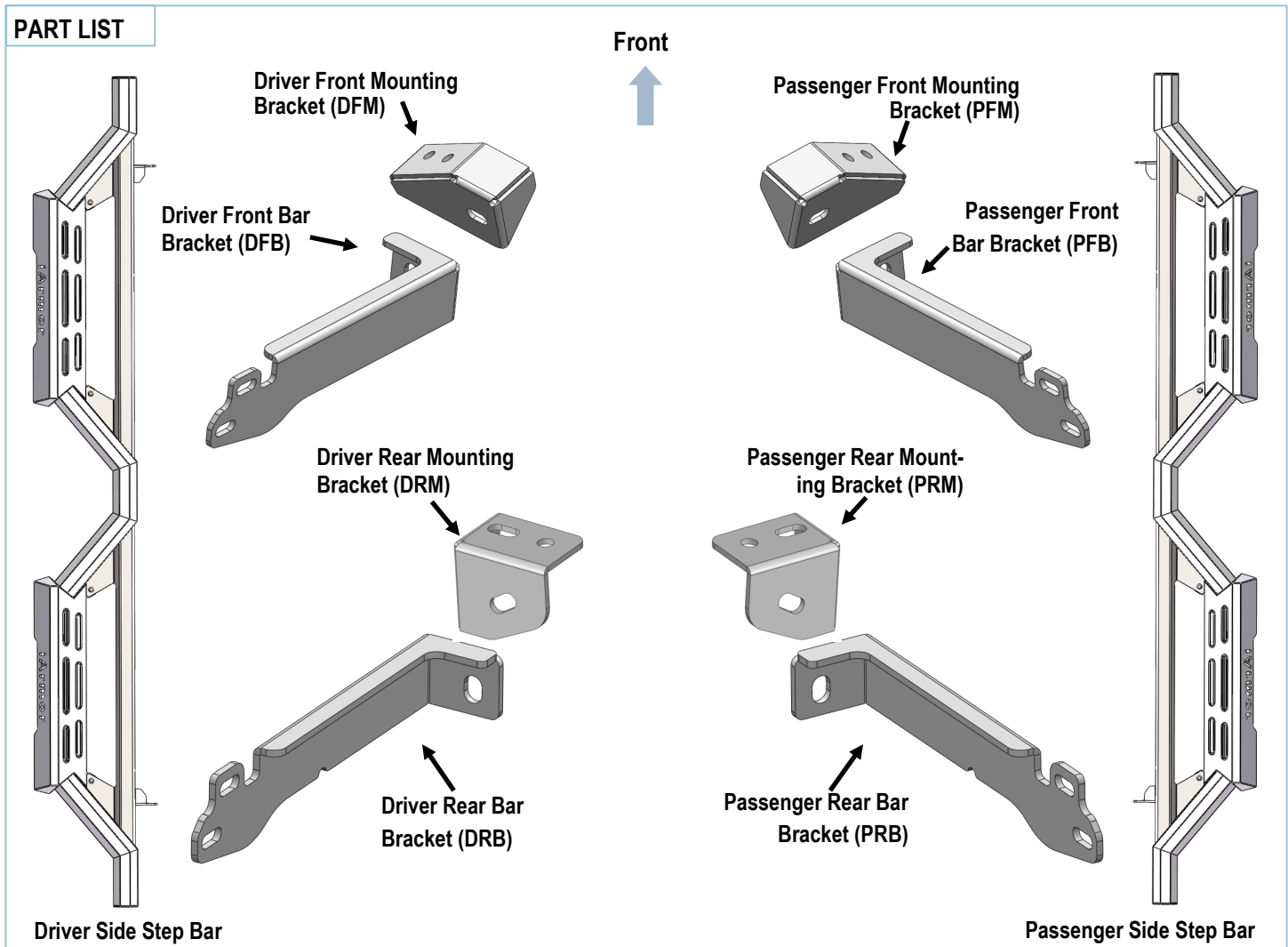

# iArmor<sup>®</sup>

## Hardware Package (For Brackets & Step Bars Installation)

Item	QTY	Description	Item	QTY	Description
1#	4	Backing Plates	6#	4	M12X1.75 Hex Nuts
2#	4	M12X1.75-35 Hex Bolts	7#	8	M10X1.5-25 Hex Bolts
3#	8	M12X1.75-30 Hex Bolts	8#	16	M10 Flat Washers
4#	16	M12 Large Flat Washers	9#	8	M10X1.5 Nylon Lock Nuts
5#	12	M12 Lock Washers			

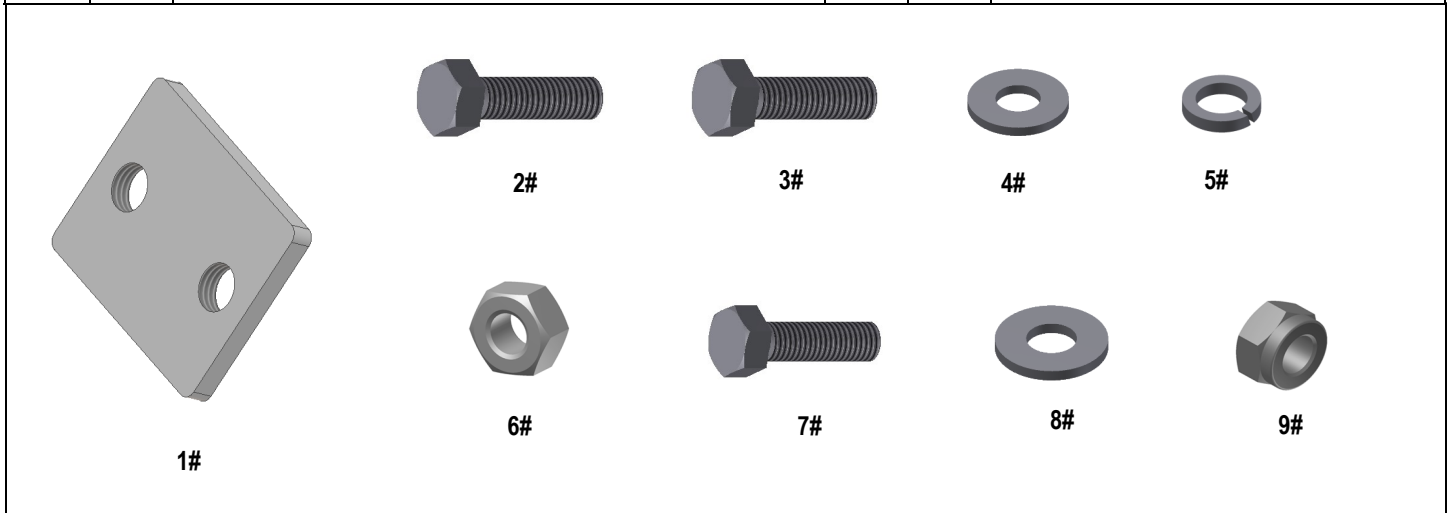

# iArmor®

The instruction here is for your reference only. We strongly recommend the professional installer for best result. We are not responsible for any damage caused by the installation.

## STEP 1

Start installation from the driver side front of the vehicle. Assemble the Driver Front Mounting Bracket (**DFM**) and Driver Front Bar Bracket (**DFB**) with (1) M12X1.75-35 Hex Bolt, (2) M12 Large Flat Washers, (1) M12 Lock Washer and (1) M12X1.75 Hex Nut (**Fig 1**). Do not fully tighten hardware at this time.

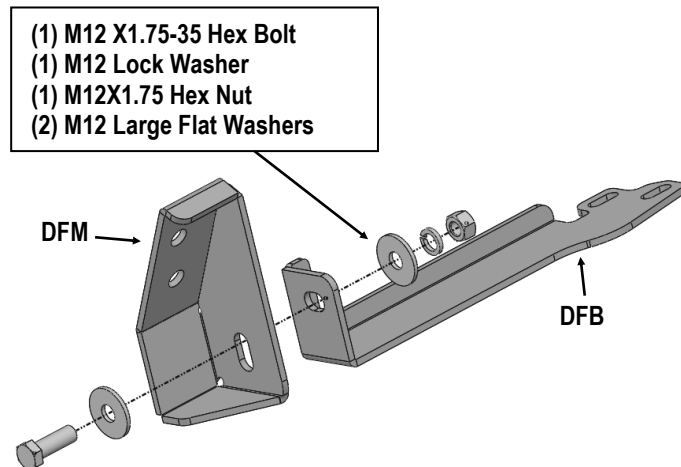

(Fig 1) Driver Side Front Brackets Assembly

## STEP 2

Select (1) Backing Plate and put it behind the frame, line up the holes, attach (1) Driver Front Mounting Bracket (**DFM**) on the other side of the frame with (2) M12X1.75-30 Hex Bolts, (2) M12 Lock Washers and (2) M12 Large Flat Washers. Do not fully tighten hardware at this time, (**Figs 2&3**).

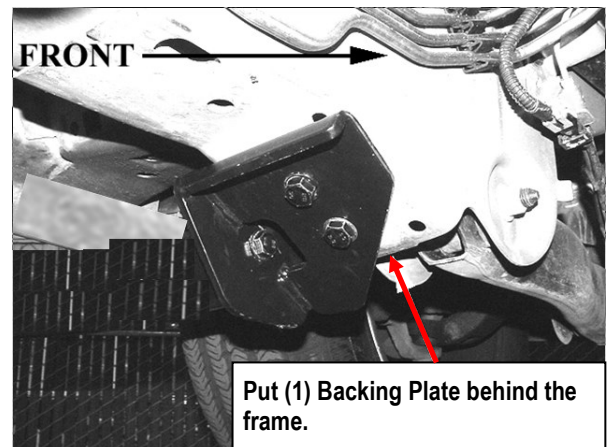

(Fig 2) Example of Driver Front Mounting Bracket Installed

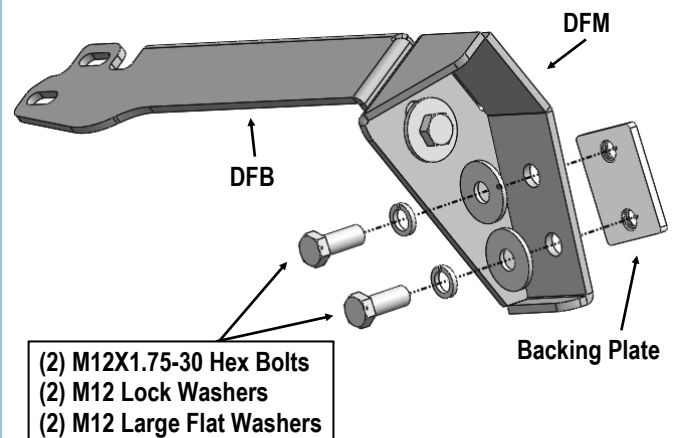

(Fig 3) Assembled Driver Front Mounting Bracket Installation

## STEP 3

Move to the Driver Side Rear Mounting Location. Assemble the Driver Rear Mounting Bracket (**DRM**) and Driver Rear Bar Bracket (**DRB**) with (1) M12X1.75-35 Hex Bolt, (2) M12 Large Flat Washers, (1) M12 Lock Washer and (1) M12X1.75 Hex Nut, (**Fig 4**). Do not fully tighten hardware at this time.

# iArmor®

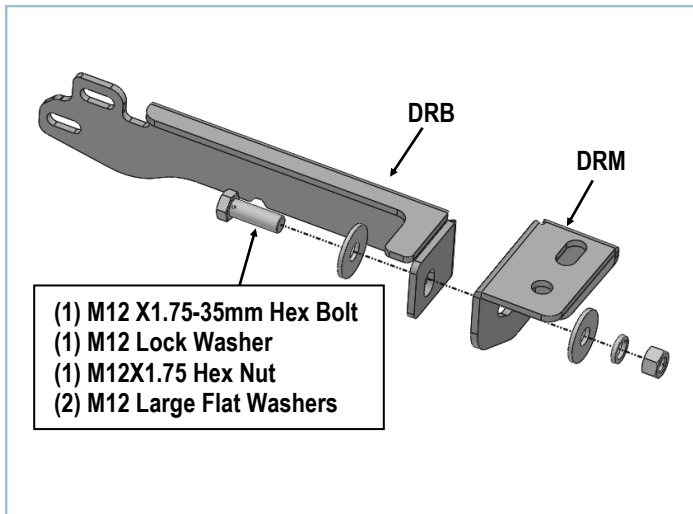

(Fig 4) Driver Rear Mounting Brackets Assembly

## STEP 4

Repeat **Step 2** to install the Assembled Driver Rear Mounting Bracket. Do not fully tighten hardware at this time, (Figs 5-6).

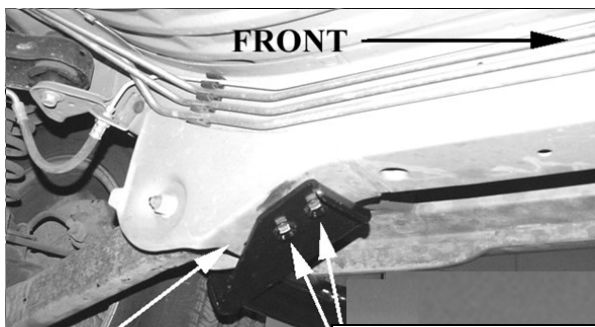

Place (1) Backing Plate behind the frame to attach the mounting bracket.

(2) M12 X1.75-30 Hex Bolts  
(2) M12 Lock Washers  
(2) M12 Flat Washers

(Fig 5) Example of Assembled Driver Rear Mounting Bracket Installed

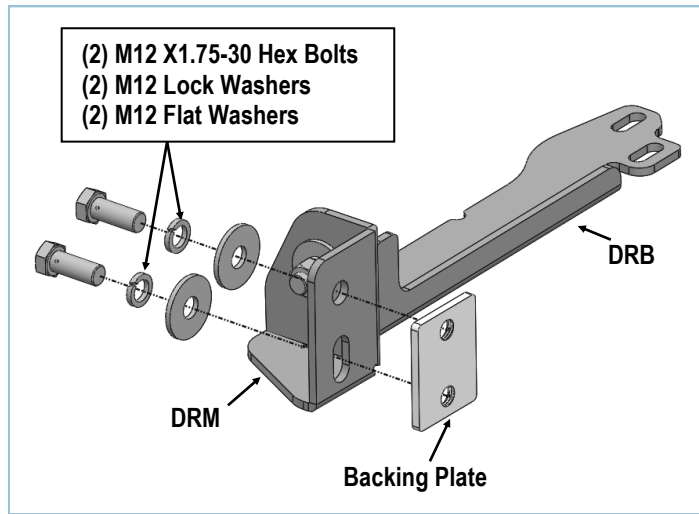

(Fig 6) Driver Rear Mounting Bracket Installation

## STEP 5

Once all (2) Mounting Brackets have been installed, attach the Driver Side Step Bar to the Mounting Brackets with (4) M10X1.5-25 Hex Bolts, (8) M10 Flat Washers and (4) M10X1.5 Nylon Lock Nuts, (Fig 7). Do not fully tighten hardware at this time.

## STEP 6

Properly level and adjust the Step Bar and fully tighten all hardware.

## STEP 7

Move to the other side of the vehicle. Repeat **Steps 1-6** for the other Side Step Bar installation.

# iArmor®

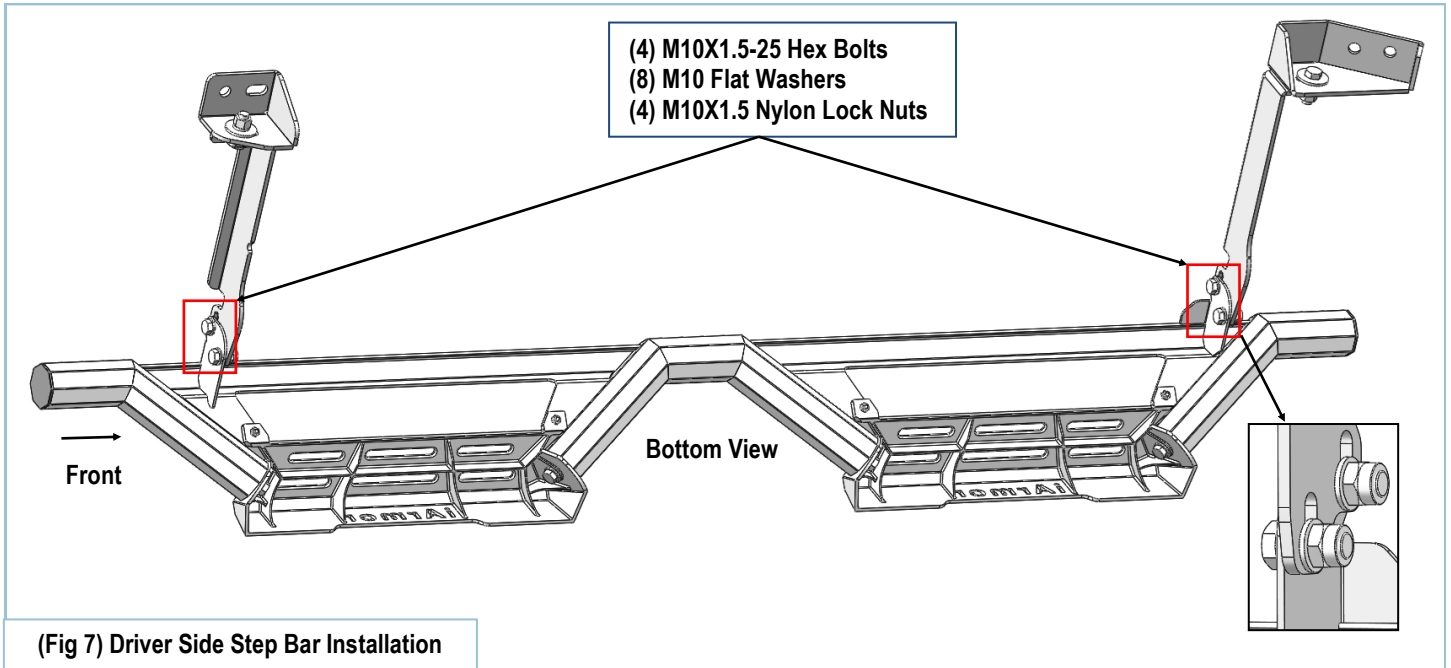

(Fig 7) Driver Side Step Bar Installation

## Attention

Do periodic inspections to the installation to make sure that all hardware is secure and tight.  
In order to protect your bars/boards, please use mild soap/non-abrasive products for cleaning only.