

# iArmor®

## IARMOR EDGE™

PART#: IA-N219H

### BEFORE INSTALLATION

REMOVE CONTENTS FROM BOX. VERIFY ALL PARTS ARE PRESENT. READ INSTRUCTIONS CAREFULLY BEFORE STARTING INSTALLATION. ASSISTANCE IS RECOMMENDED. THANK YOU FOR CHOOSING OUR PRODUCT!

\*ROCKER PANEL MOUNT

\*DRILLING NOT REQUIRED

### Torque Value

Fastener Size	Tightening Torque (ft-lbs)	Required
6mm	6-7	√
8mm	16-18	√
10mm	31-32	√
12mm	56-58	X
14mm	92-94	X

### PART LIST

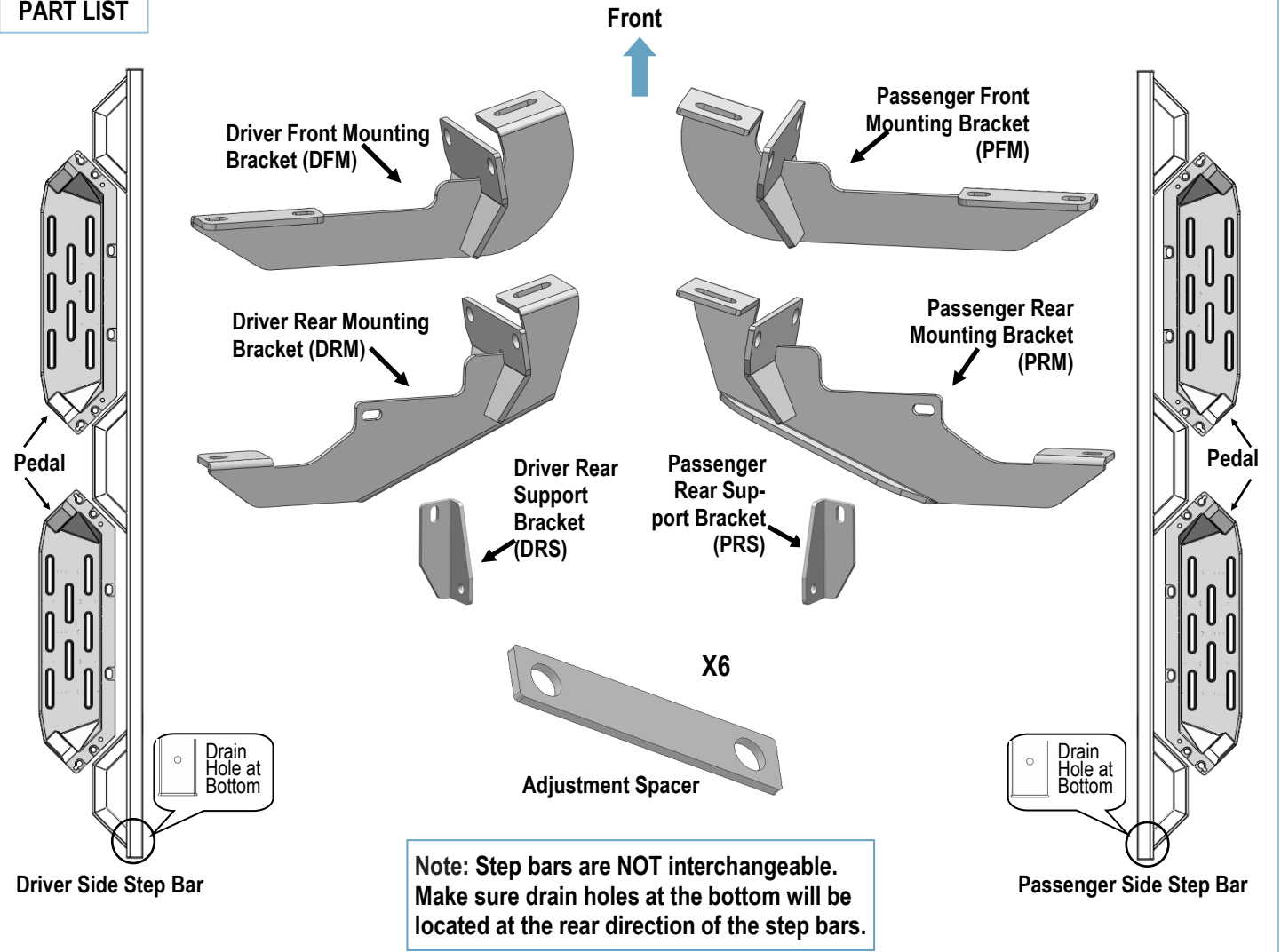

Customer Support: [info@iarmorauto.com](mailto:info@iarmorauto.com)

# iArmor®

Hardware Package A (For Brackets & Bars Installation)					
Item	QTY	Description	Item	QTY	Description
1#	4	M10 Bolt Plates	7#	2	M6X1-20 Square Head Bolts
2#	4	M10 Large Flat Washers	8#	2	M6 Large Flat Washers
3#	4	M10 Nylon Lock Nuts	9#	2	M6 Nylon Lock Nuts
4#	10	M8X1.25-35 Hex Bolts	10#	6	M8X1.25-20 T-Bolts
5#	26	M8 Large Flat Washers	11#	6	M8 Plastic Washers
6#	16	M8 Nylon Lock Nuts			

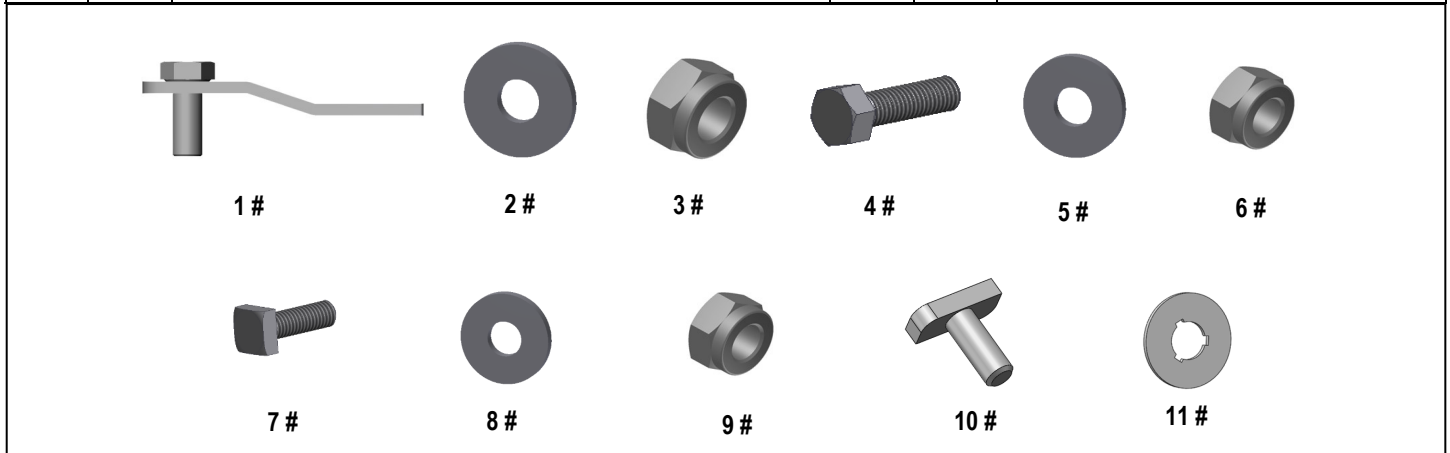

Hardware Package B (For Step Pedals Installation)					
Item	QTY	Description	Item	QTY	Description
1#	24	M8X1.25-25 Hex Bolts	3#	24	M8 Lock Washers
2#	24	M8 Large Flat Washers			

1# 2# 3#

Customer Support: [info@iarmorauto.com](mailto:info@iarmorauto.com)

# iArmor®

The instruction here is for your reference only. We strongly recommend the professional installer for best result. We are not responsible for any damage caused by the installation.

## STEP 1

Install (4) Pedals onto the step bars with (24) M8X1.25-25mm Hex Bolts, (24) M8 Large Flat Washers and (24) M8 Lock Washers.

**IMPORTANT:** Don't punch the pedal with any metal hammer within pedal installation, or the pedal will be damaged.

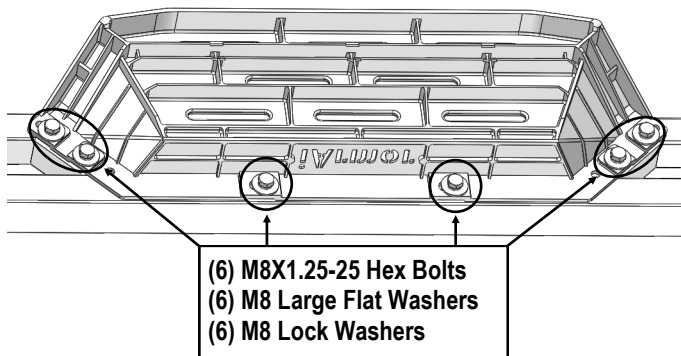

## STEP 2

Start installation at passenger side front. Insert (1) M10 Bolt Plate into the rectangular hole and out the round hole in the bottom of the side panel, (Fig 1).

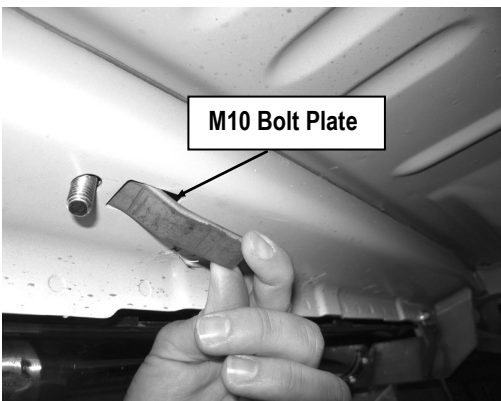

(Fig 1) Insert M10 Bolt Plate at the Passenger Front Location

## STEP 3

Select (1) Passenger Front Mounting Bracket (**PFM**), attach it to the M10 Bolt Plate with included (1) M10 Flat Washer and (1) M10X1.5 Nylon Lock Nut, (Fig 2).

**NOTE:** Make sure that the mounting tab on the Bracket is on the outside of the pinch weld. Line up the (2) holes in the Bracket with the factory holes in the pinch weld. Attach the Bracket to the pinch weld using the included (2) M8X1.25-35 Hex Bolts, (4) M8 Large Flat Washers and (2) M8X1.25 Nylon Lock Nuts, (Fig 2). Do not fully tighten at this time.

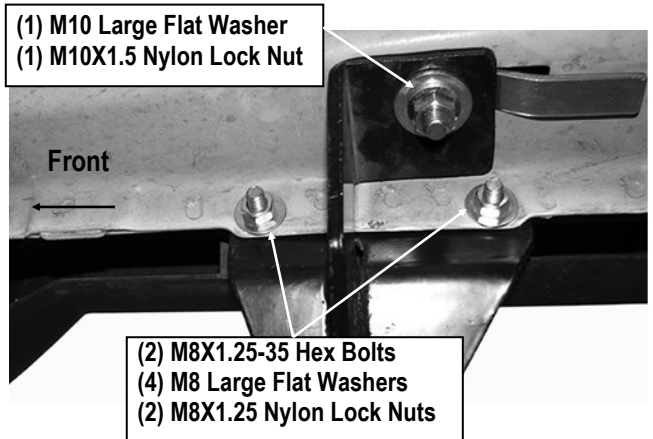

(Fig 2) Passenger Front Mounting Bracket Installed

## STEP 4

Select Passenger Rear Support Bracket (**PRS**), attach it to the Passenger Rear Mounting Bracket (**PRM**) with (1) M8X1.25-35 Hex Bolt, (2) M8 Large Flat Washers, and (1) M8X1.25 Nylon Lock Nut, (Fig 3). Leave the hardware loose at this time.

# iArmor®

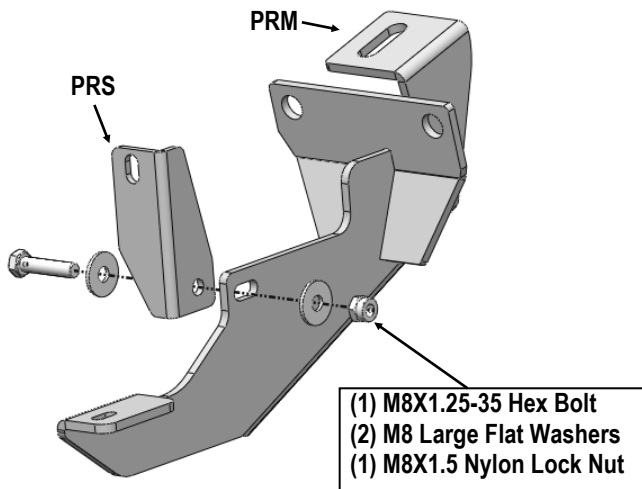

(Fig 3) Passenger Rear Mounting Bracket Assembly

## STEP 5

Move to the passenger Side Rear Mounting Location, repeat **Steps 2-3** to insert (1) M10 Bolt Plate, and assembled Passenger Rear Mounting Bracket (**PRM**), (**Fig 4**). Do not fully tighten at this time.

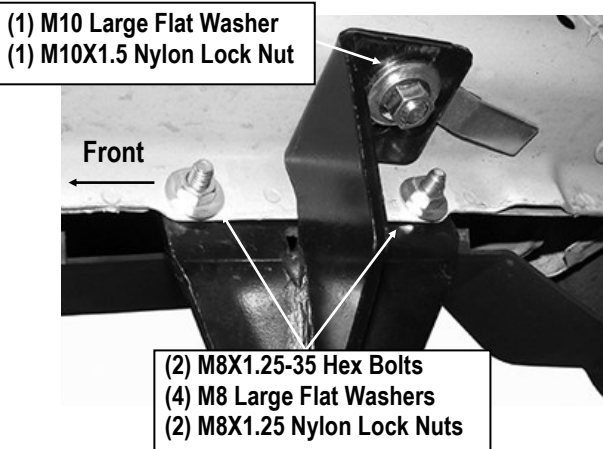

(Fig 4) Passenger Rear Mounting Bracket Installed

## STEP 6

Once all (2) brackets have been installed, select (3) M8X1.25-20mm T-Bolts, thread (1) M8 Plastic Washer on each T-Bolt, (**Fig 5**). Install the (3) M8X1.25-20mm T-Bolts with plastic washers in the slots on the assembled step bar. Rotate the T-Bolts to 90 degree, thread down the M8 Plastic Washers against the step bar (**Fig 6**).

**NOTE:** The Plastic Washer is designed to keep the T-Bolt in place to avoid falling into the tube during installation.

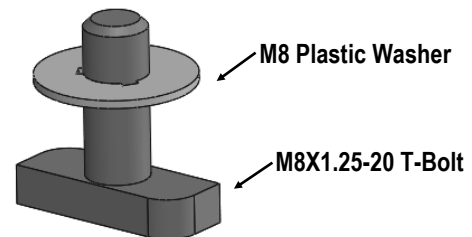

(Fig 5) Thread (1) M8 Plastic Washer on each T-Bolt Before Inserting into the slot !!!

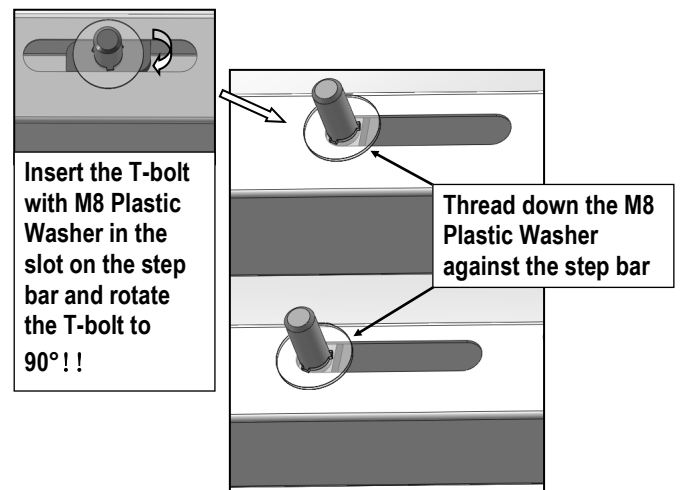

(Fig 6) T-Bolt with plastic washer in the slot

# iArmor®

## STEP 7

Attach the Assembled Passenger Side Step Bar onto the Mounting Brackets with (3) M8 Plastic Washers, (3) M8X1.25-20mm T-Bolts, (3) M8 Large Flat Washers, (3) M8 Nylon Lock Nuts, (Fig 7). Do not fully tighten hardware at this time.

**NOTE:** Passenger Rear Mounting Bracket is located under (1) pedal. Slide (1) M6X1-20mm Square Head Bolt into the channel at the bottom of pedal (Fig 8). And secure the Passenger Rear Mounting Bracket to pedal with (1) M6 Large Flat Washer and (1) M6 Nylon Lock Nut, (Fig 7). Do not fully tighten hardware at this time.

Adjustment Spacers

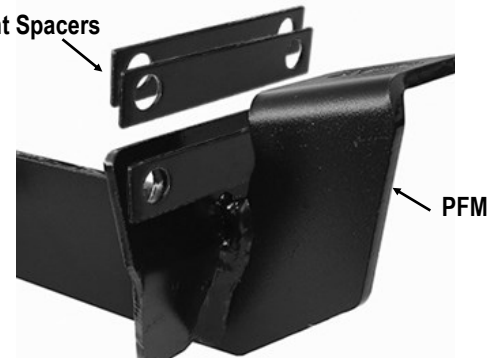

(Fig 9) Adjustment Spacers between Vehicle Pinch Weld and Mounting Bracket

## STEP 8

Depending on the model and year of the vehicle, the front of the running board may be too close (or interfering) with front factory flare. If necessary, insert 1 to 3 Adjustment Spacers between the Bracket and the pinch weld to adjust the side bar on a properly position, (Fig 9).

## STEP 9

Level and adjust the assembled Step Bar properly and tighten all hardware.

Move to the other side of the vehicle. Repeat Steps 2-8 for the other Side Step Bar installation.

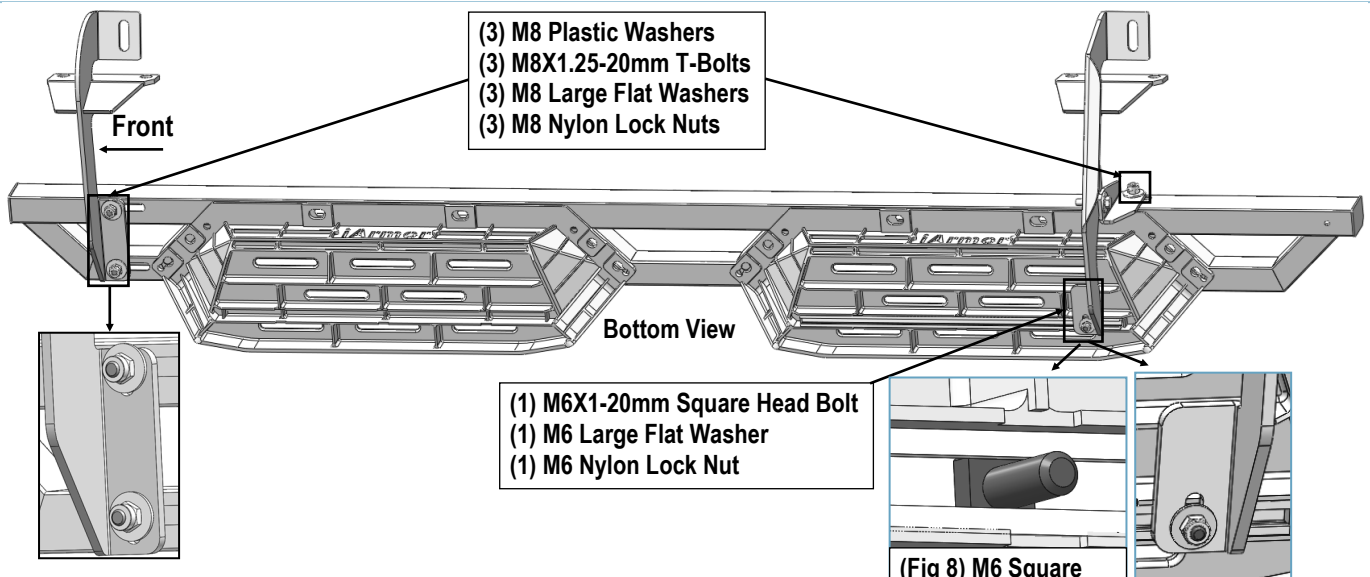

(Fig 7) Passenger Side Step Bar Installation

(Fig 8) M6 Square Bolt in the Channel

### Attention

Do periodic inspections to the installation to make sure that all hardware is secure and tight. In order to protect your bars/boards, please use mild soap/non-abrasive products for cleaning only.

Customer Support: [info@iarmorauto.com](mailto:info@iarmorauto.com)