

# iArmor®

## IARMOR EDGE™

PART#: IA-N212

### BEFORE INSTALLATION

REMOVE CONTENTS FROM BOX. VERIFY ALL PARTS ARE PRESENT. READ INSTRUCTIONS CAREFULLY BEFORE STARTING INSTALLATION. ASSISTANCE IS RECOMMENDED. THANK YOU FOR CHOOSING OUR PRODUCT!

\*ROCKER PANEL MOUNT

\*DRILLING/TRIMMING NOT REQUIRED

### Torque Value

Fastener Size	Tightening Torque (ft-lbs)	Required
6mm	6-7	√
8mm	16-18	√
10mm	31-32	X
12mm	56-58	X
14mm	92-94	X

### PART LIST

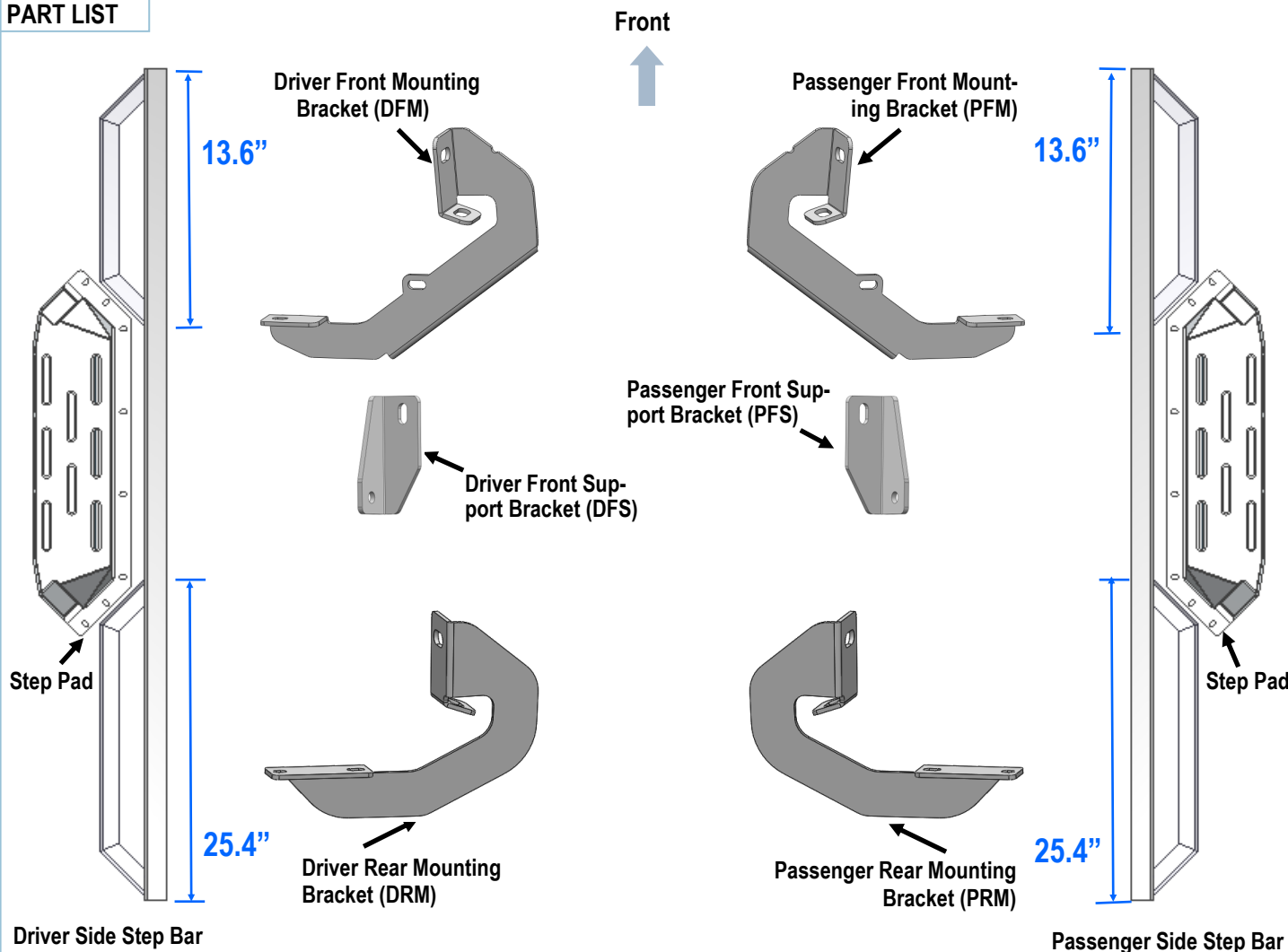

Customer Support: [info@iarmorauto.com](mailto:info@iarmorauto.com)

# iArmor<sup>®</sup>

Hardware Package					
Item	QTY	Description	Item	QTY	Description
1#	4	M8X1.25-30mm Hex Bolts	7#	4	M8 Clip Nuts
2#	6	M8X1.25-25mm Hex Bolts	8#	20	M6X1-20mm T-Bolts
3#	4	M8 Large Flat Washers	9#	4	M6X1-20mm Square Head Bolts
4#	12	M8 Flat Washers	10#	24	M6 Large Flat Washers
5#	10	M8 Lock Washers	11#	24	M6X1 Nylon Lock Nuts
6#	6	M8X1.25 Hex Nuts			

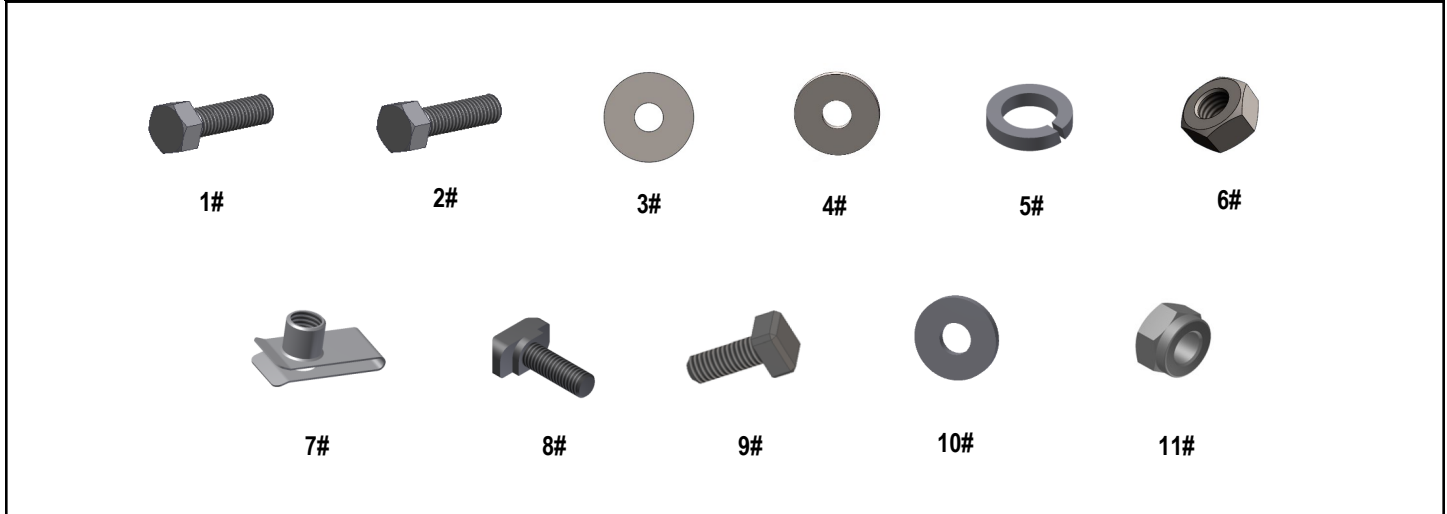

# iArmor®

The instruction here is for your reference only. We strongly recommend the professional installer for best result. We are not responsible for any damage caused by the installation.

## STEP 1

Install the Step Pads onto the step bars with (16) M6X1-20mm T-Bolts, (16) M6 Large Flat Washers and (16) M6X1 Nylon Lock Nuts.

**IMPORTANT:** Don't hit the step pad with any metal hammer within step pad installation, or the step pad will be damaged.

- (8) M6X1-20 T-Bolts
- (8) M6 Large Flat Washers
- (8) M6 Nylon Lock Nuts

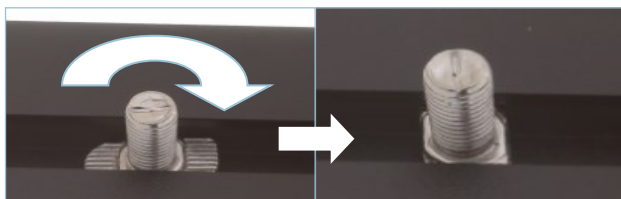

**Note: Rotate 90° after inserting the T-Bolts into the Channel!!!**

## STEP 2

Assemble following mounting brackets and support brackets together with (2) M8X1.25-25mm Hex Bolts, (4) M8 Flat Washers, (2) M8 Lock Washers and (2) M8 Hex Nuts:

- (1) Driver Front Mounting Bracket (DFM) & Driver Front Support Bracket (DFS) (Fig 1).
- (2) Passenger Front Mounting Bracket (PFM) & Passenger Front Support Bracket (PFS) (Fig 2).

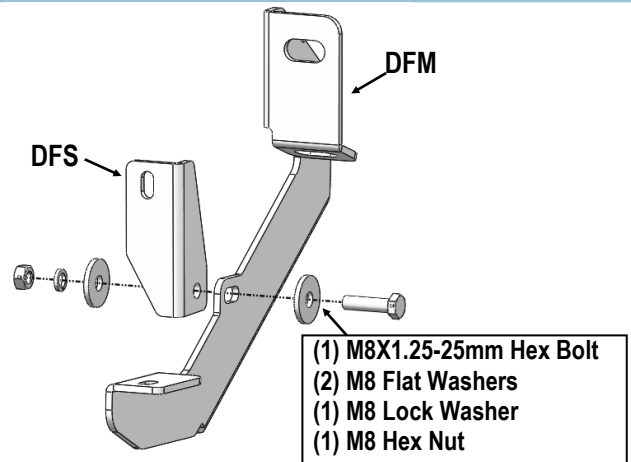

(Fig 1) Driver Front Brackets Assembly

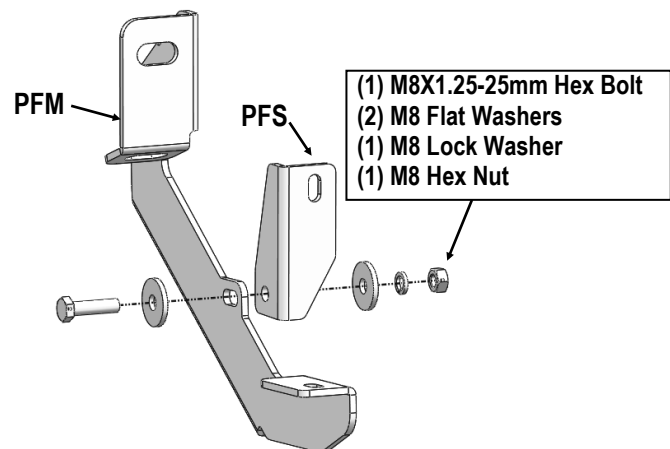

(Fig 2) Passenger Front Brackets Assembly

# iArmor®

## STEP 3

Starting on the driver side of the vehicle, locate the (2) holes on the pinch weld, (**Fig 3**). And then locate the rectangular opening and (2) small holes on the inner body panel directly above the holes on the pinch weld, (**Figs 3&4**). Only (1) hole on the pinch weld and (1) small hole on the inner body panel will be used. It will be helpful for Identifying the mounting locations by holding up Brackets in place.

**NOTE:** The holes on the inner panel may be covered with sealing tape or insulation, remove sealing tape if equipped.

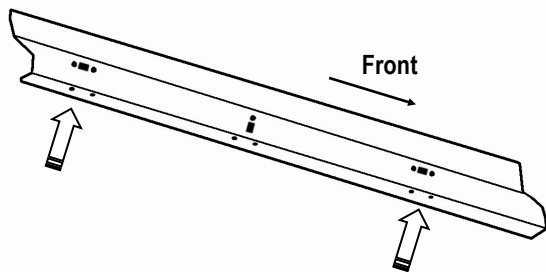

(Fig 3) Driver Side Mounting Locations

## STEP 4

Slide (1) M8 Clip Nut into the rectangular opening with the nut towards the inside. Line up the threaded nut on the clip with the round hole, (**Fig 4**).

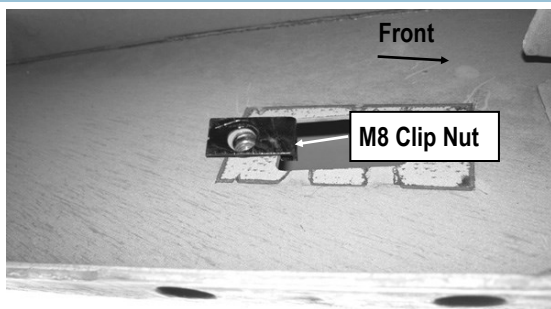

(Fig 4) M8 Clip Nuts Installed  
(On Driver Side Front Mounting Location)

## STEP 5

Attach the Assembled Driver Side Front Mounting Bracket to the installed M8 Clip Nuts with the included (1) M8X1.25-30mm Hex Bolt, (1) M8 Lock Washer and (1) M8 Large Flat Washer, (**Figs 5**). Do not fully tighten hardware at this time.

**Note:** Depending on model/year, the brake cable may be run on the inside or outside of the Bracket.

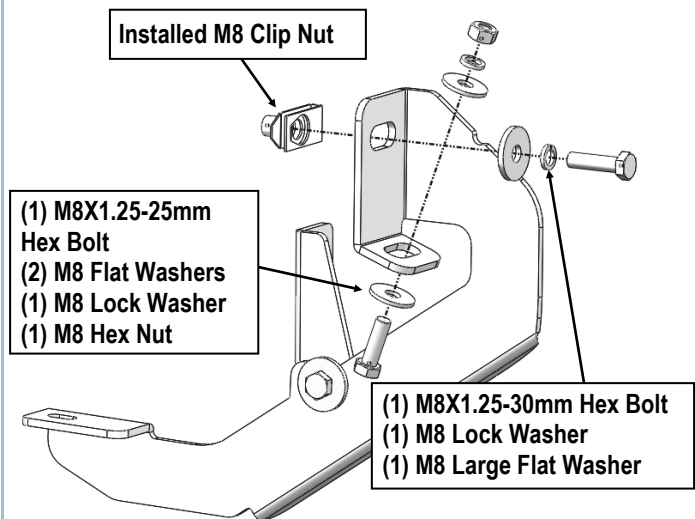

(Fig 5) Driver Side Front Mounting Bracket Installation

## STEP 6

Align the bottom holes of the Driver Front Mounting Bracket with the (1) hole on the pinch weld. Bolt the Bracket to the pinch weld using the included (1) M8X1.25-25mm Hex Bolt, (2) M8 Flat Washers, (1) M8 Lock Washer and (1) M8 Hex Nut, (**Fig 5**).

**NOTE:** Insert the bolts up from the bottom of the pinch weld and through the Bracket. Do not fully tighten hardware at this time.

# iArmor®

## STEP 7

Move to the Driver Side Rear Mounting Location. Locate the mounting holes on the body panel and pinch weld, **(Fig 3)**. Repeat **Steps 4-6** for Driver Rear Mounting Bracket installation **(Fig 6)**. Do not fully tighten hardware at this time.

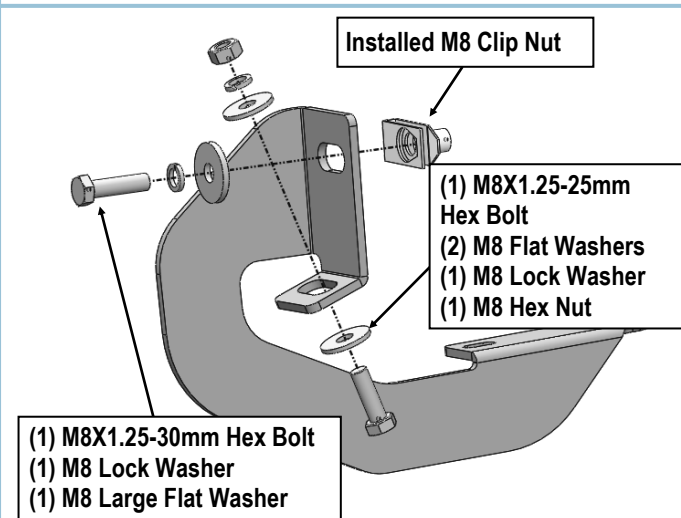

**(Fig 6) Driver Side Rear Mounting Bracket Installation**

## STEP 8

Once all (2) Driver side mounting brackets are installed, attach the assembled Passenger Side Bar to the Mounting Brackets with (2) M6X1-20 T-Bolts, (2) M6X1-20mm Square Head Bolts, (4) M6 Large Flat Washers and (4) M6X1 Nylon Lock Nuts, **(Fig 7)**. Do not fully tighten hardware at this time.

## STEP 9

Properly level and adjust the Step Bar and fully tighten all hardware.

## STEP 10

Move to the driver side of the vehicle. Repeat **Steps 1-9** to install driver side step bar.

### Attention

**Do periodic inspections to the installation to make sure that all hardware is secure and tight.**

**In order to protect your bars/boards, please use mild soap/non-abrasive products for cleaning only.**

# iArmor®

(Fig 7) Driver Side Step Bar Installation

