



Hitch Installation Instruction

REV.20240801

Part#	HT-X38920	Application	For 2005-2010 Chrysler 300 ALL\2005-2008 Dodge Magnum ALL\2006-2010 Dodge Challenger ALL
-------	-----------	-------------	--

Hardware List	Item	Part Name	QTY	Description	Item	Part Name	QTY	Description
Hitch Parts	A	Hitch Body	1		B/C	Mounting Brackets	2	B-Driver Side C-Passenger Side
HW B (For Hitch Installation)	1#	Fishwire	1		4#	Hex Flange Nuts	3	M12X1.75
	2#	Hex Bolts	3	M12X1.75-40	5#	Spacers	3	With SQ Hole
	3#	Conical Washers	3	M12	6#	Carriage Bolts	3	M12X1.75-45
HW A (For Hitch Assembly)	7#	Hex Bolts	8	M12X1.75-35	9#	Hex Flange Nuts	8	M12
	8#	Flat Washers	16	M12				

Gross Load Capacity When Used As A Weight Carrying Hitch: 3500 LBS. Trailer Weight & 350 LBS. Tongue Weight.
DO NOT EXCEED VEHICLE MANUFACTURER'S RECOMMENDED TOWING CAPACITY.

- * No Trimming Required
- * No Drilling Required

FISHWIRE TECHNIQUE

INSERT COILED END OF FISHWIRE TOOL THROUGH HITCH MOUNTING HOLE IN VEHICLE FRAME RAIL AND OUT THE ACCESS HOLE. PASS COILED END OF FISHWIRE THROUGH SPACER AND THREAD BOLT INTO COIL. KINK WIRE TO KEEP SPACER SEPARATE FROM BOLT AS SHOWN. PULL FISHWIRE, SPACER, AND BOLT THROUGH FRAME AND OUT MOUNTING HOLE. USE FISHWIRE TO GUIDE HITCH DURING MOUNTING AND PREVENT LOSS OF BOLT / SPACER INSIDE FRAME RAIL.

NOTE: SOME VEHICLES MAY FISHWIRE THROUGH END OF FRAME

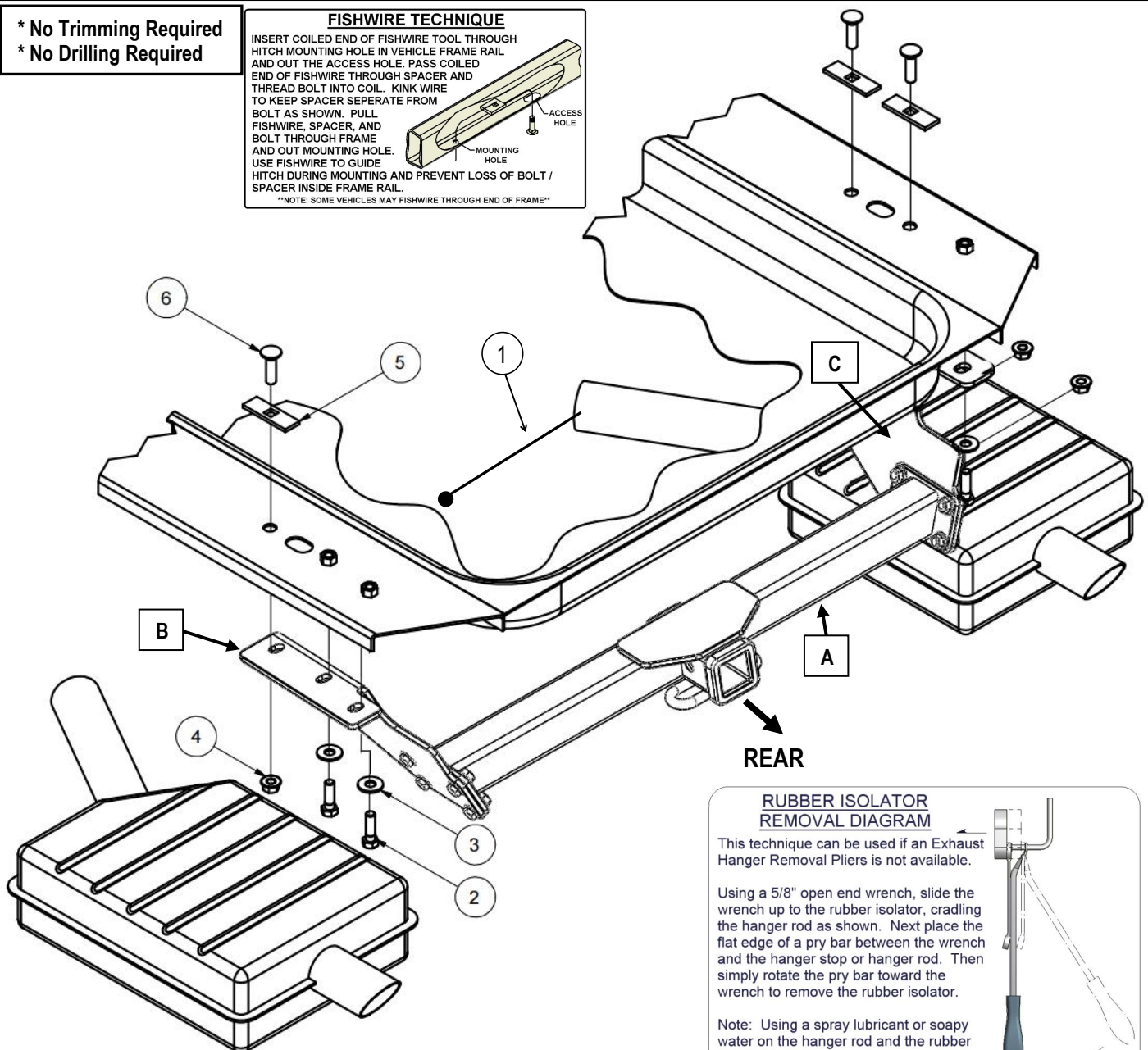

The instruction here is for your reference only. We strongly recommend the professional installer for best result. We are not responsible for any damage caused by the installation. Thank you for choosing our product!



Hitch Installation Instruction

Part#	HT-X38920	Application	For 2005-2010 Chrysler 300 ALL\2005-2008 Dodge Magnum ALL\2006-2010 Dodge Challenger ALL
-------	-----------	-------------	--

Step	Description
1	Assemble Hitch Body (A) and Mounting Brackets (B, C) with (8) M12X1.75-35mm Hex Bolts, (16) M12 Flat Washers, (8) M12 Hex Flange Nuts.(Hardware in "HW A").
2	Lower exhaust by removing the (2) hangers and (1) rubber mount on the 300 limited. (Note the 300C and Dodge Magnum will have (4) hangers and (2) rubber mounts for dual exhaust.)
3	Fishwire M12 carriage bolts and spacer blocks through existing holes in the frame as shown.
4	Slide hitch over muffler(s) and into position over the M12 carriage bolts. Secure with flange nuts, finger tight only.
5	Install 12mm hex bolts and conical washers in remaining holes,finger tight only.
6	Torque M12 Carriage Bolt to 58 lb-ft, torque M12 Hex Bolts to 86 lb-ft.
7	Reinstall exhaust hangers removed in step (1).
***Periodically Check The Receiver Hitch To Ensure That All Fasteners *** Are Tight & All Structural Components Are Sound.	

The instruction here is for your reference only. We strongly recommend the professional installer for best result. We are not responsible for any damage caused by the installation. Thank you for choosing our product!