



Hitch Installation Instruction

REV.20240701

Part#	HT-X32500	Application	For 2003-2009 Toyota 4Runner\2003-2009 Lexus GX470					
-------	-----------	-------------	--	--	--	--	--	--

Hardware List	Item	Part Name	QTY	Description	Item	Part Name	QTY	Description
Hitch Parts	A	Hitch Body	1		B/C	Mounting Brackets	2	B-Driver Side C-Passenger Side
HW B (For Hitch Installation)	1#	Conical Washers	4	M12	3#	Conical Washers	4	M8
	2#	Hex Bolts	4	M12X1.25-40	4#	Hex Bolts	4	M8X1.25-35
HW A (For Hitch Assembly)	5#	Hex Bolts	8	M12X1.75-35	6#	Hex Flange Nuts	8	M12
	6#	Flat Washers	16	M12				

Gross Load Capacity When Used As A Weight Carrying Hitch: 5000 LBS. Trailer Weight & 500 LBS. Tongue Weight.
Gross Load Capacity When Used As A Weight Distribution Hitch: 5500 LBS. Trailer Weight & 550 LBS. Tongue Weight.
DO NOT EXCEED VEHICLE MANUFACTURER'S RECOMMENDED TOWING CAPACITY.

- * No Drilling Required
- * No Trimming Required

RUBBER ISOLATOR REMOVAL DIAGRAM

This technique can be used if exhaust hanger removal pliers are not available.

Using a 5/8" open end wrench, slide the wrench up to the rubber isolator, cradling the hanger rod as shown.

Place the flat edge of a pry bar between the wrench and the hanger stop or hanger rod. Then simply rotate the pry bar toward the wrench to remove the rubber isolator.

Note: Using a lubricant or soapy water on the hanger rod and the rubber isolator helps removal.

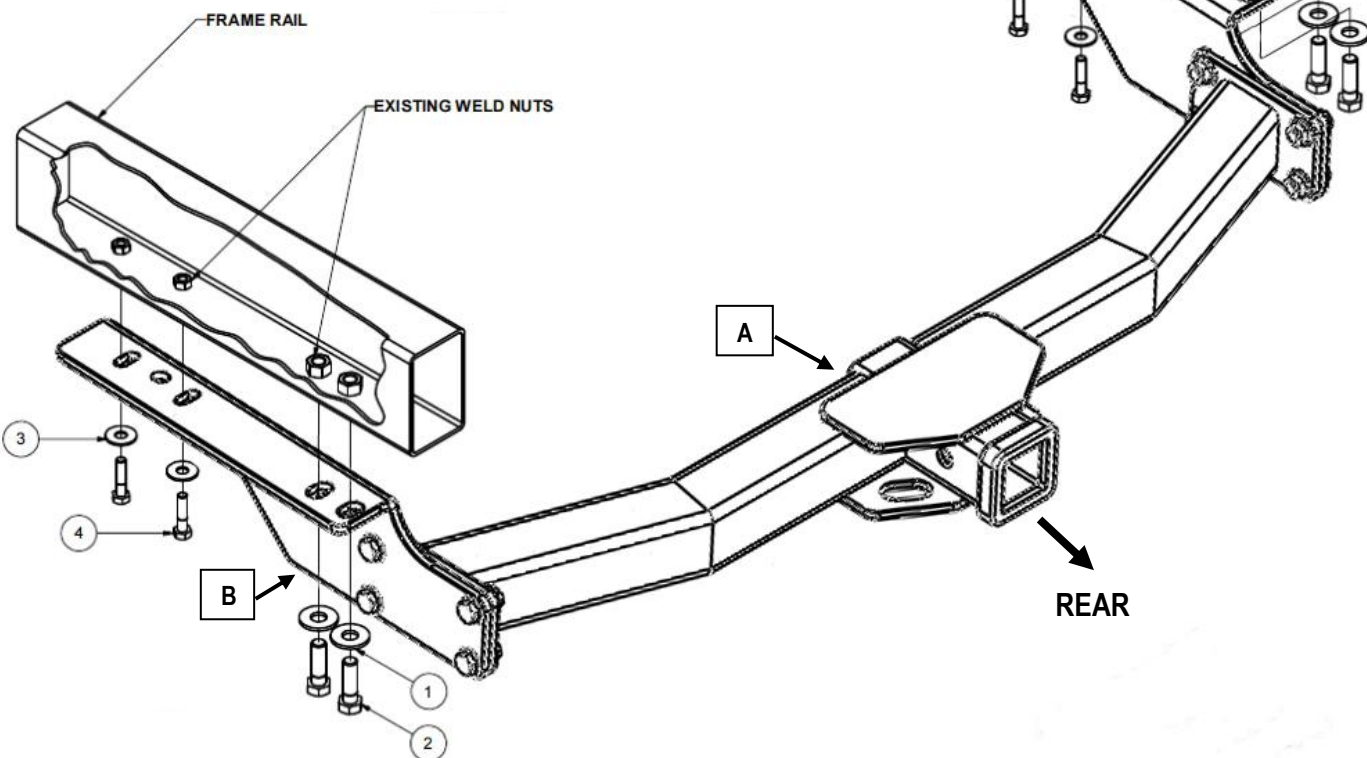
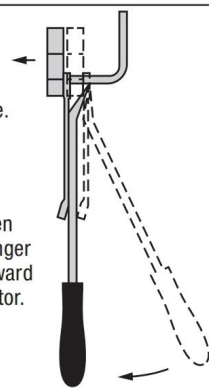

The instruction here is for your reference only. We strongly recommend the professional installer for best result. We are not responsible for any damage caused by the installation. Thank you for choosing our product!



Hitch Installation Instruction

REV.20240701

Part#	HT-X32500	Application	For 2003-2009 Toyota 4Runner\2003-2009 Lexus GX470
-------	-----------	-------------	--

Step	Description
1	Assemble Hitch Body (A) and Mounting Brackets (B, C) with (8) M12X1.75-35mm Hex Bolts, (16) M12 Flat Washers, (8) M12 Hex Flange Nuts.(Hardware in "HW A").
2	Remove tow hooks if present.
3	Maneuver passenger side plate over the exhaust and hold hitch up against frame.
4	Line up holes in the hitch side plates to existing weldnuts in frame. Install M12 and M8 bolts as shown.
5	Torque all M12 fasteners to 86 ft.-lbs. Torque all M8 fasteners to 18 ft.-lbs.
***Periodically Check The Receiver Hitch To Ensure That All Fasteners *** Are Tight & All Structural Components Are Sound.	

The instruction here is for your reference only. We strongly recommend the professional installer for best result. We are not responsible for any damage caused by the installation. Thank you for choosing our product!