



Hitch Installation Instruction

REV.20240901

Part#	HT-X31981	Application	For 2008-2017 Buick Enclave\ 2009-2017 Chevrolet Traverse\ 2007-2016 GMC Acadia\ 2017-2017 GMC Acadia Limited\ 2007-2010 Saturn Outlook
-------	-----------	-------------	---

Hardware List	Item	Part Name	QTY	Description	Item	Part Name	QTY	Description
Hitch Parts	A	Hitch Body	1		B/C	Mounting Brackets	2	B-Driver Side C-Passenger Side
HW B (For Hitch Installation)	1#	Hex Bolts	6	M12X1.75-30	4#	Square Hole Spacer	2	
	2#	Conical Washer	6	M12	5#	Hex Flange Nuts	2	M12X1.25
	3#	Carriage Bolts	2	M12X1.75-35	6#	Fishwire	2	
HW A (For Hitch Assembly)	7#	Hex Bolts	8	M12X1.75-35	9#	Hex Flange Nuts	8	M12
	8#	Flat Washers	16	M12				

Gross Load Capacity When Used As A Weight Carrying Hitch: 5000 LBS. Trailer Weight & 500 LBS. Tongue Weight.
Gross Load Capacity When Used As A Weight Distribution Hitch: 6000 LBS. Trailer Weight & 600 LBS. Tongue Weight.
DO NOT EXCEED VEHICLE MANUFACTURER'S RECOMMENDED TOWING CAPACITY.

No Drilling Required

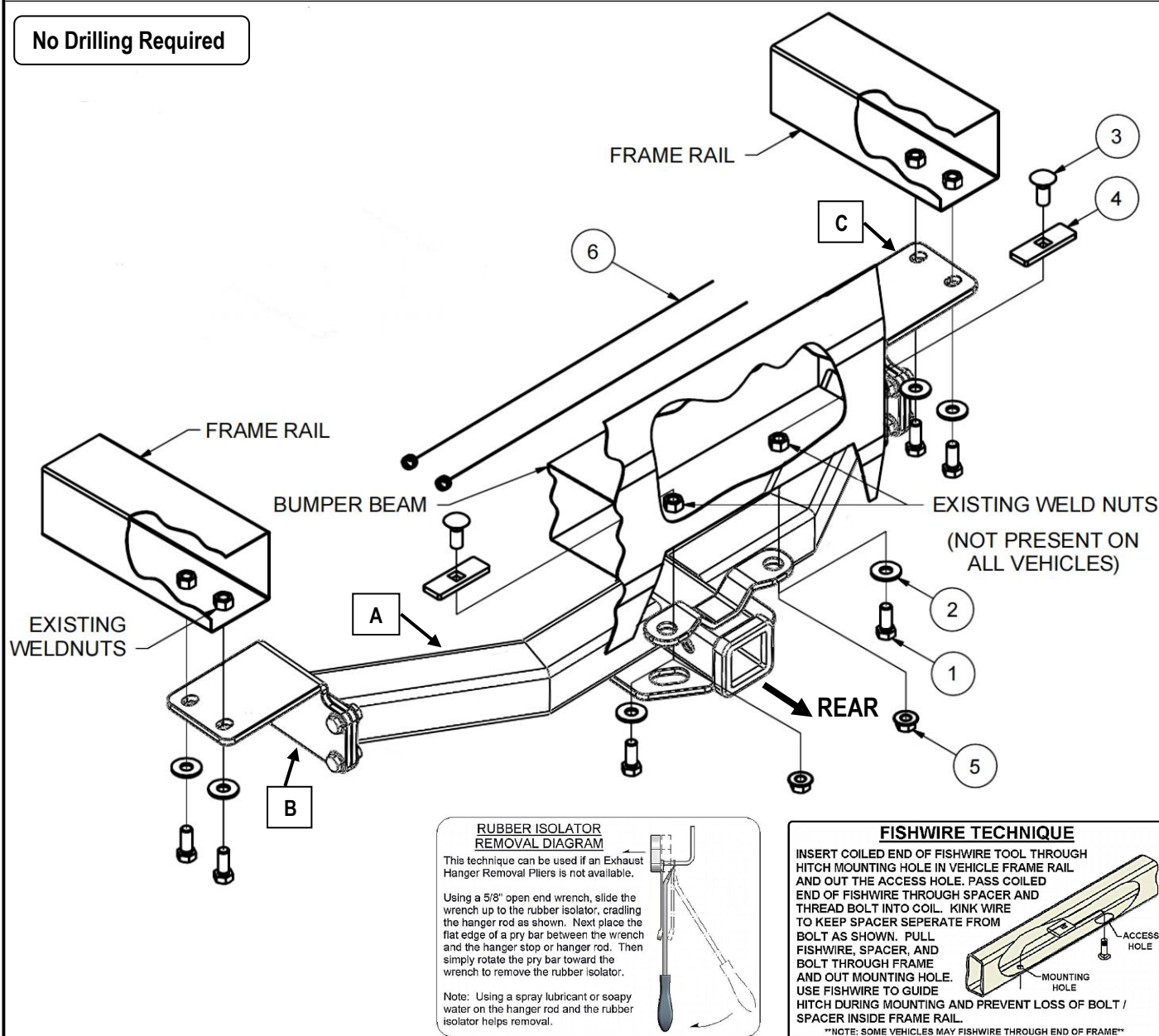

The instruction here is for your reference only. We strongly recommend the professional installer for best result. We are not responsible for any damage caused by the installation. Thank you for choosing our product!



Hitch Installation Instruction

REV.20240901

Part#	HT-X31981	Application	For 2008-2017 Buick Enclave\ 2009-2017 Chevrolet Traverse\ 2007-2016 GMC Acadia\ 2017-2017 GMC Acadia Limited\ 2007-2010 Saturn Outlook
Step	Description		
1	Assemble Hitch Body (A) and Mounting Brackets (B, C) with (8) M12X1.75-35mm Hex Bolts, (16) M12 Flat Washers, (8) M12 Hex Flange Nuts.(Hardware in “HW A”).		
2	Remove bumper fascia panel. (Note: Panel may be reinstalled on some models after hitch installation if desired.)		
3	Lower exhaust to ease installation. (See Rubber Isolator Removal Diagram)		
4	Raise hitch into position over the exhaust pipes aligning the slots in the hitch with the weldnuts in the bottom of the frame rails.		
5	Install (4) M12 bolts and conical toothed washers through the side plates and into the existing weld nuts in the frame rails are shown.		
6	If weldnuts in bumper beam are present, install (2) M12 bolts and conical toothed washers as shown. If the weld nuts are not present, fishwire, carriage bolts and spacers into position from the end of the bumper beam. Some models may require going through square access hole next to the mounting locations (square access hole may need to be slightly enlarged to fishwire hardware into position). Secure with (2) M12 hex flange nuts as shown. (See Fishware Technique.)		
7	Torque M12 Carriage Bolt to 58 ft-lbs, other M12 fasteners to 86 ft-lbs.		
8	Raise exhaust back into position, reinstall rubber isolaters and fascia panel (if desired).		
***Periodically Check The Receiver Hitch To Ensure That All Fasteners *** Are Tight & All Structural Components Are Sound.			

The instruction here is for your reference only. We strongly recommend the professional installer for best result. We are not responsible for any damage caused by the installation. Thank you for choosing our product!