



Hitch Installation Instruction

REV.20240701

Part#	HT-X31681	Application	For 1996-2005 Toyota Rav4					
-------	-----------	-------------	---------------------------	--	--	--	--	--

Hardware List	Item	Part Name	QTY	Description	Item	Part Name	QTY	Description
Hitch Parts	A	Hitch Body	1		B/C	Mounting Brackets	2	B-Driver Side C-Passenger Side
HW B (For Hitch Installation)	1#	Hex Bolts	4	M12X1.25-50	2#	Conical Washers	4	M12
HW A (For Hitch Assembly)	3#	Hex Bolts	8	M12X1.75-35	5#	Hex Flange Nuts	8	M12
	4#	Flat Washers	16	M12				

Gross Load Capacity When Used As A Weight Carrying Hitch: 4000 LBS. Trailer Weight & 400 LBS. Tongue Weight.
DO NOT EXCEED VEHICLE MANUFACTURER'S RECOMMENDED TOWING CAPACITY.

- * No Drilling Required
- * No Trimming Required

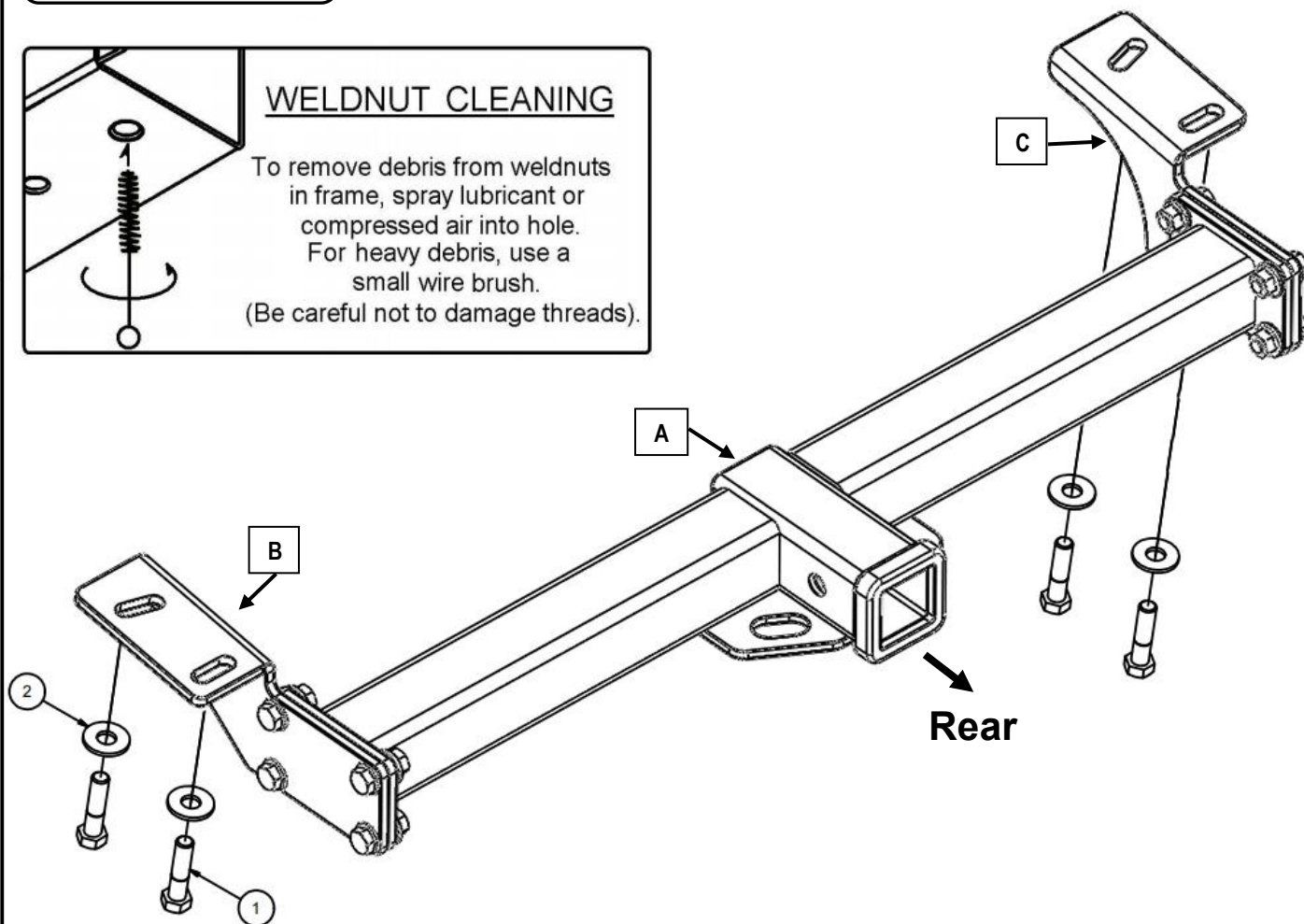
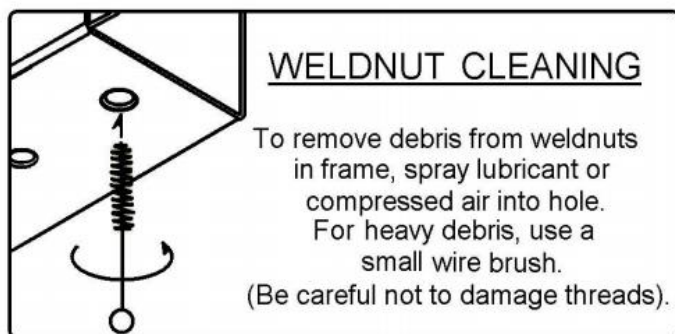

The instruction here is for your reference only. We strongly recommend the professional installer for best result. We are not responsible for any damage caused by the installation. Thank you for choosing our product!



Hitch Installation Instruction

REV.20240701

Part#	HT-X31681	Application	For 1996-2005 Toyota Rav4
-------	-----------	-------------	---------------------------

Step	Description
1	Assemble Hitch Body (A) and Mounting Brackets (B, C) with (8) M12X1.75-35mm Hex Bolts, (16) M12 Flat Washers, (8) M12 Hex Flange Nuts.(Hardware in "HW A").
2	Remove tow hooks if present.
3	Remove the two rearmost M12 fasteners from the vehicle frame. (both sides)
4	Raise the hitch into position and loosely reinstall the two M12 fasteners.
6	Tighten all fasteners. Torque M12 fastener to 86 ft-lbs.
***Periodically Check The Receiver Hitch To Ensure That All Fasteners *** Are Tight & All Structural Components Are Sound.	

The instruction here is for your reference only. We strongly recommend the professional installer for best result.
We are not responsible for any damage caused by the installation. Thank you for choosing our product!