



# Hitch Installation Instruction

REV.20240801

Part#	HT-X31633	Application	For 2010-2013 Ford Transit Connect
-------	-----------	-------------	------------------------------------

Hardware List	Item	Part Name	QTY	Description	Item	Part Name	QTY	Description
Hitch Parts	A	Hitch Body	1		B/C	Mounting Brackets	2	B-Driver Side C-Passenger Side
HW B (For Hitch Installation)	1#	Hex Bolts	4	M12X1.75-40	2#	Conical Washers	4	M12
HW A (For Hitch Assembly)	3#	Hex Bolts	4	M12X1.75-35	5#	Hex Flange Nuts	8	M12
	4#	Flat Washers	16	M12	6#	Hex Bolts	4	M12X1.75-40

Gross Load Capacity When Used As A Weight Carrying Hitch: 3500 LBS. Trailer Weight & 350 LBS. Tongue Weight.  
Gross Load Capacity When Used As A Weight Distribution Hitch: 4000 LBS. Trailer Weight & 400 LBS. Tongue Weight.  
\*\*\*DO NOT EXCEED VEHICLE MANUFACTURER'S RECOMMENDED TOWING CAPACITY.\*\*\*

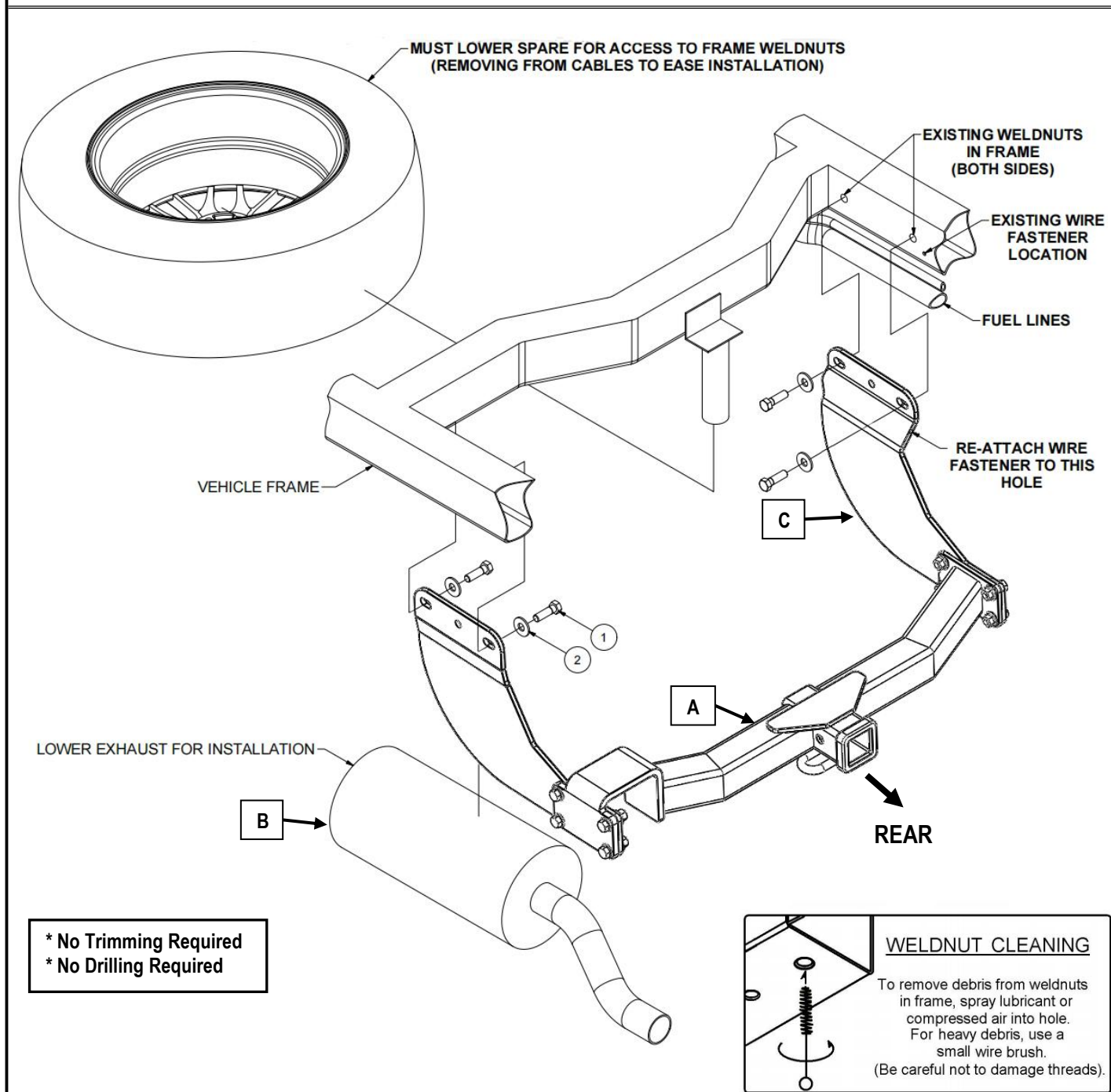

The instruction here is for your reference only. We strongly recommend the professional installer for best result. We are not responsible for any damage caused by the installation. Thank you for choosing our product!



## Hitch Installation Instruction

REV.20240801

Part#	HT-X31633	Application	For 2010-2013 Ford Transit Connect
-------	-----------	-------------	------------------------------------



### EXHAUST HANGER REMOVAL

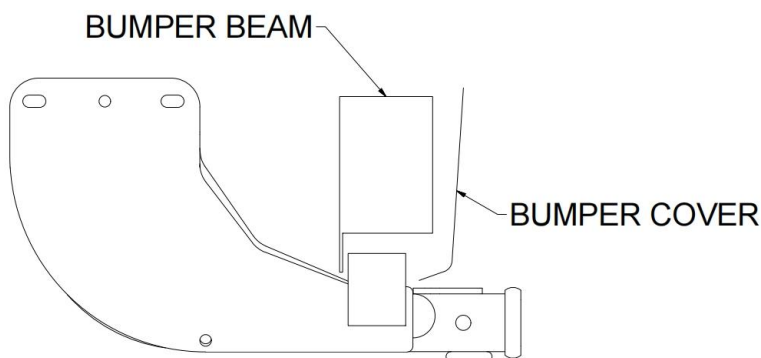

### INSTALLED HITCH POSITION

NOTE: VEHICLE SUSPENSION NEEDS TO STAY IN COMPRESSION DURING INSTALLATION TO AVOID SPRING SHACKLE ROTATION WHICH WILL CAUSE INTERFERENCE WITH THE HITCH

Step	Description
1	Assemble Hitch Body (A) and Mounting Brackets (B, C) with (4) M12X1.75-35mm Hex Bolts, (16) M12 Flat Washers, (8) M12 Hex Flange Nuts, (4) M12X1.75-40mm Hex Bolts.(Hardware in "HW A").
2	Lower rearmost exhaust hanger by twisting the hanger 90° in the frame and lower through the slot in the frame. (See exhaust hanger removal image)
3	Lower the spare tire, to ease installation remove spare tire from vehicle. (Spare tire will be re-installed in step 7) (Note: Refer to vehicle manual for spare tire removal)
4	Using a screw driver, on the passenger side, pry the wire fastener from the frame rail. <b>Caution:</b> before and while raising hitch into position, be sure not to pinch any wires or fuel lines between the hitch and the frame rails.
5	To raise hitch into position, raise the passenger side mounting plate up to the inside of the frame while sliding the hitch over the exhaust. Then raise the driver side mounting plate to the inside of the frame.
6	Loosely secure hitch with M12-1.75 hex bolts and conical toothed washers through existing weldnuts in side of frame rails. Attach the wire fastener (removed in step 3) to passenger side mounting plate where shown.
7	Torque all 12mm fasteners to 86 lb-ft.
8	Re-install exhaust hanger (reverse of removal) and re-install spare tire (spare tire may touch hitch when fully raised).
<b>***Periodically Check The Receiver Hitch To Ensure That All Fasteners *** Are Tight &amp; All Structural Components Are Sound.</b>	

The instruction here is for your reference only. We strongly recommend the professional installer for best result.  
We are not responsible for any damage caused by the installation. Thank you for choosing our product!