



Hitch Installation Instruction

REV.20231201

Part#	HT-R30201	Application	For 2009-2020 Dodge Journey
--------------	-----------	--------------------	-----------------------------

Hardware List	Item	Part Name	QTY	Description	Item	Part Name	QTY	Description
	1	Square Hole Spacer	2	6X32X75-13	4	Fishwire	2	For installing bolts
	2	Hex Flange nut	6	M12X1.75	5	Square Hole Spacer	4	6X25.4X51-13
	3	Carriage bolt	6	M12x1.75-40	6	Wedge Spacer	2	M12

Gross Load Capacity When Used As A Weight Carrying Hitch: 4000 LBS. Trailer Weight & 400 LBS. Tongue Weight.
 Gross Load Capacity When Used As A Weight Distribution Hitch: 4000 LBS. Trailer Weight & 400 LBS. Tongue Weight.
*****DO NOT EXCEED VEHICLE MANUFACTURER'S RECOMMENDED TOWING CAPACITY.*****

No Drilling Required

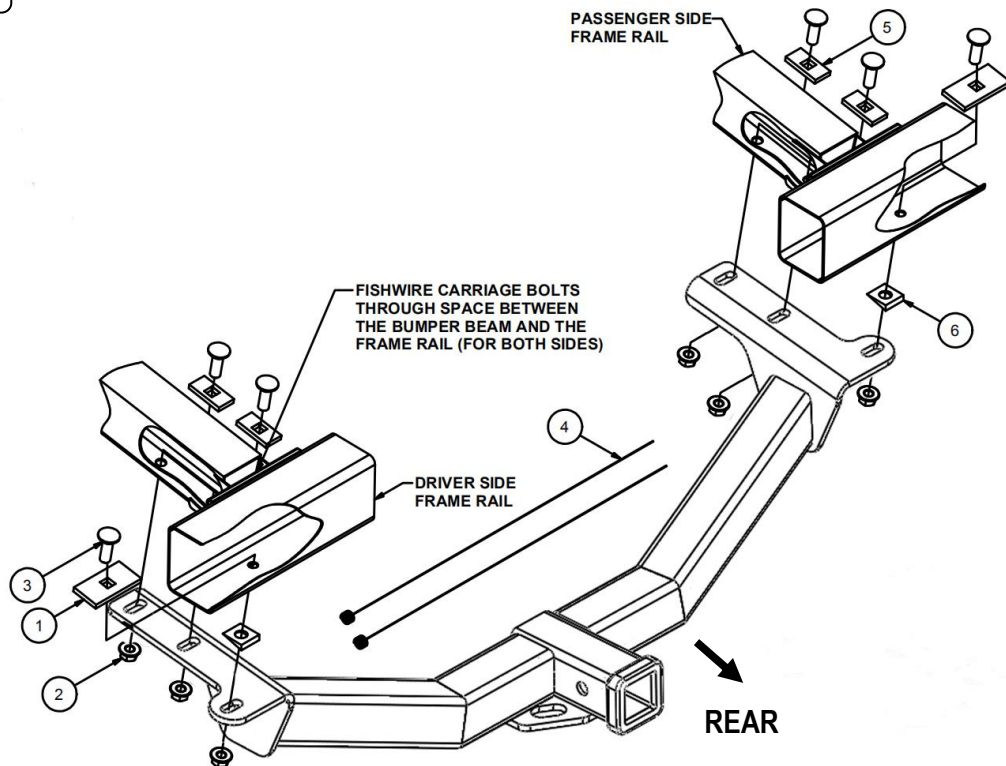

FISHWIRE TECHNIQUE

INSERT COILED END OF FISHWIRE TOOL THROUGH HITCH MOUNTING HOLE IN VEHICLE FRAME RAIL AND OUT THE ACCESS HOLE. PASS COILED END OF FISHWIRE THROUGH SPACER AND THREAD BOLT INTO COIL. KINK WIRE TO KEEP SPACER SEPARATE FROM BOLT AS SHOWN. PULL FISHWIRE, SPACER, AND BOLT THROUGH FRAME AND OUT MOUNTING HOLE. USE FISHWIRE TO GUIDE HITCH DURING MOUNTING AND PREVENT LOSS OF BOLT / SPACER INSIDE FRAME RAIL.

****NOTE: SOME VEHICLES MAY FISHWIRE THROUGH END OF FRAME****

RUBBER ISOLATOR REMOVAL DIAGRAM

This technique can be used if and Exhaust Hanger Removal Pliers is not available.



Using a 5/8" open end wrench, slide the wrench up to the rubber isolator, cradling the hanger rod as shown. Next place the flat edge of a pry bar between the wrench and the hanger stop or hanger rod. Then simply rotate the pry bar toward the wrench to remove the rubber isolator.

Note: Using a spray lubricant or soapy water on the hanger rod and the rubber isolator helps removal.

The instruction here is for your reference only. We strongly recommend the professional installer for best result. We are not responsible for any damage caused by the installation. Thank you for choosing our product!



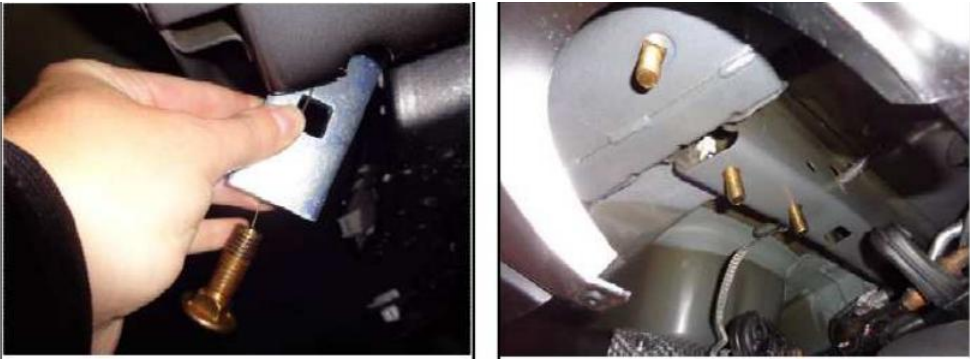
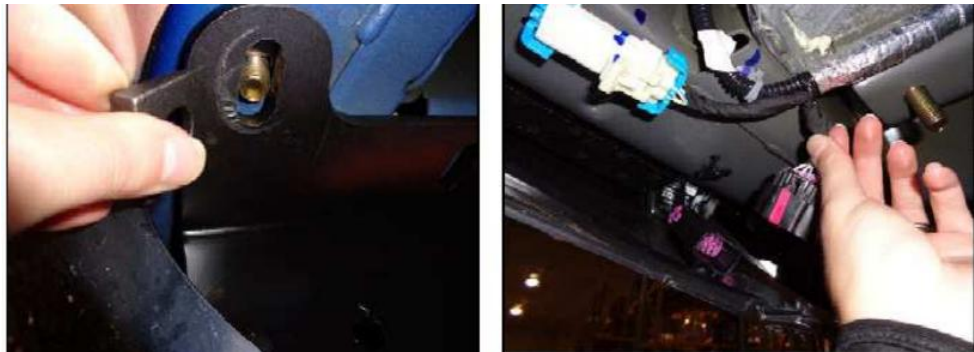

Hitch Installation Instruction

Part#	HT-R30201	Application	For 2009-2020 Dodge Journey
Step	Description		
1	<p>Lower exhaust by removing rubber isolators (3 each side) as shown in the above diagram. NOTE: Support exhaust from underneath after lowering.</p> 		
2	<p>Fishwire the carriage bolts and small square hole spacers through the space between the bumper beam and the end of the frame rail for both sides.</p> 		
3	<p>Fishwire the remaining carriage bolts and large spacers through the bumper beam and into position.</p> 		
4	<p>Raise hitch into position with the "wedge" shaped spacers between as shown and secure with hex flange nuts. NOTE: If equipped, temporarily disconnect driver side electrical connector for clearance while securing the hitch.</p> 		

The instruction here is for your reference only. We strongly recommend the professional installer for best result. We are not responsible for any damage caused by the installation. Thank you for choosing our product!



Hitch Installation Instruction

Part#	HT-R30201	Application	For 2009-2020 Dodge Journey
5	Torque all M12 fasteners to 86 ft-lbs.		
			
6	Raise exhaust back into position and reinstall the (6) rubber isolators removed in Step 1. NOTE: Apply lubricant or soapy water to ease installation.		
			
***Periodically Check The Receiver Hitch To Ensure That All Fasteners *** Are Tight & All Structural Components Are Sound.			

The instruction here is for your reference only. We strongly recommend the professional installer for best result. We are not responsible for any damage caused by the installation. Thank you for choosing our product!