



Hitch Installation Instruction

REV.20231201

Part#	HT-R30144	Application	For 2014-2018 Subaru Forester
--------------	-----------	--------------------	-------------------------------

Hardware List	Item	Part Name	QTY	Description	Item	Part Name	QTY	Description
	1#	Carriage Bolts	6	M12X1.75-45	3#	Spacers	6	With SQ Hole
	2#	Hex Flange Nuts	6	M12X1.75	4#	Fish Wire	6	

Gross Load Capacity When Used As A Weight Carrying Hitch:3500 LBS. Trailer Weight & 525 LBS. Tongue Weight.
*****DO NOT EXCEED VEHICLE MANUFACTURER'S RECOMMENDED TOWING CAPACITY.*****

No Drilling Required

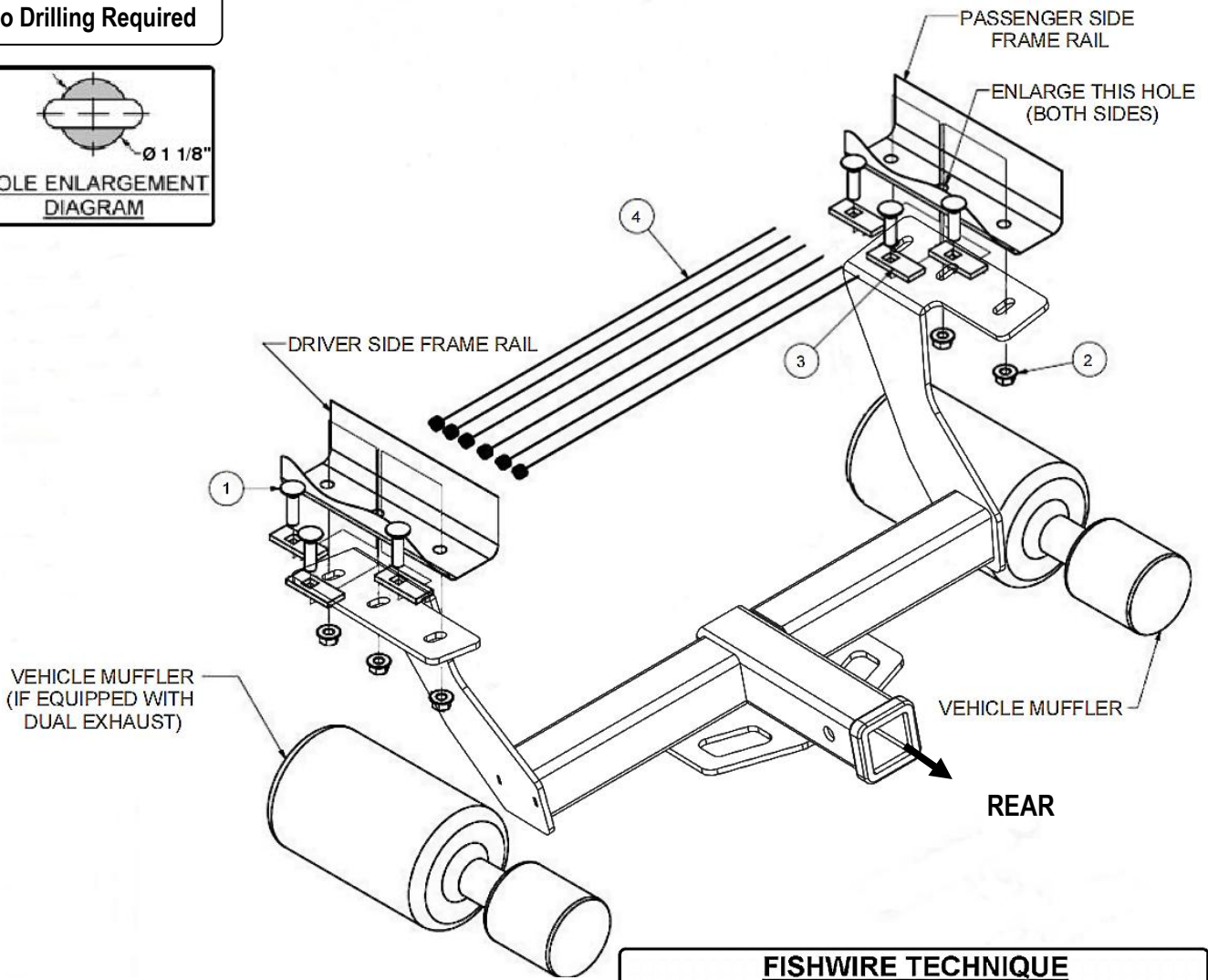
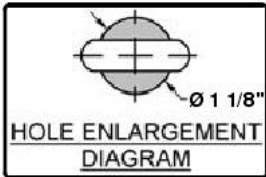

REVERSE PULL FISHWIRE TECHNIQUE

ATTACH FISHWIRE TO CARRIAGE BOLT AND SLIDE SPACER ONTO FISHWIRE. PUSH THE BOLT THRU THE HOLE FOLLOWED BY THE SPACER (AS SHOWN). PULL BOLT BACK INTO POSITION, PROTRUDING FROM THE FRAME.

FISHWIRE TECHNIQUE

INSERT COILED END OF FISHWIRE TOOL THROUGH HITCH MOUNTING HOLE IN VEHICLE FRAME RAIL AND OUT THE ACCESS HOLE. PASS COILED END OF FISHWIRE THROUGH SPACER AND THREAD BOLT INTO COIL. KINK WIRE TO KEEP SPACER SEPERATE FROM BOLT AS SHOWN. PULL FISHWIRE, SPACER, AND BOLT THROUGH FRAME AND OUT MOUNTING HOLE. USE FISHWIRE TO GUIDE HITCH DURING MOUNTING AND PREVENT LOSS OF BOLT / SPACER INSIDE FRAME RAIL.

ACCESS HOLE
MOUNTING HOLE



****NOTE: SOME VEHICLES MAY FISHWIRE THROUGH END OF FRAME****

The instruction here is for your reference only. We strongly recommend the professional installer for best result. We are not responsible for any damage caused by the installation. Thank you for choosing our product!



Hitch Installation Instruction

REV.20231201

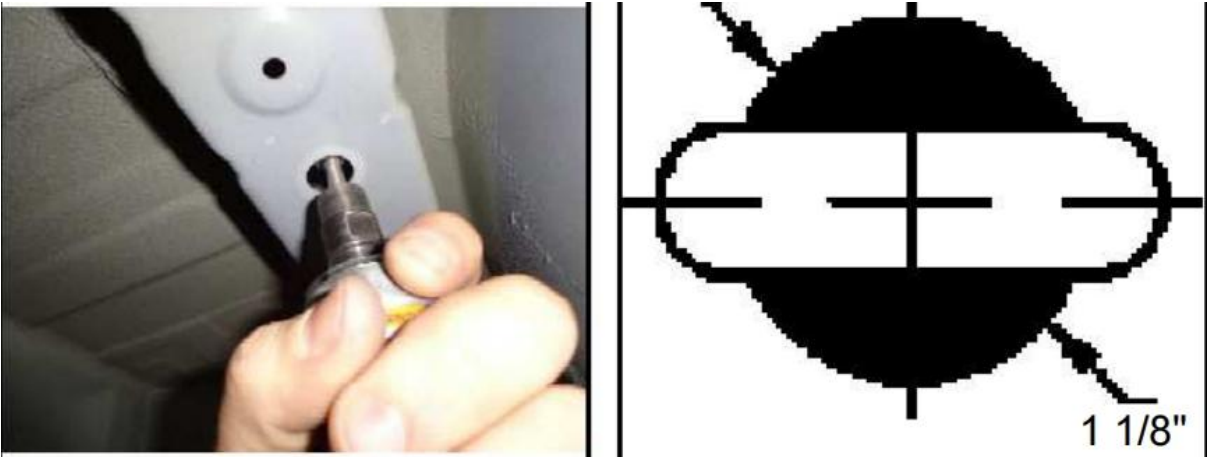
Part#	HT-R30144	Application	For 2014-2018 Subaru Forester
Step	Description		
1	<p>Remove (2) exhaust hangers from the passenger side muffler and (1) exhaust from the center front of vehicle for single exhaust vehicles, dual exhaust will remove (2) exhaust hangers from the driver side muffler as well. Support lowered exhaust with jack stand.</p> 		
2	<p>Remove (4) heat shield attachments with Phillips head screwdriver or 10mm socket (both sides if equipped with dual exhaust). Remove three hole plugs from each side of frame to expose mounting holes. Return all removed items to customer.</p> 		
3	<p>Enlarge the center hole on each side of the frame to about 1 1/8" to allow the mounting hardware to pass though. (Both sides)</p> 		

The instruction here is for your reference only. We strongly recommend the professional installer for best result. We are not responsible for any damage caused by the installation. Thank you for choosing our product!



Hitch Installation Instruction

REV.20231201

Part#	HT-R30144	Application	For 2014-2018 Subaru Forester
--------------	-----------	--------------------	-------------------------------

4 Fishwire M12 carriage bolt and spacer through the front and rear frame holes in both frame sides then reverse fishwire the center hole both sides.



5 Raise hitch into place and secure hitch to frame, using the M12 hardware provided. Torque all hardware to 86 ft-lbs.



6 Raise exhaust back into place and reattach exhaust hangers. Install complete.



The instruction here is for your reference only. We strongly recommend the professional installer for best result. We are not responsible for any damage caused by the installation. Thank you for choosing our product!