



# Hitch Installation Instruction

REV.20231201

Part#	HT-R30105		Application	For 2004-2020 Toyota Sienna All				
Hardware List	Item	Part Name	QTY	Description	Item	Part Name	QTY	Description
	1	Hex Bolts	6	M12 X1.25-40	2	Conical Washer	6	M12

Gross Load Capacity When Used As A Weight Carrying Hitch: 3500 LBS. Trailer Weight & 350 LBS. Tongue Weight.  
 Gross Load Capacity When Used As A Weight Distribution Hitch: 5000LBS. Trailer Weight & 500 LBS. Tongue Weight  
**\*\*\*DO NOT EXCEED VEHICLE MANUFACTURER'S RECOMMENDED TOWING CAPACITY.\*\*\***

**\*NO Drilling Required**  
**\*May Require Trimming If Underbody Panel Is Present**

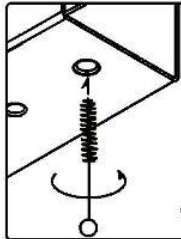

**WELDNUT CLEANING**

To remove debris from weldnuts in frame, spray lubricant or compressed air into hole. For heavy debris, use a small wire brush. (Be careful not to damage threads).

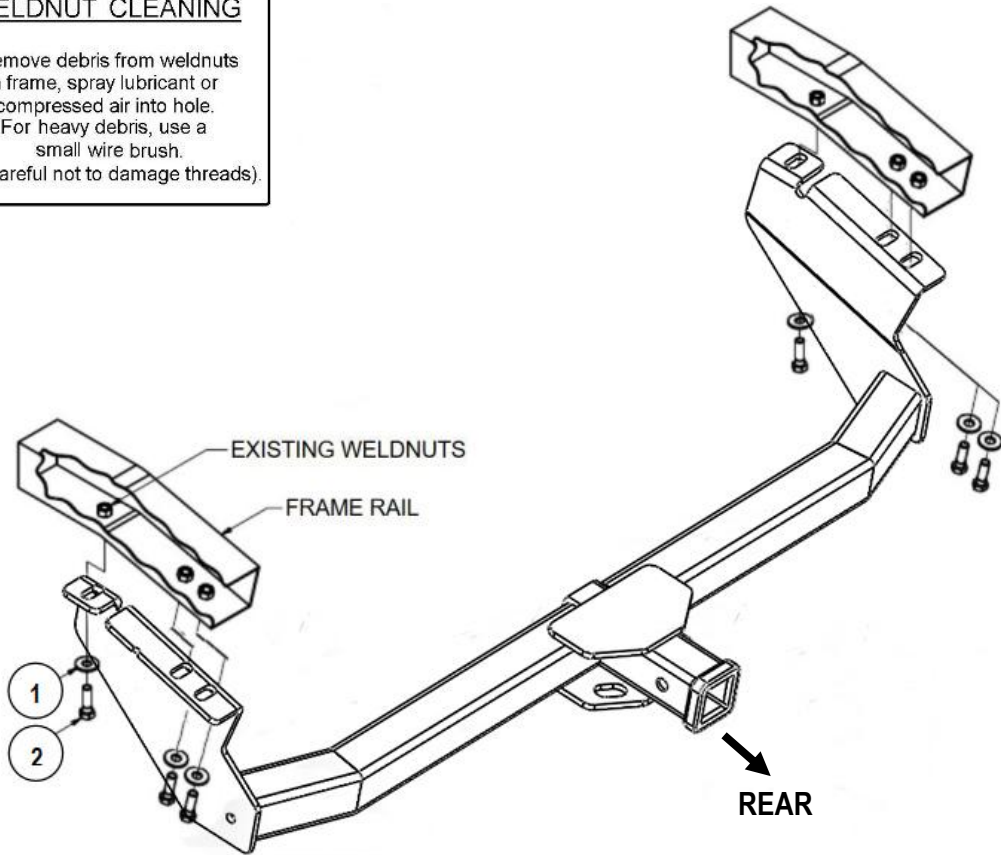

**RUBBER ISOLATOR REMOVAL DIAGRAM**

This technique can be used if and Exhaust Hanger Removal Pliers is not available.

Using a 5/8" open end wrench, slide the wrench up to the rubber isolator, cradling the hanger rod as shown. Next place the flat edge of a pry bar between the wrench and the hanger stop or hanger rod. Then simply rotate the pry bar toward the wrench to remove the rubber isolator.

**Note:** Using a spray lubricant or soapy water on the hanger rod and the rubber isolator helps removal.

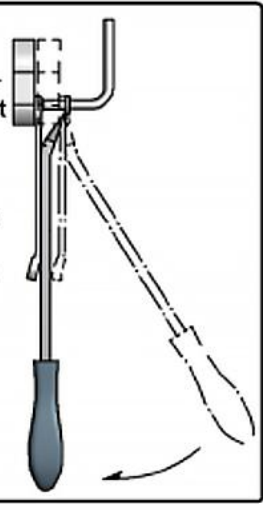

UNDERBODY TRIM DIAGRAM 2



UNDERBODY TRIM DIAGRAM 1

The instruction here is for your reference only. We strongly recommend the professional installer for best result. We are not responsible for any damage caused by the installation. Thank you for choosing our product!



## Hitch Installation Instruction

Part#	HT-R30105	Application	For 2004-2020 Toyota Sienna All
-------	-----------	-------------	---------------------------------

Step	Description
1	Remove underbody panel, if present.
2	Lower exhaust assembly for ease of installation. ( See Rubber Isolator Removal Diagram )
3	Remove hole plugs in frame rails and clean weldnuts. ( See Weldnut Cleaning Diagram )
4	Mark underbody panel for trimming, confirm fit prior to trimming. (See Underbody Trim Diagram 1) <b>NOTE:</b> Some models may have a lip that protrudes down, if present this will need to be trimmed as well. (See Underbody Trim Diagram 2)
5	Slide driver side plate through slot trimmed in underbody panel. Rise hitch and underbody panel into position aligning holes with existing weldnuts. <b>NOTE:</b> Underbody panel will be sandwiched between the hitch and the trunk pan.
6	Secure hitch with M12X1.25-40mm Hex Bolts and M12 Conical Washers as shown.
7	Tighten all fasteners. <b>Torque all M12 hardware to 56-58 ft-lbs.</b>
8	Raise exhaust back into original position and reattach underbody panel to maintain manufacturers appearance and fuel economy rating.
<b>***Periodically Check The Receiver Hitch To Ensure That All Fasteners *** Are Tight &amp; All Structural Components Are Sound.</b>	

The instruction here is for your reference only. We strongly recommend the professional installer for best result. We are not responsible for any damage caused by the installation. Thank you for choosing our product!