

<b>Part#</b>	HT-R38990	<b>Application</b>	For 2002-2006 Honda CR-V
--------------	-----------	--------------------	--------------------------

Hardware List	Item	Part Name	QTY	Description	Item	Part Name	QTY	Description
	1#	Fish Wires	2		4#	Spacers	4	With SQ hole
	2#	Hex Flange Nuts	6	M10X1.5	5#	U-Bolt	1	M10X1.5-67
	3#	Carriage Bolts	4	M10X1.5-35				

Gross Load Capacity When Used As A Weight Carrying Hitch:3500 LBS. Trailer Weight & 350 LBS. Tongue Weight.  
**\*\*\*DO NOT EXCEED VEHICLE MANUFACTURER’S RECOMMENDED TOWING CAPACITY.\*\*\***

**RUBBER ISOLATOR REMOVAL DIAGRAM**

This technique can be used if exhaust hanger removal pliers are not available.

Using a 5/8" open end wrench, slide the wrench up to the rubber isolator, cradling the hanger rod as shown.

Place the flat edge of a pry bar between the wrench and the hanger stop or hanger rod. Then simply rotate the pry bar toward the wrench to remove the rubber isolator.

**Note:** Using a lubricant or soapy water on the hanger rod and the rubber isolator helps removal.

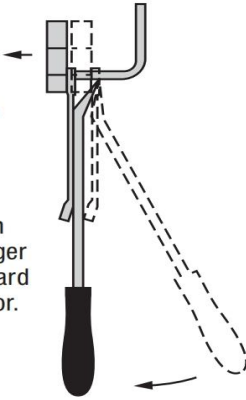

**No Drilling Required**

**FISHWIRE TECHNIQUE**

Insert coiled end of fishwire tool through hitch mounting hole in vehicle frame rail and out the access hole. Pass coiled end of fishwire through spacer and thread bolt into coil. Kink wire to keep spacer separate from bolt as shown. Pull fishwire, spacer and bolt through frame and out mounting hole. Use fishwire to guide hitch during mounting and prevent loss of bolt or spacer inside frame rail.

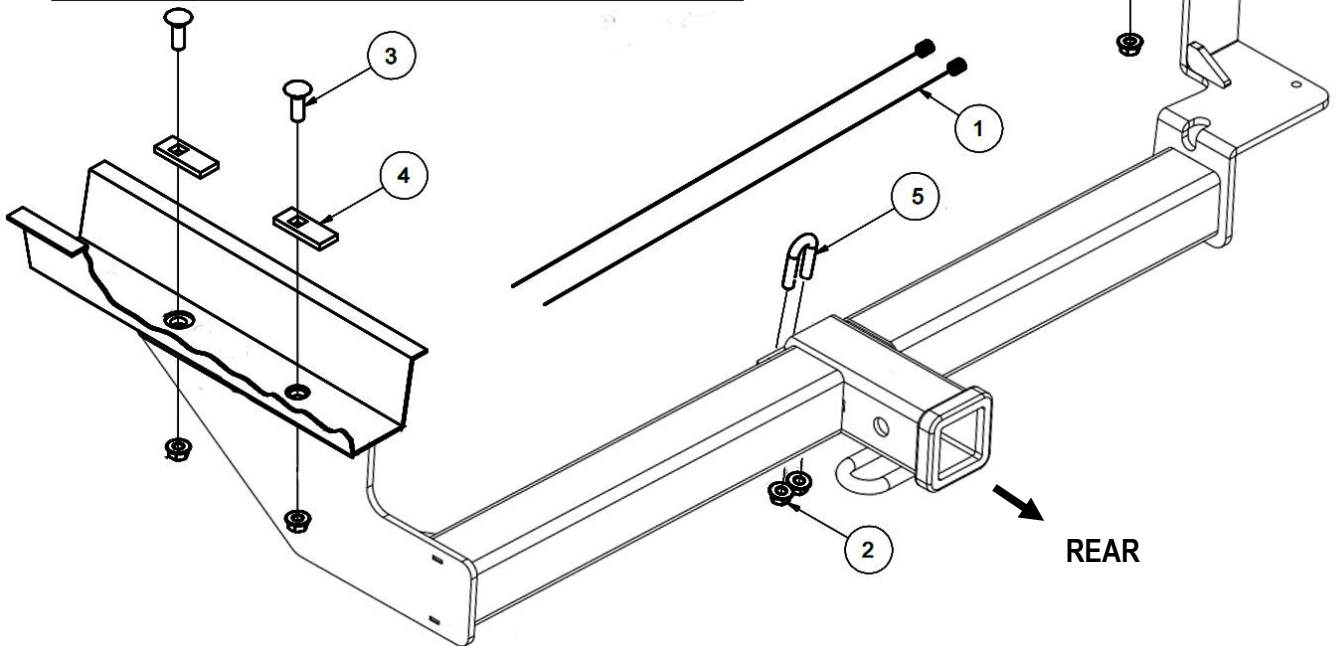
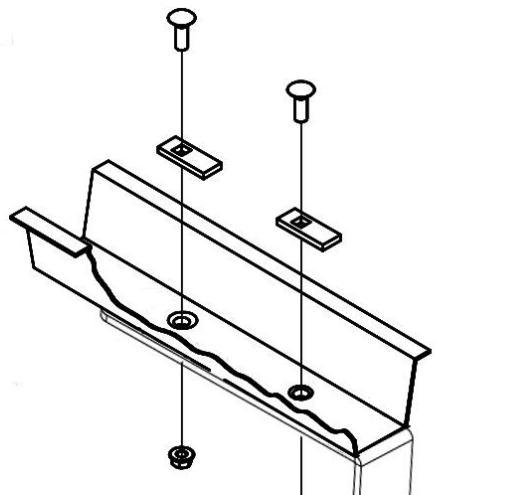
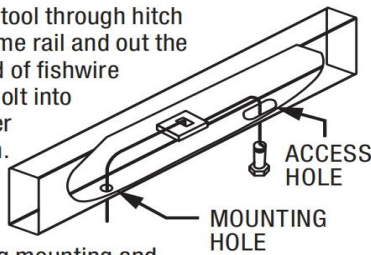

The instruction here is for your reference only. We strongly recommend the professional installer for best result. We are not responsible for any damage caused by the installation. Thank you for choosing our product!

<b>Part#</b>	HT-R38990	<b>Application</b>	For 2002-2006 Honda CR-V
--------------	-----------	--------------------	--------------------------

Step	Description
1	Lower the exhaust by removing the two rear exhaust hangers and one in front of the axle.
2	After the exhaust has been lowered, fishwire a carriage bolt and spacer through the large frame hole and out the small front hole in the frame.
3	Remove the fishwire from the front bolt and fishwire a carriage bolt and spacer into the rear frame hole. Repeat the process for the driver side frame rail.
4	Place the U-bolt over the tow hook in the middle of the vehicle.
5	After all hardware has been properly installed, raise the hitch into position and secure with U-bolt and flange nuts first, then attach the remaining M10 hardware.
6	Torque all M10 hardware to 47 ft-lbs.
7	Reattach the three exhaust hangers removed in Step 1.
8	<b>NOTE: Modify exhaust hangers if muffler interferes with hitch.</b>

The instruction here is for your reference only. We strongly recommend the professional installer for best result. We are not responsible for any damage caused by the installation. Thank you for choosing our product!