



# Hitch Installation Instruction

REV.20240401

Part#	HT-R38490	Application	For 1985-2005 Chevy Astro\ GMC Safari All (16 in. spare requires relocation)				
-------	-----------	-------------	---	--	--	--	--

Hardware List	Item	Part Name	QTY	Description	Item	Part Name	QTY	Description
	1	Fishwire	1		5	Hex Flange Nuts	2	M12X1.75
	2	Hex Bolts	2	M10X1.5-45	6	Spacers	2	With SQ Hole
	3	Lock Washers	2	M10	7	Carriage Bolts	2	M12X1.75-45
	4	Flat Washers	2	M10				

Gross Load Capacity When Used As A Weight Carrying Hitch: 4000 LBS. Trailer Weight & 400 LBS. Tongue Weight.  
 Gross Load Capacity When Used As A Weight Distribution Hitch: 6000 LBS. Trailer Weight & 600 LBS. Tongue Weight.  
**\*\*\*DO NOT EXCEED VEHICLE MANUFACTURER'S RECOMMENDED TOWING CAPACITY.\*\*\***

- \* No Trimming Required
- \* No Drilling Required

**WELDNUT CLEANING**

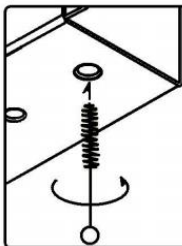

To remove debris from weldnuts in frame, spray lubricant or compressed air into hole. For heavy debris, use a small wire brush. (Be careful not to damage threads).

**FISHWIRE TECHNIQUE**

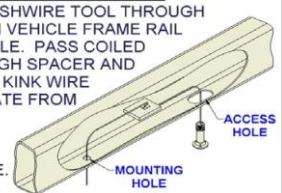

INSERT COILED END OF FISHWIRE TOOL THROUGH HITCH MOUNTING HOLE IN VEHICLE FRAME RAIL AND OUT THE ACCESS HOLE. PASS COILED END OF FISHWIRE THROUGH SPACER AND THREAD BOLT INTO COIL. KINK WIRE TO KEEP SPACER SEPARATE FROM BOLT AS SHOWN. PULL FISHWIRE, SPACER, AND BOLT THROUGH FRAME AND OUT MOUNTING HOLE. USE FISHWIRE TO GUIDE HITCH DURING MOUNTING AND PREVENT LOSS OF BOLT / SPACER INSIDE FRAME RAIL.

**\*\*NOTE: SOME VEHICLES MAY FISHWIRE THROUGH END OF FRAME\*\***

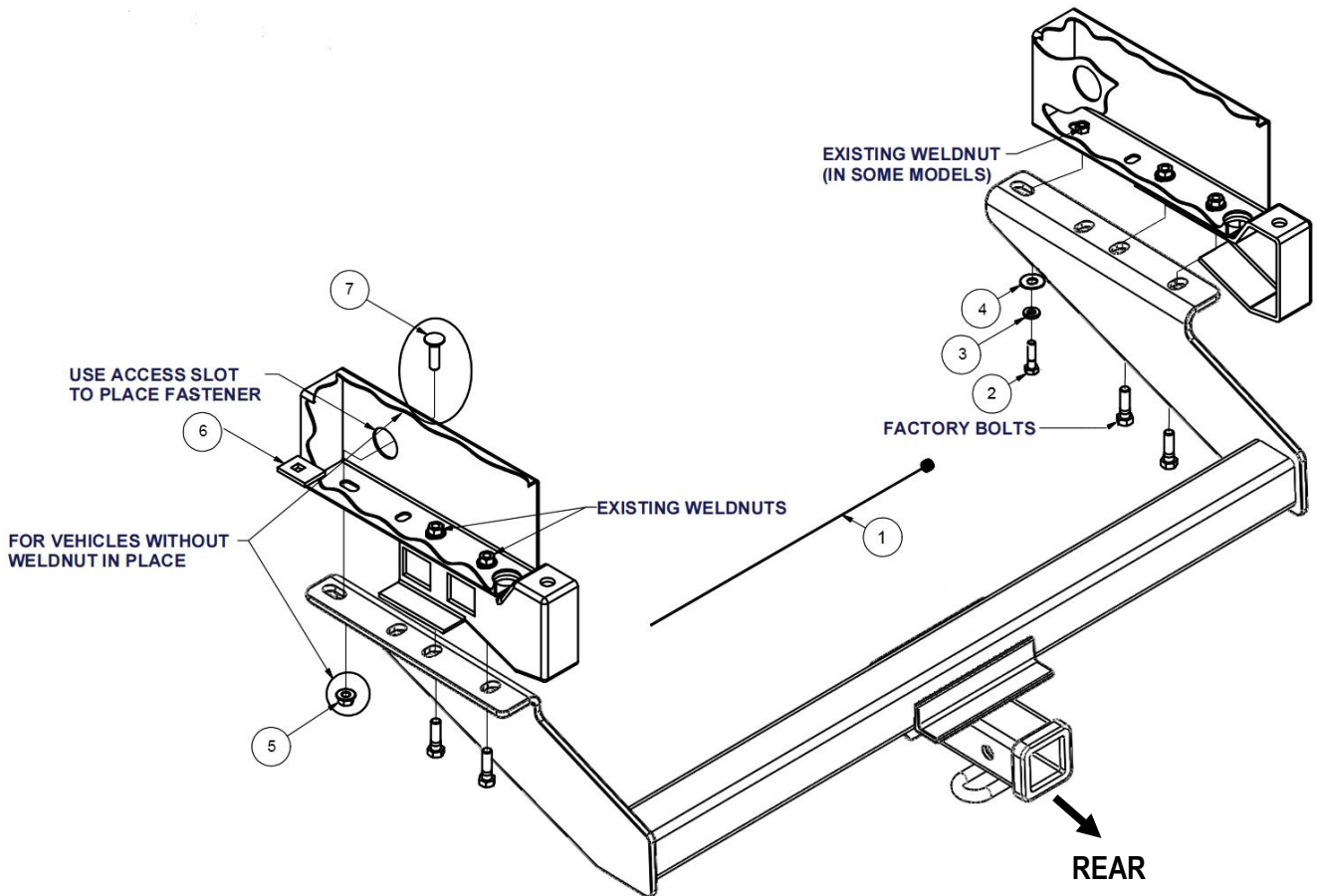

The instruction here is for your reference only. We strongly recommend the professional installer for best result. We are not responsible for any damage caused by the installation. Thank you for choosing our product!



## Hitch Installation Instruction

Part#	HT-R38490	Application	For 1985-2005 Chevy Astro\ GMC Safari All (16 in. spare requires relocation)
-------	-----------	-------------	---

Step	Description
1	Remove bumper bracket bolts and set aside for later install directions.
2	Position hitch between bumper bracket and frame. Align the holes of the bumper bracket with the holes of the hitch and loosely reinstall factory bolts.
3	<b>Early models:</b> Using M12 carriage bolts and square hole spacers provided, pass one of each through the large hole in frame under the bumper bracket into the hole in the end plate. <b>Late models:</b> With existing weldnut at furthest hole, from rear bumper, in frame install M10 bolt with lock washer and flatwasher.
4	Torque M10 fasteners to 47 lb-ft, M12 fasteners to 58 lb-ft.
<b>***Periodically Check The Receiver Hitch To Ensure That All Fasteners *** Are Tight &amp; All Structural Components Are Sound.</b>	

The instruction here is for your reference only. We strongly recommend the professional installer for best result. We are not responsible for any damage caused by the installation. Thank you for choosing our product!