



Hitch Installation Instruction

REV.20241201

Part#	HT-R38271	Application	For 2008-2010 Saturn Vue ALL \2012-2015 Chevrolet Captiva Sport ALL
-------	-----------	-------------	---

Hardware List	Item	Part Name	QTY	Description	Item	Part Name	QTY	Description
	1	Hex Bolts	6	M12X1.75-35	2	Conical Washers	6	M12

Gross Load Capacity When Used As A Weight Carrying Hitch: 3500 LBS. Trailer Weight & 350 LBS. Tongue Weight.
Gross Load Capacity When Used As A Weight Distribution Hitch: 4000 LBS. Trailer Weight & 400 LBS. Tongue Weight.
*****DO NOT EXCEED VEHICLE MANUFACTURER'S RECOMMENDED TOWING CAPACITY.*****

- * No Trimming Required
- * No Drilling Required

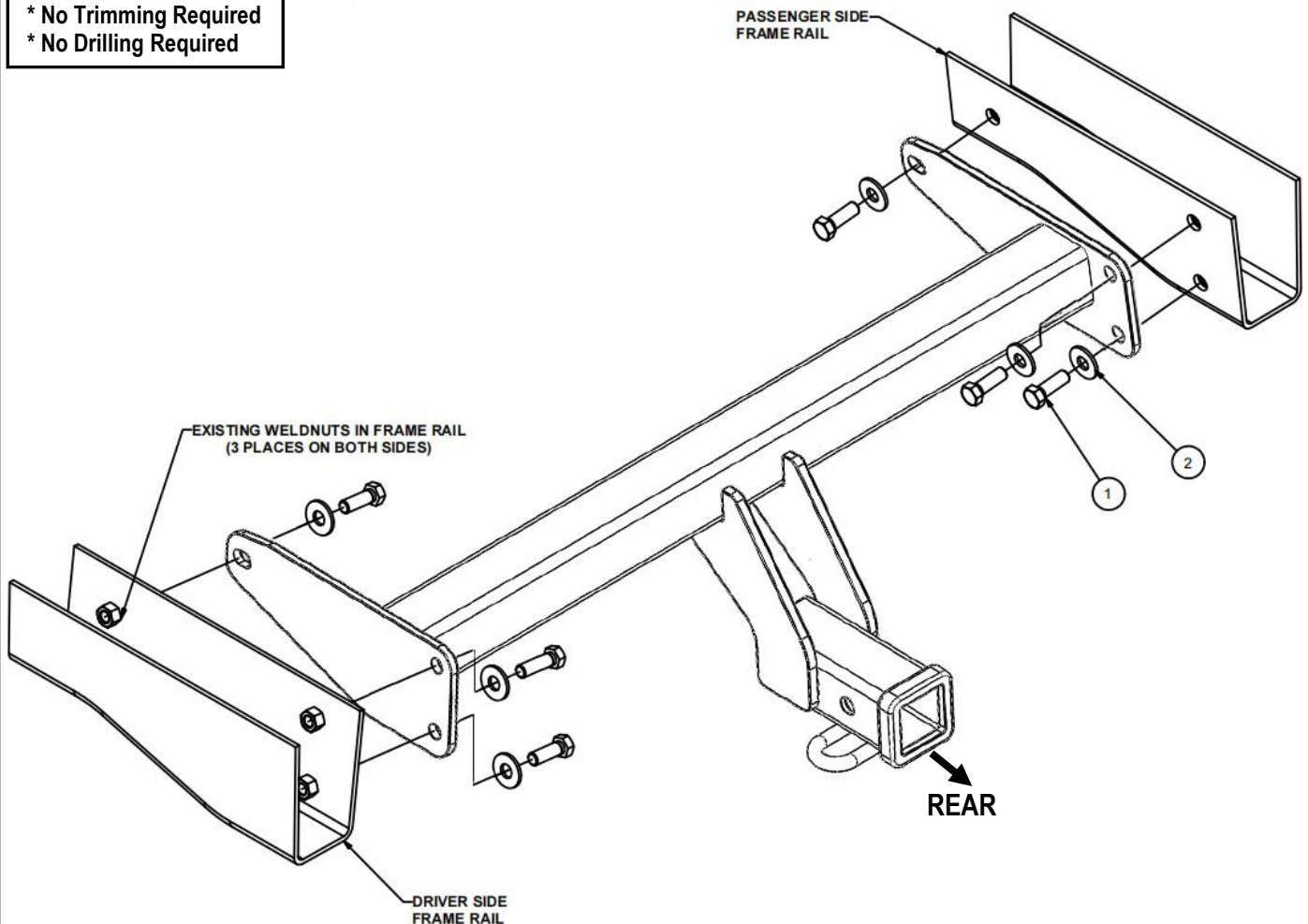

Step	Description
1	Lower exhaust by removing rear (4) exhaust hangers. Use a spray lubricant if needed to remove hangers.
2	Raise hitch into position between frame rails, aligning holes in hitch with the weldnuts within the frame rails.
3	Install supplied hex bolts and conical tooth washers.
4	Torque all M12 fasteners to 86 lb-ft.

***Periodically Check The Receiver Hitch To Ensure That All Fasteners ***
Are Tight & All Structural Components Are Sound.

The instruction here is for your reference only. We strongly recommend the professional installer for best result. We are not responsible for any damage caused by the installation. Thank you for choosing our product!