



Hitch Installation Instruction

REV.20240401

| | | | | | | | |
|-------|-----------|-------------|-----------------------------------|--|--|--|--|
| Part# | HT-R37370 | Application | For 2009-2013 Subaru Forester ALL | | | | |
|-------|-----------|-------------|-----------------------------------|--|--|--|--|

| Hardware List | Item | Part Name | QTY | Description | Item | Part Name | QTY | Description |
|---------------|----------------|-----------|-------------|-------------|------|-----------------|---------|-------------|
| | 1 | Fishwires | 2 | | | 3 | Spacers | 4 |
| 2 | Carriage Bolts | 4 | M12X1.75-40 | | 4 | Hex Flange Nuts | 4 | M12X1.75 |

Gross Load Capacity When Used As A Weight Carrying Hitch: 4000 LBS. Trailer Weight & 400 LBS. Tongue Weight.
*****DO NOT EXCEED VEHICLE MANUFACTURER'S RECOMMENDED TOWING CAPACITY.*****

- * No Trimming Required
- * Drilling Required (Enlarge Holes)

FISHWIRE TECHNIQUE

INSERT COILED END OF FISHWIRE TOOL THROUGH HITCH MOUNTING HOLE IN VEHICLE FRAME RAIL AND OUT THE ACCESS HOLE. PASS COILED END OF FISHWIRE THROUGH SPACER AND THREAD BOLT INTO COIL. KINK WIRE TO KEEP SPACER SEPARATE FROM BOLT AS SHOWN. PULL FISHWIRE, SPACER, AND BOLT THROUGH FRAME AND OUT MOUNTING HOLE. USE FISHWIRE TO GUIDE HITCH DURING MOUNTING AND PREVENT LOSS OF BOLT / SPACER INSIDE FRAME RAIL.

****NOTE: SOME VEHICLES MAY FISHWIRE THROUGH END OF FRAME****

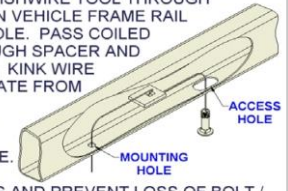

REVERSE PULL FISHWIRE TECHNIQUE

ATTACH FISHWIRE TO CARRIAGE BOLT AND SLIDE SPACER ONTO FISHWIRE. THEN PUSH THE BOLT THRU THE HOLE FOLLOWED BY THE SPACER (AS SHOWN). PULL BOLT BACK INTO POSITION, PROTRUDING FROM THE FRAME.

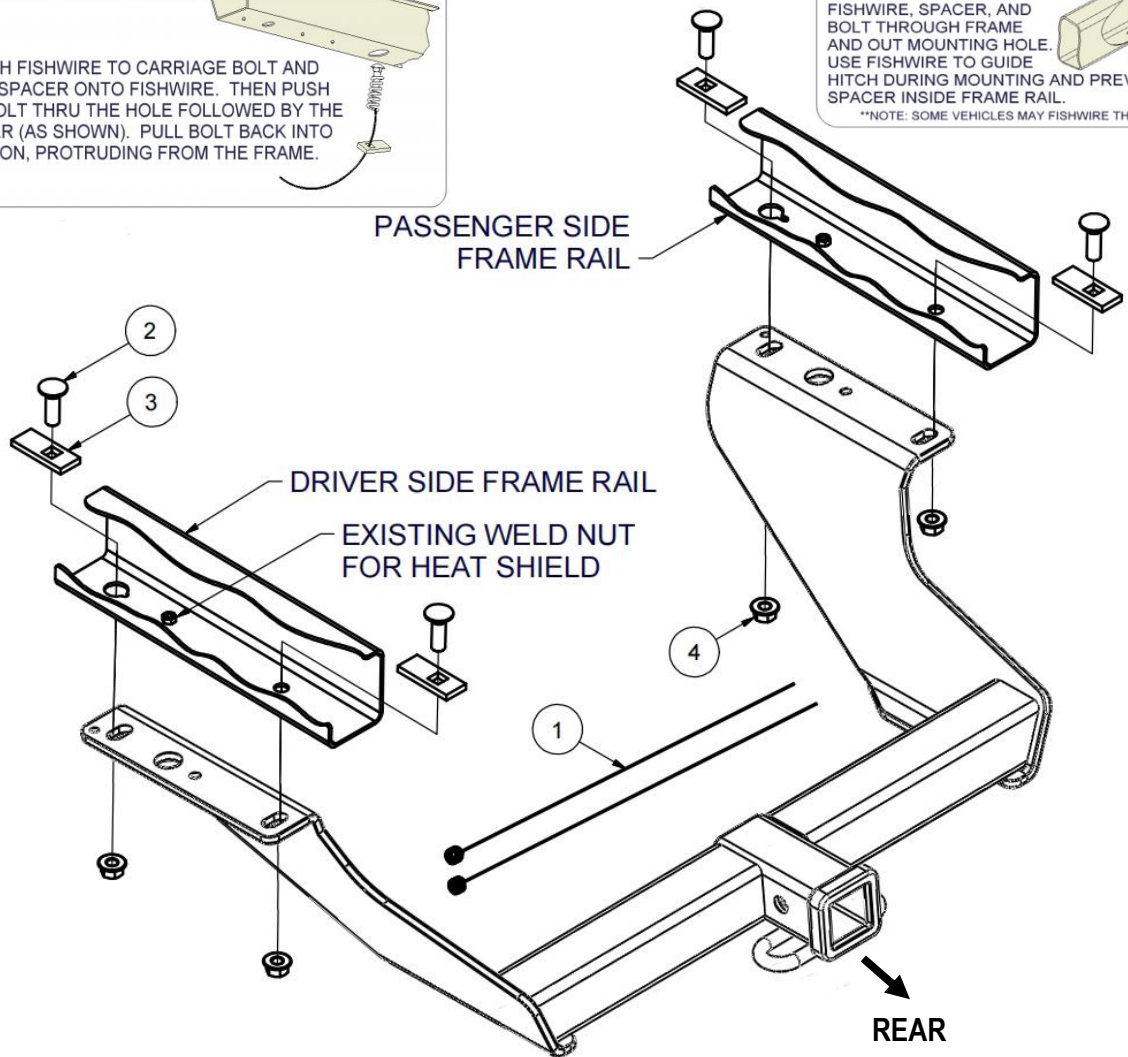
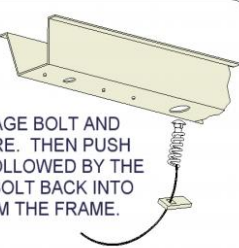

REMOVE PLUG AND MODIFY USING DIE GRINDER (OR ROUND FILE) TO ALLOW INSERTION OF 1/2-13 BOLTS AND CM-SP10 SPACERS INTO FRAME RAIL

REMOVE PLUG AND ENLARGE HOLE USING 17/32" DRILL BIT TO ALLOW 1/2-13 BOLT THREADS TO PROTRUDE THROUGH FRAME RAIL

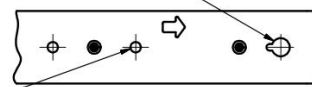

"A" "B"



HEAT SHIELD DIAGRAM
(BOTH SIDES)

The instruction here is for your reference only. We strongly recommend the professional installer for best result. We are not responsible for any damage caused by the installation. Thank you for choosing our product!



Hitch Installation Instruction

| Part# | HT-R37370 | Application | For 2009-2013 Subaru Forester ALL |
|---|--|-------------|-----------------------------------|
| Step | Description | | |
| 1 | Lower the exhaust for ease of install. (Remove (5) rubber hangers to lower the exhaust.) NOTE: Use a spray lubricant or soapy water on the hanger rod and isolator to ease removal. | | |
| 2 | Using a screwdriver, remove the frame rail hole plugs. Enlarge / modify the holes as noted in the "Heat Shield Diagram". | | |
| 3 | Fishwire the carriage bolts and the spacers into hole ("A") as shown in the "Heat Shield Diagram". Refer to the "Fishwire Technique" diagram. | | |
| 4 | Reverse pull fishwire the carriage bolts and the spacers into hole ("B") as shown in the "Heat Shield Diagram". Refer to "Reverse Pull Fishwire Technique" diagram. | | |
| 5 | Raise the hitch into position and secure using the hex flange nuts. | | |
| 6 | Torque all M12 fasteners to 58 lb-ft. | | |
| 7 | Re-install the exhaust and the rubber isolators removed in Step 1. | | |
| ***Periodically Check The Receiver Hitch To Ensure That All Fasteners *** Are Tight & All Structural Components Are Sound. | | | |

The instruction here is for your reference only. We strongly recommend the professional installer for best result. We are not responsible for any damage caused by the installation. Thank you for choosing our product!