



Hitch Installation Instruction

REV.20231201

Part#	HT-R31981	Application	For 2008-2017 Buick Enclave 2009-2017 Chevrolet Traverse 2007-2016 GMC Acadia 2017-2017 GMC Acadia Limited 2007-2010 Saturn Outlook
--------------	-----------	--------------------	---

Hardware List	Item	Part Name	QTY	Description	Item	Part Name	QTY	Description
	1	Hex Bolts	6	M12X1.75-30	4	Square Hole Spacer	2	
	2	Conical Washer	6	M12	5	Hex Flange Nuts	2	M12X1.25
	3	Carriage Bolts	2	M12X1.75-35	6	Fishwire	2	

Gross Load Capacity When Used As A Weight Carrying Hitch: 5000 LBS. Trailer Weight & 500 LBS. Tongue Weight.
 Gross Load Capacity When Used As A Weight Distribution Hitch: 6000 LBS. Trailer Weight & 600 LBS. Tongue Weight.
*****DO NOT EXCEED VEHICLE MANUFACTURER'S RECOMMENDED TOWING CAPACITY.*****

No Drilling Required

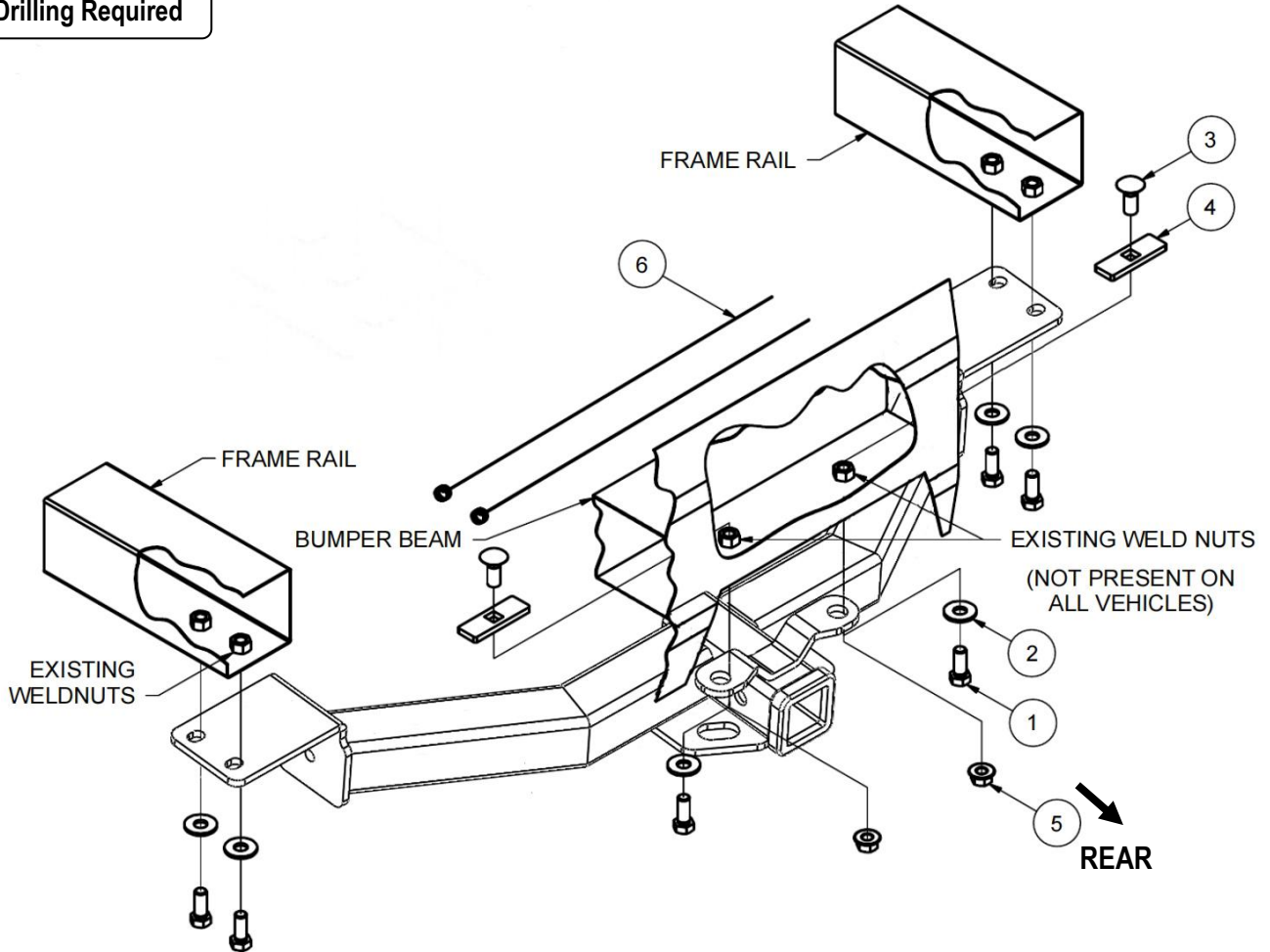

RUBBER ISOLATOR REMOVAL DIAGRAM

This technique can be used if an Exhaust Hanger Removal Pliers is not available.

Using a 5/8" open end wrench, slide the wrench up to the rubber isolator, cradling the hanger rod as shown. Next place the flat edge of a pry bar between the wrench and the hanger stop or hanger rod. Then simply rotate the pry bar toward the wrench to remove the rubber isolator.

Note: Using a spray lubricant or soapy water on the hanger rod and the rubber isolator helps removal.

FISHWIRE TECHNIQUE

INSERT COILED END OF FISHWIRE TOOL THROUGH HITCH MOUNTING HOLE IN VEHICLE FRAME RAIL AND OUT THE ACCESS HOLE. PASS COILED END OF FISHWIRE THROUGH SPACER AND THREAD BOLT INTO COIL. KINK WIRE TO KEEP SPACER SEPERATE FROM BOLT AS SHOWN. PULL FISHWIRE, SPACER, AND BOLT THROUGH FRAME AND OUT MOUNTING HOLE. USE FISHWIRE TO GUIDE HITCH DURING MOUNTING AND PREVENT LOSS OF BOLT / SPACER INSIDE FRAME RAIL.

NOTE: SOME VEHICLES MAY FISHWIRE THROUGH END OF FRAME

The instruction here is for your reference only. We strongly recommend the professional installer for best result. We are not responsible for any damage caused by the installation. Thank you for choosing our product!



Hitch Installation Instruction

REV.20231201

Part#	HT-R31981	Application	For 2008-2017 Buick Enclave 2009-2017 Chevrolet Traverse 2007-2016 GMC Acadia 2017-2017 GMC Acadia Limited 2007-2010 Saturn Outlook
--------------	-----------	--------------------	---

Step	Description
1	Remove bumper fascia panel. (Note: Panel may be reinstalled on some models after hitch installation if desired.)
2	Lower exhaust to ease installation. (See Rubber Isolator Removal Diagram)
3	Raise hitch into position over the exhaust pipes aligning the slots in the hitch with the weldnuts in the bottom of the frame rails.
4	Install (4) M12 bolts and conical toothed washers through the side plates and into the existing weld nuts in the frame rails are shown.
5	If weldnuts in bumper beam are present, install (2) M12 bolts and conical toothed washers as shown. If the weld nuts are not present, fishwire, carriage bolts and spacers into position from the end of the bumper beam. Some models may require going through square access hole next to the mounting locations (square access hole may need to be slightly enlarged to fishwire hardware into position). Secure with (2) M12 hex flange nuts as shown. (See Fishware Technique.)
6	Torque all M12 fasteners to 86 ft-lbs.
7	Raise exhaust back into position, reinstall rubber isolaters and fascia panel (if desired).

The instruction here is for your reference only. We strongly recommend the professional installer for best result. We are not responsible for any damage caused by the installation. Thank you for choosing our product!