

Part#	HT-R31265	Application	For 2004-2012 Chevy Colorado\ 2004-2012 GMC Canyon\ 2006-2008 Suzuki series					
-------	-----------	-------------	---	--	--	--	--	--

Hardware List	Item	Part Name	QTY	Description	Item	Part Name	QTY	Description
	1	Fishwire	1		5	Flat Washers	2	M14
	2	Spacer_1	2	With SQ hole	6	Hex Bolts	2	M14X2-60
	3	Spacer_2	4	With SQ hole	7	Carriage Bolts	4	M12X1.75-45
	4	Spacer_3	2	With Round Hole	8	Hex Flange Nuts	4	M12X1.75

Gross Load Capacity When Used As A Weight Carrying Hitch: 4000 LBS. Trailer Weight & 400 LBS. Tongue Weight.
 Gross Load Capacity When Used As A Weight Distribution Hitch: 6000 LBS. Trailer Weight & 600 LBS. Tongue Weight.
*****DO NOT EXCEED VEHICLE MANUFACTURER'S RECOMMENDED TOWING CAPACITY.*****

- * No Trimming Required
- * No Drilling Required

FISHWIRE TECHNIQUE

INSERT COILED END OF FISHWIRE TOOL THROUGH HITCH MOUNTING HOLE IN VEHICLE FRAME RAIL AND OUT THE ACCESS HOLE. PASS COILED END OF FISHWIRE THROUGH SPACER AND THREAD BOLT INTO COIL. KINK WIRE TO KEEP SPACER SEPERATE FROM BOLT AS SHOWN. PULL FISHWIRE, SPACER, AND BOLT THROUGH FRAME AND OUT MOUNTING HOLE. USE FISHWIRE TO GUIDE HITCH DURING MOUNTING AND PREVENT LOSS OF BOLT / SPACER INSIDE FRAME RAIL.

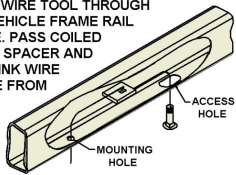

NOTE: SOME VEHICLES MAY FISHWIRE THROUGH END OF FRAME

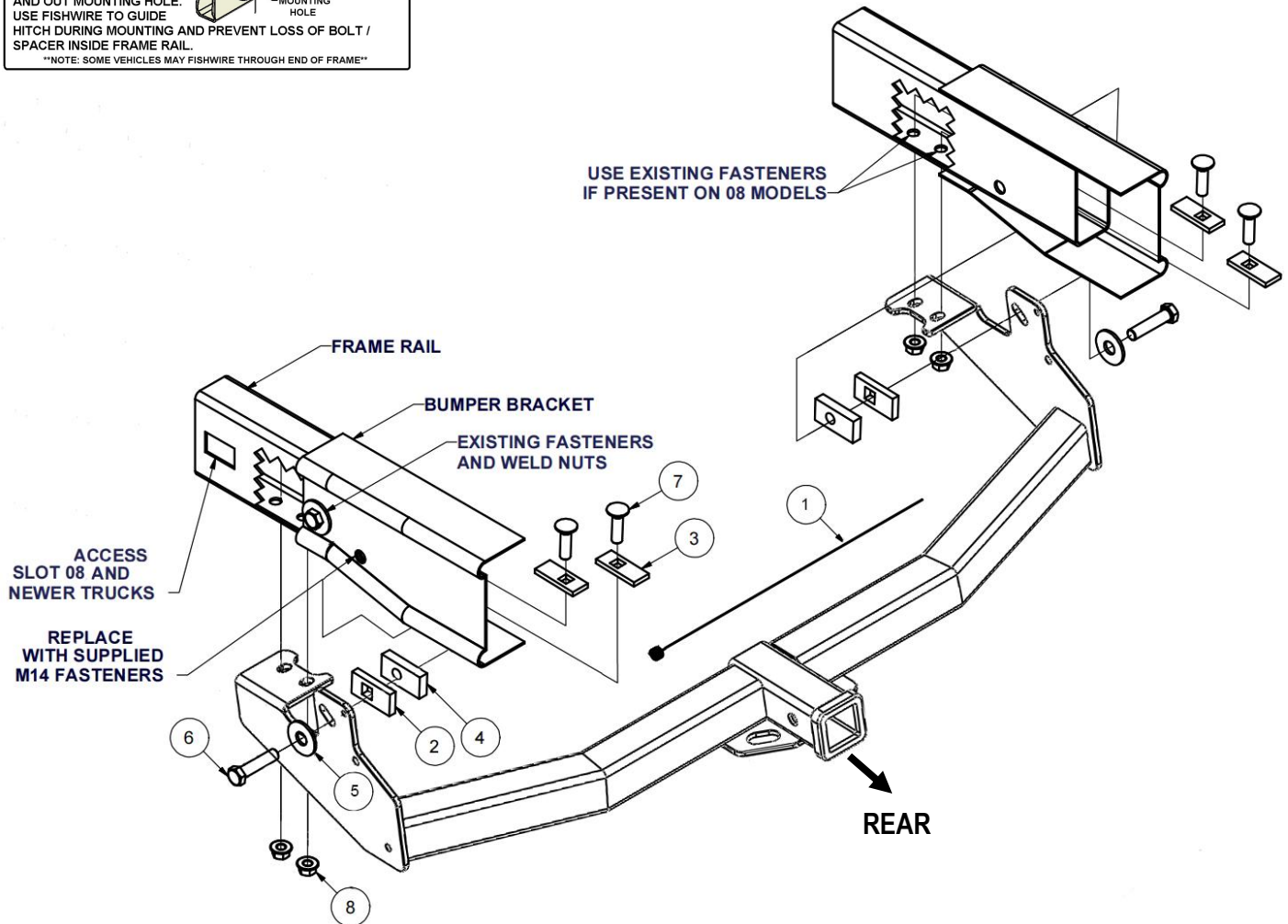

**Note: Hitch is purposely built wide
 Frame Brackets will draw in when tighten**

The instruction here is for your reference only. We strongly recommend the professional installer for best result. We are not responsible for any damage caused by the installation. Thank you for choosing our product!

Part#	HT-R31265	Application	For 2004-2012 Chevy Colorado\ 2004-2012 GMC Canyon\ 2006-2008 Suzuki series
-------	-----------	-------------	---

Step	Description
1	On 2007 and earlier trucks: the bumper brackets are on the outside of the truck frame. On 2008 and newer trucks: the bumper brackets are inside the truck frame. Remove forward bumper bracket bolt, both sides; and loosen rear bumper bracket bolt.
2	Raise hitch into position. Attach with supplied M14 hex bolt and washer. Place a spacer_1 and spacer_3 between hitch side plate and bumper bracket.(Both sides). Loosely fasten both sides before tightening.
3	Fishwire M12 carriage bolts and spacers inside frame rail as shown. On 2007 and older trucks you can fishwire from the end of the frame. On 2008 and newer trucks there is an access slot on the outside of the frame. Fasten with M12 flange nuts.
4	Torque M14 fasteners to 126 lb.-ft. & M12 fasteners to 86 lb.-ft.
<p>***Periodically Check The Receiver Hitch To Ensure That All Fasteners *** Are Tight & All Structural Components Are Sound.</p>	

The instruction here is for your reference only. We strongly recommend the professional installer for best result. We are not responsible for any damage caused by the installation. Thank you for choosing our product!