

Part#	<b>GR20GFJ31 T/H</b>	Application	<b>For 2018-2019 Toyota Tacoma Main Upper with front sensor TSS</b>
-------	--------------------------	-------------	---

Parts List	Item	Part Name	QTY	Description	Item	Part Name	QTY	Description
	1	Mesh Grille	1	Stainless steel	5	Hex Flange Nut	4	M4
	2	Lock Nut	14	10#	6	Nylon Spacer	4	
	3	Flat Washer	9	∅ 16x∅ 6.5x1	7	Flat Washer	8	∅ 25x∅ 5x1
	4	Bolts	4	M4x20	8	Top Mounting Plate	1	

Install Notes: Overlay  Replacement  Drill  Cut

Step	Description	illustration
1	Identify the grille & hardware with parts list.	

**2018 TOYOTA TUNDRA, TACOMA TSS LOGO INSTALLATION:**

<p>1. Disconnect negative battery terminal.</p>	<p>2. Remove access panel (Tundra only) and disconnect TSS harness .</p>	<p>3. Remove TSS sensor module and harness from factory grille. Note the TOP side orientation of the sensor.</p>
<p>4. Remove harness and connector from factory grille tabs.</p>	<p>5. Install factory TSS sensor to mounting plate. Use supplied (4) #10 screws, washers and lock nuts. Torque to 30 in-lbs.</p>	<p>6. Install supplied 4 spacers as shown</p>

The instruction here is for your reference only. You may need to bend the grille a little bit to adjust to fit. We strongly recommend the professional installer for best result. We are not responsible for any damage caused by the installation. Thank you for choosing our product!

Part#	<b>GR20GFJ31 T/H</b>	Application	<b>For 2018-2019 Toyota Tacoma Main Upper with front sensor TSS</b>
-------	--------------------------	-------------	---



7. Install complete assembly to mounting studs with spacers in place. Use (4) #10 lock nuts and Torque to 30 in- lbs. Note orientation of TOP side of module. Connect harness to module, press harness cable mounts into position as shown.



8. Press harness cable mounts into bracket as shown.

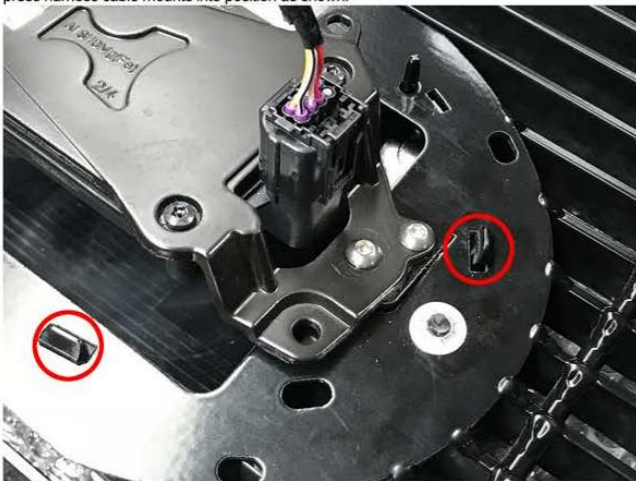

9. Install OEM. front logo as shown. Do not force logo into the logo mounting plate. Insert the lower tabs First, then the upper tabs. .



10. Install grille to vehicle. Connect TSS harness.



11. Replace access cover (Trunda Only)



12. Reconnect negative battery terminal.

The instruction here is for your reference only. You may need to bend the grille a little bit to adjust to fit. We strongly recommend the professional installer for best result. We are not responsible for any damage caused by the installation. Thank you for choosing our product!

Part#	GR20GFJ31 T/H	Application	For 2018-2019 Toyota Tacoma Main Upper with front sensor TSS
-------	------------------	-------------	--

- Turn off engine and chalk tires with stop block. Open Hood. (Fig 1)
- With the hood open, near the main head lamps, identify and remove (2) plastic push pins. (Fig 2)
- Identify and remove (2) 10mm bolts. (Fig 2-4)



- Using both hands firmly grasp the grille and with a firm tug on both sides will release clips at bottom of grill. The Grille should now be free to pull away from truck.(Fig 5-6)

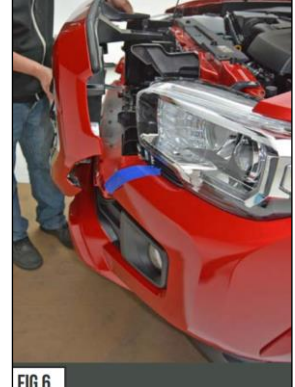
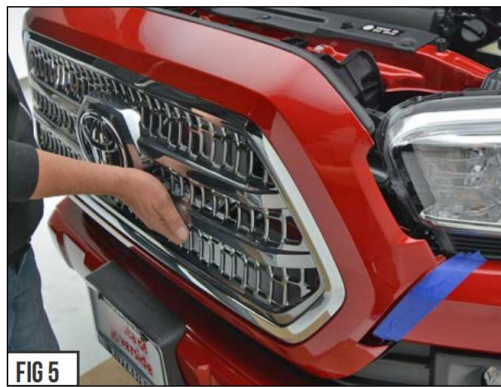

- Flip the grille assembly over and place on a flat cushioned surface or foam pad to begin disassembly.(Fig7)
- Use Phillips head screwdriver to remove (9) #8 screws located around the grille assembly perimeter that secures the inner shell to outer shell.(Fig8)



The instruction here is for your reference only. You may need to bend the grille a little bit to adjust to fit. We strongly recommend the professional installer for best result. We are not responsible for any damage caused by the installation. Thank you for choosing our product!

<b>Part#</b>	<b>GR20GFJ31 T/H</b>	<b>Application</b>	<b>For 2018-2019 Toyota Tacoma Main Upper with front sensor TSS</b>
--------------	--------------------------	--------------------	---

- 8 At this point you to remove the inner shell liner that holds and secures the main factory grille in the grille assembly. (Fig 9-11)
- 9 Using a pair of broad nose pliers and press the grille locking tabs so that you will release the inner shell lip guard. (Fig 9)
- 10 You may need to manually press the tabs to completely free the inner shell. (Fig 10)

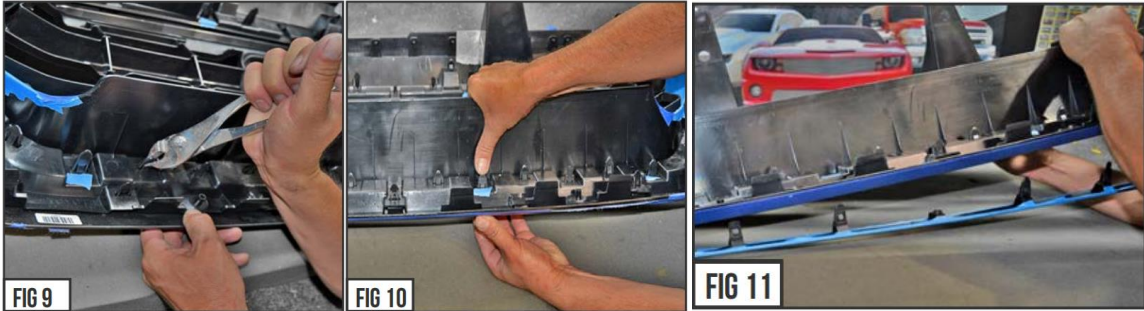

- 11 Inner Grille Shell Lip Removed.(Fig 12-14)
- 12 At this point you will need to remove the main factory grille from the complete grille assembly. Using the same technique as before, pinch the tabs and manually press them through the pre-arranged hole. (Fig 15-20)

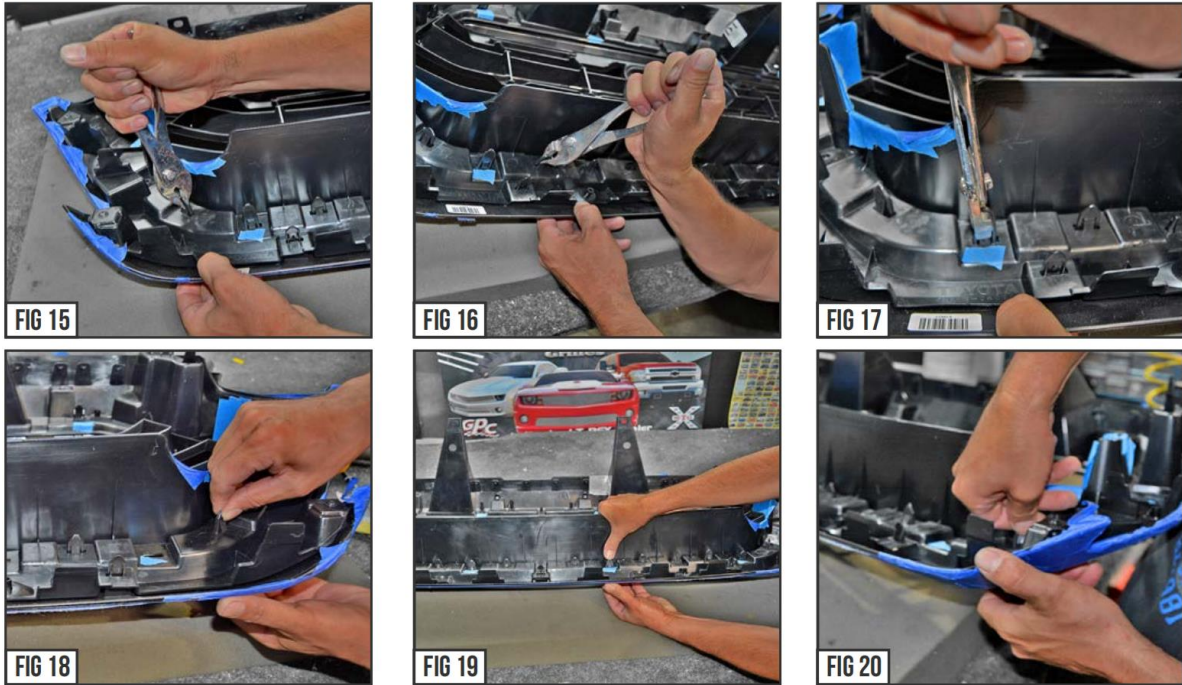

The instruction here is for your reference only. You may need to bend the grille a little bit to adjust to fit. We strongly recommend the professional installer for best result. We are not responsible for any damage caused by the installation. Thank you for choosing our product!

Part#	<b>GR20GFJ31 T/H</b>	<i>Application</i>	<b>For 2018-2019 Toyota Tacoma Main Upper with front sensor TSS</b>
-------	--------------------------	--------------------	---

- 13 The Main grille should now be free from the grille assembly and can be pulled forward and set aside. (Fig 21-24)
- 14 **YOUR VEHICLE MAYBE EQUIPPED WITH THE TOYOTA SAFETY SENSE (TSS) FEATURE.SEE OUR TSS INSTALL SUPPLEMENT GUIDE FOR PROPER TSS INTEGRATION WITH THE NEW GRILLE. SEE TSS INSTALL SUPPLEMENT GUIDE.**



- 15 Take your new grille Insert and place, face down, on the soft cushioned foam pad.(Fig 24)
- 16 Take your grille shell assembly and place over and down on the grille so that the grille's threaded mounting studs will align and insert into their designated holes.(Fig 24-25)
- 17 The grille is now ready to be secured and fastened to factory grille shell assembly. Using an Nut driver, socket, or wrench and the provided Nylon Lock Nuts, tighten and secure the grille insert to the factory grille assembly. Secure the grille by first inserting a screw into the top middle tab bracket and tighten down loosely. Inspect and align all gaps between grille and grille shell.(Fig 26-28)

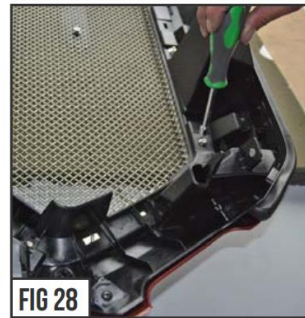
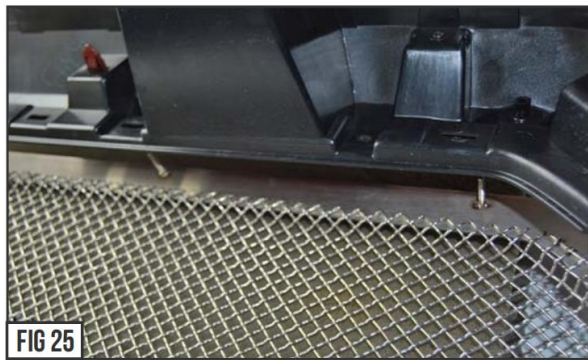

- 18 Re-install the grille assembly in the reverse order that it was removed from the vehicle. At this point you want to look over your work and examine the gap alignments around all edges and in between the new grille and the vehicle components and body lines. Carefully close the hood for a complete visual inspection. If adjustment is needed, you can loosen the hardware mounts and shift side to side or up & down to achieve proper look. Check over your work for hardware tightness and visual inspection.

The instruction here is for your reference only. You may need to bend the grille a little bit to adjust to fit. We strongly recommend the professional installer for best result. We are not responsible for any damage caused by the installation. Thank you for choosing our product!