



PATENT PRODUCT Grille Installation Instruction

Rev. 20220901

| | | | |
|--------------|-------------|--------------------|---------------------------------|
| Part# | N65564C&J&S | Application | For 2013-2016 Nissan Pathfinder |
|--------------|-------------|--------------------|---------------------------------|

| Parts List | Item | Part Name | QTY | Description | Item | Part Name | QTY | Description |
|------------|------|---------------------|-----|-----------------|------|-----------|-----|-------------|
| | #1 | Billet Grille | 1 | Stainless Steel | #3 | Clip Nuts | 4 | 8# |
| | #2 | Self Tapping Screws | 4 | 8#-2.5" | #4 | Tabs | 4 | |

Install Notes: Overlay Replacement Drill Cut

| Step | Description | illustration |
|------|--|--------------|
| 1 | Identify the grille & hardware with parts list. | |
| 2 | Optional: pop hood, remove the black plastic cover (on top of OEM grille) from vehicle. If you are still unable to access the rear, remove the grille shell according to factory manual. | |
| 3 | Thread a Screw in each nut welded to the grille. Secure billet grille using the U-Clip Nuts and Tabs from the back side of the grille shell. | |

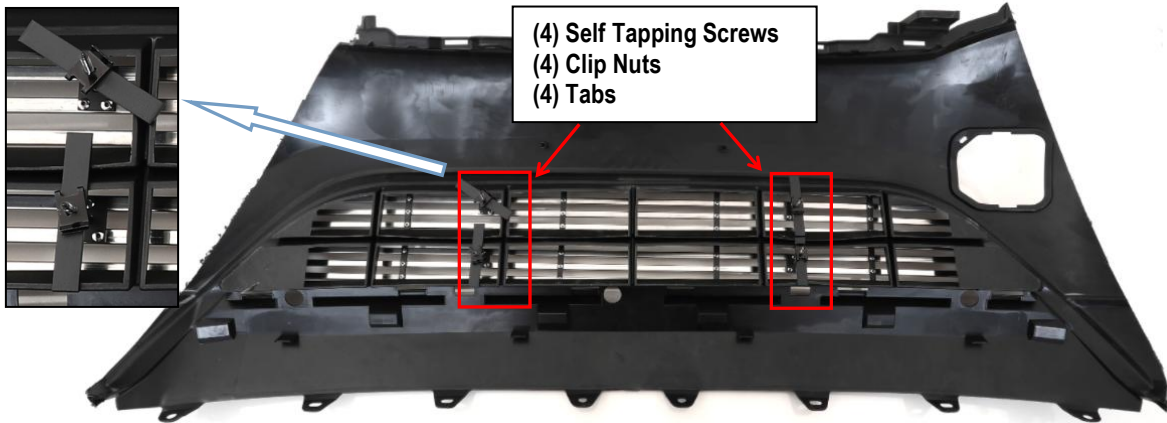

| | | |
|---|--|--|
| 4 | Make sure the insert is centered and tighten the hardware. | |
| 5 | Reinstall the plastic shroud with the fasteners removed in Step 2 . | |

| | | |
|---|-------------------------|--|
| 6 | Installation completed. |  |
|---|-------------------------|--|

The instruction here is for your reference only. We strongly recommend the professional installer for best result. We are not responsible for any damage caused by the installation. Thank you for choosing our product!