

PATENT PRODUCT

Grille Installation Instruction

Rev. 20230701

Part#	F65294C&J&S	Application	For 2019-2022 Ford Edge ST&ST-Line /2023 Ford Edge SE&SEL&ST&ST-Line
-------	-------------	-------------	---

Parts List	Item	Part Name	QTY	Description	Item	Part Name	QTY	Description
	#1	Billet Grille	1	Stainless Steel	#3	Clip Nuts	4	8#
	#2	Self Tapping Screws	4	8#-1.5"	#4	Tabs	4	

Install Notes: Overlay ☒ Replacement ☐ Drill ☐ Cut ☐

Step	Description	illustration
------	-------------	--------------

1 Identify the grille & hardware with parts list.

2 Optional: pop hood, remove the black plastic cover (on top of OEM grille) from vehicle. If you are still unable to access the rear, remove the grille shell according to factory manual.

3 Install the Clip Nuts onto the Flat tabs as shown.



4 Thread a Screw in each nut welded to the grille. Secure billet grille using the U-Clip Nuts and Tabs from the back side of the grille shell.

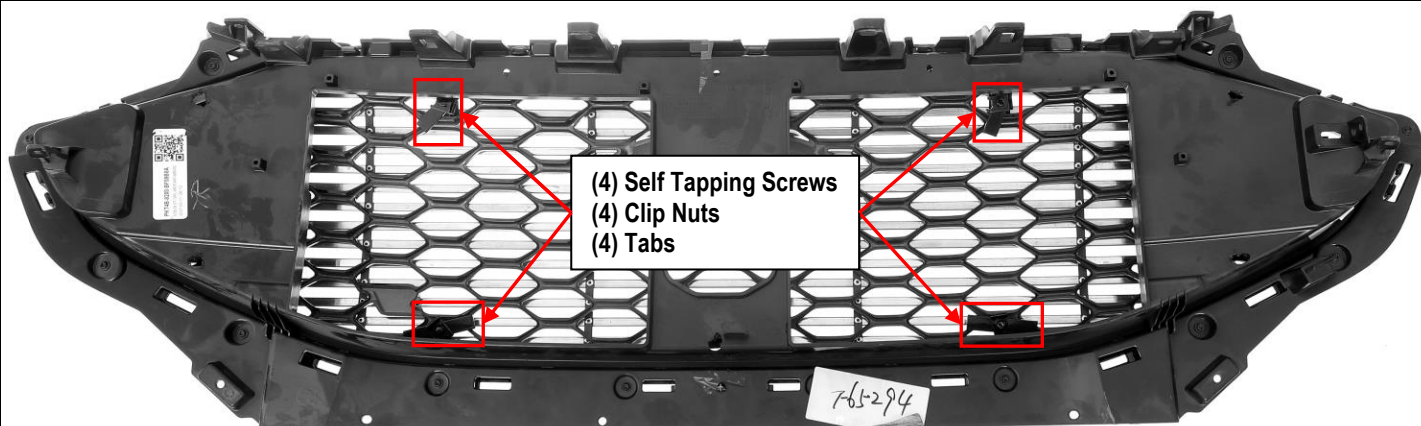

5 Make sure the insert is centered and tighten the hardware.

6 Reinstall the plastic shroud with the fasteners removed in Step 2.

7 Installation completed.



The instruction here is for your reference only. We strongly recommend the professional installer for best result. We are not responsible for any damage caused by the installation. Thank you for choosing our product!